

2010 Audi S4 3.0L S/C

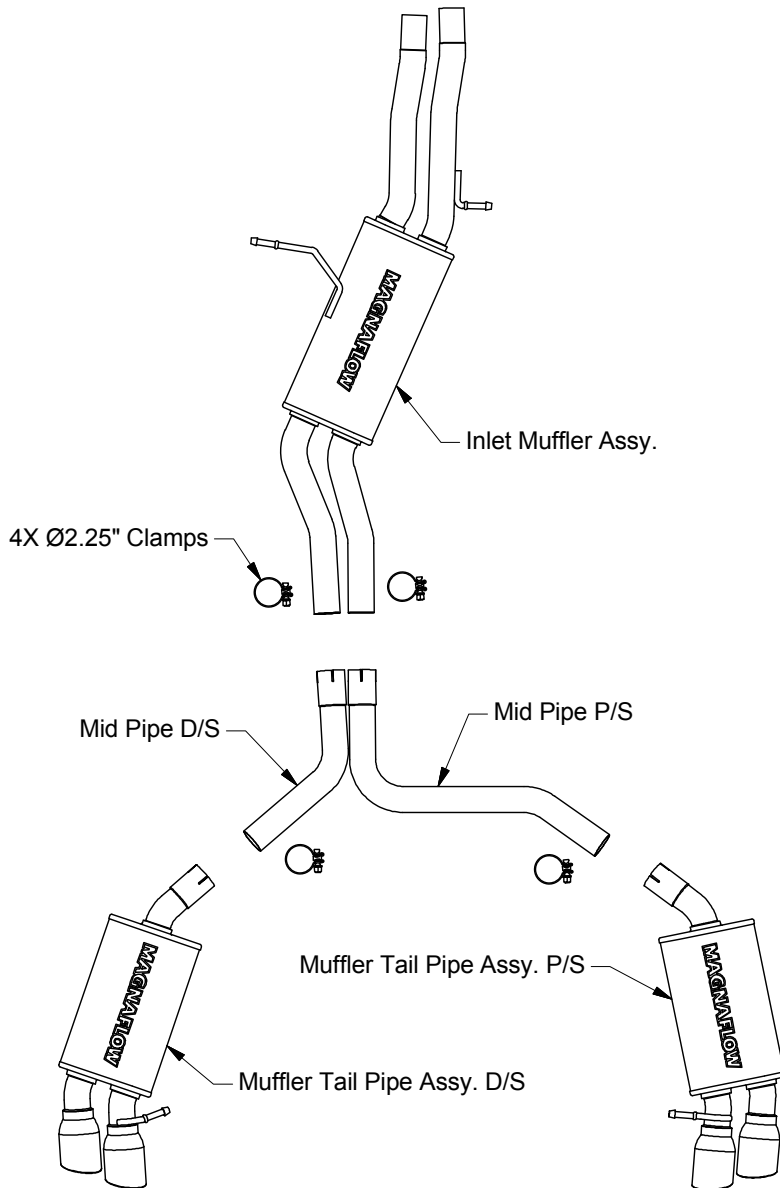

Warning: When working on, under, or around any vehicle exercise caution. Please allow the vehicle's exhaust system to cool before removal, as exhaust system temperatures may cause severe burns. If working without a lift, always consult vehicle manual for correct lifting specifications. Always wear safety glasses and ensure a safe work area. Serious injury or death could occur if safety measures are not followed.

Step 1: Remove the OEM exhaust system by first loosening the clamps attaching the inlet pipes to the catalytic converter. Working front to rear loosen all connecting band clamps. Carefully remove the hangers from the rubber isolators. Be sure to retain all mounting hardware as it will be need to install your new MAGNAFLOW performance exhaust system.

Step 2: Begin the installation process by first loosely attaching the inlet pipes of the inlet muffler assembly to the catalytic converter using the OEM clamps. Slip the driver side and passenger side mid pipe inlets over the outlet ends of the muffler assembly pipes and loosely secure using the supplied clamps. Next, slip the inlet pipes of the driver side and passenger side muffler tail pipe assemblies and secure loosely using the supplied clamps. Next, locate all hangers to the respective rubber isolators.

Step 3: With all components mounted loosely, adjust the system for overall aesthetics and clearance of frame & bodywork. (MAGNAFLOW recommends at least 1/2" of clearance between the exhaust system and any body panels to prevent heat-related body damage or fire.)

Step 4: Once a final position has been chosen for the new system, evenly tighten all fasteners from front to rear. The supplied band clamps must be VERY tight to properly align the pipes and prevent leaks (Approximately 65ft-lbs). U-bolt clamps should be tightened to approximately 30-35ft-lbs. Inspect all fasteners after 25-50 miles of operation and retighten if necessary.

**** Magnaflow Performance Exhaust recommends professional installation on all their products**