

# INSTALLATION INSTRUCTIONS

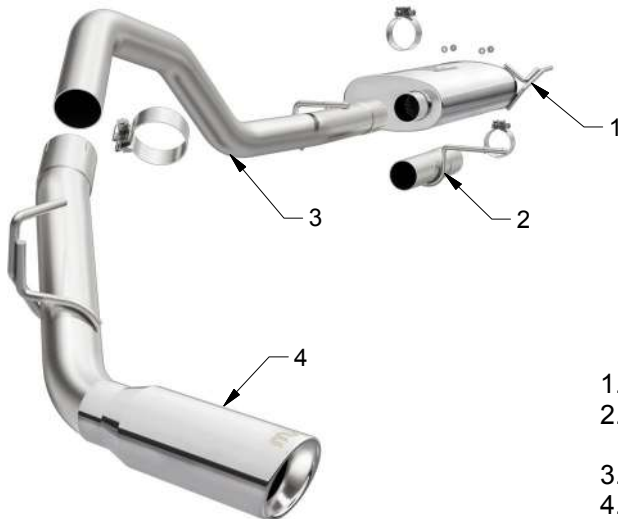

2018 FORD EXPEDITION 3.5L | PART NO. 19424

### BILL OF MATERIALS:



- 1. MUFFLER ASSEMBLY.
- 2. EXTENSION PIPE ASSEMBLY (MAX VERSION)
- 3. OVER-AXLE PIPE ASSY.
- 4. TAIL PIPE ASSEMBLY.



WEAR SAFETY GLASSES



READ INSTRUCTIONS THOROUGHLY BEFORE INSTALLING PRODUCT

### SHOP SUPPLIES:



SPRAY LUBRICANT

To ease removal of existing exhaust components (especially on older vehicles) spray penetrating lubricant on all fasteners and hangers/insulators that will be loosened or removed and let soak before disassembly.

### HARDWARE KIT:

- 1.[3] 3.00" Clamp
- 2.[2] Nut Hex Stover M10
- 3.[2] Washer M10

### MINIMUM REQUIRED TOOLS:



10, 14, 15, 17mm



Hanger Tool (Or Pry Bar)

## MAGNAFLOW RECOMMENDS PROFESSIONAL INSTALLATION ON ALL THEIR PRODUCTS



**WARNING:** When working on, under, or around any vehicle exercise caution. Please allow the vehicle's exhaust system to cool before removal, as exhaust system temperatures may cause severe burns. If working without a lift always consult vehicle manual for correct lifting specifications. Always wear safety glasses and ensure a safe work area. Serious injury or death could occur if safety measures are not followed.

**ATTENTION:** Always install any supplied band or U-bolt clamps to the proper torque specifications of 40-45 ft-lbs for band clamps and 30-35 ft-lbs for U-bolt clamps. Over tightening will result in the clamp breaking and will NOT be warranted by MagnaFlow.

## INSTALLATION INSTRUCTIONS



**Step 1.** To remove the OEM exhaust system you will first need to remove the rear sway bar.



**Step 2.** Next, remove the tail pipe section by loosening the OEM clamp. Disengage the welded hanger from the rubber insulator and remove the tail pipe assembly. Do not discard or damage the rubber insulators as they will be used to mount the new system.



**Step 3.** Unbolt the muffler assembly from the catalytic converter outlet at the flange junction. Disengage all welded hangers from the rubber insulators. The remainder of the system can now be removed.



**Step 4.** Begin installing your new MAGNAFLOW system by loosely bolting the Muffler Assembly inlet flange to the flex assembly outlet using the supplied hardware.



**Step 5.** If you have the MAX version of the Expedition you will need to loosely install the 11.25" Extension Pipe Assembly. Next, loosely attach the Over-Axle Pipe Assembly and the Tail Pipe Assembly using the supplied 3.00" clamps and engage the welded hangers to the OEM rubber insulators. Re-install sway bar.



**Step 7.** Once a final position has been chosen for the new exhaust system, evenly tighten all clamps from front to rear using the torque specifications on page one of the instructions. Inspect all fasteners after 25-50 miles of operation and re-tighten if necessary.