

INSTALLATION INSTRUCTIONS AND PARTS LIST

APPLICATION: MODEL **281037** (STAINLESS STEEL) SIDE ENTRY STEP BOARDS:
ROCKER MOUNT APPLICATION

1. READ INSTRUCTIONS COMPLETELY AND CHECK TO MAKE SURE THAT ALL REQUIRED PARTS (LISTED ON SERVICE PARTS LIST) ARE ON HAND BEFORE STARTING THE INSTALLATION.
2. WITH THE STEP BOARD BRACKETS ATTACHED TO THE VEHICLE, ON THE LEFT SIDE OF THE VEHICLE PLACE THE STEP BOARD (ITEM #1) ON THE BRACKETS AND CHECK THAT THE MOUNTING HOLES LINE UP. (THE LUVERNE STICKER SHOULD BE ON THE FRONT DRIVERS SIDE)
3. INSERT THE 10-24 X .75" CARRIAGE BOLTS (ITEM #3) INTO THE BLACK NEOPRENE WASHERS (ITEM #13).
4. USING SIX (6) 10-24 X .75" CARRIAGE BOLTS (ITEM #3), AND SIX (6) 10-24 FLANGE NUTS (ITEM #4) ATTACH THE STEP BOARD TO THE BRACKETS.
5. ADJUST STEP IN/OUT TO ALIGN STEP WITH THE CAB.
6. TIGHTEN THE STEP MOUNTING BOLTS.
7. REPEAT FOR RIGHT SIDE OF VEHICLE.

SERVICE PARTS LIST

ITEM	QTY	DESCRIPTION
1	1	STEP PLATE-SES, LH, 281037, CREW CAB
2	1	STEP PLATE-SES, RH, 281037, CREW CAB
3	10	BOLT – CARRIAGE –, 10-24 X .75"
4	12	NUT – FLANGE, SST, 10-24
5	2	END CAP – RH FRONT/LH REAR
6	2	END CAP – LH FRONT/RH REAR
7	4	STEP PAD, 5.50 X 20.00
8	8	NUT – HEX, SINGLE THREAD
9	4	SCR-PPH, #8-18 X .5", SST
10	4	CLIP-U, .118-.185, BLK
11	24	BOLT – CARRIAGE, 10-24 X .5", BZP
12	2	TRIM-SEAL, EXTRUSION, 95", CREW/MEGA CABS
13	12	WASHER-NEOPRENE, .200 X .468 X .03



SERVICE PARTS LIST

MODEL NO. - 281037

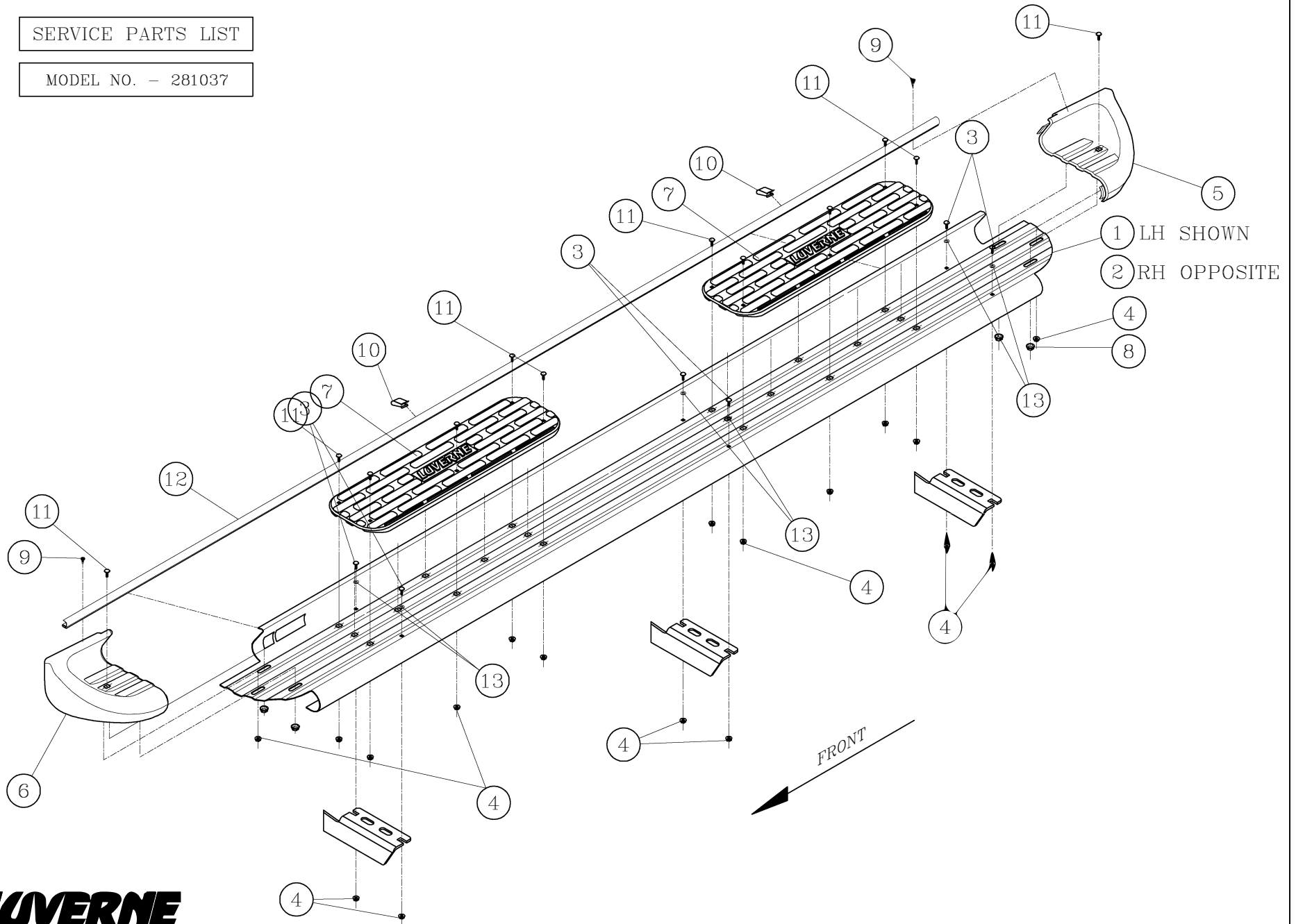

Rely on premium running boards and step bars by Luverne Truck Equipment if you're looking for quality and efficiency.