

# Installation Instructions

® I - Sheet Number LUND 10772

## **LUND** OE Style No Drill Bracket

For proper installation and best possible fit, please read all instructions BEFORE you begin.

### Important Safety Information



- To be used with Lund® branded products only.
- Do not stand on Lund running board or bracket while vehicle is in motion.
- Do not exceed 350 lbs. weight on the Lund bracket system.
- Do not use the brackets as a jacking point for the vehicle.
- Do not use the bracket system or running boards to fasten cargo.
- Periodically check all components for tightness.
- Be sure to wear safety glasses while installing brackets.
- When using power tools, read and understand all operating instructions.

### Contents

NOTE: Actual product may vary from illustration.

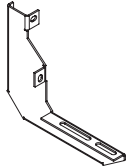

Front Bracket  
(M-3304) (2)  
OR (M-3305) (2)

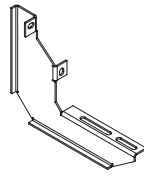

Rear Bracket  
(M-3306) (2)  
OR (M-3307) (2)



P-1032



Flange Nut  
8mmx12

### Tools Required



Torque Wrench



Safety Glasses



Socket Wrench



Wrench



Socket Set



Stanley Knife

### Preparation Before Painting / Installation

- Park your vehicle in a clean, level location. Check to make sure the vehicle is in park, or for manual drive models, place the transmission in first gear. Engage the parking brake.
- Unpack the bracket kit and identify the parts according to the content descriptions.
- A trial fit is recommended to ensure proper positioning and fit.
- Check fit of parts before painting as we will not accept the return of modified or painted parts.

# Installation Steps

NOTE: Actual application may vary slightly from illustrations.

Identify the mounting locations for each bracket by looking under the vehicle and finding the holes in the pinch weld.

1

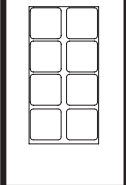
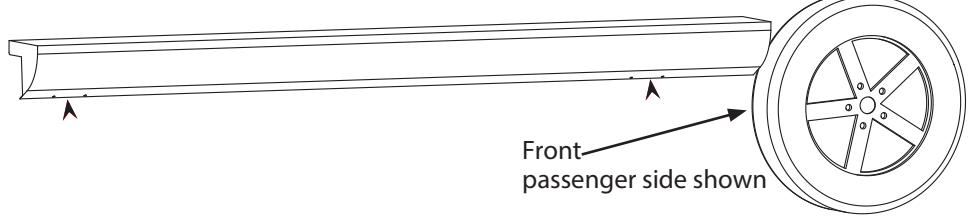

Peel plastic then apply to bracket as shown in the image above. Cut through the plastic with blade as shown in the image.

2

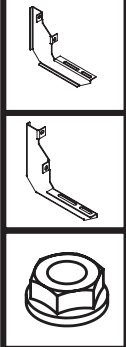
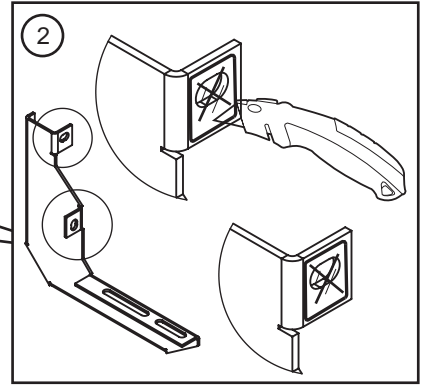
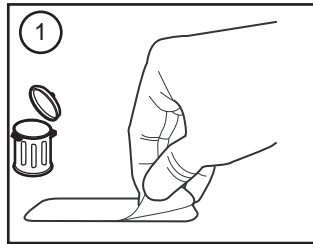
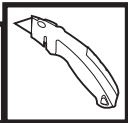

Begin bracket installation by locating bracket on inner rocker panel so that the hole in the bracket lines up with the bolt sticking out of the rocker panel (M-3304 or M-3305 goes in front locations, M-3306 or M-3307 rear locations). Use the nuts given in the kit to bolt the bracket on to the rocker panel. Complete bracket installation by tightening bolts down.



3

Front Passenger side shown  
Repeat for opposite side

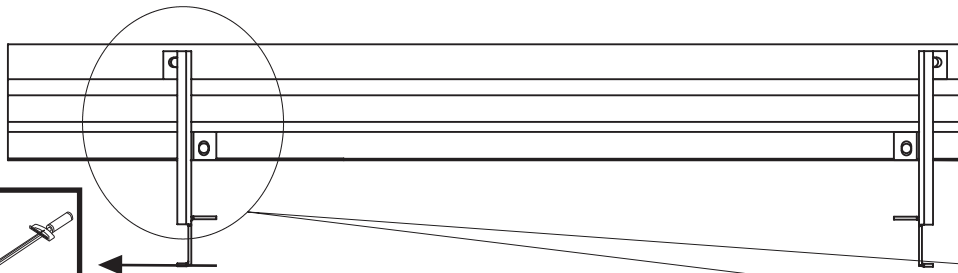

10 ft-lb / 13.6 N-m

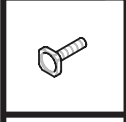
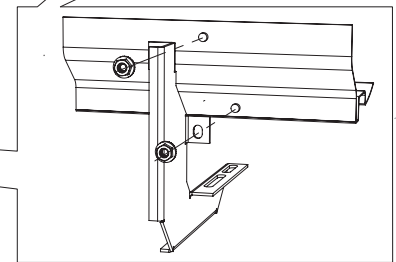
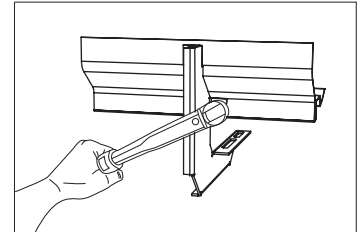

4

Install square bolts into the shaded outer channels. One (1) bolt in each channel per bracket to attach boards.

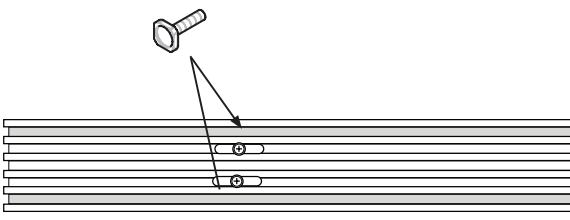

Attach boards to brackets. Tighten all Fasteners.

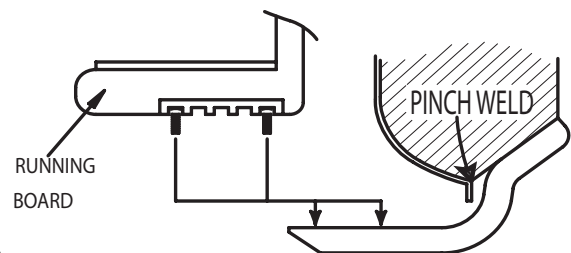

Washer  
5/16" Nylock Nut

5