

Installation Instructions

I - Sheet Number I-PW010978 Rev.A

LUND[®]

Premium Style. Lasting Performance.

For proper installation and best possible fit, please read all instructions BEFORE you begin.

Care and Cleaning

- Wash only with mild soap & dry with a clean cloth.
- Every 3 months or 5000 miles check the cover tension and all components for tightness.

Congratulations!

You have purchased one of the many quality Lund[®] branded products offered by Lund International, Inc. We take the utmost pride in our products and want you to enjoy years of satisfaction from your investment. We have made every effort to ensure that your product is top quality in terms of fit, durability, finish and ease of installation.

INSTALLATION INSTRUCTIONS

PART# 24310565/26610565

PARTS LIST:

Qty	Description	Qty	Description
1	Driver/Left Sidebar	12	8-1.25mm Clip-On Nuts
1	Passenger/Right Sidebar	24	8-1.25mm x 25mm Hex Bolt
6	6" Brackets	24	8mm Lock Washer
		24	8mm x 24mm x 2mm Flat Washer

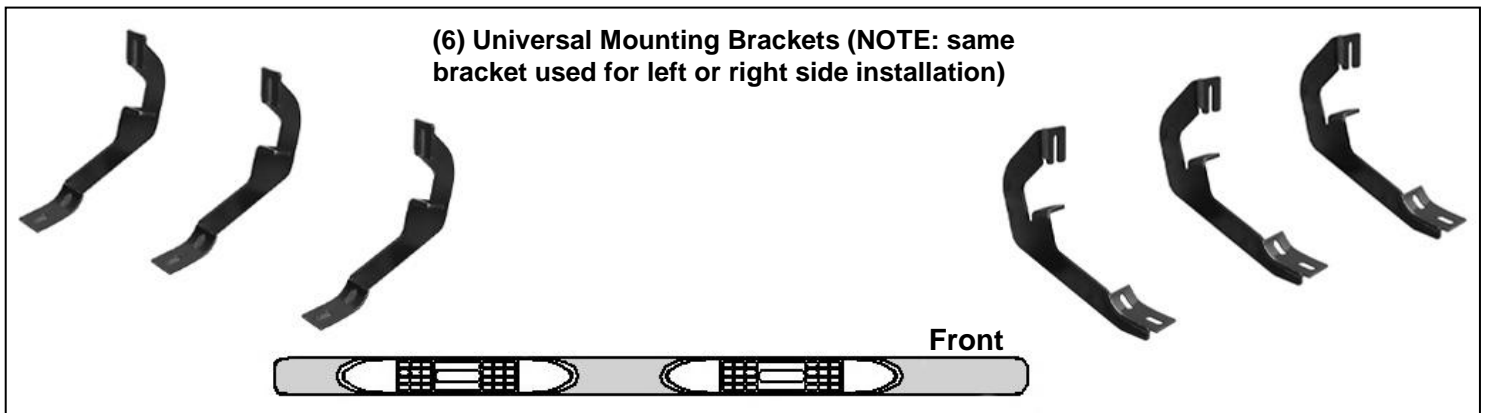

PROCEDURE:

REMOVE CONTENTS FROM BOX. VERIFY ALL PARTS ARE PRESENT. READ INSTALLATION INSTRUCTIONS CAREFULLY BEFORE STARTING INSTALLATION.

- Start the installation under the passenger side of the vehicle. Locate the 1st, 2nd and 4th mounting tabs along the bottom edge of the body, **(Figure 1)**. If necessary, hold the passenger Sidebar up in place to help determine the correct mounting holes to use along the bottom of the body.
 - Vehicles with flat tab, no threaded hole:** Select (1) 8mm Clip Nut. Slide the Clip Nut over the first tab with the nut facing up behind the tab, **(Figure 1)**. Line up threaded nut with hole in tab.
 - Vehicles with factory installed threaded insert in tab:** Thread hex bolt into threaded insert from the backside-down to clear paint as required.
- Locate the inner mounting location on the back of the rocker panel directly above the flat tab in **Step 1**.
 - Vehicles without threaded hole:** Remove the rubber plug from the larger hole, **(Figure 2)**. Select (1) 8mm Clip Nut. Slide the Clip Nut into the larger hole. Line up the threaded nut with the smaller hole, **(Figure 3)**.
 - Vehicles with factory installed threaded insert:** Thread 8mm Hex Bolt into threaded insert to clear paint as required. Use a small amount of oil if necessary, **(Figure 1)**.
- Select (1) Mounting Bracket. **NOTE:** Brackets are universal and will fit left or right side. Bolt the Mounting Bracket to the Clip Nuts and/or the factory threaded holes with (2) 8mm Hex Bolts, (2) 8mm Lock Washers and (2) 8mm Flat Washers, **(Figure 4)**. Snug but do not fully tighten the hardware.
- Repeat **Steps 1 – 3** for all Bracket installations.
- Carefully position the Passenger Sidebar onto the (3) Mounting Brackets. Attach the Sidebar to the Mounting Brackets with (6) 8mm x 25mm Hex Bolts, (6) 8mm Lock Washers and (6) 8mm Flat Washers, **(Figure 5)**. Do not tighten hardware at this time.
- Level and adjust the Sidebar and tighten all hardware.
- Repeat **Steps 2 – 6** for driver Sidebar installation.
- Do periodic inspections to the installation to make sure that all hardware is secure and tight.

6" STRAIGHT ROCKER PANEL MOUNT SIDEBARS
2014 1500 SILVERADO/SIERRA DOUBLE CAB
07-13 1500 SILVERADO/SIERRA EXTENDED CAB
07-14 25-3500 SILVERADO/SIERRA EXTENDED CAB
2015 25-3500 SILVERADO/SIERRA DOUBLE CAB
EXCLUDES DIESEL W/DEF SYSTEM

To protect your investment, wax this product after installing. Regular waxing is recommended to add a protective layer over the finish. Do not use any type of polish or wax that may contain abrasives that could damage the finish.

For stainless steel: Aluminum polish may be used to polish small scratches and scuffs on the finish. Mild soap may be used also to clean the Sidebar.

For gloss black finishes: Mild soap may be used to clean the Sidebar.

Use 8mm Clip Nut or factory threaded insert if equipped

Factory 8mm threaded insert in body panel

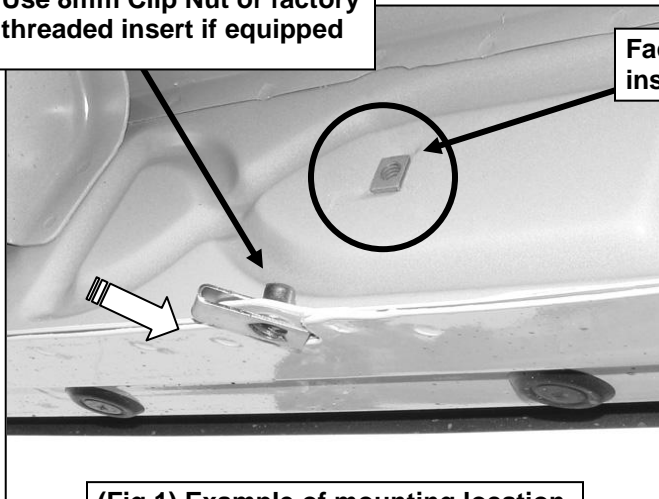

(Fig 1) Example of mounting location with factory threaded hole

Remove plug

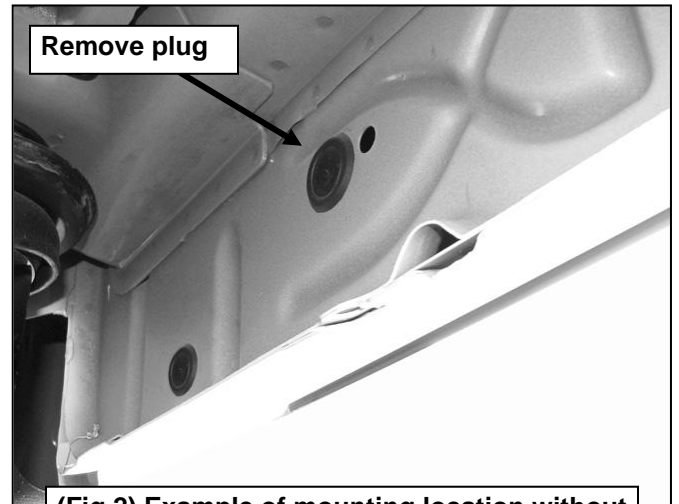

(Fig 2) Example of mounting location without factory threaded hole in rocker panel

(2) 8mm Clip Nuts

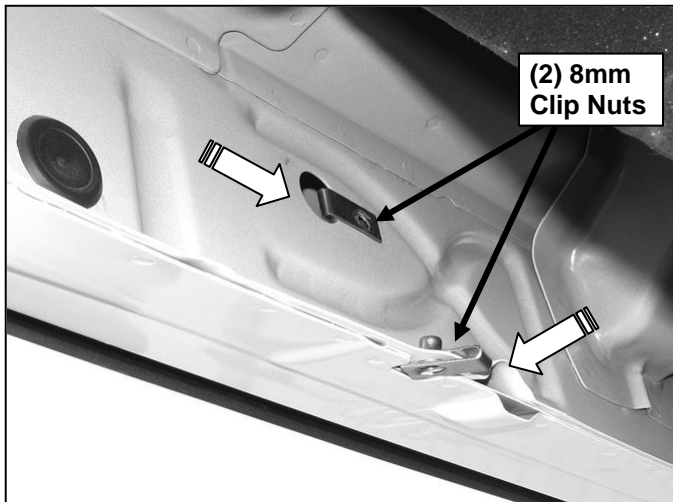

(Fig 3) Insert 8mm Clip Nut as required

8mm x 25mm Hex Bolts
8mm Lock Washers
8mm Flat Washers

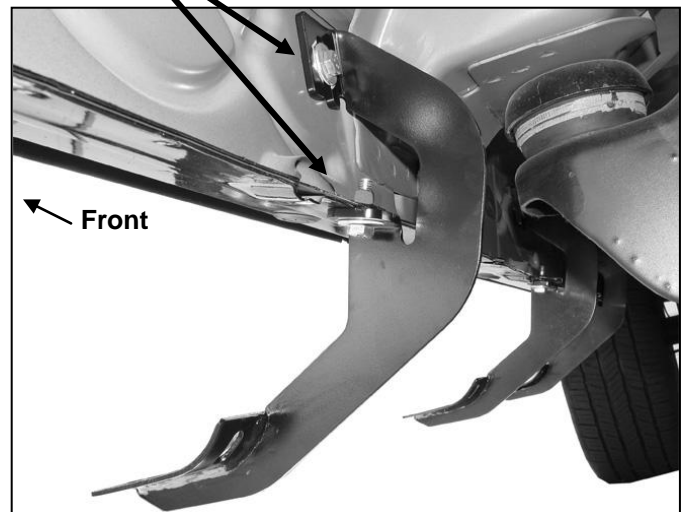

(Fig 4) Passenger side installation pictured

6" STRAIGHT ROCKER PANEL MOUNT SIDEBARS
2014 1500 SILVERADO/SIERRA DOUBLE CAB
07-13 1500 SILVERADO/SIERRA EXTENDED CAB
07-14 25-3500 SILVERADO/SIERRA EXTENDED CAB
2015 25-3500SILVERADO/SIERRA DOUBLE CAB
EXCLUDES DIESEL W/DEF SYSTEM

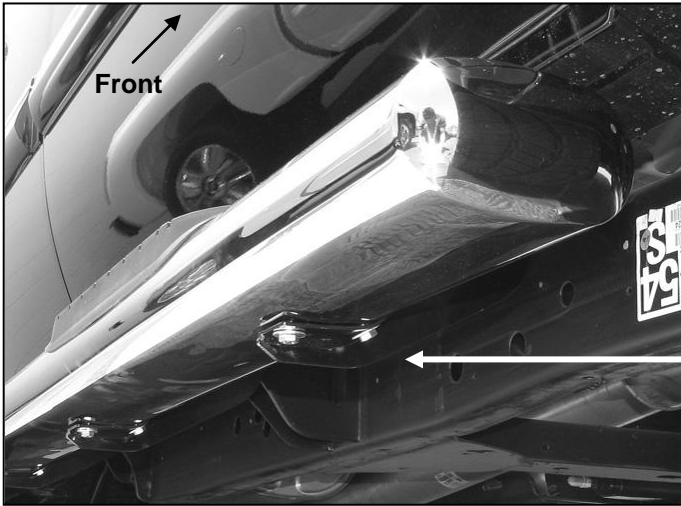

- (2) 8mm x 25mm Hex Bolts
- (2) 8mm Lock Washers
- (2) 8mm Flat Washers

(Fig 5) Passenger side front installation pictured