



DESTROYER SERIES

TRUCK

FRONT CENTER HITCH



VERIFY YOU HAVE ALL THE COMPONENTS BEFORE STARTING THE INSTALLATION. REFER TO THE ENGINEERING DRAWINGS AT THE END OF THIS DOCUMENT FOR A COMPLETE PARTS LIST

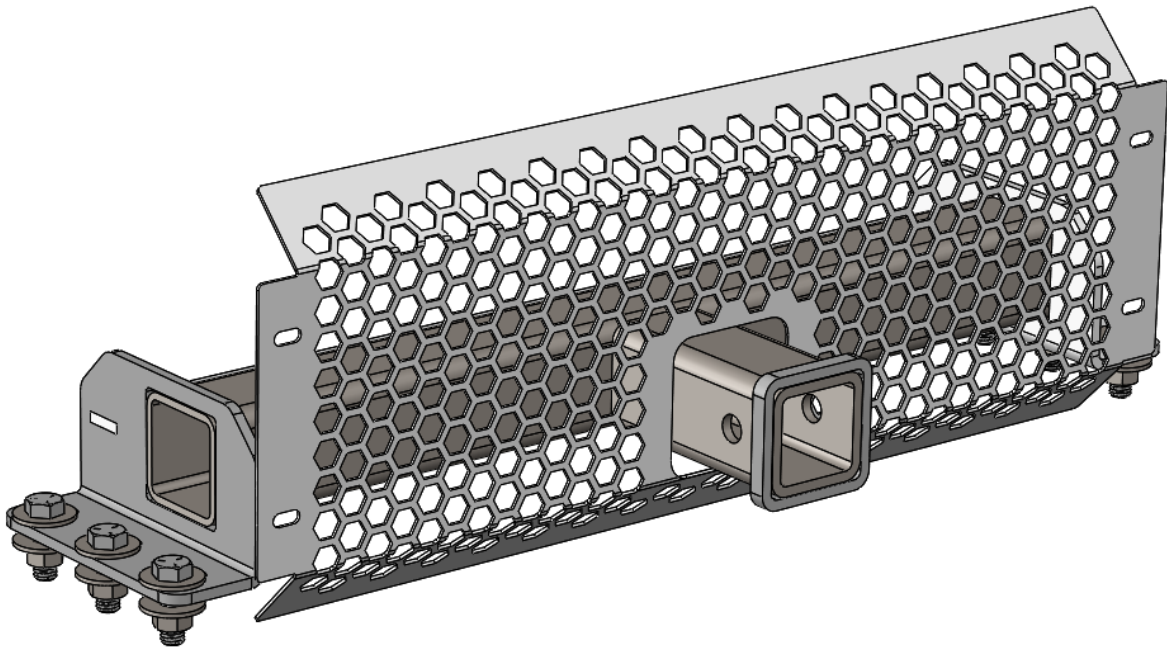

Install your Bumper Mounts following the instructions for your Destroyer Front Bumper.

Before installing the Bumper Center weldment, loosely attach the Front Hitch to the Bumper Mounts as shown using 1/2" Bolts provided.

Bumper Mounts
Style may vary

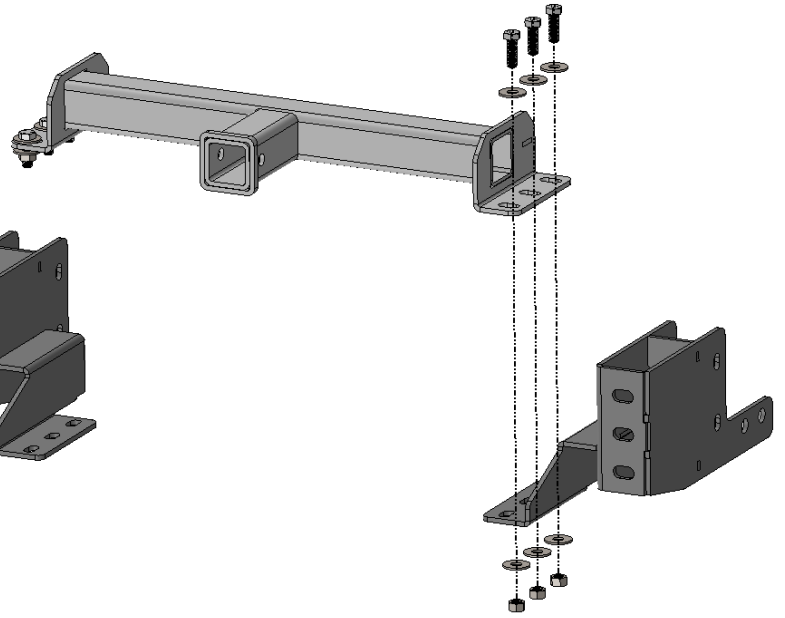

Install the Front Screen into your Bumper Center using the 1/4" Button Head Screws provided with your Bumper Bolt Kit.

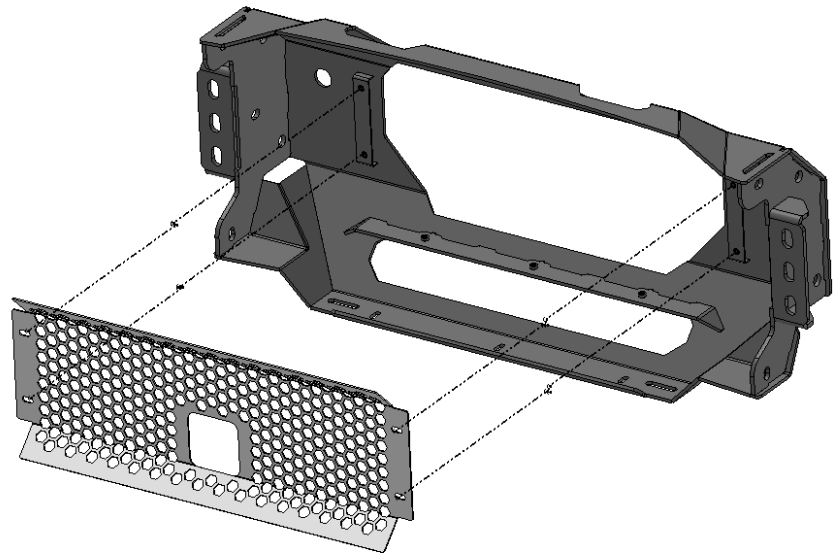

Carefully place the Bumper Center into position and adjust the Front Hitch if needed to fit thru the square hole in the screen. Remove the Bumper Center and tighten all the Front Hitch mounting bolts securely.

Check for clearance around hitch and
for hitch pin (not included)

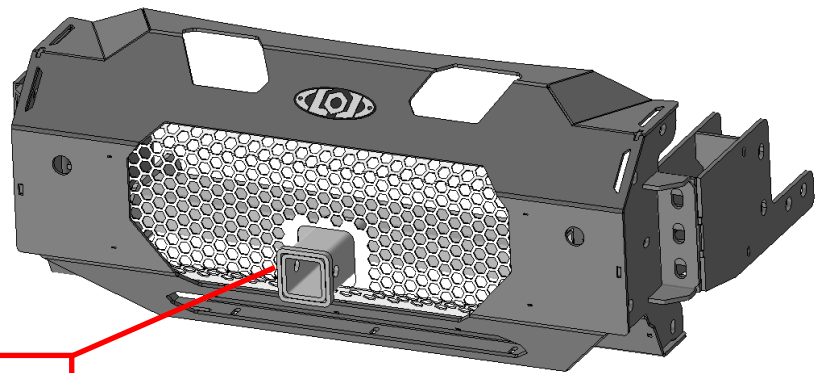

Alternative Installation:

Depending on your truck, you can install the Front Hitch after the bumper is already installed on your truck.

Remove the Front Screen that came with your bumper. Then install the Front Hitch by carefully inserting thru the hole. This will take a bit of maneuvering. Once the Front Hitch is set in place, insert the Front Screen thru the hole in same manner. Then using the access holes in the top of the bumper, secure the Front Hitch and the Front Screen securely.

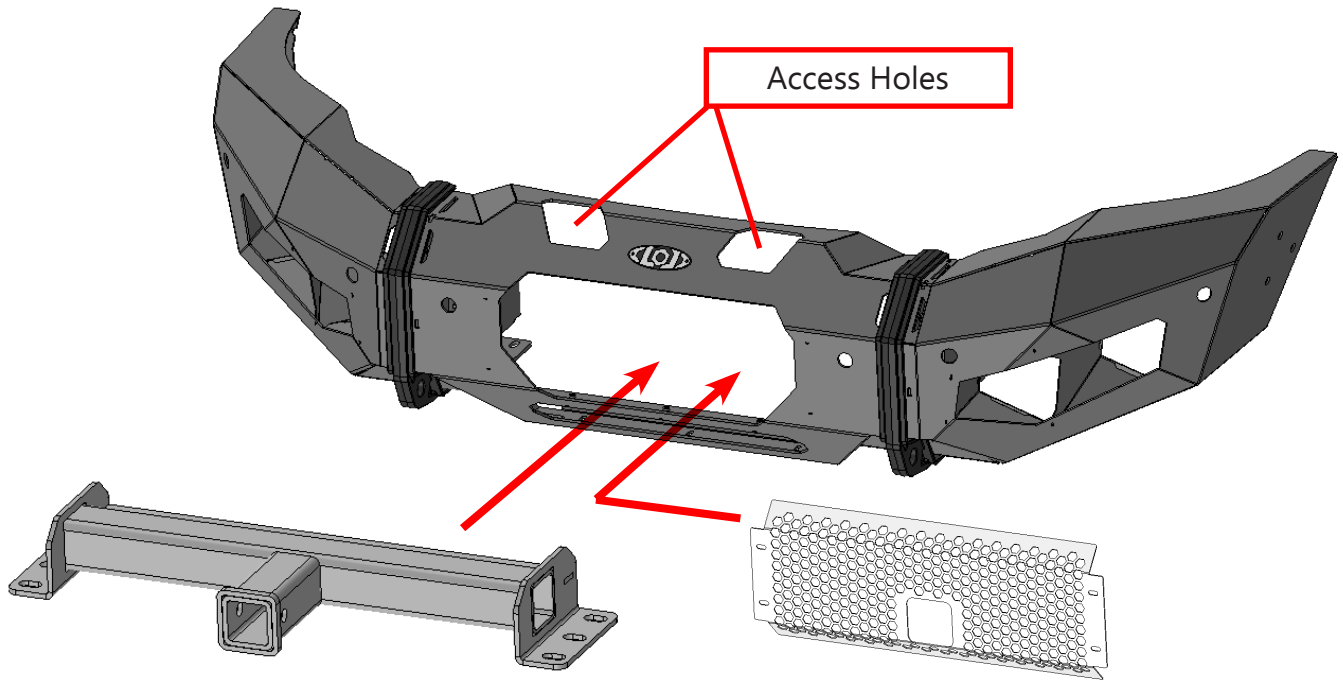

Maintenance

- Periodically check and re-tighten all fasteners.
-
- Periodically check your product for scratches, dings, or rust spots which can happen over time or after heavy use. It is important to address these areas as soon as possible to prevent rust and corrosion from spreading. We recommend using Rustoleum® brand Black Semi-Gloss Protective Enamel (oil based). Apply using a foam brush by dabbing to match the powder coat texture.



ITEM NO.	PART NUMBER	DESCRIPTION	QTY.
1	4MFH2020-01	FRONT HITCH WELDMENT	1
2	2MFH2020-01	FRONT SCREEN - HITCH	1
3	FW5022ZP	FLAT WASHER Ø1/2" X 1.375" ZINC PLATE	12
4	HN5013ZPGR5	HEX NUT 1/2-13 ZINC PLATE GR5	6
5	HB501324ZPGR5	HEX BOLT 1/2-13 X 1.50 HEX BOLT ZINC PLATE GR5	6

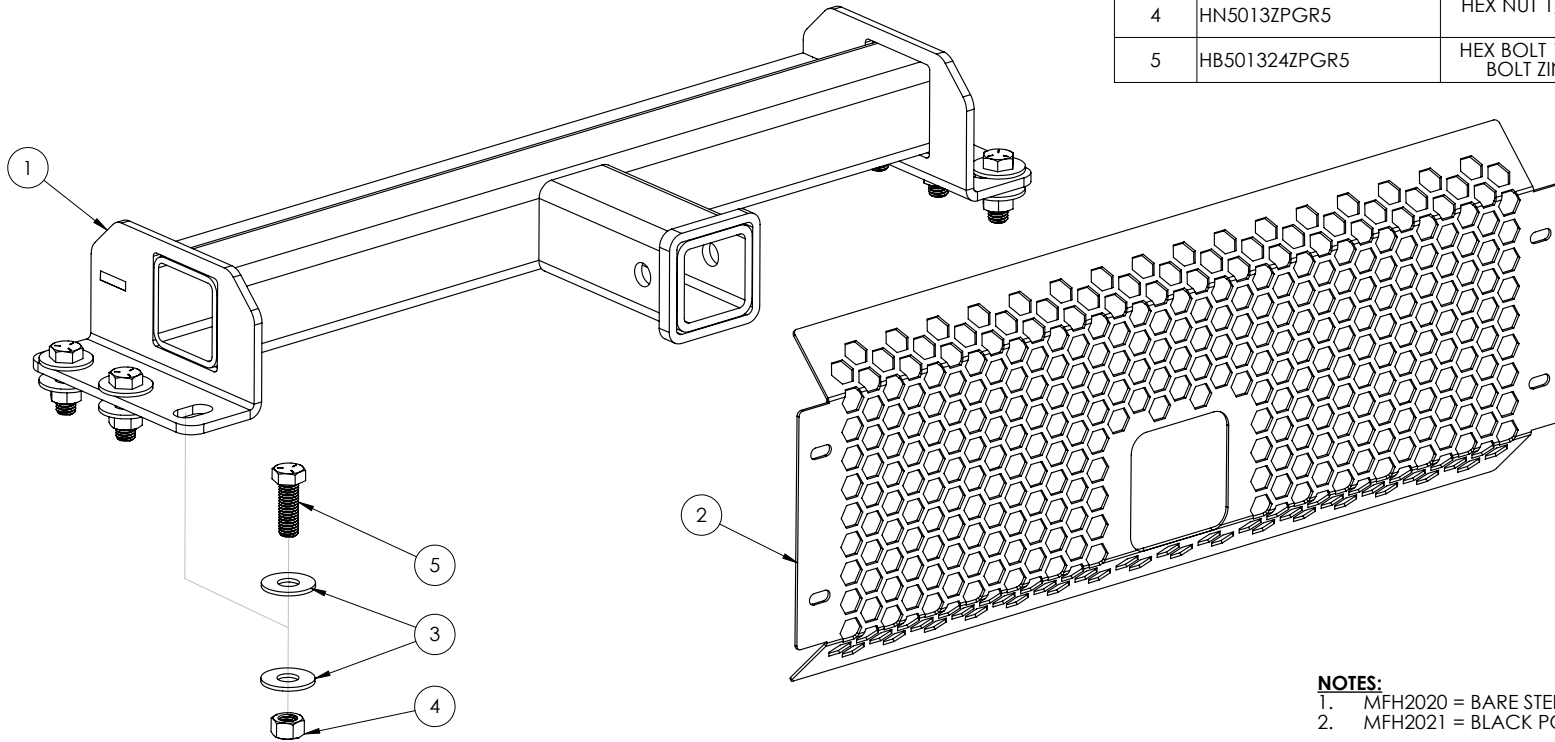

NOTES:

- 1. MFH2020 = BARE STEEL OPTION
- 2. MFH2021 = BLACK POWDER COAT

UNLESS OTHERWISE SPECIFIED:	NAME	DATE	LOD LLC. 
DIMENSIONS ARE IN INCHES TOLERANCES: ±0.010 ANGULAR: MACH ±1° TWO PLACE DECIMAL ±0.015 THREE PLACE DECIMAL ±0.005	MCH	6/15/2021	
PROPRIETARY AND CONFIDENTIAL THE INFORMATION CONTAINED IN THIS DRAWING IS THE SOLE PROPERTY OF LOD LLC. ANY REPRODUCTION IN PART OR AS A WHOLE WITHOUT THE WRITTEN PERMISSION OF LOD LLC IS PROHIBITED.	DRAWN		DESCRIPTION: DESTROYER FRONT BUMPER CENTER HITCH
	CHECKED		
	ENG APPR.		DWG. NO. MFH2020 MFH2021
	MFG APPR.		
	MATERIAL:		REV
	N/A		A
	FINISH:		
	SEE NOTES		
	ECO:		
	-		
			SCALE: 1:3
			SHEET SIZE: B
			SHEET 1 OF 1



**TRUCK
DESTROYER SERIES**
FRONT CENTER HITCH
SHIPPING SHEET

Packaged by:

On:



INSTRUCTION
SHEET

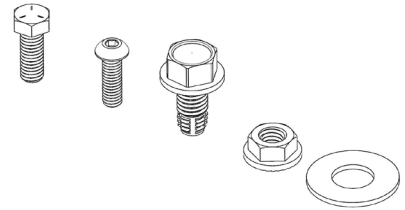

BOLT KIT
(may vary)

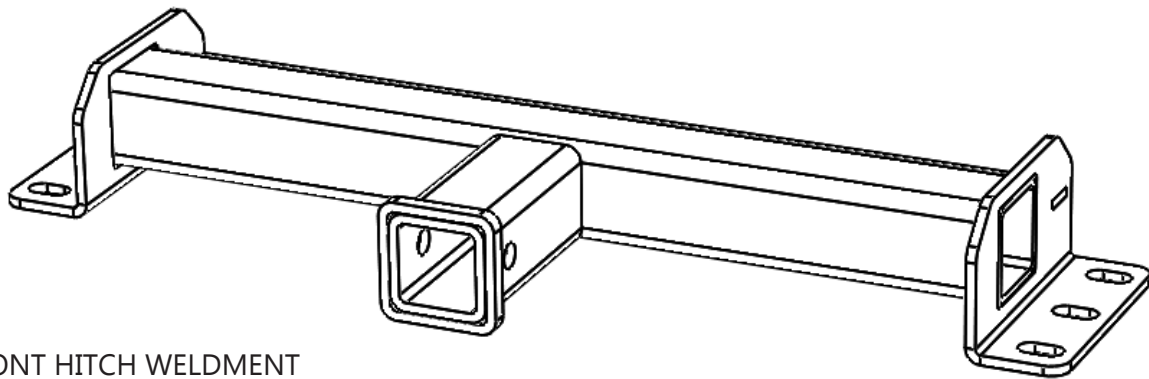

FRONT HITCH WELDMENT
4MFH2020-01

(x1)



FRONT SCREEN HITCH
2MFH2020-01

(x1)

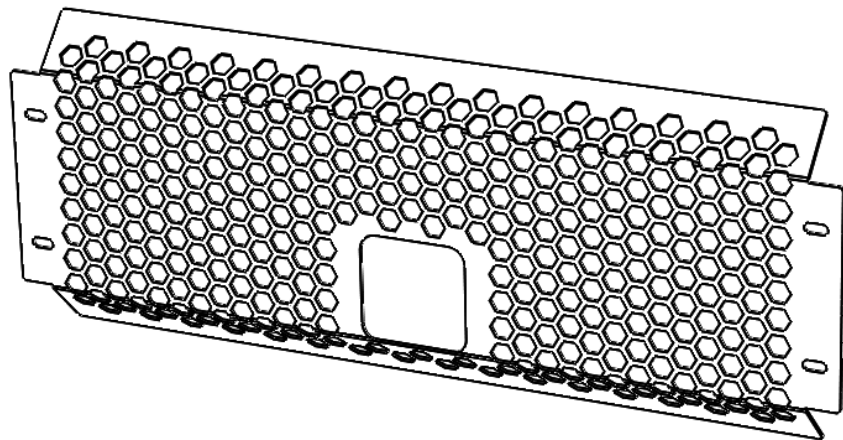



TRUCK
DESTROYER SERIES
FRONT CENTER HITCH

Bolt Kit
Packaged by:

On:

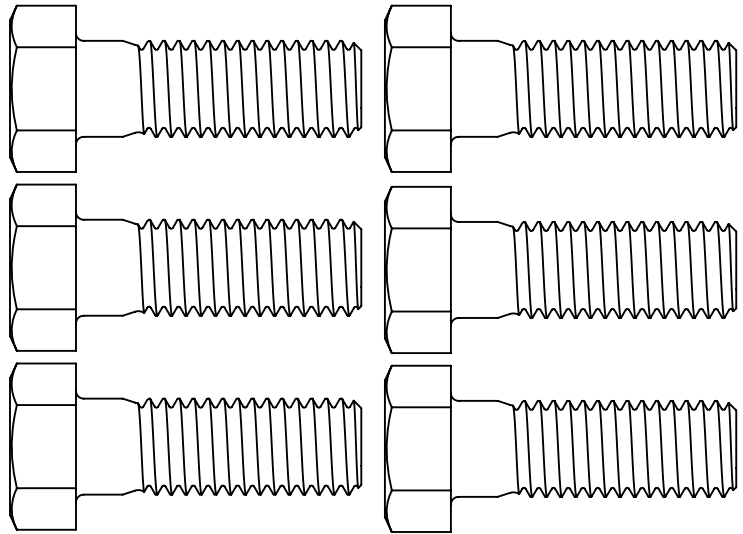

HEX BOLT 1/2-13 X 1.50"
(0137545)

(x6)

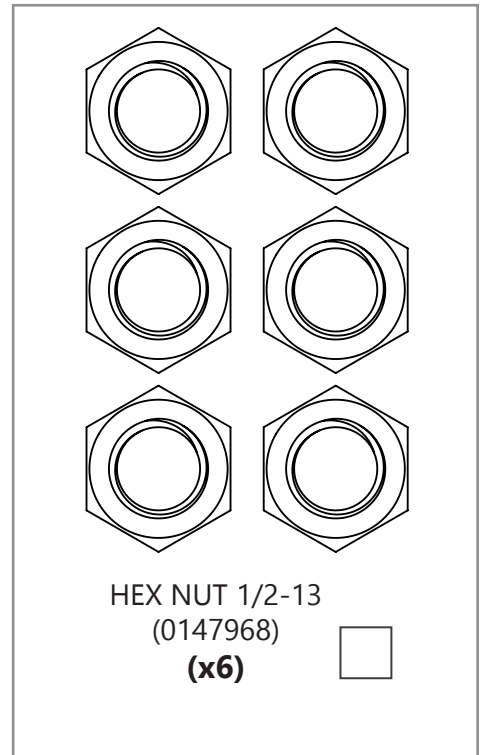
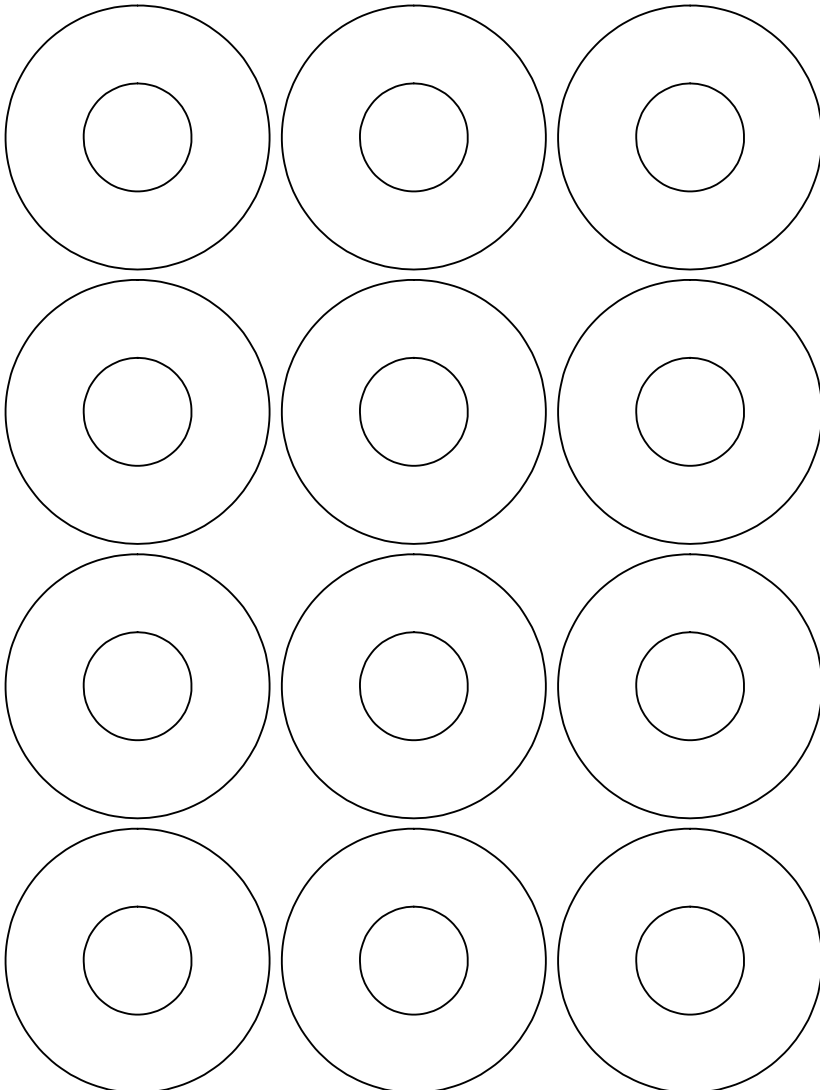

HEX NUT 1/2-13
(0147968)

(x6)



FLAT WASHER
Ø1/2" X 1.375"
(0159681)

(x12)

