

# PART APPROVAL



# Parts Approval

Nr. / No. 1137/18  
vom / of 03.07.2018



**on the compliance of a vehicle when vehicle parts are properly installed  
and fitted to the car in accordance with § 19 Par. 3 No. 4 StVZO**

Modification

fbaus / Continuously adjustable suspension system for  
lowering the car body

: ... 25 089

Part type(s)

Manufacturer : KW automotive GmbH  
Aspachweg 14  
D-74427 Fichtenberg

Vehicle Manufacturer / Type(s) : Mercedes-Benz / 204  
Mercedes-AMG / 204 AMG

max. axle load : VA (front axle) 1155 kg  
HA (rear axle) 1180 kg

## **0. Instructions for vehicle owner**

### **Performance and confirmation without delay of modification acceptance**

*With the modification the type approval of the vehicle will expire if the modification acceptance provided for in StVZO § 19 Par. 3 is not performed and confirmed without delay or if conditions laid down are not complied with.*

*After performance of the technical modification, the vehicle must be pre-sented without delay together with the present TÜV parts approval to an officially recognised inspector at a Technical Inspection Centre or to an inspection engineer from an officially recognised inspection organisation to perform and confirm the specified modification acceptance.*

# Parts Approval

Nr. / No. 1137/18  
vom / of 03.07.2018



## Compliance with Conditions and Notes

The Conditions and Notes given in III. and IV. must be complied with.

## Availability of documents

After the acceptance procedure the certificate with confirmation of the modification acceptance must be carried in the car and presented to authorised persons on demand; this will not apply once the vehicle documents have been amended.

## Amendment of vehicle documents

The vehicle owner must apply, in accordance with the provision in the confirmation of modification acceptance, for the competent licensing authority to amend the vehicle documents (vehicle registr. documents).

Further conditions can be found in the confirmation of modification acceptance.

## I. Field of application

Vehicle manufacturer	Trade name	Vehicle type	Variants and versions	Type approval
Mercedes-Benz	AMG C63, AMG C63 S	204	nur Coupé und Cabrio mit Heckantrieb only coupe and convertible with rear wheel drive	e1*?/?*0431*.. ab Nachtrag 38 valid from amendment 38
Mercedes-AMG	AMG C63, AMG C63 S	204 AMG		e1*?/?*0464*.. ab Nachtrag 18 valid from amendment 18

The part of the EC type approval number showing \*?/?\* merely document the current status of the framework directive and are of no significance for this parts approval as long as the parts of the vehicle which are relevant to the lowering of the bodywork have not changed.

# Parts Approval

Nr. / No. 1137/18  
vom / of 03.07.2018



## II. Description of the modification

Front axle

	<b>Pre spring</b>	<b>Main spring</b>
Marking	10-60-80	100-70-225*
Corrosion protection	imprinted EPS – powder coating	imprinted EPS – powder coating
Wire size	4,4 x 7,4 mm	13,9 mm
Outer diameter	oben / top - mm	- mm
	mitte / middle 76 mm	99 mm
	unten / bottom - mm	- mm
Untensioned height	80 mm	225 mm
Number of coils	5,1	7
Coil shape	Cylinder, head(s) baselined	Cylinder, head(s) baselined
Spring characteristic	linear	linear

	<b>Spring cup seat (top)</b>	<b>Spring cup seat (bottom)</b>
Max. diameter	100 mm	82 mm
Diameter rest	71 mm	61 mm
Height	23 mm	24 mm
Spring height adjustment	Infinitely adjustable cup seat (Strut)	

	<b>Strut</b>
Damping adjustment (rebound/ compression)	without / manual / elektronik (DDC)
Marking	250 1027

	<b>Rubber or polyurethane foam element</b>
Bump stop	
High/Diameter	35+15/50 mm
Bump travel	extended by 5 mm

# Parts Approval

Nr. / No. 1137/18  
vom / of 03.07.2018



Rear axle

	<b>Pre spring</b>	<b>Main spring</b>
Marking	10-70-70	160-70-225*
Corrosion protection	<i>imprinted EPS – powder coating</i>	<i>/imprinted EPS – powder coating</i>
Wire size	3 x 10,2 mm	15,9 mm
Outer diameter	- mm	- mm
oben / top	92 mm	103 mm
mitte / middle	- mm	- mm
unten / bottom	70 mm	225 mm
Untensioned height	3,7	6,9
Number of coils	<i>Cylinder, head(s) baselined</i>	<i>Cylinder, head(s) baselined</i>
Coil shape	linear	linear
Spring characteristic		

	<b>Spring cup seat (top)</b>	<b>intermediate ring (middle)</b>
Max. diameter	100 mm	89 mm
Diameter rest	71 mm	71 mm
Height	20 mm	17 mm

	<b>Spring cup seat (bottom)</b>	
Max. diameter	98 mm	
Diameter rest	71 mm	
Height	51 mm	
Spring height adjustment	<i>Infinitely adjustable cup seat (Bushing)</i>	

	<b>Shock absorber</b>
Damping adjustment (rebound/ compression)	<i>without / manual / elektronik (DDC)</i>
Marking	250 1132

	<b>Gummi- oder Hartschaumelement Rubber or polyurethane foam element</b>
Bump stop	50/50 mm
High/Diameter	extended by 20 mm
Bump travel	

### III.

#### **Notes on possible combination with other modifications**

##### **III. 1 Wheel/tyre combinations**

*There are no technical objections against the use of all O. E. wheel/tyre combinations.*

*If other wheel-/ tyre combinations are used, the examination in accordance with § 21 German Road Traffic Licensing Code - StVZO must be carried out by an officially recognised expert.*

##### **III. 2 Aerodynamic devices, special exhaust systems etc.**

*The dynamic ground clearance is decreased by the provision of special springs/dampers which increase the bump travel of the front and rear axle. In the case of the test vehicle, the min. ground clearance of 80 mm is complied with (below front axle). Care must be taken when driving over humps, barriers and heightened paving or road surfaces.*

*If special spoilers, aprons and exhaust systems are mounted, attention must be paid to the decreased overhang angle (driving up ramps etc.).*

### IV. **Conditions and Notes**

#### **Conditions and notes for the installation shop and modification acceptance**

*Mounting of the vehicle bodywork components will be performed in accordance with the vehicle manufacturer's specifications which must be included in the delivery and should be carried out by a specialist shop.*

*Please check regularly, that the main and helper spring at rear axle are in right position and that there is enough pre-tension, when the rear axle is fully extended. In the case of sufficient pretension, the length of the helper spring must be by approx. 60 mm.*

# Parts Approval

Nr. / No. 1137/18  
vom / of 03.07.2018



*The headlight adjustment has to be checked.*

*After modification an axle alignment must be carried out on the vehicle.*

*The bump stops (rubber or polyurethane foam element) must correspond to the descriptions of this re-port. Additional travel limiters are not allowed.*

*When installing the coilover kit in vehicles with electronic damping control - depending on the technical specification of the vehicle - the electronic dampers need to either*

- be deactivated by the use of "KW simulating plugs" respectively by changing the software or*
  - to be connected with the plugs of the serial dampers via the "KW connectors" of the KW dampers.*
- The simulating plugs which optionally can be used, consist of a plug-in sleeve with an integrated electric coil. These plugs are to be connected with the vehicle-mounted connectors instead of the serial dampers in order to simulate the situation that the serial ones would still be installed, furthermore in order to rule out an error signal.*

*The optional installed Dynamic Damping Control (DDC) was tested with regard to the electromagnetic compatibility (EMC), the system stability and the driving dynamics.  
The damping characteristic is adjustable in three steps.*

*Use of the lowering kit on vehicles with levelling system is not permitted.*

*The vehicle height must be laid down in the vehicle documents in box 20. The precise measure of the lowering will depend on the specific vehicle tolerances, tyre size and vehicle version.*

# Parts Approval

Nr. / No. 1137/18  
vom / of 03.07.2018



dimensions (mm)

vehicle application	adjustment range (min. – max.)		Clearance		Size of lowering	
	VA/front <sup>1)</sup>	HA/rear <sup>2)</sup>	VA/front <sup>3)</sup>	HA/rear <sup>3)</sup>	VA/front	HA/rear
coupe	330 – 350	15 – 35	330	330	5 – 35	15 – 45
convertible	335 – 355	21 – 41	330	330	0 – 30	5 – 35

1) Distance from the spring rest to the nearest fastening screw

2) Distance from contact point of the car to the adjustable spring perch

3) Minimum distance from wheel centre to wheelhouse rim

Amendment of vehicle documents:

Amendment of the vehicle documents is only necessary the next time the approval authority has to do with the vehicle documents. The following example is suggested for the entry:

## V. Basis of tests and test results

The test vehicle and the modification parts were subjected to a test in accordance with the test conditions regarding raising / lowering of vehicles contained in VdTÜV Merkblatt 751 (08.2008).  
The test conditions were fulfilled.

## VI. Annex: none



# Parts Approval

Nr. / No. 1137/18  
vom / of 03.07.2018



## VII. Concluding certification

*It is hereby certified that the vehicles described under field of application satisfy the regulations of StVZO in the current version after modification and performed and confirmed modification acceptance, provided the conditions/notes given in the present TÜV approval are observed.*

*The manufacturer KW automotive GmbH maintains a quality management system according to ISO 9001: 2008 (Certificate Registration No.: 12 102 22913 TMS).*

*The parts approval may only be reproduced and passed on by the manufacturer in its unabbreviated form.*

*The TÜV parts approval shall cease to be valid if technical modifications are made to the vehicle part or if modifications made to the vehicles described affect use of the part and in the case of any changes to the statutory specifications.*

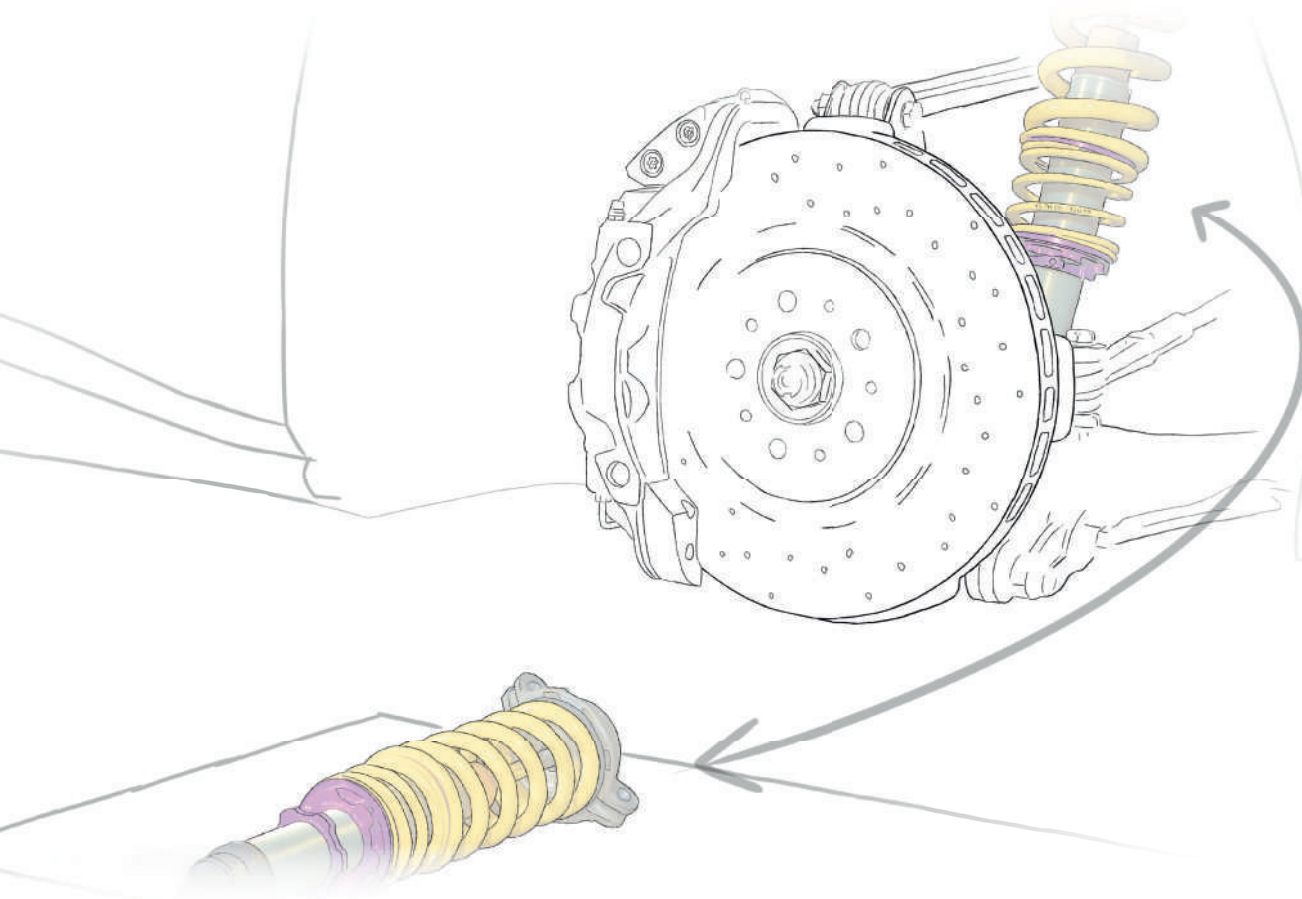

# INSTALLATION INSTRUCTIONS





## INSTALLATION INSTRUCTIONS

**Before you begin installation,  
please read the following carefully:**

- **Ensure that certificate matches the vehicle specifications (front vehicle identification number (VIN)) etc...**
- **The suspension components must match the suspensions application specifications (springs and shock/struts identification numbers).**
- **The instructions have to be strictly observed.**

KW Coilovers for automobile suspensions are designed for easy installation. If not otherwise stipulated in these instructions, all suspension components are installed and removed in accordance with the manufacturer's specifications for installing and removing standard springs and damper components. At the time of printing all instructions and specifications are correct.

Technical data	Coilover part number 3A7 25 089			
Vehicle model	Mercedes AMG C63, AMG C63S Coupé type 204, 204 AMG		max. permissible front axle load: 1100 kg	
	front axle		rear axle	
Spring signature	10-60-80 / 100-70-225*		10-70-70 / 160-70-225*	
Coilover strut / Shock absorber signature	250 1027		250 1132	
Approximate distance measurement A Front axle: Fastening screw - spring contact area Rear axle: Seating height adjustment - spring contact area or fastening screw - spring contact area	min:	max:	min:	max:
	330 mm / 13,0 inch	350 mm / 13,8 inch	15 mm / 0,6 inch	35 mm / 1,4 inch
Approximate measurement* B in mm / inch: wheel hub center to fender edge	min:		min:	
	330 mm / 13,0 inch		330 mm / 13,0 inch	

Calculating the adjustment range (distance measurement A) : (Photos are examples only)

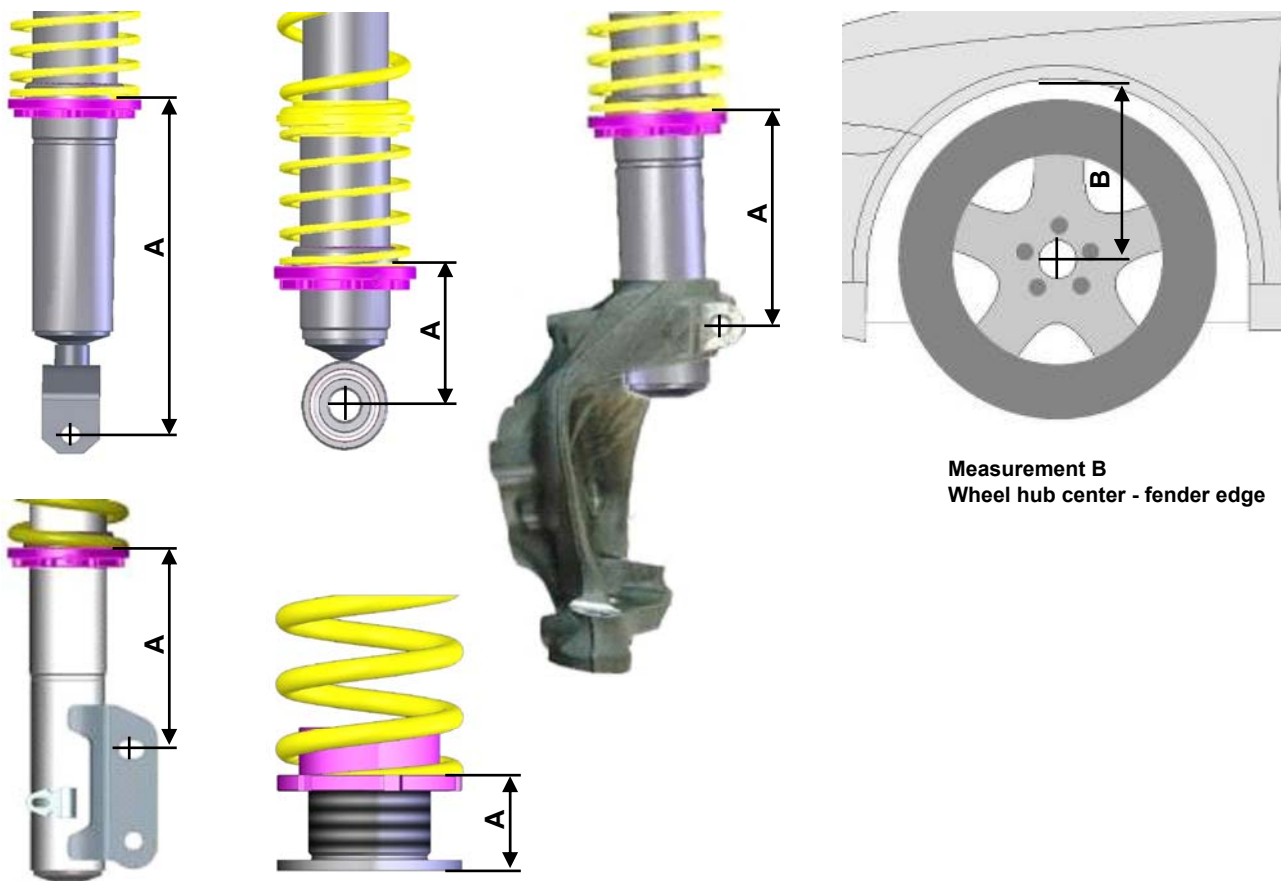

Measurement B  
Wheel hub center - fender edge

Please enter the adjusted height of the modified car into the list:

Coilover part no	Vehicle type	Measurement A		Wheel hub center - fender edge Measurement B	
		Front	Rear	Front	Rear

\* **IMPORTANT:** The allowable measurement between wheel hub center and fender edge as indicated above, may not exceed these measurements when using standard fenders.

**Danger:**

Always follow the latest accident prevention regulations (not applicable for North America) for each step to prevent any serious bodily harm or injury.

1. We recommend the use of a vehicle hoist or lift when installing the suspension. If a lift is not available and jacking equipment is used, make sure that the vehicle is secured with commercial wheel blocks and jack stand to ensure safety.
2. The suspension components may only be installed by trained technical personnel using the proper tools.
3. The General Installation instructions, as well as the Technical Inspectorate documents must be read BEFORE attempting installation.
4. Never use impact wrenches or guns to install or remove shock absorber piston hardware.
5. Never disassemble or cut open shock absorbers and/or shock absorber inserts. They contain oil under pressure. Danger of explosion.
6. Before driving on public highways, carry out the work steps on page 7, items 11 through 14 after installation.
7. The suspension regulation (when available) needs to be disabled through an authorized dealer.
8. Please take care in any case that fittings (for example fittings of shock absorber housings or fittings of the lower control arm in the housing of the wheel bearing) are free of dust and oil. (see manufacturer guideline)

**General Instructions for Use:**

1. When adjusting the vehicle height, make sure that the threads are clean and free of debris. After initial cleaning, move the perch by 10 mm (0.4 Inches) downwards, and then clean the area that you desire to adjust the perch (up or down).
2. During height adjustments on separate shock and spring systems, remove the perch from the vehicle to adjust the height.
3. After adjusting the vehicle height, repeat steps 11 through 14 from page 7.
4. In the area of the piston rod and the sealing package of the new and used damper there might be oil and grease collected. This could either be caused by using a special black grease during assembling the washer or due to accumulation of streak oil. Further more oil is used during assembling the cartridge and rod guide. There is no reason of worrying about and damage, as in this area also dust and dirt used to be collected.

**Tightening torque for the piston rod nut:**

M8 = **25Nm (18 ft-lb)**, M10x1 = **20Nm (15 ft-lb)**, M10x1,25 = **20Nm (15 ft-lb)**, M12x1,25 = **35Nm (26 ft-lb)**,  
M12x1,5 = **40Nm (29 ft-lb)**, M14x1,5 = **50Nm (37 ft-lb)**, M16x1,5 = **50Nm (37 ft-lb)**

## General Mounting Specifications:

1. We recommend the use of a vehicle hoist or lift when installing the suspension.
2. **Caution:** If the vehicle is equipped with ride height sensors, they should be removed before removal of struts or dampers, otherwise damage may occur.
3. The struts should be removed as specified by manufacturer's instructions.
4. Manufacturer recommended tools for removal of the original struts, or a suitable spring compressor, must be used in order to remove most factory mounted suspension systems.
5. Mount the complete suspension system as described on the following pages.
6. Never use impact drivers to install nuts on the piston rods as permanent damage may occur. It is imperative that you do not damage the piston rod surface, through use of pliers etc, as the smallest damage will result in seal damage, and will not be covered under warranty.
7. Stay within the lowering range specified in the table on page 3.  
**Example:** With a specified range of 20 - 60 mm (0.8 - 2.3 Inches), 40 mm (1.5 Inches) is your height adjustment range.
8. Ensure that the set screw on each spring collar is tightened to prevent movement of the spring perch. On vehicles with separate shock/spring combinations, no set screw is necessary.  
**Caution:** Do not over tighten the set screw. Maximum torque is 1 - 2 Nm (0.74-1.47 ft-lb).
9. Install the suspension components in the vehicle as specified by the vehicle manufacturers in their document.
10. Except as noted, all torque values must comply with manufacturer recommended specifications.
11. After assembly and installation is complete, the vehicle should be rolled onto level ground. Once on level ground, measure the vehicle height and adjust to the customer's requirements, within the prescribed lowering range.  
**Caution:** Wheel hub center—wheel arch maximum measurement in the table of page 3 must not be exceeded! Also take into account minimum road clearances specified in the table on page 7 (only valid for Germany!).  
**Caution:** It is common for the vehicle suspensions to settle by an additional 5 - 10 mm (0.2 - 0.4 Inches)
12. Examine the clearance between the tires and the suspension over the full range of motion of the wheel. The minimum clearance between the suspension and the tire is 4 mm (0.16 Inches). If this clearance is less than 5 mm (0.2 Inches), wheel spacers may be necessary. With strut designs that are located close to the wheel, but that have no steering functions, use 100 mm (3.9 Inches) spacers on diagonally opposed wheel (e.g. front right, rear left). In this position, you must be able to achieve the minimum clearance required. You can also check the clearance between tire and body.  
**Caution:** With torsion beam trailing arm axles, this method is not sufficient. The wheel must be under full load as well as test driven to properly calculate the clearances of 5 mm (0.2 Inches) from any other components.
13. The geometry of the suspension needs to be adjusted according the regulations of the vehicle manufacturer. If a value cannot be reached due to the difference in the height, a optimal value next to the tolerance range of the vehicle manufacturer needs to be adjusted.
14. All components that are controlled by vehicle ride height (e.g. headlights, brake bias regulator etc.) must be adjusted as specified by the vehicle manufacturer instructions and procedures.
15. For vehicles with ESP, DSC or EPC your new suspension components may cause an engine fault code to appear. This is only temporary as the vehicle electronics adjust to the new components/height. On some models this will end after driving approximately 3-5 miles, or through turning the steering wheel from full left to full right. On other models, this must be reset through the factory diagnostic port by a qualified technician.
16. If Vehicles have Driver Assistant Systems and the ride high is lowered by an increase of the compression travel, it must be proofed that all relevant sensors (like Radar Sensor or Camera Systems) be adjusted according to the Manufacture Specifications

**Front axle:**

Put the standard supporting bearing unit without spring rubber as shown in the picture and fix it with the supplied nuts. Tightening torque for the piston rod is 20 Nm (15 ft-lb). Please install the strut unit to manufacturers recommended settings regarding tightening torque and fixing specifications.

Supplied coilover strut.

Remove plastic disc (if available)

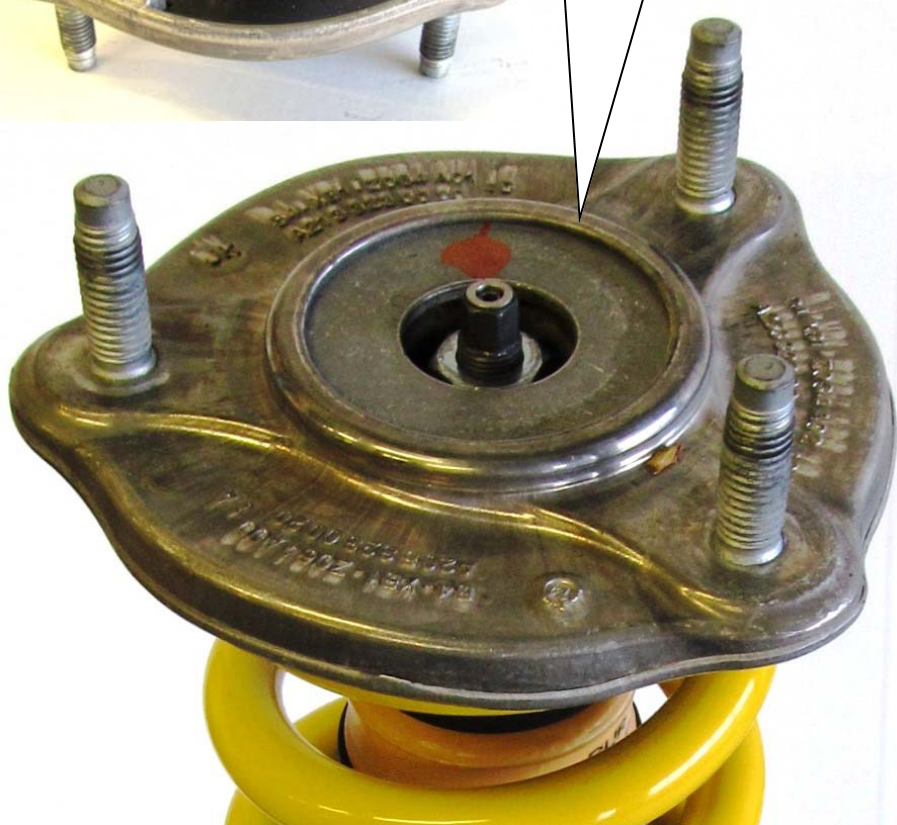
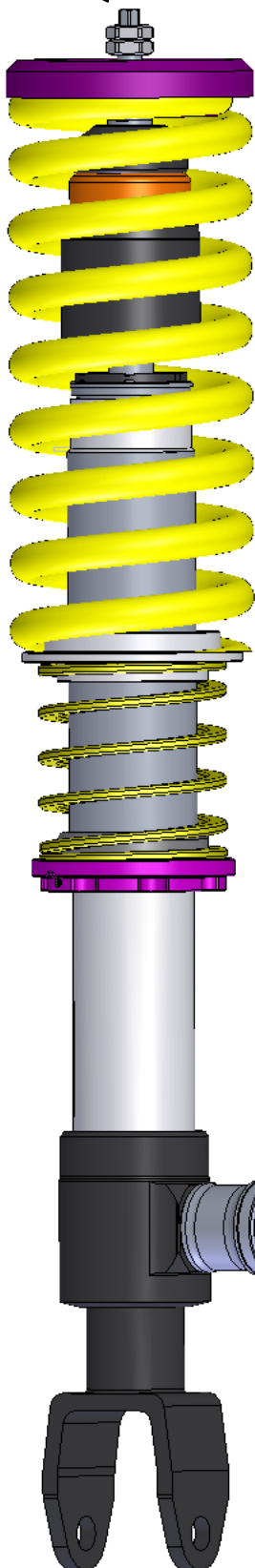
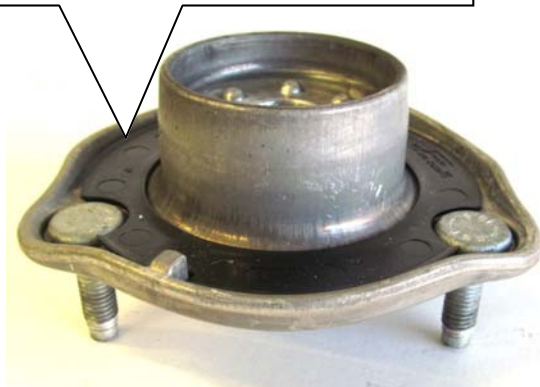

The bump adjustment must shows to the vehicle's front



**Front axle:**

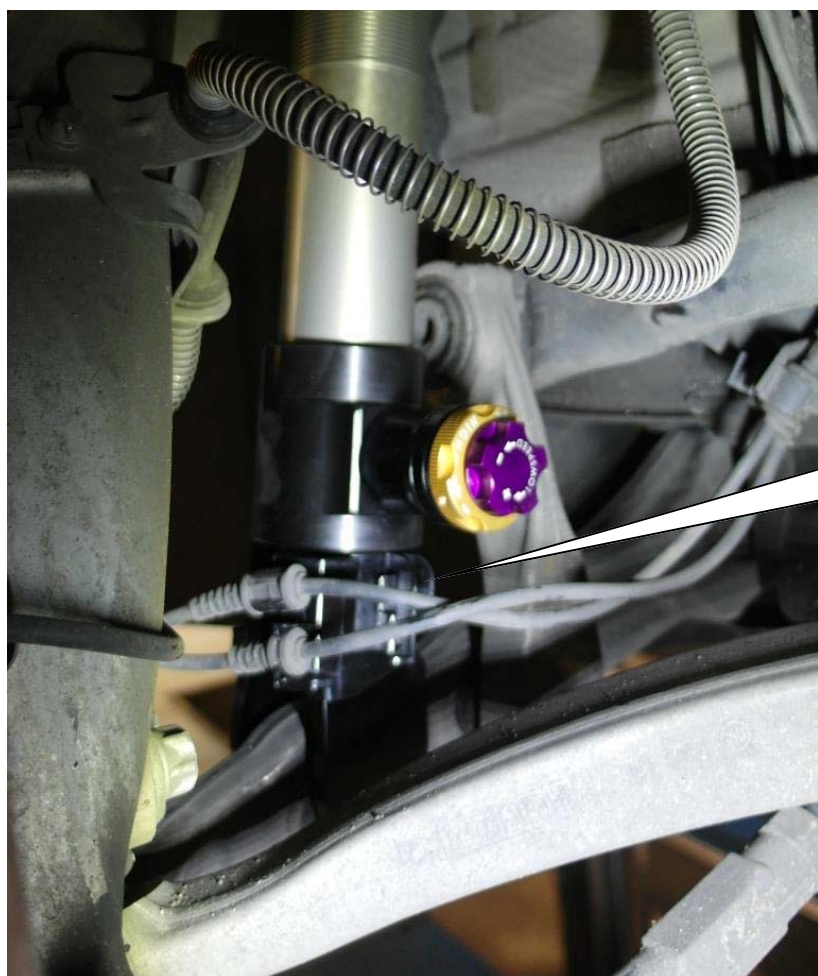
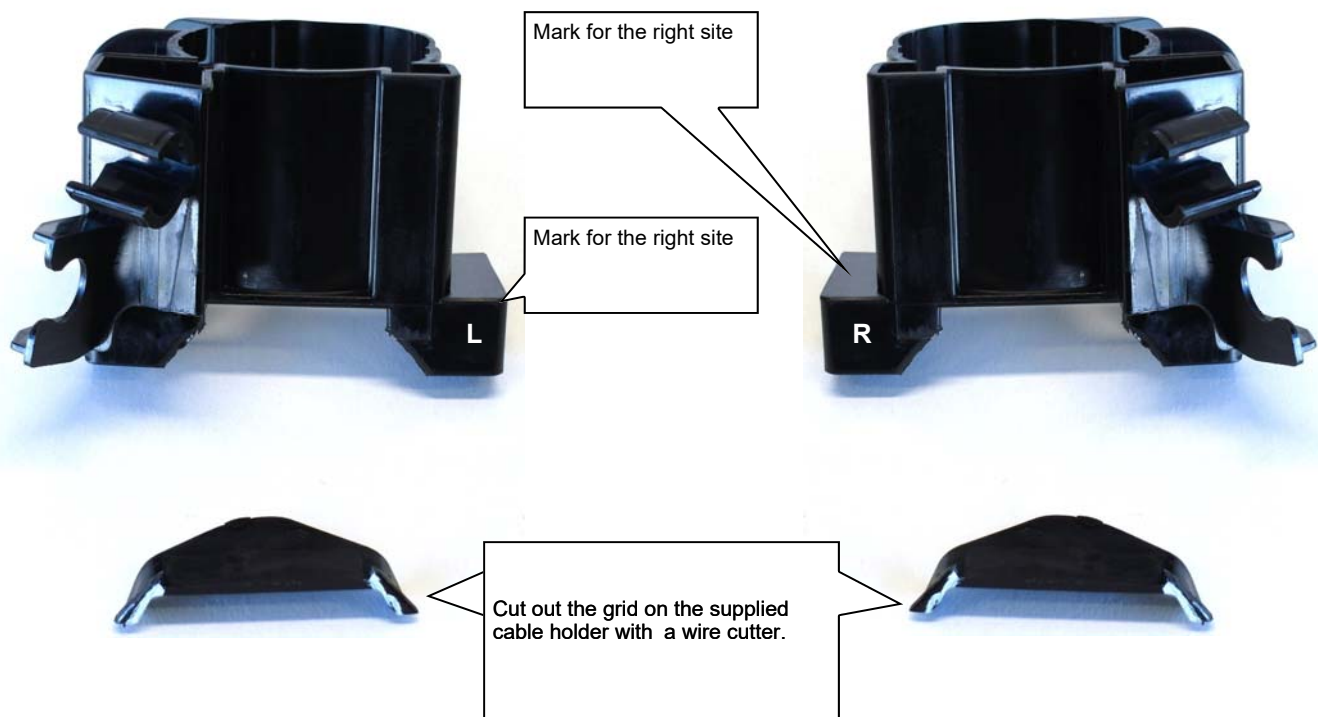

Install the supplied left and right cable bracket on the coilover.



**Rear axle:**

Supplied damper.

Install the factory top mount and secure it with the supplied nuts. Tightening torque for the piston rod nut is 20 Nm (15 ft-lb). The strut unit has to be installed according to manufacturers instructions settings regarding tightening torque and fixing specifications.



**The bump adjustment must show to the vehicle's rear.**

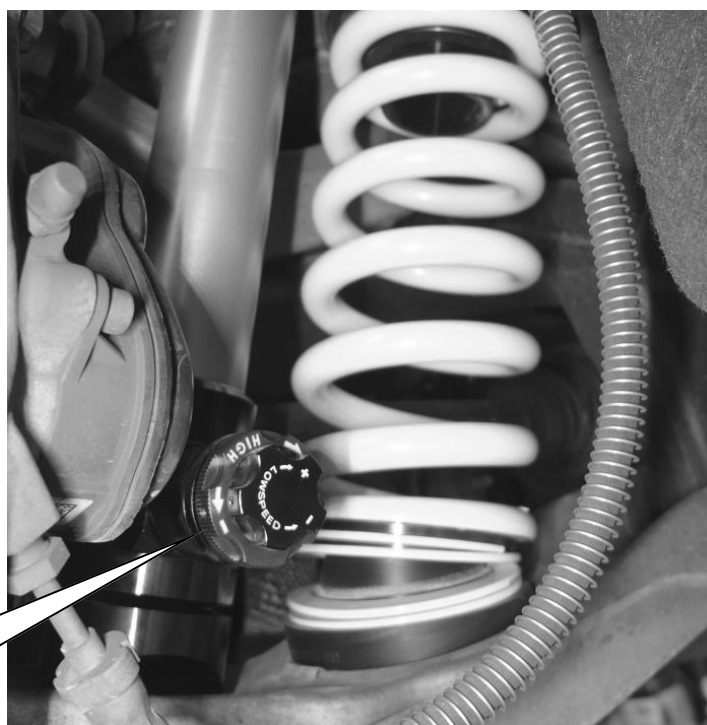

**Rear axle:**

Press the original plastic nut into the hole of the HAA adjustment.  
Subsequently place the original rubber on the HA adjustment.



**Rear axle:**

Mount the rear axle adjustment between spring and chassis, the original spring support is no longer used. You have to remove the rear axle adjustment to correct (screw up the threaded ring) the car height.  
 Attention: Before the installation of the height adjustment perch the touching surface area have to be cleaned.

Please make sure that the spring ends, the helper spring and main spring are not exactly on top of each other and twist them 180° to each other.

Mount the intermediate ring with the small collar towards to the helper spring.

Intermediate ring

Helper spring

Use the supplied spring adapter at the bottom end of the spring. Pay attention to a clearance-free mounting of the adapter in the axle.



The kit contains 2x 2 adapters each.

The adapters with part. no. 65210781 are for vehicles up to 08/2018

The adapters part. no. 65210886 are for the facelift model from year 09/2019.

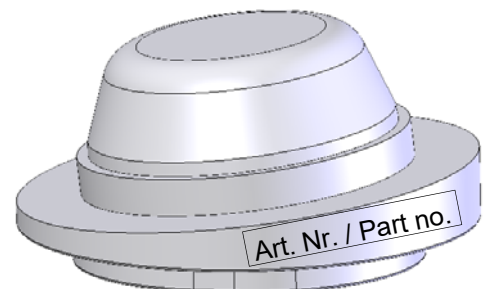

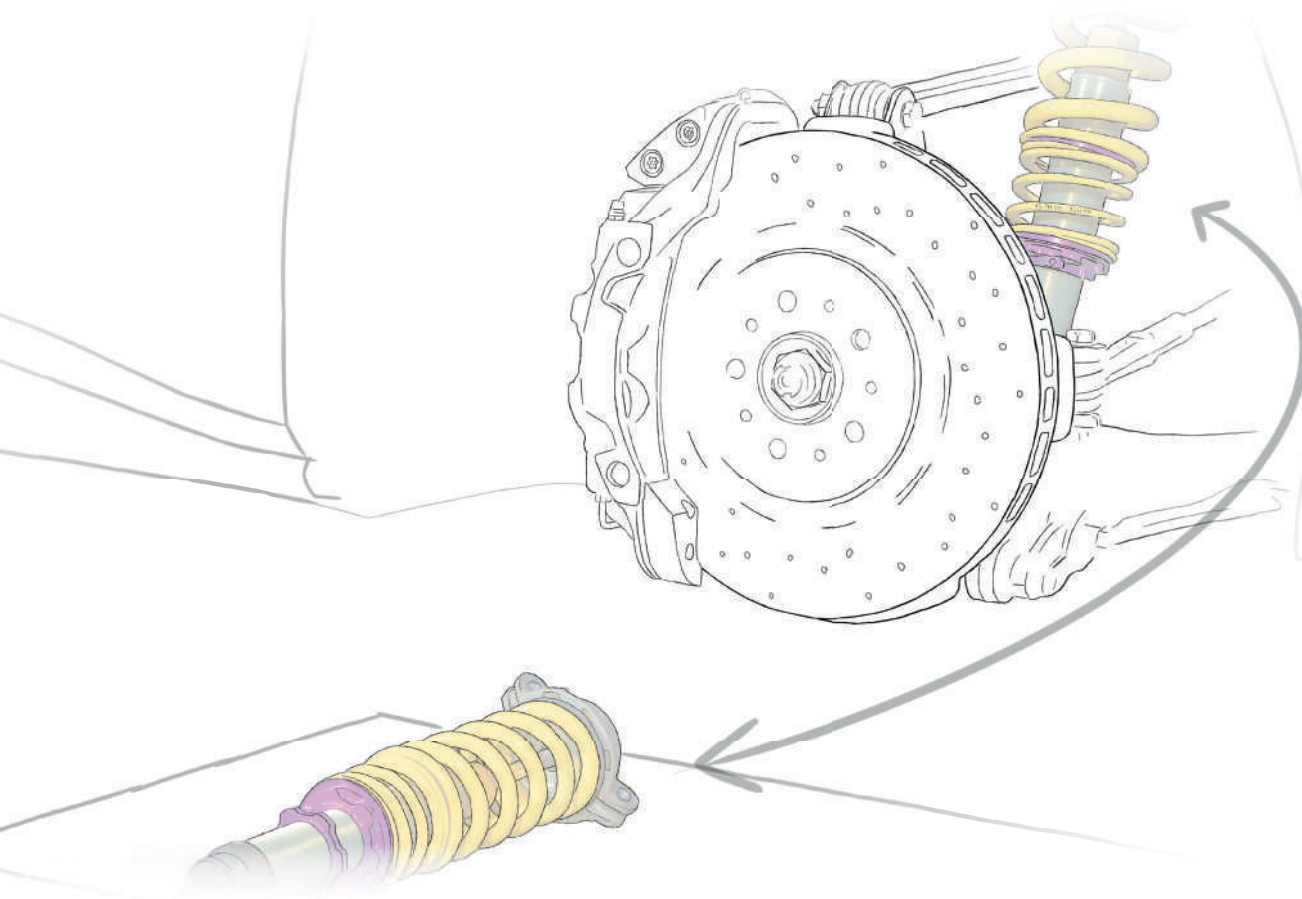

# INSTALLATION INSTRUCTIONS



<b>Installation Instructions</b>		<i>KW automotive</i>	
Instruction No.	685 10 478	Date	06.11.2017

# *KW automotive*

**685 10 478**  
**INSTALLATION INSTRUCTIONS**  
**Cancellation kit**



<b>Installation Instructions</b>			<b>KW automotive</b>	
Instruction No.	685 10 478		Date	06.11.2017

**Front axle:**

Fix the edge clips on the electronic component.

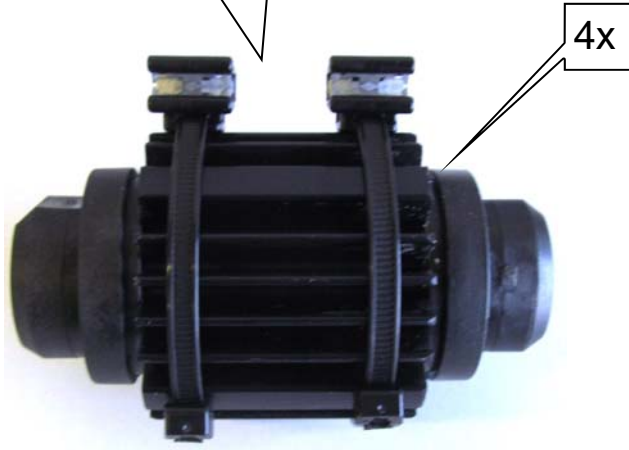

Fix the electronic component with the edge clips on the chassis edge as shown in the picture.



<b>Installation Instructions</b>		<b><i>KW automotive</i></b>	
Instruction No.	685 10 478	Date	06.11.2017

**Front axle:**

**VA links / FA left**

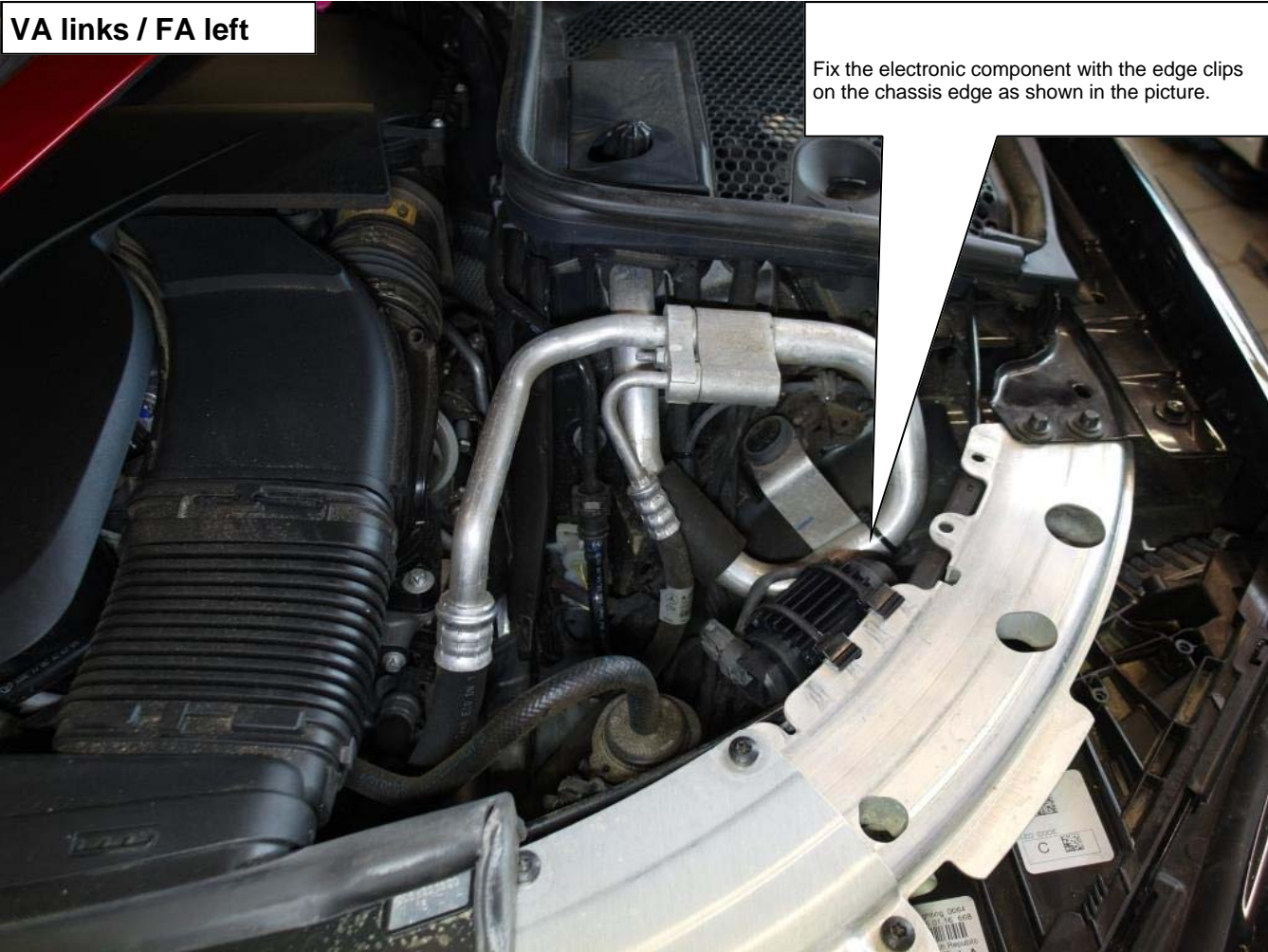



<b>Installation Instructions</b>			<b>KW automotive</b>	
Instruction No.	685 10 478		Date	06.11.2017

**Front axle:**

Run the standard damper control wire into the engine bay.



Run the standard damper control wire to the electronic component connector. Insert the standard connector into the electronic component connector until it locks. Pay attention the a correct cable running.



<b>Installation Instructions</b>			<b>KW automotive</b>	
Instruction No.	685 10 478		Date	06.11.2017

**Rear axle:**

Use the edge clips to attach the component on the axle. In addition, the component must be attached to the axle with a cable tie through the hole.



<b>Installation Instructions</b>		<b><i>KW automotive</i></b>	
Instruction No.	685 10 478	Date	06.11.2017

**Rear axle:**

Run the standard damper control wire to the electronic component connector. Insert the standard connector into the electronic component connector until it locks. Pay attention the a correct cable running.

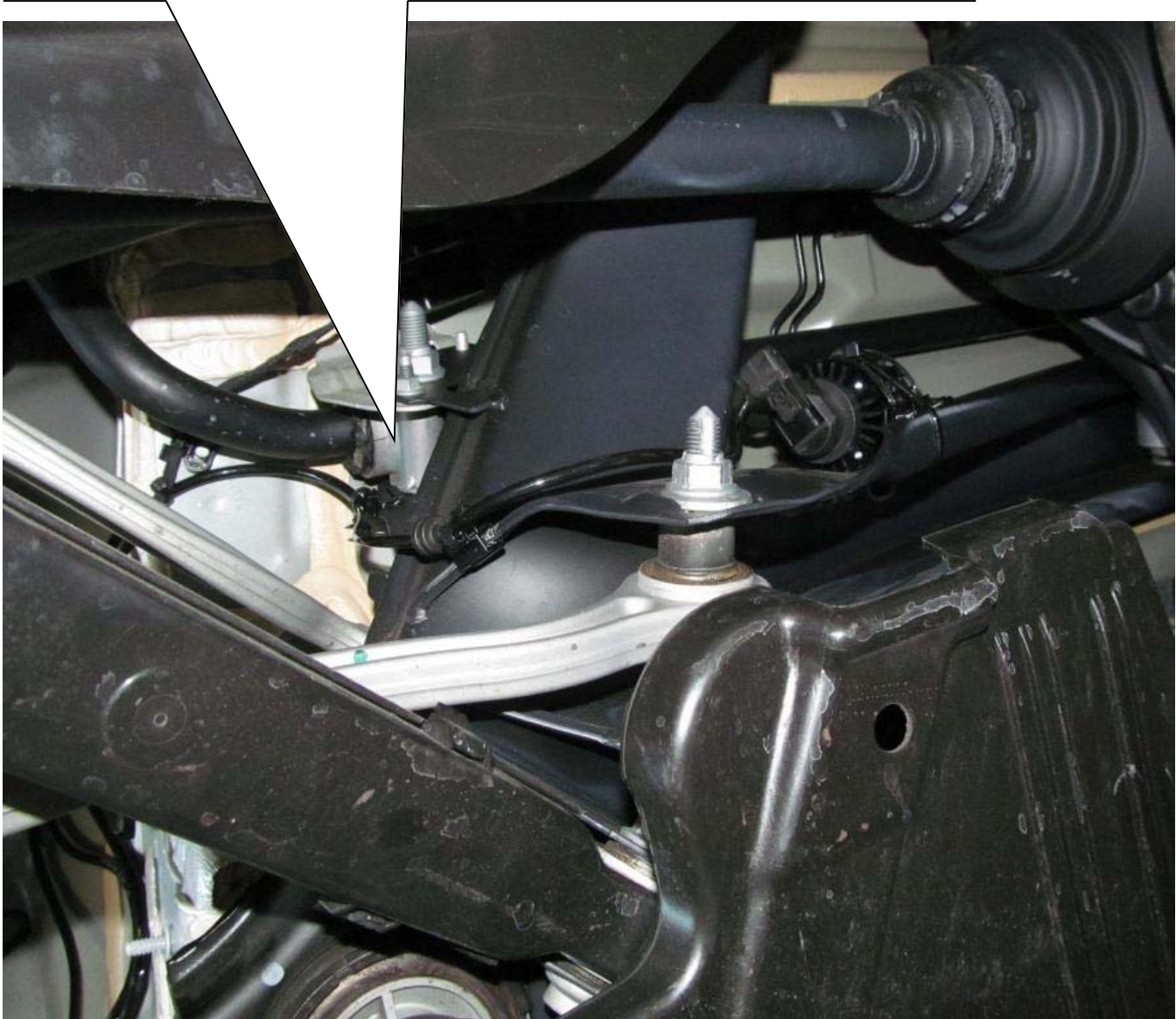



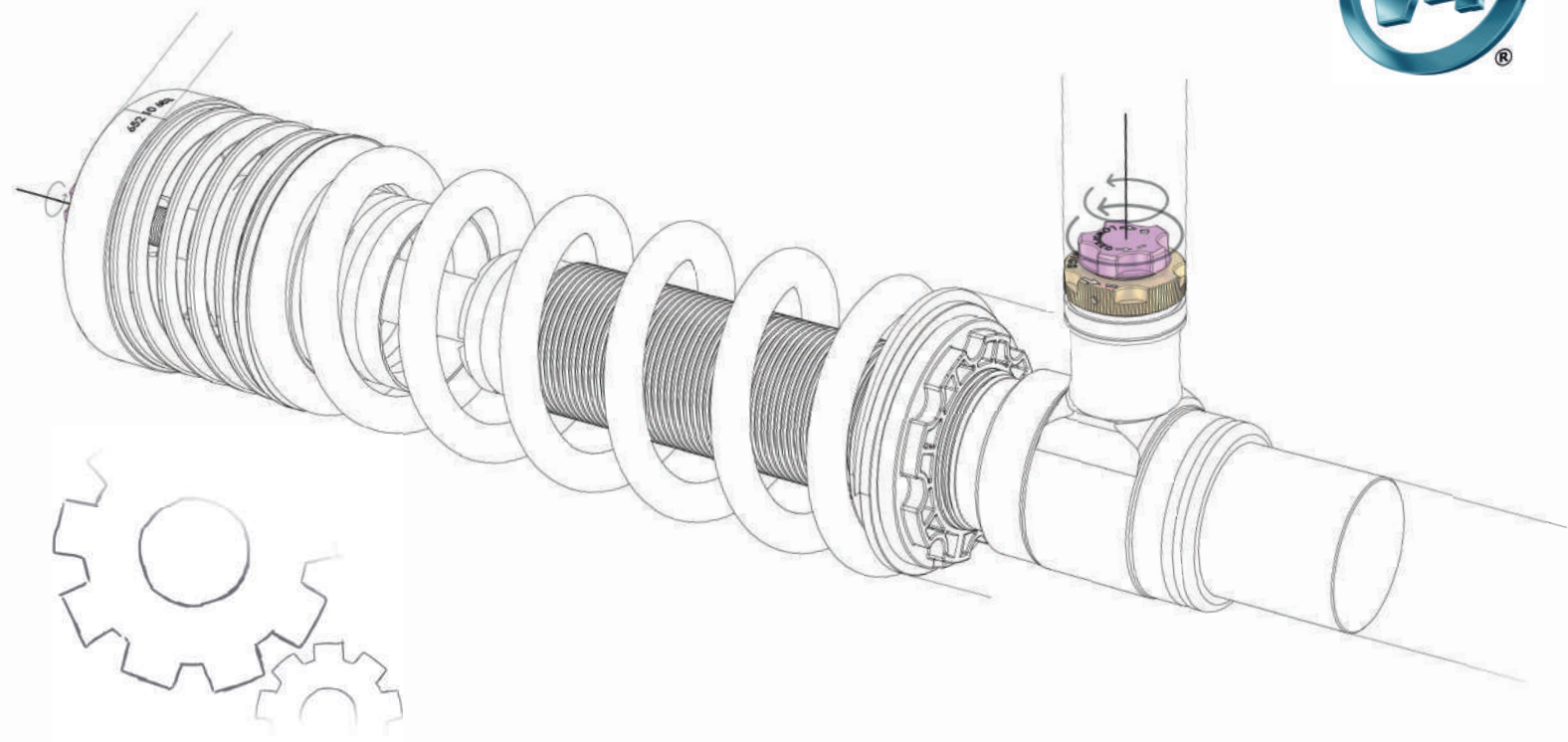

# SETUP MANUAL



# KW automotive

## Set Up Manual KW V4

No. 685 79 413

Our 3-way adjustable damper is separate and independently adjustable in compression and rebound.

### Rebound:

The rebound setting can be adjusted at the upper end of the piston rod via an adjustment wheel (version 1 and version 2)

In version 3 (upside-down version), the rebound adjuster is located at the lower end of the damper.

In all versions, the adjustment will be done based on closed status (max. hard). The closed status is reached when the adjustment wheel is completely turned to hard (+). ("0" on the adjustment wheel).

The effective adjustment range is 0 – 16 clicks open.

**Never apply force to the adjusting mechanism of the shock absorber. As soon as you reach the end of the adjustment range, you will recognize a certain resistance. Stop turning to avoid damage to the bottom valve.**

### Impact of the rebound

Little rebound power improves driving comfort during slow driving, but reduces stability and control accuracy at fast driving, especially with appropriate adjustment.

High rebound power improves the handling at the front axle, but possibly reduces the grip. The driving comfort will be extremely limited.

### Version 1 (Adjustment wheel for clipping on):

The adjustment wheel has to be put on the piston rod for adjusting the dampers. With clockwise rotation of the adjustment wheel the rebound damping will become harder. With anti-clockwise rotation the rebound damping will become softer. The click directions are labeled with "+" (harder) and "-" (softer) on the adjustment wheel.

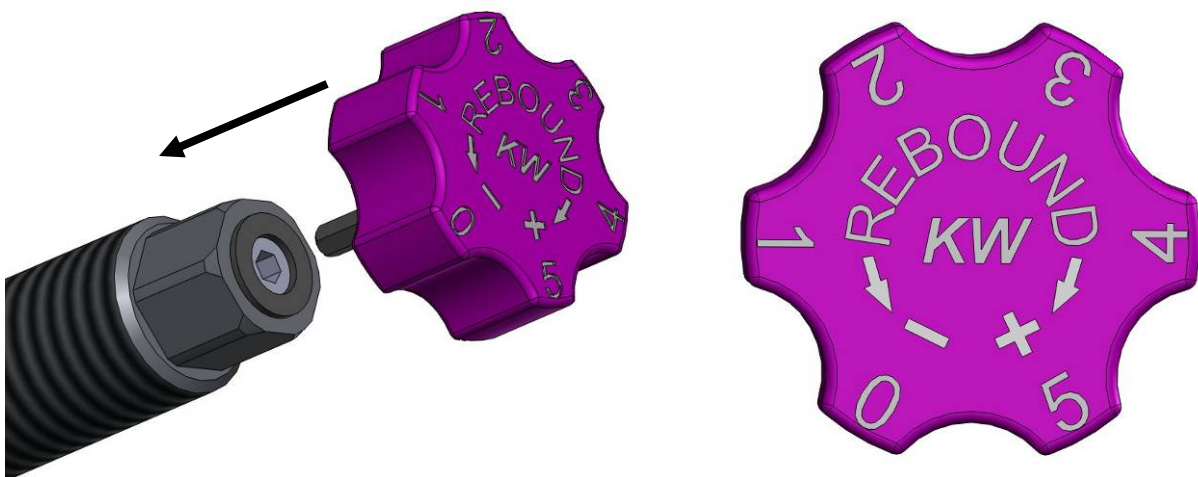

**Version 2 (Integrated adjustability):**

The numbers on the adjustment wheel show the current setup and facilitate the setup of the dampers. The click direction, in which the rebound becomes harder respectively softer, is marked on the adjustment header with a "+" (rebound becomes harder) and a "-" (rebound becomes softer). The numeration on the adjustment header is one sided. On the same side of the header, the valid adjustment stage can be found as a number on the adjustment wheel.

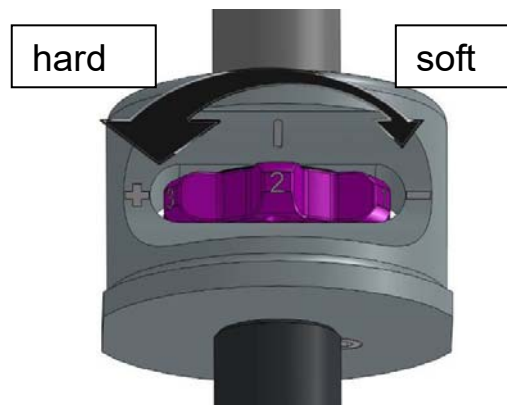
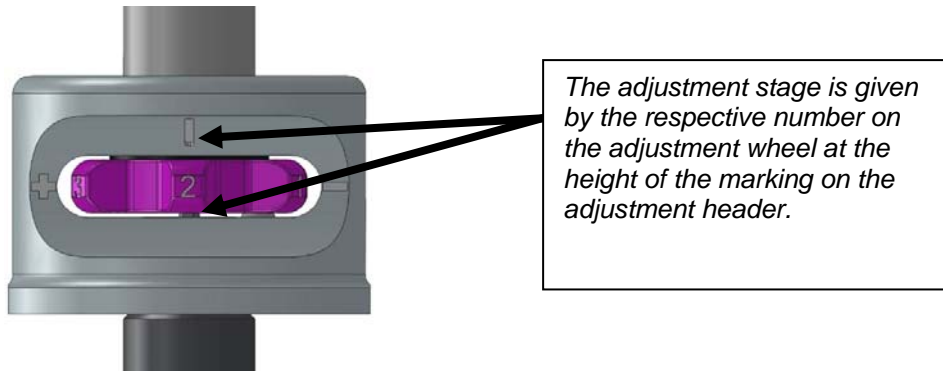
**Version 3 (Upside-down):**

The adjusting wheel is fixed to the bottom of the damper. With clockwise rotation of the adjustment wheel the rebound damping will become harder. With anti-clockwise rotation the rebound damping will become softer. The click directions are labeled with "+" (harder) and "-" (softer) on the adjustment wheel.

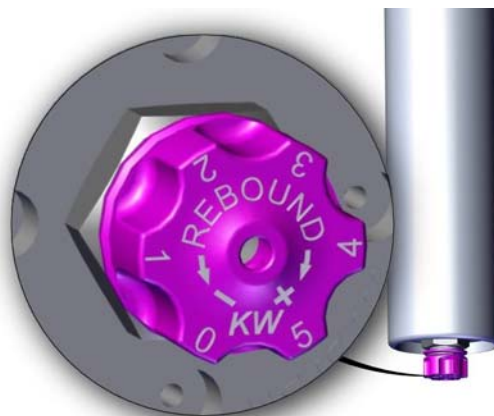
**Bump:**

The compression adjustment is done at the reservoir or the damper housing using the adjustment wheels. The adjustment will be done based on the closed valve (max. hard). The closed valve can be reached by turning the adjustment wheel completely too hard (+).

The maximum effective adjustment is

0 – 13 clicks in low speed and
0 – 14 clicks in highspeed.

**Influence of low speed compression adjustment**

Compression adjustment has significant influence on handling and driving behaviour.

In general there is to say:

A harder compression adjustment on the front axle makes the car more precise and more aggressive, whereas a softer adjustment favours a more forgiving steering behaviour.

Harder compression adjustment on the rear axle makes the car more stable on fast direction changes and helps if it has too much tendency to over steer. On the other hand, a softer compression damping makes the rear axle looser and might improve the handling if the car was too tight or had too much understeering before.

However, too much compression might cause uncomfortable and loud tyre role and/or costs grip.

Due to the digressive characteristic of the high speed section in our compression valve, hard adjustments do barely affect ride comfort on hard kerbs and bumps.

**Never apply force to the adjusting mechanism of the shock absorber. As soon as you reach the end of the adjustment range, you will recognize a certain resistance. Stop turning to avoid damage to the bottom valve.**

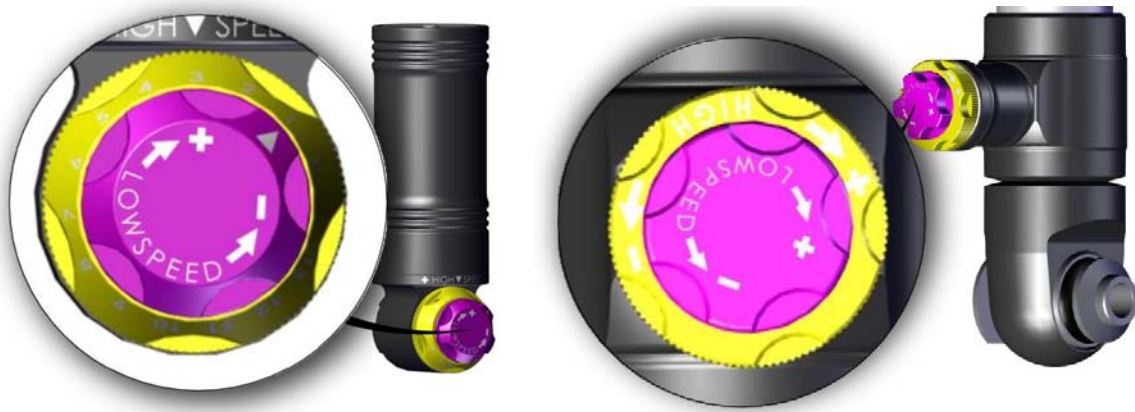
**Delivery status**

Our dampers will be delivered always in performance setup. This basic setup was specified for your car at the front and rear axle. In case of reset the dampers into the basic setup, the values of the following table are valid.

**Our recommendation street setup for your car to start with (delivery):**

<b>Front axle</b>	Rebound:	9	Clicks open
-------------------	----------	---	-------------

<b>Rear axle</b>	Rebound:	12	Clicks open
------------------	----------	----	-------------

<b>Front axle</b>	Bump low:	8	Clicks open	Bump high:	8	Clicks open
-------------------	-----------	---	-------------	------------	---	-------------

<b>Rear axle</b>	Bump low:	8	Clicks open	Bump high:	10	Clicks open
------------------	-----------	---	-------------	------------	----	-------------

**Our recommendation performance setup for your car with:**

<b>Front axle</b>	Rebound:	5	Clicks open
-------------------	----------	---	-------------

<b>Rear axle</b>	Rebound:	6	Clicks open
------------------	----------	---	-------------

<b>Front axle</b>	Bump low:	3	Clicks open	Bump high:	3	Clicks open
-------------------	-----------	---	-------------	------------	---	-------------

<b>Rear axle</b>	Bump low:	3	Clicks open	Bump high:	4	Clicks open
------------------	-----------	---	-------------	------------	---	-------------

**Example: Adjusting the basic setup rebound front axle:**

Basic setup rebound is 9 clicks opened in this example.

First, the rebound needs to be turned clockwise, direction "hard" (+). Afterwards, the adjustment wheel needs to be turned anti-clockwise, direction "soft" (-) until the adjustment wheel clicks 9 times.

The adjustment wheel now shows the number 3.

The single adjustment positions are described in the following chart.

