



# INSTALLATION INSTRUCTIONS



Technical data	<u>Coilover</u> part number 253 25 043			
Vehicle model	Mercedes AMG GT, GTS type 197		max. permissible front axle load: 905 kg	
	front axle		rear axle	
Spring signature	50-70-250*		10-60-80 / 60-70-250*	
Coilover strut / Shock absorber signature	-		-	
Approximate distance measurement A Front axle: Fastening screw - spring contact area Rear axle: Seating height adjustment - spring contact area or fastening screw - spring contact area	min:	max:	min:	max:
	160 mm / 6,3 inch	180 mm / 7,1 inch	235 mm / 9,3 inch	255 mm / 10,0 inch
Approximate measurement* B in mm / inch: wheel hub center to fender edge	min:		min:	
	355 mm / 14,0 inch		365 mm / 14,4 inch	

Calculating the adjustment range (distance measurement A) : (Photos are examples only)

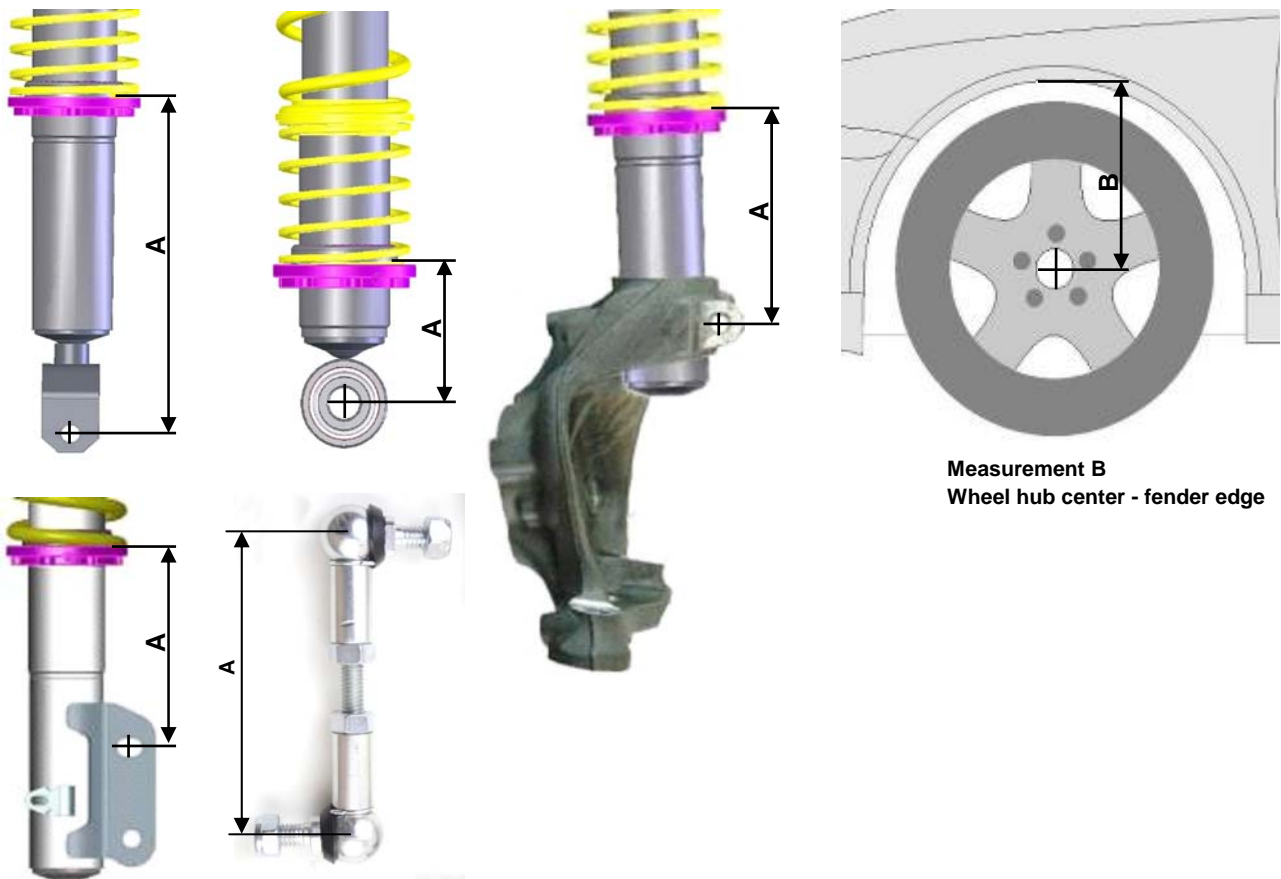

Please enter the adjusted height of the modified car into the list:

Coilover part no	Vehicle type	Measurement A		Wheel hub center - fender edge Measurement B	
		Front	Rear	Front	Rear

\* **IMPORTANT:** The allowable measurement between wheel hub center and fender edge as indicated above, may not exceed these measurements when using standard fenders.

Front axle:

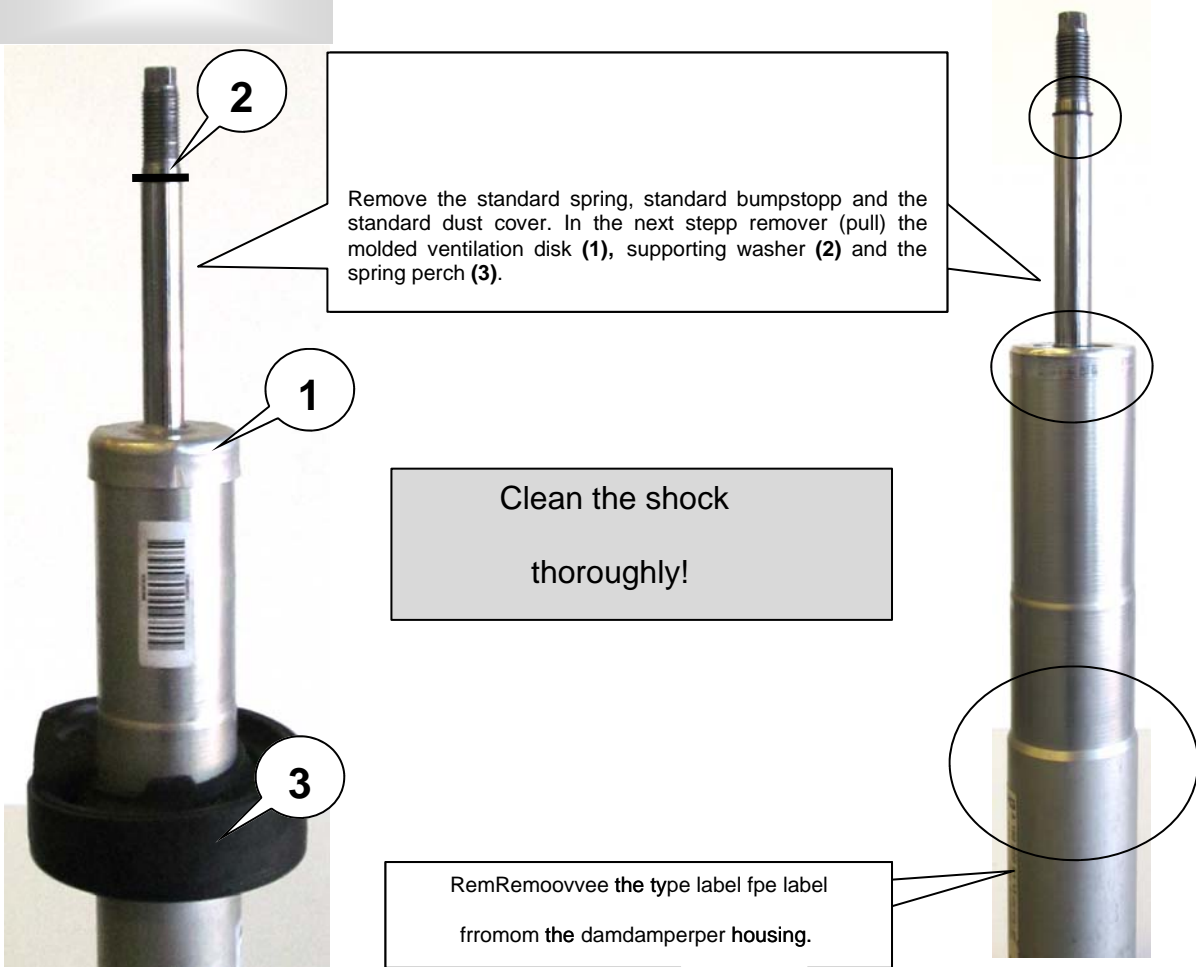

Clean the shock thoroughly!

Remove the type label from the damper housing.



## Front axle:

Grease the damper housing !  
Insert the supplied threaded sleeve (1) with spring perch (2). Tightening torque for the grub screw is max. 2Nm / 1,5 ft-lb.



**Front axle:**



Insert the supplied KW pumpstopp with dust cover (1) an spring (2). Additional put on the standard supporting washer (3).

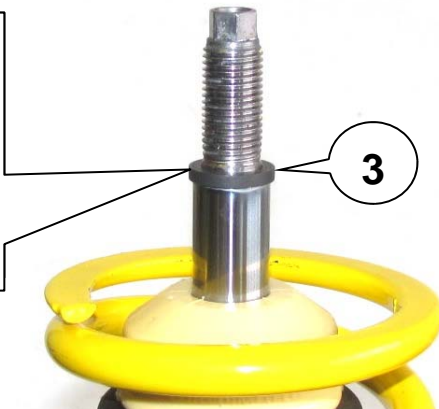

Place the supplied spring on the spring. Smooth side to the spring!

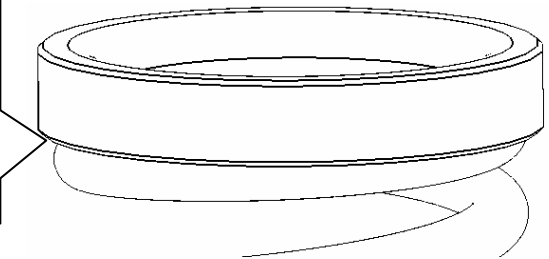

Install the factory top mount with the supplied spring perch and secure it with the supplied stop nut. The strut unit has to be installed according to manufacturers recommended settings regarding tightening torque and fixing specifications.



The image shows a strut with HLS cylinder. This is not included.!



**Rear axle:**

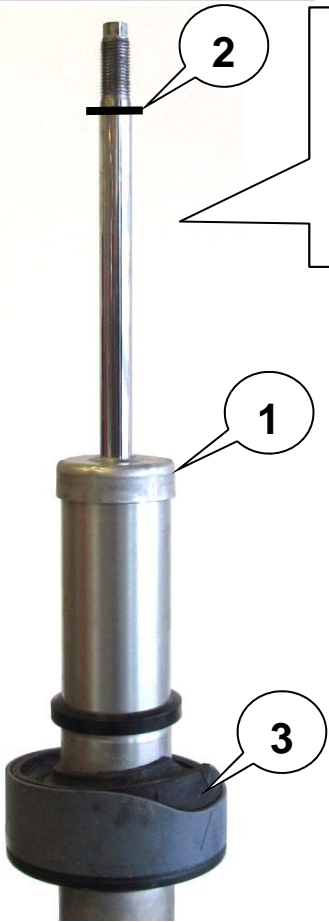

Remove the standard spring, standard bumpstopp and the standard dust cover. In the next stepp remover (pull) the molded ventilation disk (1), supporting washer (2) and the spring perch (3).



Clean the shock thoroughly!

Grease the damper housing !  
At first put on the supplied bush (1). Then insert the supplied threaded sleeve (2) with spring perch (3). Tightening torque for the grub screw is max. 2Nm / 1,5 ft-lb.



Install the standard ventilation disk on the damper again.



## Rear axle:



Insert the supplied helper spring (1), intermediate ring (3), pumpstopp with dust cover (3) and spring (4). Additionally put on the standard supporting washer (5).

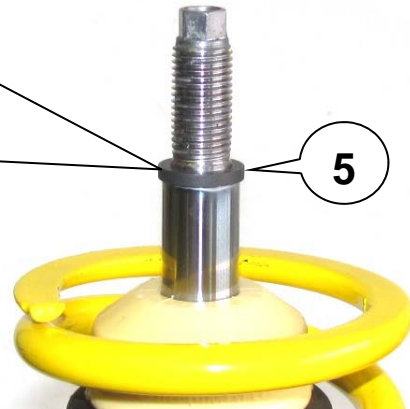

Place the supplied spring on the spring. Smooth side to the spring!

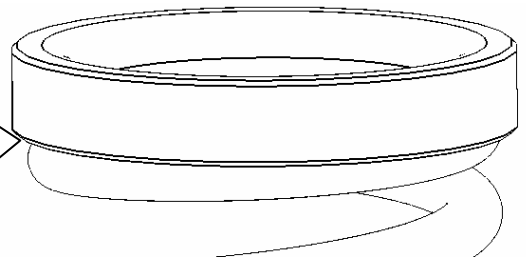

Install the factory top mount with the supplied spring perch and secure it with the supplied stop nut. The strut unit has to be installed according to manufacturers recommended settings regarding tightening torque and fixing specifications.

