

KUKKO // *Pull forward*



Product overview **BALL JOINTS EXTRACTOR**



BALL JOINTS EXTRACTOR

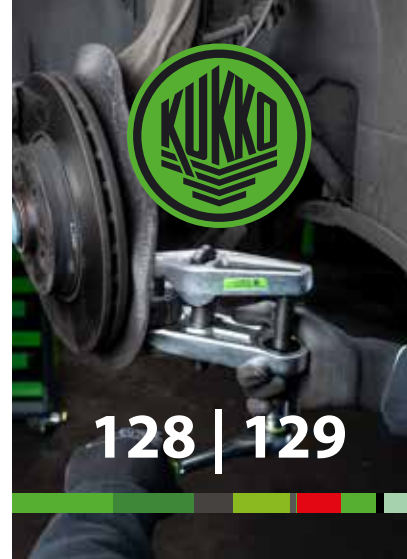
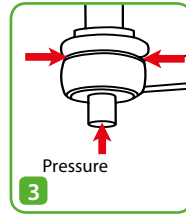
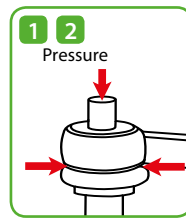
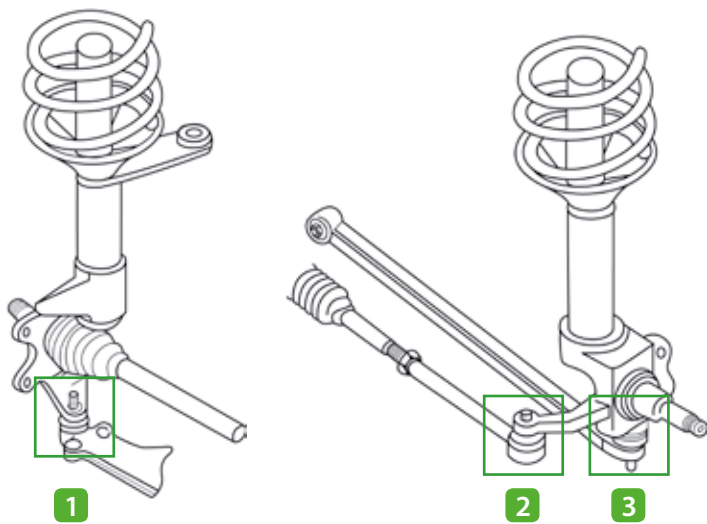

2 3 AREAS OF APPLICATION

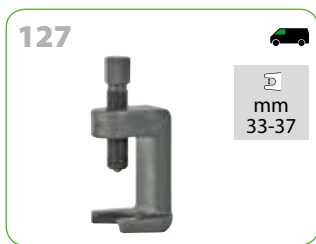

1 2 3 AREAS OF APPLICATION

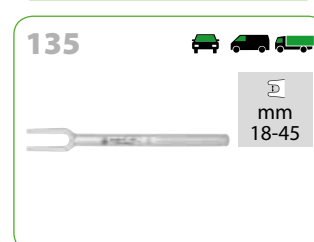
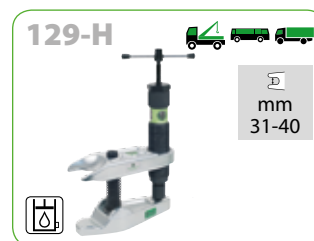

 1 1/4 inch

 2 3/4 inch

 für
für medium-
sized trucks, busses and construction vehicles

 max. 62,6 ft lb

 max. 11 US t

metric **imperial**

 31 mm

 70 mm

 DIN ISO
7803 35 mm

 DIN ISO
7803 40 mm

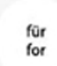
 für
für medium-
sized trucks, busses and construction vehicles

 max. 85 Nm

 max. 10 t

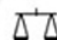
 3.316 kg

metric imperial

Spare part

[801](#) Short hydraulic spindle.

[129331](#) Clamping lever

[129314](#) Frame

[129406](#) Mechanical screw with accessories

[129506](#) Screw with adapter

Accessories

[800](#) Short hydraulic spindle.

part of

[WT-005](#) Puller product range - automotive

[EVLW-1-NFZ](#) Merchandiser, automotiv pullers

[EVLW-2-NFZ](#) Merchandiser, automotive pullers / commercial vehicle / agricultural machinery

Spare part of

[WT-005](#) Puller product range - automotive

also included in

[WT-005](#) Puller product range - automotive

Looking for dependable automotive tools? Rely on Kukko for quality and long-lasting products.