

2" - 2.5" **HITCH ADAPTER**

USER GUIDE

INCLUDED

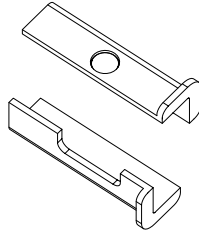

2" - 2.5" Hitch Adapter

Hitch Adapter Installation

- 1 Insert top and bottom adapter pieces into 2.5" hitch port. Pieces are magnetized and will remain in place once positioned.

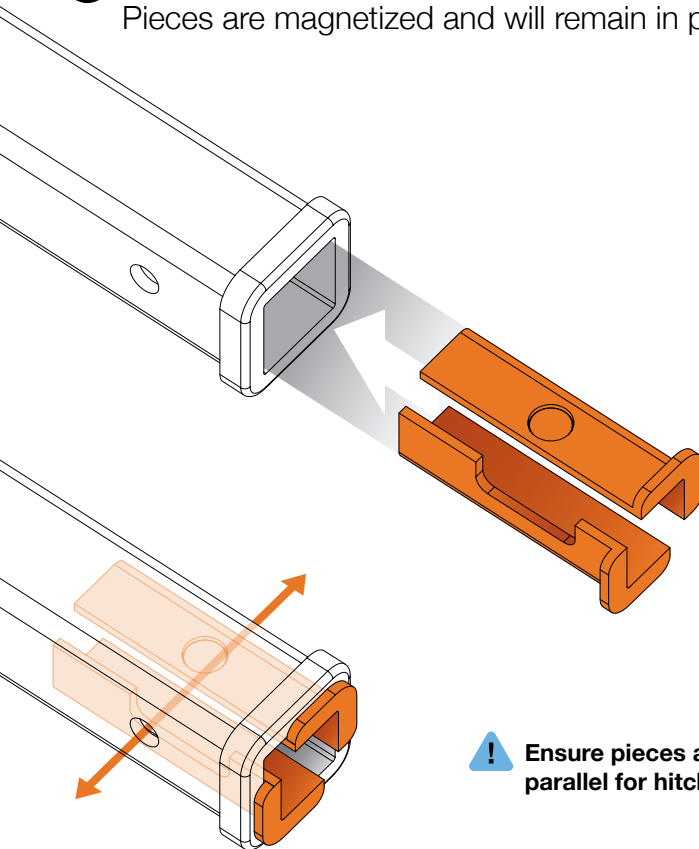

Ensure pieces are oriented with notches parallel for hitch pin installation later.

2 Insert bike rack into adapted hitch port.

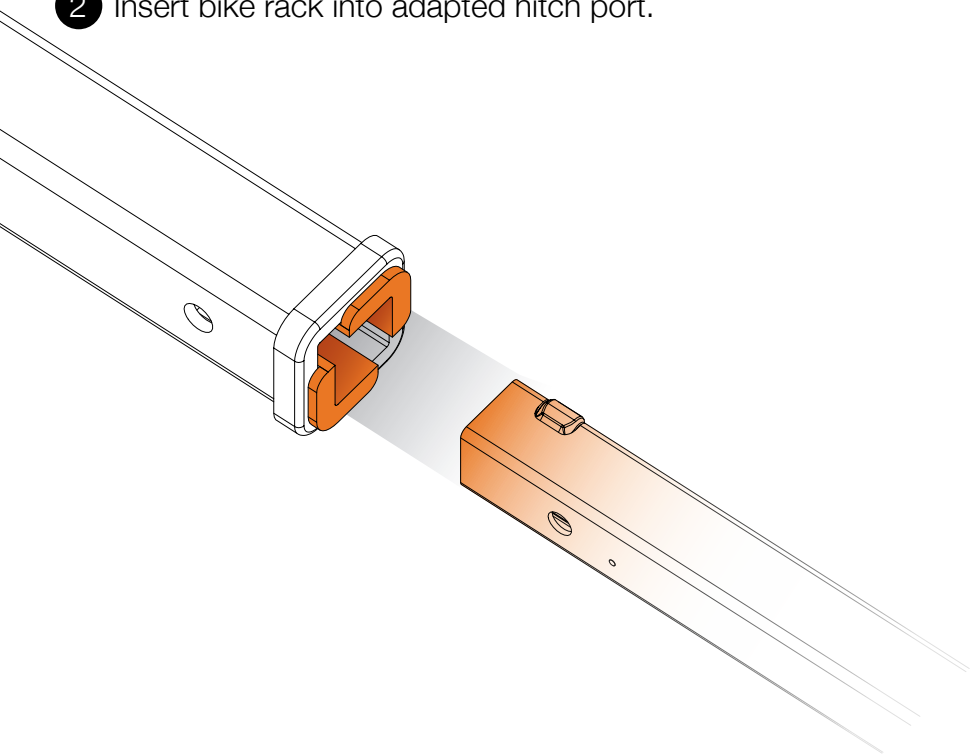

3 Tighten bike rack and secure with hitch lock.

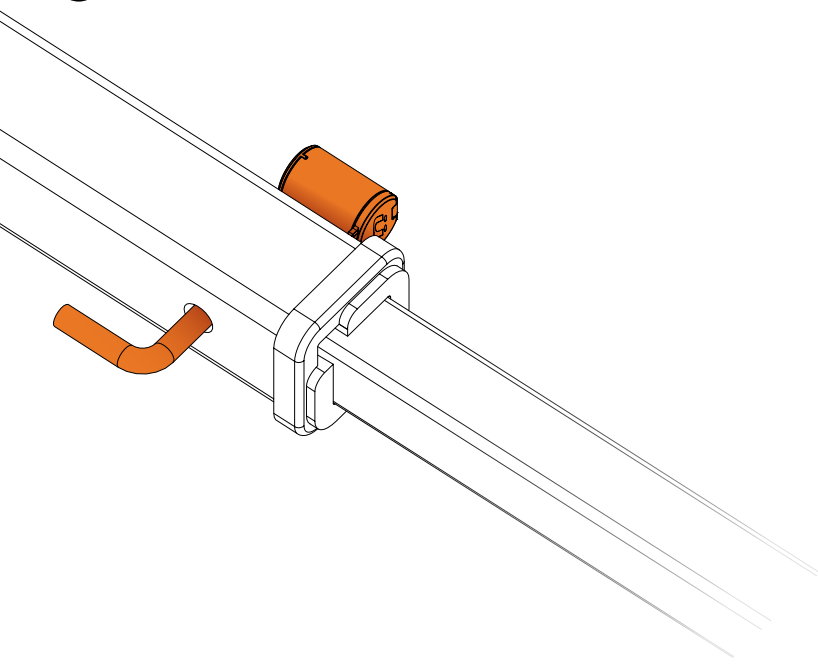

Warnings

2" - 2.5"

HITCH ADAPTER

Maximum Bike Weight

65 lb
29.5 kg

WARNINGS

- Follow instructions for proper assembly, installation and use.
- Check tightness of all bolts and screws periodically.

If you have questions or problems, please contact Küat Racks directly by calling toll free 1(877)822-KUAT, or by email: info@kuat.com

ADVERTENCIAS

- Siga las instrucciones para un montaje, instalación y uso adecuados.
- Compruebe periódicamente la estanqueidad de todos los pernos y tornillos.

AVERTISSEMENTS

- Suivez les instructions pour un assemblage, une installation et une utilisation appropriés.
- Vérifiez régulièrement le serrage de tous les boulons et vis.

kuat[®]

1.877.822.5828

info@kuat.com

kuat.com