

OIL HYDRAULIC HANDBRAKES INSTRUCTION

VERTICAL TYPE / HORIZONTAL TYPE

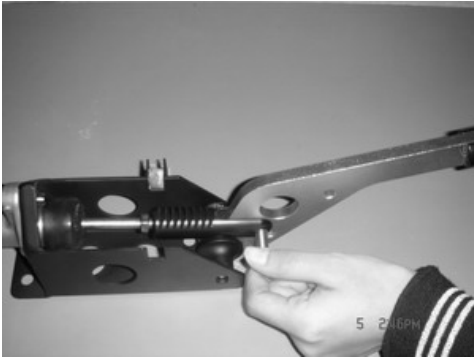

TAKE OUT THE SILVER BOLT

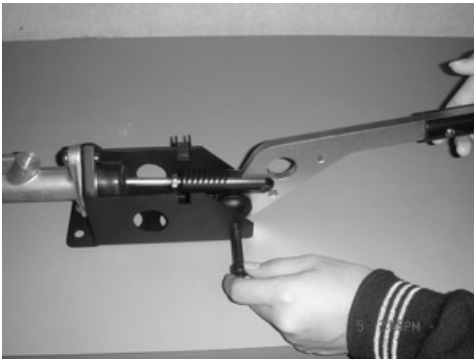

TO LOOSE THE SCREW AND TAKE IT OUT

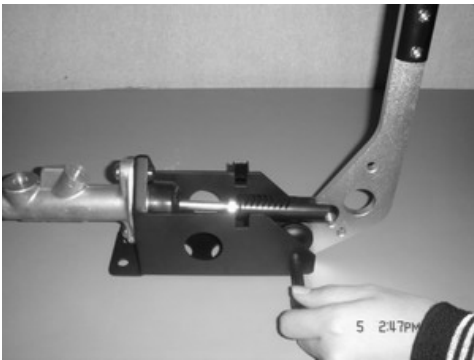

TO OPPOSITE THE HANDLE AND INSTALL THE SCREW,
ALSO MAKE SURE THE NUT IS TIGHTEN.

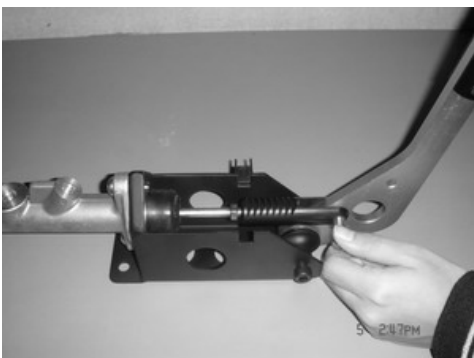

TO PUT THE BOIL BACK

OIL HYDRAULIC HANDBRAKES

- This product is complete universal for all the vehicles.
- This product is designed for D1, RALLY, or TRACK RACE.
- The rear tire can be fully locked and makes the vehicle slide to the side.
- This product can be installed to the vertical type or horizontal type as the following:

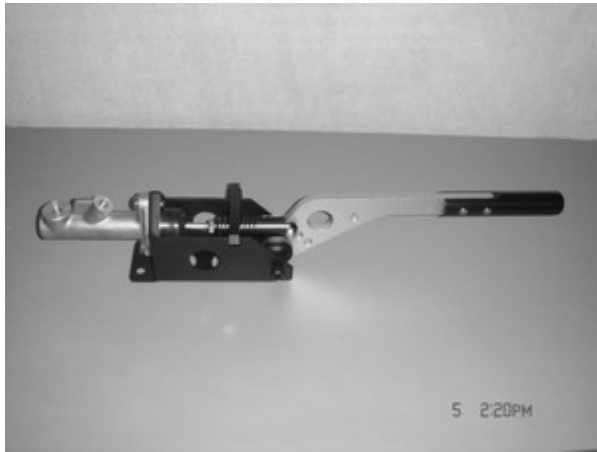

Horizontal Type

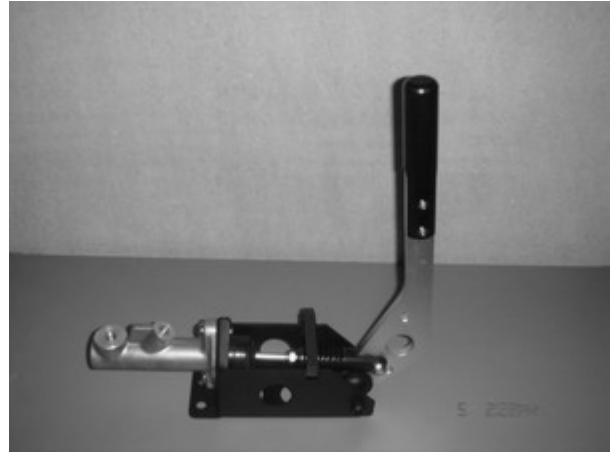

Vertical Type

- The Horizontal Type can be installed on the vehicle without disassemble the internal board, if there is any problem of the angle or the length are while installation, please contact the specialized technician to revise it.
- The Vertical Type is for RACE purpose, it can be installed close to the gear for the better handle.
- Using the length of the rod to adjust the fix pad and makes it to be fixed on the alveolus, it is for stopping the vehicle.
- This product will involve the brake system to be changed, please install this products by the licensed technicians, and make sure the air on the brake oil is evacuated, also inspect the connection has no leaking.
- This product is suitable for DOT3, DOT4, DOT5.
- The oil pipe on the AB trough, please custom-made by each model.
- The A trough is for oil to entry.
- The B trough is for oil to exit.

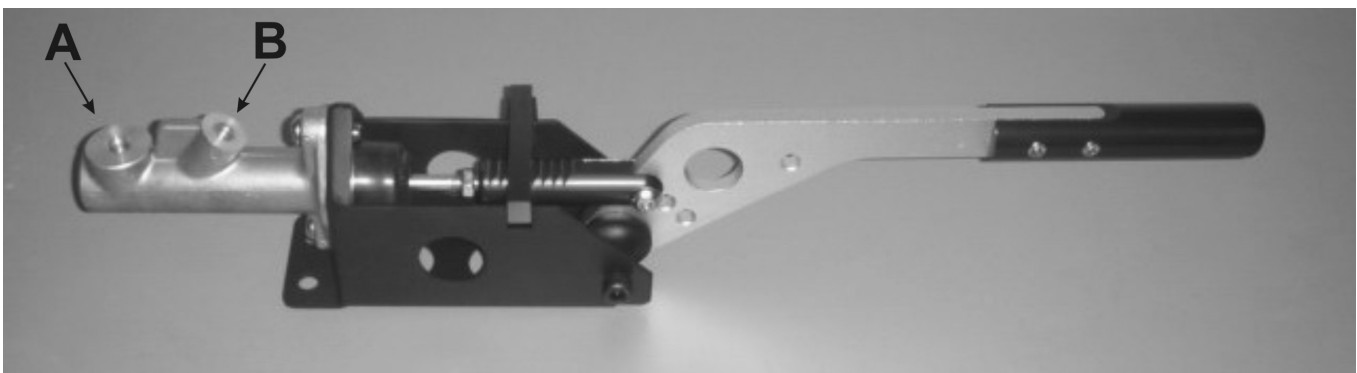

This product needs to be installed by the specialized technology, thus, we do not take any responsibility if there is any damage by install this product.