



INSTALLATION INSTRUCTIONS

77-9040KP TOYOTA 2016-17 Land Cruiser V8-5.7L

NOTE: This kit was not designed to fit vehicles with a body lift.

TOOLS NEEDED:

flat blade screw driver
Phillips screw driver
ratchet
extension
10mm socket
9/16 wrench
10mm wrench
3mm Allen wrench
4mm Allen wrench

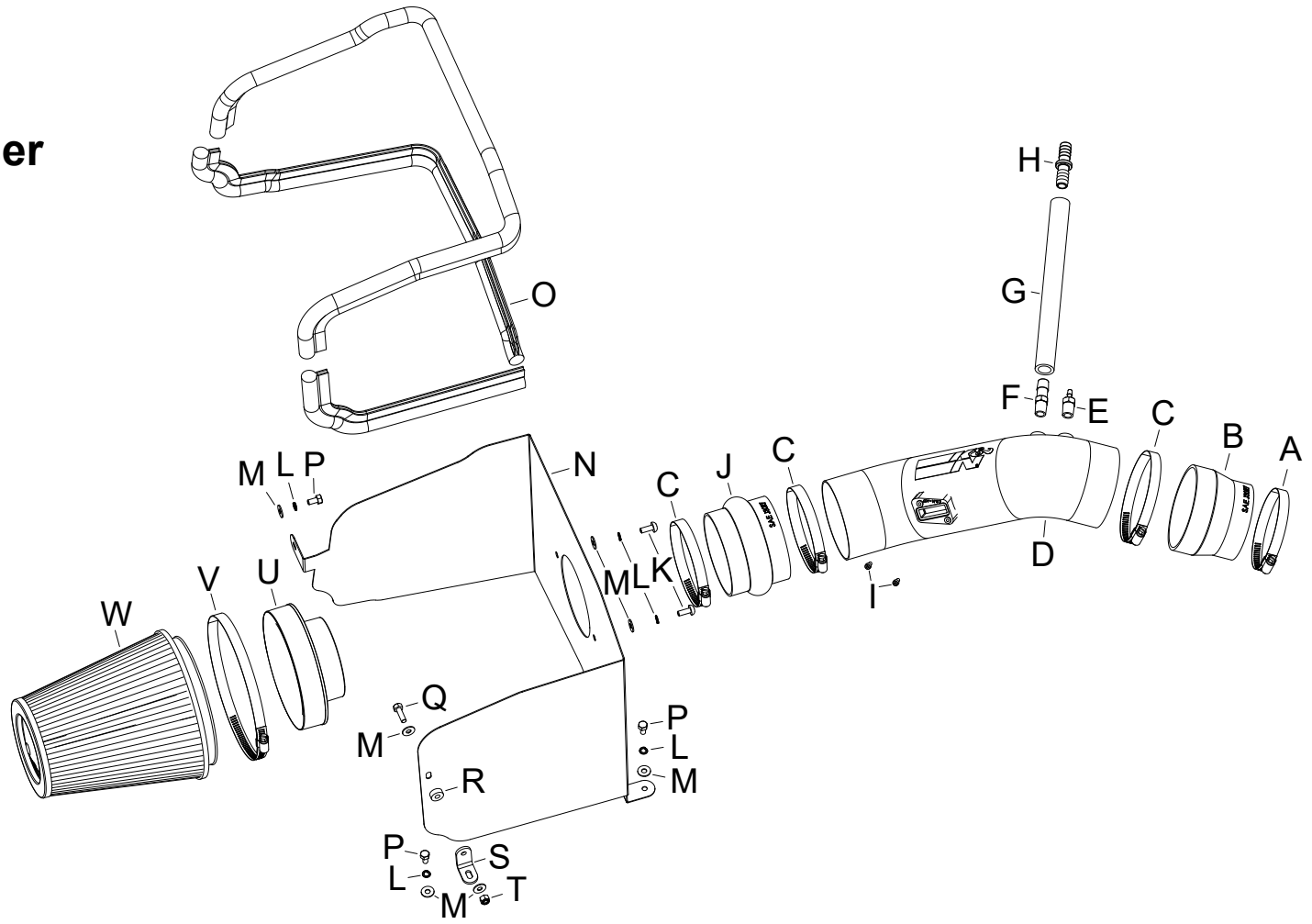

PARTS LIST:

Description	Qty.	Part #	Description	Qty.	Part #	Description	Qty.	Part #
A HOSE CLAMP; #56	1	08620	I BOLT; M4 - 0.07 8MM, A/H CAP	2	07733	Q BOLT; M6 X 1.00" X 20MM HEX	1	07795
B HOSE; 4"ID TO 3-1/2"ID X 3"L	1	08497	J HOSE; 4" ID X 3" L HUMP	1	08418	R SPACER: .625" OD X .250"ID	1	06555
C HOSE CLAMP; #64 STAINLESS	3	08645	K BOLT; M6 X 1.00 X 16MM, SS	2	07730	S BRACKET; 69-2521, "L", SML	1	070066A
D INTAKE TUBE	1	27549P	L WASHER, M6 SPLIT LOCK ZINC	5	1-3025	T NUT; 6MM NYLOCK, HEXHEAD	1	07512
E VENT; STRT, 3/16 BARBED 1/4"	1	080021	M WASHER; 6MM FLAT, SS	7	08269	U ADAPTOR; 57-3058 #454	1	27300
F VENT; STRT 1/2" HOSE, 1/4"	1	080022	N HEAT SHIELD	1	073246	V HOSE CLAMP; #104	1	08697
G HOSE; 1/2" ID X 9" L	1	08401	O EDGE TRIM (80")	1	102461	W FILTER CHARGER	1	RF-1044
H HOSE MENDER; 1/2" BARBED	1	08686	P BOLT; M6 X 1.00 X 12MM, HEX	3	07727			

NOTE: FAILURE TO FOLLOW INSTALLATION INSTRUCTIONS AND NOT USING THE PROVIDED HARDWARE MAY DAMAGE THE INTAKE TUBE, THROTTLE BODY AND ENGINE.

TO START:

1. Turn off the ignition and disconnect the negative battery cable.

NOTE: Disconnecting the negative battery cable erases pre-programmed electronic memories. Write down all memory settings before disconnecting the negative battery cable. Some radios will require an anti-theft code to be entered after the battery is reconnected. The anti-theft code is typically supplied with your owner's manual. In the event your vehicles anti-theft code cannot be recovered, contact an authorized dealership to obtain your vehicles anti-theft code.



2. Disconnect the mass air sensor electrical connection and then unhook the wiring harness from the air box.



3. Remove the decorative engine cover.



4. Loosen the hose clamp which secures the intake tube to the throttle body.



5. Disconnect the crank case vent hose and fuel pressure line from the intake resonator.



6. Release the four retaining clips securing the upper air box and then remove the upper air box and intake tube assembly from the vehicle.



7. Loosen the three bolts securing the lower air box and then remove the lower air box from the vehicle.
NOTE: K&N Engineering, Inc., recommends that customers do not discard factory air intake.

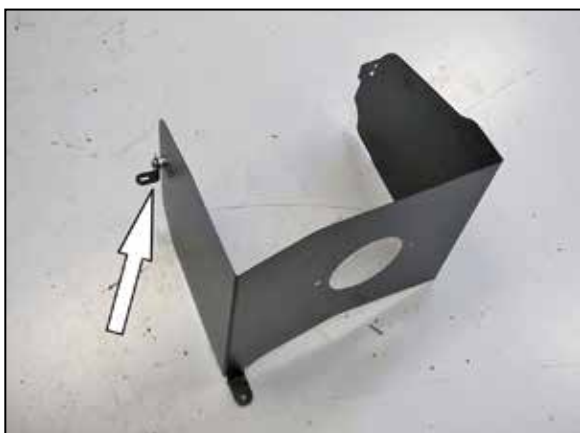

8. Install the heat shield mounting bracket (070066) onto the heat shield using the provided spacer and hardware.

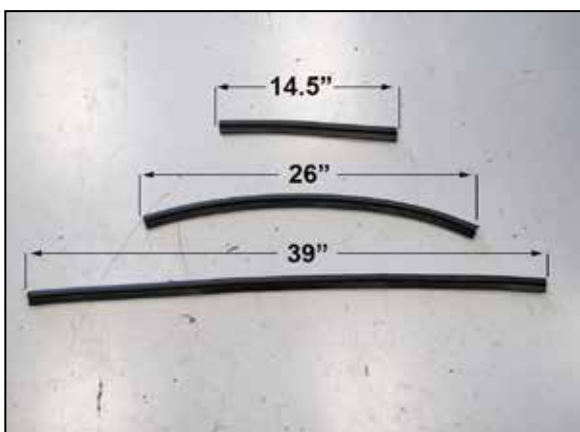

9. Cut the provided edge trim into three sections, one section will be 39" long, one section will be 26" long and the final section will be 14.5" long.



10. Install the edge trim onto the heat shield as shown.



11. Install the filter adapter onto the heat shield and secure with the provided hardware.



12. Remove the bolt which secures the horn to the inner fender.



13. Set the heat shield into the engine compartment and secure with the provided hardware.

NOTE: Be sure to secure the horn in the factory location along with the heat shield.



14. Install the coupling hose (08050) onto the throttle body and secure with the provided hose clamp.



15. Install the hump coupler (08418) onto the filter adapter and secure with the provided hose clamp.



16. Remove the two screws securing the mass air sensor and then remove the mass air sensor from the upper air box housing.



17. Install mass air sensor into the intake tube and secure with the provided hardware.



18. Install the provided NPT vent fittings into the K&N® intake tube as shown.

NOTE: Plastic NPT fittings are easy to cross thread. Install the vent fitting "hand" tight, then turn it two complete turns with a wrench.



19. Install the hose mender into the provided crank case vent hose as shown.



20. Install the K&N® intake tube into the hump coupler at the heat shield and then into the coupler at the throttle body, adjust the tube for best fit and then secure with the provided hose clamp.



21. Install the crank case hose assembly into the factory crank case vent, Then connect the crank case vent hose and the fuel pressure hose to the fittings installed into the K&N® intake tube.



22. Install the K&N® air filter and secure with the provided hose clamp.

NOTE: Drycharger® air filter wrap; part # RF-1020DK is available to purchase separately.



23. Reconnect the mass air sensor electrical connection.



24. Install the decorative engine cover.



25. Reconnect the vehicle's negative battery cable. Double check to make sure everything is tight and properly positioned before starting the vehicle.

26. It will be necessary for all K&N® high flow intake systems to be checked periodically for realignment, clearance and tightening of all connections. Failure to follow the above instructions or proper maintenance may void warranty.

ROAD TESTING:

1. Start the engine with the transmission in neutral or park, and the parking brake engaged. Listen for air leaks or odd noises. For air leaks secure hoses and connections. For odd noises, find cause and repair before proceeding. This kit will function identically to the factory system except for being louder and much more responsive.

2. Test drive the vehicle. Listen for odd noises or rattles and fix as necessary.

3. If road test is fine, you can now enjoy the added power and performance from your kit.

4. K&N Engineering, Inc., requires cleaning the intake system's air filter element every 100,000 miles. When used in dusty or off-road environments, our filters will require cleaning more often. We recommend that you visually inspect your filter once every 25,000 miles to determine if the screen is still visible. When the screen is no longer visible some place on the filter element, it is time to clean it. To clean and re-oil, purchase our filter Recharger® service kit, part number 99-5050 or 99-5000 and follow the easy instructions.