



## INSTALLATION INSTRUCTIONS

### 77-2586KS FORD 2012-14 Edge L4-2.0L Turbo

#### TOOLS NEEDED:

ratchet  
extension  
13mm socket  
10mm socket  
8mm socket  
flat blade screw driver  
pliers  
4mm allen key  
3mm allen key  
t20 torx

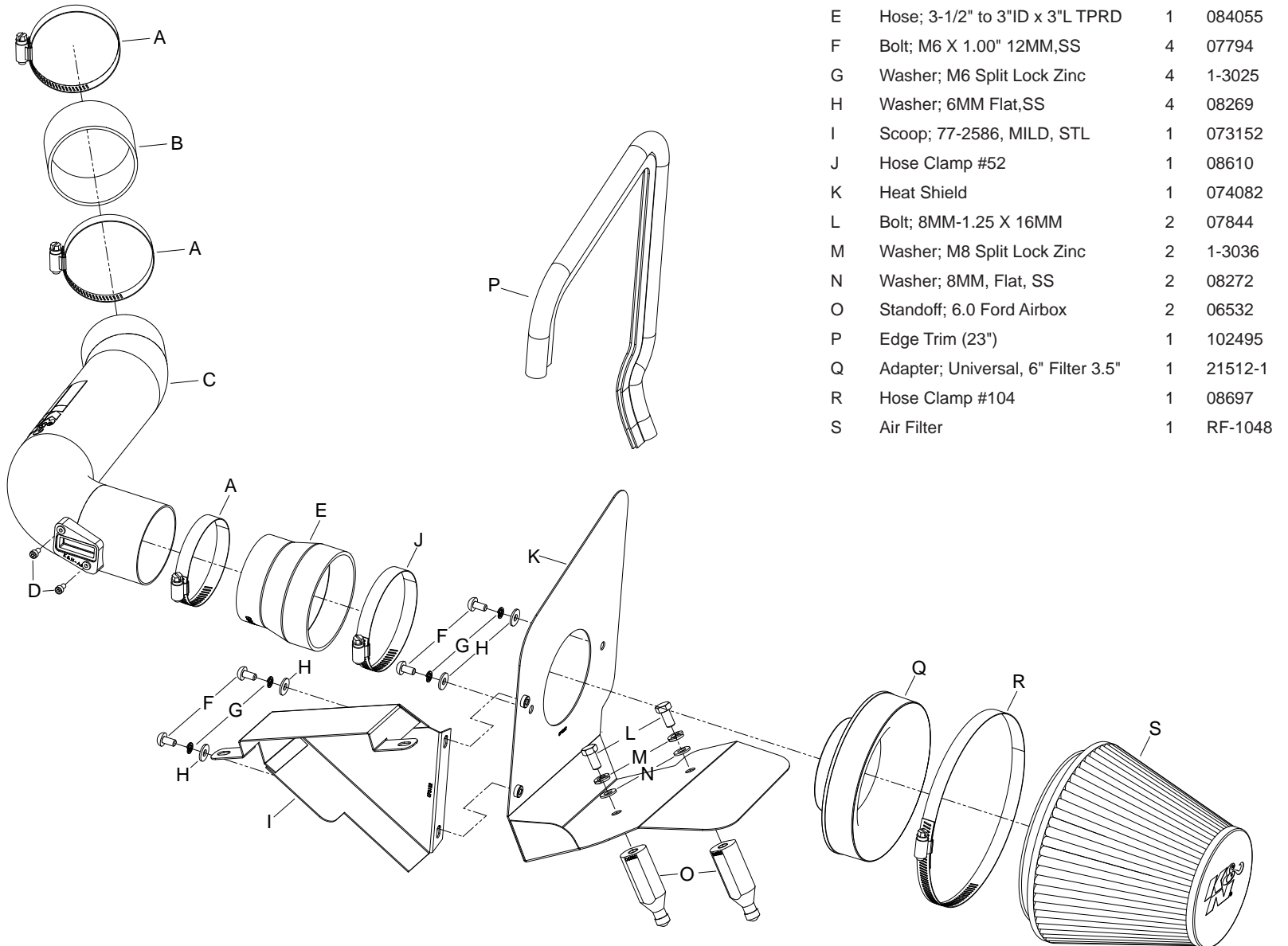

#### PARTS LIST:

	Description	Qty.	Part #
A	Hose Clamp #44 Stainless	3	08560
B	Hose; 3"ID X 2"L Reinforced	1	08711
C	Intake Tube	1	27606KS
D	Bolt; M4-0.07 8MM, A/H CAP, SS	2	07733
E	Hose; 3-1/2" to 3"ID x 3"L TPRD	1	084055
F	Bolt; M6 X 1.00" 12MM,SS	4	07794
G	Washer; M6 Split Lock Zinc	4	1-3025
H	Washer; 6MM Flat,SS	4	08269
I	Scoop; 77-2586, MILD, STL	1	073152
J	Hose Clamp #52	1	08610
K	Heat Shield	1	074082
L	Bolt; 8MM-1.25 X 16MM	2	07844
M	Washer; M8 Split Lock Zinc	2	1-3036
N	Washer; 8MM, Flat, SS	2	08272
O	Standoff; 6.0 Ford Airbox	2	06532
P	Edge Trim (23")	1	102495
Q	Adapter; Universal, 6" Filter 3.5"	1	21512-1
R	Hose Clamp #104	1	08697
S	Air Filter	1	RF-1048

**NOTE: FAILURE TO FOLLOW INSTALLATION INSTRUCTIONS AND NOT USING THE PROVIDED HARDWARE MAY DAMAGE THE INTAKE TUBE, THROTTLE BODY AND ENGINE.**

#### TO START:

1. Turn off the ignition and disconnect the negative battery cable.  
**NOTE: Disconnecting the negative battery cable erases pre-programmed electronic memories. Write down all memory settings before disconnecting the negative battery cable. Some radios will require an anti-theft code to be entered after the battery is reconnected. The anti-theft code is typically supplied with your owner's manual. In the event your vehicles anti-theft code cannot be recovered, contact an authorized dealership to obtain your vehicles anti-theft code.**



2. Lift up and remove the engine cover.



3. Disconnect the inlet air temperature sensor electrical connection and unhook the harness from the air box.

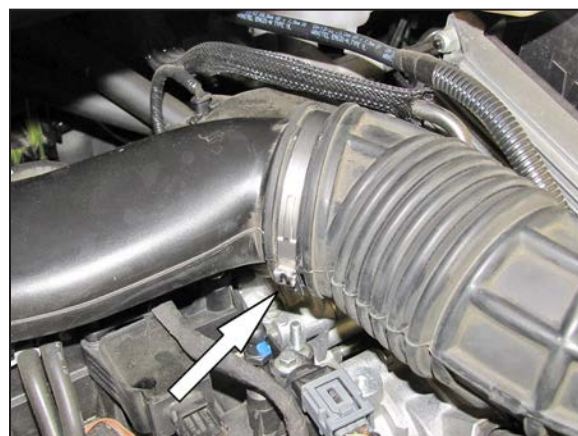

4. Release the hose clamp that secures the intake hose to the intake tube.

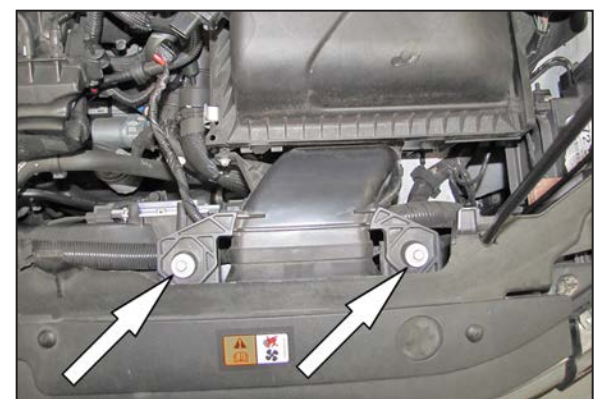

5. Remove the two bolts that secure the fresh air intake to the core support and then lift up and remove the complete intake assembly.  
**NOTE: These bolts will be reused in a later step.**

**NOTE: K&N Engineering, Inc., recommends that customers do not discard factory air intake.**

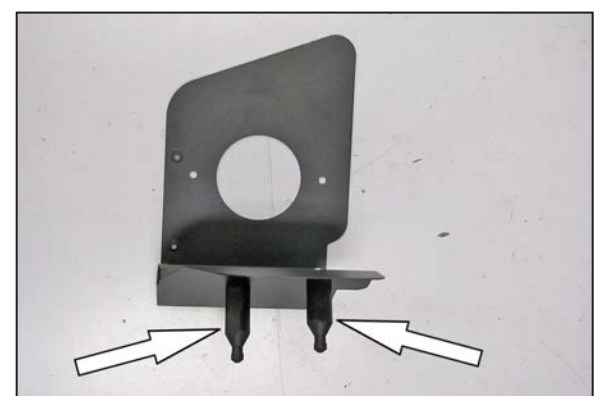

6. Install the two provided stand offs onto the heat shields using the provided hardware.



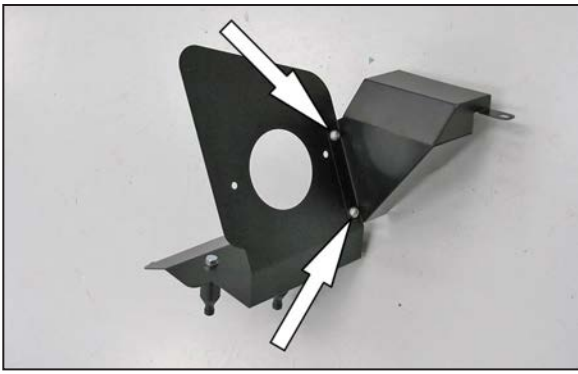

7. Install the K&N® fresh air intake onto the heat shield as shown using the provided hardware.

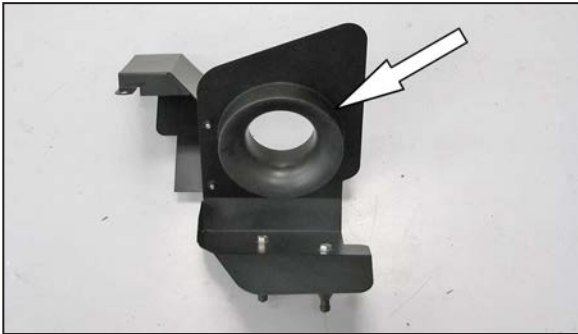

8. Install the filter adapter onto the heat shield as shown using the provided hardware.

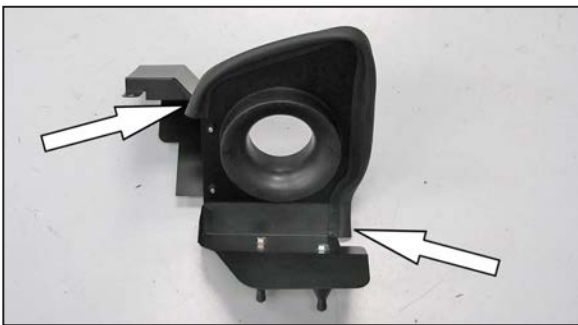

9. Install the provided edge trim onto the heat shield as shown.

**NOTE: Some trimming of the edge trim will be necessary.**



10. Install the K&N® air filter onto the filter adapter and secure with the provided hose clamp.

**NOTE: Drycharger® air filter wrap; part # RF-1048DK is available to purchase separately.**

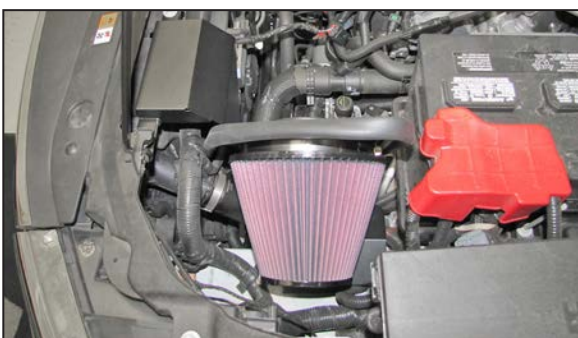

11. Install the K&N® filter/heat shield assembly so the stand-offs insert into the air box mounting grommets. Align the K&N® fresh air intake with the factory mounting holes and secure with the factory bolts removed in step #5.

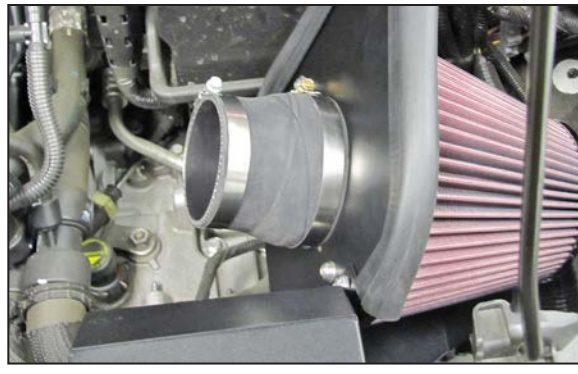

12. Install the provided step hose (084055) onto the filter adapter and secure with the provided hose clamp.



13. Install the provided coupling hose (08711) onto the turbo inlet tube and secure with the provided hose clamp.



14. Remove the two screws securing the inlet air temperature sensor into the factory intake tube and then remove the sensor.



15. Install the inlet air temperature sensor into the K&N® intake tube and secure with the hardware provided.



16. Install the K&N® intake tube into the hose at the throttle body and then into the hose at the filter adapter, align the tube for best fit and then secure with the provided hose clamps.

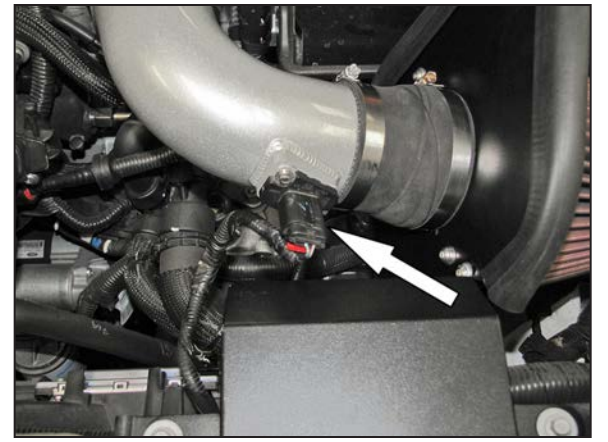

17. Reconnect the inlet air temperature electrical connection.



18. Reinstall the engine cover.

19. Reconnect the vehicle's negative battery cable. Double check to make sure everything is tight and properly positioned before starting the vehicle.

20. The C.A.R.B. exemption sticker, (attached), must be visible under the hood so that an emissions inspector can see it when the vehicle is required to be tested for emissions. California requires testing every two years, other states may vary.

21. It will be necessary for all K&N® high flow intake systems to be checked periodically for realignment, clearance and tightening of all connections. Failure to follow the above instructions or proper maintenance may void warranty.

#### ROAD TESTING:

1. Start the engine with the transmission in neutral or park, and the parking brake engaged. Listen for air leaks or odd noises. For air leaks secure hoses and connections. For odd noises, find cause and repair before proceeding. This kit will function identically to the factory system except for being louder and much more responsive.

2. Test drive the vehicle. Listen for odd noises or rattles and fix as necessary.

3. If road test is fine, you can now enjoy the added power and performance from your kit.

4. K&N Engineering, Inc., requires cleaning the intake system's air filter element every 100,000 miles. When used in dusty or off-road environments, our filters will require cleaning more often. We recommend that you visually inspect your filter once every 25,000 miles to determine if the screen is still visible. When the screen is no longer visible some place on the filter element, it is time to clean it. To clean and re-oil, purchase our filter Recharger® service kit, part number 99-5050 or 99-5000 and follow the easy instructions.