

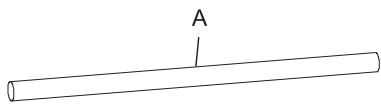

## INSTALLATION INSTRUCTIONS

### 77-1526KP JEEP 1999-04 Grand Cherokee L6-4.0L



**NOTE:** This kit was not designed to fit vehicles with a body lift.

#### TOOLS NEEDED:

Flat Blade Screwdriver  
7/16" Wrench  
5/8" Wrench  
10mm Socket  
13mm Socket  
7/16" Socket  
Ratchet w/long extension

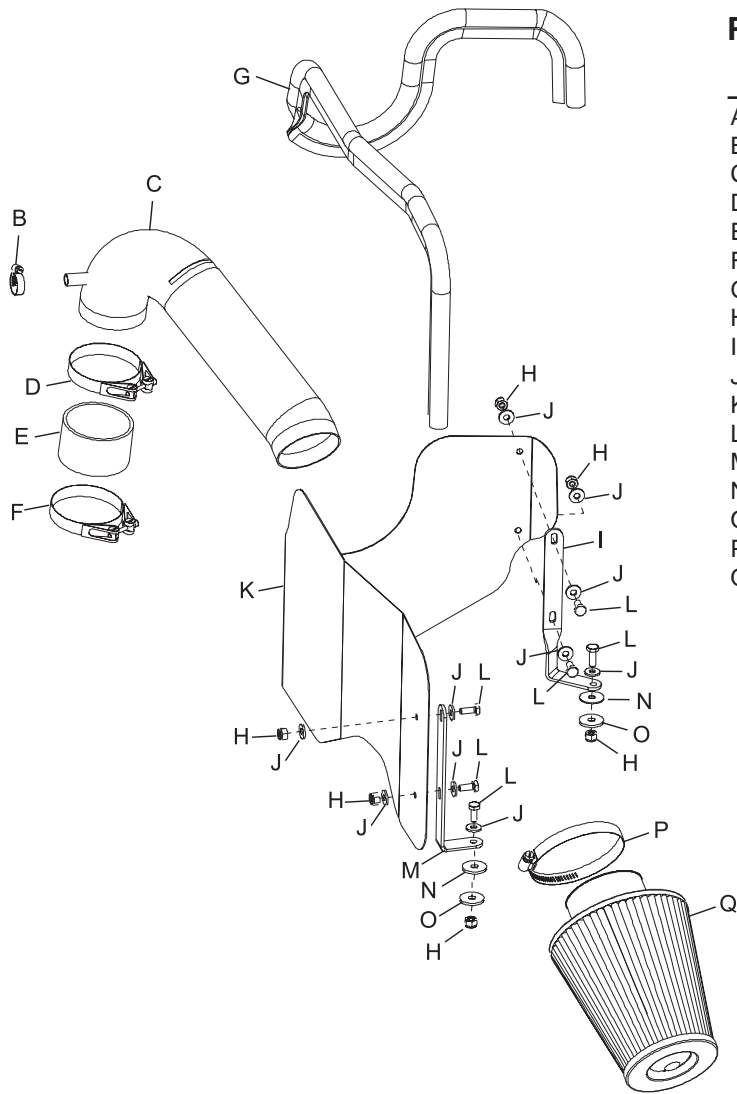

#### PARTS LIST:

Description	Qty.	Part #
A Silicone Hose, 1/2"ID x 15-3/4"L.	1	08414
B Hose Clamp, #6 Mini	1	08407
C Intake Tube	1	27423
D Hose Clamp, #40	1	08554
E Silicone Step Hose	1	084014
F Hose Clamp, #44	1	08577
G Edge Trim, 3/4" bulb, 48"L	1	102485
H Nut, 6mm Nylock	6	07512
I Bracket, "L" Twist	1	070912
J Washer, 6mm Flat, SS	10	08269
K Heat Shield	1	07475
L Bolt, M6-1.00 x 20mm L, Hex	6	07795
M Bracket, "L"	1	070902
N Washer, Rubber	2	21685
O Washer, Fender	2	08160
P Hose Clamp, #44	1	08577
Q Air Filter	1	RU-4870

**NOTE: FAILURE TO FOLLOW INSTALLATION INSTRUCTIONS AND NOT USING THE PROVIDED HARDWARE MAY DAMAGE THE INTAKE TUBE, THROTTLE BODY AND ENGINE.**

#### TO START:

- Turn off the ignition and disconnect the negative battery cable.  
**NOTE: Disconnecting the negative battery cable erases pre-programmed electronic memories. Write down all memory settings before disconnecting the negative battery cable. Some radios will require an anti-theft code to be entered after the battery is reconnected. The anti-theft code is typically supplied with your owner's manual. In the event your vehicles' anti-theft code cannot be recovered, contact an authorized dealership to obtain your vehicles anti-theft code.**



- Disconnect the crank case vent hose as shown.



- Loosen the bolt on the resonator as shown.



- Loosen the hose clamp at the air cleaner lid and at the throttle body, then, remove the resonator and bellows assembly as shown.



- Remove the three nuts that secure the air cleaner assembly from underneath the vehicle, then, remove the air cleaner assembly as shown.  
**NOTE: K&N® recommends that you do not discard your factory air intake.**



- Install the provided trim seal onto the heat shield as shown.  
**NOTE: Some trimming of the edge trim will be necessary.**



- Using the provided hardware install the two brackets onto the heat shield as shown.



- Install the heat shield into the vehicle and secure the twist bracket to the original air cleaner mounting hole using the provided hardware.



- Secure the "L" bracket to the hole on the flange/tab on the radiator core support using the provided hardware.





10. Install the provided silicone hose and hose clamps onto the throttle body as shown.



11. Install the K&N<sup>®</sup> intake tube into the silicone hose as shown, but do not tighten completely as some adjustment may be necessary.



12. Connect the provided hose to the vent on the valve cover, then, connect the other end to the vent on the K&N<sup>®</sup> intake tube as shown.



13. Reconnect the vehicle's negative battery cable. Double check to make sure everything is tight and properly positioned before starting the vehicle.

**NOTE: Drycharger<sup>®</sup> air filter wrap; part # RX-4730DK is available to purchase separately.**

14. The C.A.R.B. exemption sticker, (attached), must be visible under the hood so that an emissions inspector can see it when the vehicle is required to be tested for emissions. California requires testing every two years, other states may vary.

15. It will be necessary for all K&N<sup>®</sup> high flow intake systems to be checked periodically for realignment, clearance and tightening of all connections. Failure to follow the above instructions or proper maintenance may void warranty.

#### ROAD TESTING:

1. Start the engine with the transmission in neutral or park, and the parking brake engaged. Listen for air leaks or odd noises. For air leaks secure hoses and connections. For odd noises, find cause and repair before proceeding. This kit will function identically to the factory system except for being louder and much more responsive.

2. Test drive the vehicle. Listen for odd noises or rattles and fix as necessary.

3. If road test is fine, you can now enjoy the added power and performance from your kit.

4. K&N Engineering, Inc., suggests checking the air filter element periodically for excessive dirt build-up. When the element becomes covered in dirt (or once a year), service it according to the instructions on the Recharger<sup>®</sup> service kit, part number 99-5050 or 99-5000.