

K&N TYPHOON INTAKE SYSTEMS

INSTALLATION INSTRUCTIONS

69-8614TS

SCION

2007-10 TC

L4-2.4L

TOOLS NEEDED:

- Flat Blade Screw Driver
- Phillips Screw Driver
- Ratchet
- Extension
- 17mm Socket
- 10mm Socket
- 10mm Wrench
- 3mm Allen Wrench
- Pliers

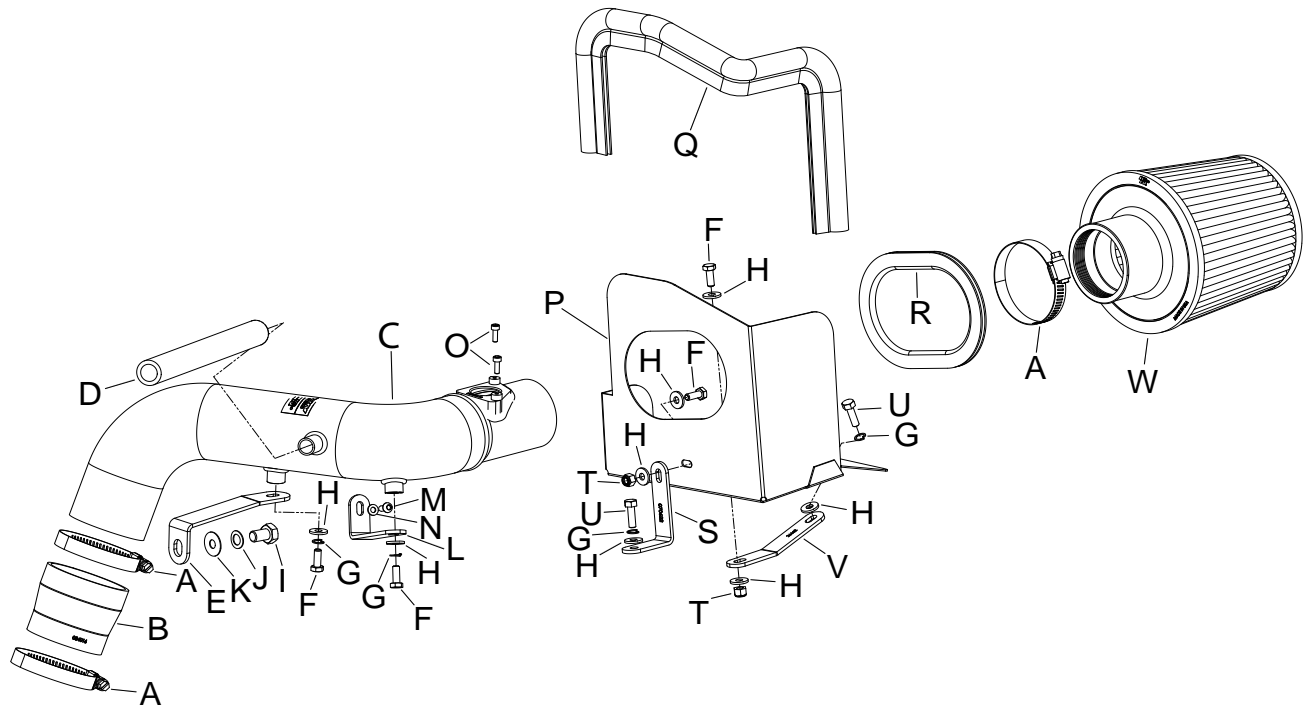

PARTS LIST:

Description	Qty.	Part #	Description	Qty.	Part #	Description	Qty.	Part #
A Hose Clamp #40	3	08554	I Bolt; M10-1.25x16MM Hex	1	071002	Q Edge Trim (23")	1	102495
B Hose; 2-1/2" TO 2-3/4" TPRD	1	084016	J Washer; 10MM Wave	1	08175	R Edge Trim (20")	1	102476
C Intake Tube	1	27538	K Washer; 3/8" Flat SS	1	08134	S Bracket; "L", FIN.	1	070622
D Hose; 5/8"IDx9-3/4"L,	1	084047	L Bracket; "L", FIN	1	07093	T Nut; 6MM Nylock, Hexhead, SS	2	07512
E Bracket; "L", STL, FB/PC	1	26661	M Bolt; M5-0.8x12MM B/H, SS	1	07734	U Bolt; M6x1.00"x20MM Hex, SS	2	07795
F Bolt; 6MM-1.00x16MM, SS	4	07812	N Washer; 5MM Flat, SS	1	08212	V Bracket; "C", STL, FB/PC	1	26662
G Washer; 1/4" Lock, ZN	4	08198	O Bolt; M4-0.07 8MM, A/H Cap	2	07733	W Air Filter	1	RU-4860
H Washer; 1/4"IDx5/8"OD - SAE	8	08275	P Heat Shield	1	07365			

NOTE: FAILURE TO FOLLOW INSTALLATION INSTRUCTIONS AND NOT USING THE PROVIDED HARDWARE MAY DAMAGE THE INTAKE TUBE, THROTTLE BODY AND ENGINE.

TO START:

1. Turn off the ignition and disconnect the negative battery cable.

NOTE: Disconnecting the negative battery cable erases pre-programmed electronic memories. Write down all memory settings before disconnecting the negative battery cable. Some radios will require an anti-theft code to be entered after the battery is reconnected. The anti-theft code is typically supplied with your owner's manual. In the event your vehicles' anti-theft code cannot be recovered, contact an authorized dealership to obtain your vehicles anti-theft code.

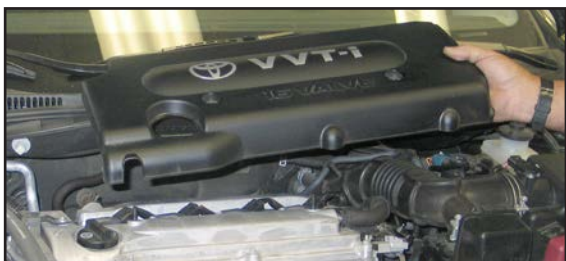

2. Remove the two nuts that secure the engine cover. Remove the engine cover from the engine.



3. Depress the locking tab on the mass air sensor electrical connection, then disconnect the mass air sensor electrical connector.



4. Un-hook the EVAP solenoid valve from the stock intake tube as shown.



5. Loosen the hose clamp that secures the intake tube to the upper air box, then disconnect the intake tube as shown.



6. Un-hook the upper air box mounting clips, then remove the upper air box as shown.

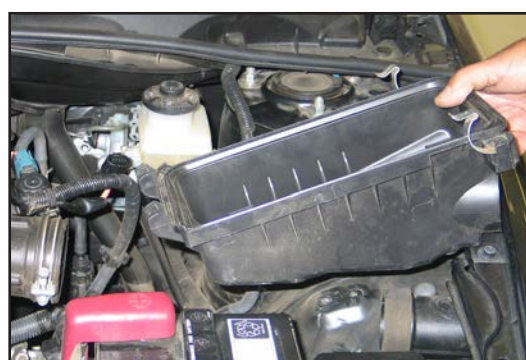

7. Remove the three lower air box mounting bolts shown, then remove the lower air box from the vehicle.

NOTE: K&N recommends that customers do not discard their factory air intake.



8. Un-hook the crank case vent hose from the valve cover as shown.



9. Release the spring clamp that secures the stock intake tube at the throttle body. Then, remove the complete intake tube assembly as shown.



10. Remove the bolt that secures the wiring harness as shown.

NOTE: This bolt will be re-used. The wiring harness bracket will stay in its current location.

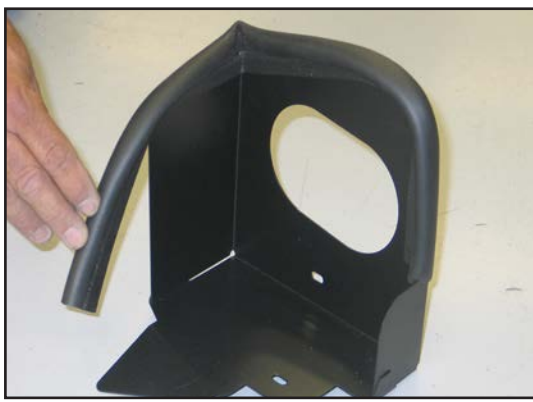

11. Install the long edge trim onto the heat shield as shown.

Note: Some trimming of the edge trim may be necessary.



12. Install the short edge trim onto the heat shield as shown.

Note: Some trimming of the edge trim may be necessary.



13. Install heat shield mounting bracket (#26662) onto the heat shield using the provided hardware as shown.



14. Install heat shield mounting bracket (#07093) onto the heat shield using the provided hardware as shown.



15. Set the heat shield into position as shown. Then, secure the heat shield brackets using the provided hardware as shown.



16. Remove the screws that secure the mass air sensor to the upper air box, then remove the mass air sensor as shown.



17. Install the mass air sensor into the K&N® intake tube and secure with the provided hardware.

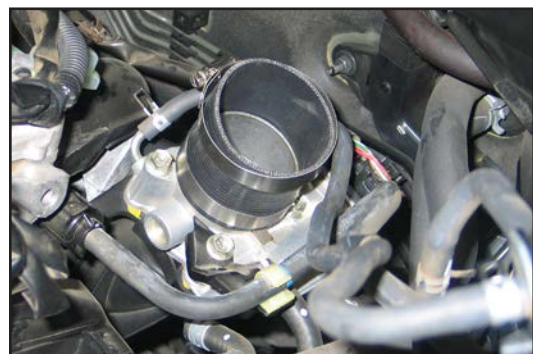

18. Install silicone hose (#084016) onto the throttle body and secure with the provided hose clamp.



19. Install intake tube mounting bracket (#26661) onto the cylinder head and secure with the provided hardware as shown.



20. Remove the screw that secures the mounting bracket to the EVAP valve, then remove the mounting bracket as shown.



21. Secure the provided bracket (#070622) to the EVAP solenoid valve as shown.



22. Install the K&N® intake tube into the silicone hose at the throttle body and align with the mounting bracket. Secure the intake tube with the provided hardware and hose clamp as shown.



23. Secure the EVAP mounting bracket to the intake tube with the provided hardware.

Note: Secure the EVAP bracket to the threaded nub on the bottom side of the tube.



24. Install the provided crank case vent hose as shown.



25. Install the K&N® air filter onto the K&N® intake tube and secure with the provided hose clamp.

NOTE: Drycharger® air filter wrap; part # RX-4730DK is available to purchase separately.



26. Re-connect the mass air sensor electrical connection.

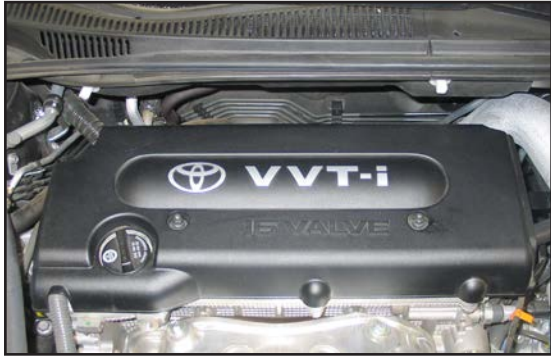

27. Re-install the engine cover and secure with the factory nuts.



28. Reconnect the vehicle's negative battery cable. Check to ensure all hose clamps and fittings are properly tightened and positioned correctly before starting the vehicle.

29. It will be necessary for all K&N® Performance Intake Kit's to be checked periodically for realignment, clearance and tightening of all connections. Failure to follow the above instructions or proper maintenance may void warranty.

ROAD TESTING:

1. Start the engine with the transmission in neutral or park, and the parking brake engaged. Listen for air leaks or odd noises. For air leaks secure hoses and connections. For odd noises, find cause and repair before proceeding. This kit will function identically to the factory system except for being louder and much more responsive.
2. Test drive the vehicle. Listen for odd noises or rattles and fix as necessary.
3. If road test is fine, you can now enjoy the added power and performance from your kit.
4. K&N suggests checking the Air Filter element periodically for excessive dirt build-up. When the element becomes covered in dirt (or once a year), service it according to the instructions on the Recharger service kit, part number 99-5000 or 99-5050.