

K&N® TYPHOON INTAKE SYSTEMS

INSTALLATION INSTRUCTIONS

69-8432TS
PONTIAC / SATURN
2006-09 Solstice
2007-09 Sky
L4-2.4L

TOOLS NEEDED:

Flat Blade Screwdriver
 Phillips Screwdriver
 Pliers
 Ratchet
 Extension
 10mm Socket
 3mm Allen Wrench
 T30 Torx Wrench
 13mm Socket

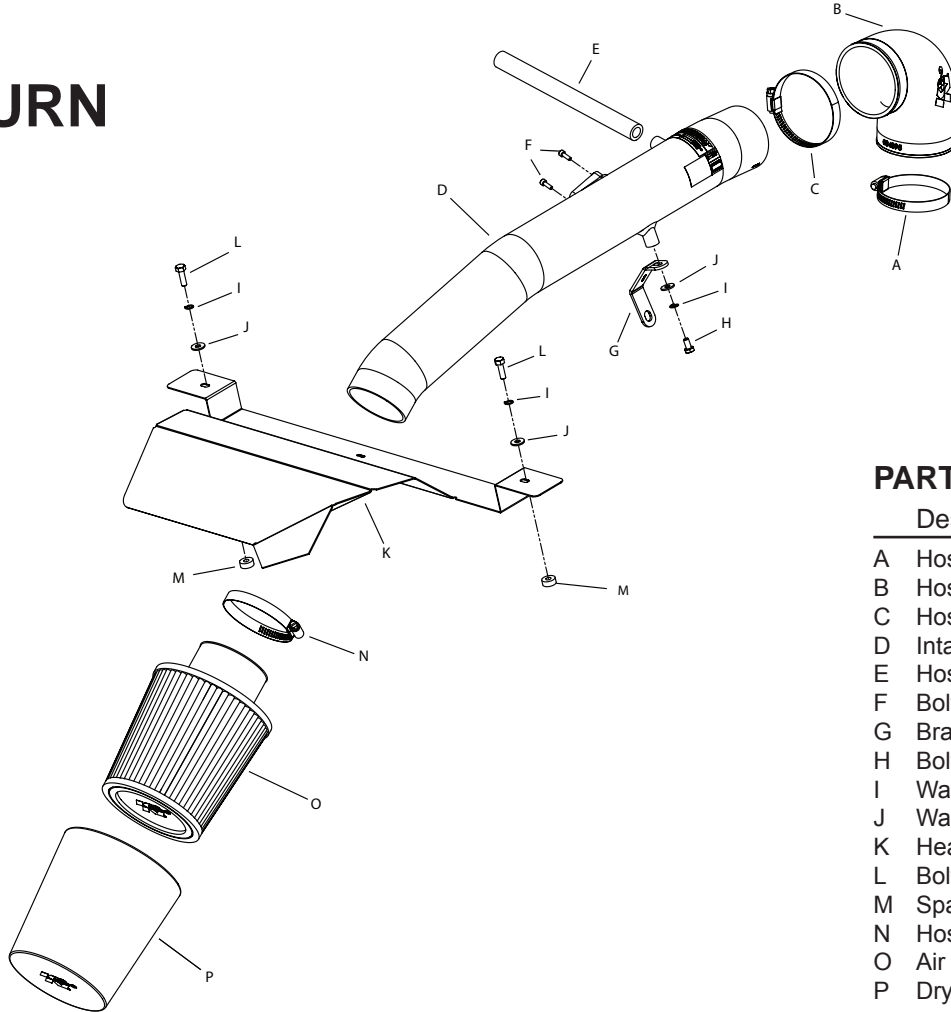

PARTS LIST:

Description	Qty.	Part #
A Hose Clamp #44	1	08560
B Hose; 2-3/4" id To 3" id Elbow	1	084087
C Hose Clamp #48	1	08601
D Intake Tube	1	27135
E Hose; 1/2" id X 9' l	1	08401
F Bolt; M4-0.07 8mm, A/h Cap	2	07733
G Bracket; "C", Stl. Fb/pc	1	06484
H Bolt; 6mm-1.00x16mm, Ss	1	07812
I Washer; 1/4" Lock, Zn	3	08198
J Washer; 6mm Flat, Ss	3	08269
K Heat Shield	1	07349
L Bolt; M6x1.00"x20mm Hex, SS	2	07795
M Spacer; .625" odx. 250" id x. 250" L	2	06555
N Hose Clamp #52	1	08610
O Air Filter	1	RU-4990
P Drycharger Wrap	1	RX-4990DK

WARNING: The K&N® Drycharger® included with this kit must be installed on the K&N® air filter when used with this K&N® cold air intake system. The K&N® cold air intake system a performance product that can be used safely during mild weather conditions. During harsh and inclement weather conditions, you must convert your cold air intake system to a short ram configuration, or return your vehicle to the stock OEM airbox and intake tract configuration. Failure to follow these instructions can void your warranty.

NOTE: FAILURE TO FOLLOW INSTALLATION INSTRUCTIONS AND NOT USING THE PROVIDED HARDWARE MAY DAMAGE THE INTAKE TUBE, THROTTLE BODY AND ENGINE.

TO START:

1. Turn off the ignition and disconnect the negative battery cable.

NOTE: Disconnecting the negative battery cable erases pre-programmed electronic memories. Write down all memory settings before disconnecting the negative battery cable. Some radios will require an anti-theft code to be entered after the battery is reconnected. The anti-theft code is typically supplied with your owner's manual. In the event your vehicles' anti-theft code cannot be recovered, contact an authorized dealership to obtain your vehicles anti-theft code.



2. Lift firmly on the engine cover to dislodge it from the mounting grommets and then remove the engine cover assembly.



3. Depress the locking tab and then disconnect the mass air sensor electrical connection.



4. Using pliers, release the hose clamp which secures the crankcase vent hose to the valve cover and then remove the crankcase vent hose from the valve cover as shown.



5. Loosen the hose clamp which secures the stock intake tube to the throttle body.



6. Release the six upper airbox mounting clips.



7. Firmly lift up the intake tube and upper airbox to release it from the mounting grommets and then remove the assembly from the vehicle.



8. Remove the front lower airbox mounting bolt shown.



9. Pull up firmly to release the lower airbox housing from the mounting grommets and then remove the lower airbox from the vehicle.

NOTE: K&N Engineering, Inc., recommends that customers do not discard factory air intake.



10. Remove the right lower airbox mounting studs shown from the bracket.

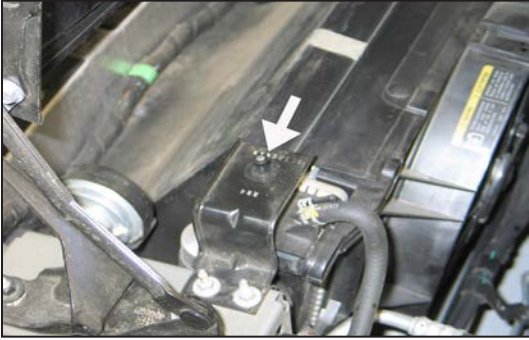

11. Remove the left lower airbox mounting studs shown from the bracket.



12. Remove the two screws securing the mass air sensor to the stock intake tube and then remove the mass air sensor as shown.



13. Install the mass air sensor into the K&N® intake tube and secure with the provided screws.



14. Install the K&N® Drycharger® onto the K&N® air filter as shown.

NOTE: Please be aware the Drycharger® is water repellent, not water proof. Depending on conditions and usage the water repellent treatment is good for 1 to 2 years. See the parts list to reorder a new Drycharger® if necessary.



15. Install the K&N® filter assembly onto the K&N® intake tube and secure with the provided hose clamp.



16. Install the provided silicone elbow hose onto the throttle body and secure with provided hose clamp.



17. Install the heat shield assembly and secure to the airbox mounting points, then secure with the provided hardware.

NOTE: It will be necessary to use the provided spacers between the heat shield and airbox mounting points on Saturn Sky vehicles.



18. Remove the upper alternator mounting bolt. **NOTE: This bolt will be reused in the next step.**



19. Install the tube mounting bracket onto the alternator and secure with the bolt removed in the previous step.



20. Install the K&N® intake tube assembly into the silicone hose at the throttle body and align with the mounting bracket installed in the previous step. Secure the tube with the hose clamp and hardware provided.



21. Install the supplied crankcase vent hose onto the valve cover and onto the intake tube as shown. **NOTE: Some trimming of the hose may be necessary.**



22. Connect the mass air sensor electrical connection.



23. Reinstall the engine cover.



24. Reconnect the vehicle's negative battery cable. Double check to make sure everything is tight and properly positioned before starting the vehicle.

25. The C.A.R.B. exemption sticker, (attached), must be visible under the hood so that an emissions inspector can see it when the vehicle is required to be tested for emissions. California requires testing every two years, other states may vary.

26. It will be necessary for all K&N® high flow intake systems to be checked periodically for realignment, clearance and tightening of all connections. Failure to follow the above instructions or proper maintenance may void warranty.

ROAD TESTING:

1. Start the engine with the transmission in neutral or park, and the parking brake engaged. Listen for air leaks or odd noises. For air leaks secure hoses and connections. For odd noises, find cause and repair before proceeding. This kit will function identically to the factory system except for being louder and much more responsive.

2. Test drive the vehicle. Listen for odd noises or rattles and fix as necessary.

3. If road test is fine, you can now enjoy the added power and performance from your kit.

4. K&N Engineering, Inc., suggests checking the air filter element periodically for excessive dirt build-up. When the element becomes covered in dirt (or once a year), service it according to the instructions on the Recharger® service kit, part number 99-5050 or 99-5000