



# TYPHOON INTAKE SYSTEMS

NOT LEGAL FOR SALE OR USE ON ANY POLLUTION CONTROLLED MOTOR VEHICLE IN CALIFORNIA OR STATES ADOPTING CALIFORNIA EMISSION PROCEDURES.

## INSTALLATION INSTRUCTIONS

**69-7084TS**  
**NISSAN / INFINITI**  
**2017-18 Pathfinder / QX60**  
**V6-3.5L**

**TOOLS NEEDED:**

- Flat Blade screw driver
- Phillips screw driver
- Ratchet
- Extension
- 8mm socket
- 10mm socket
- 3mm allen
- 4mm allen

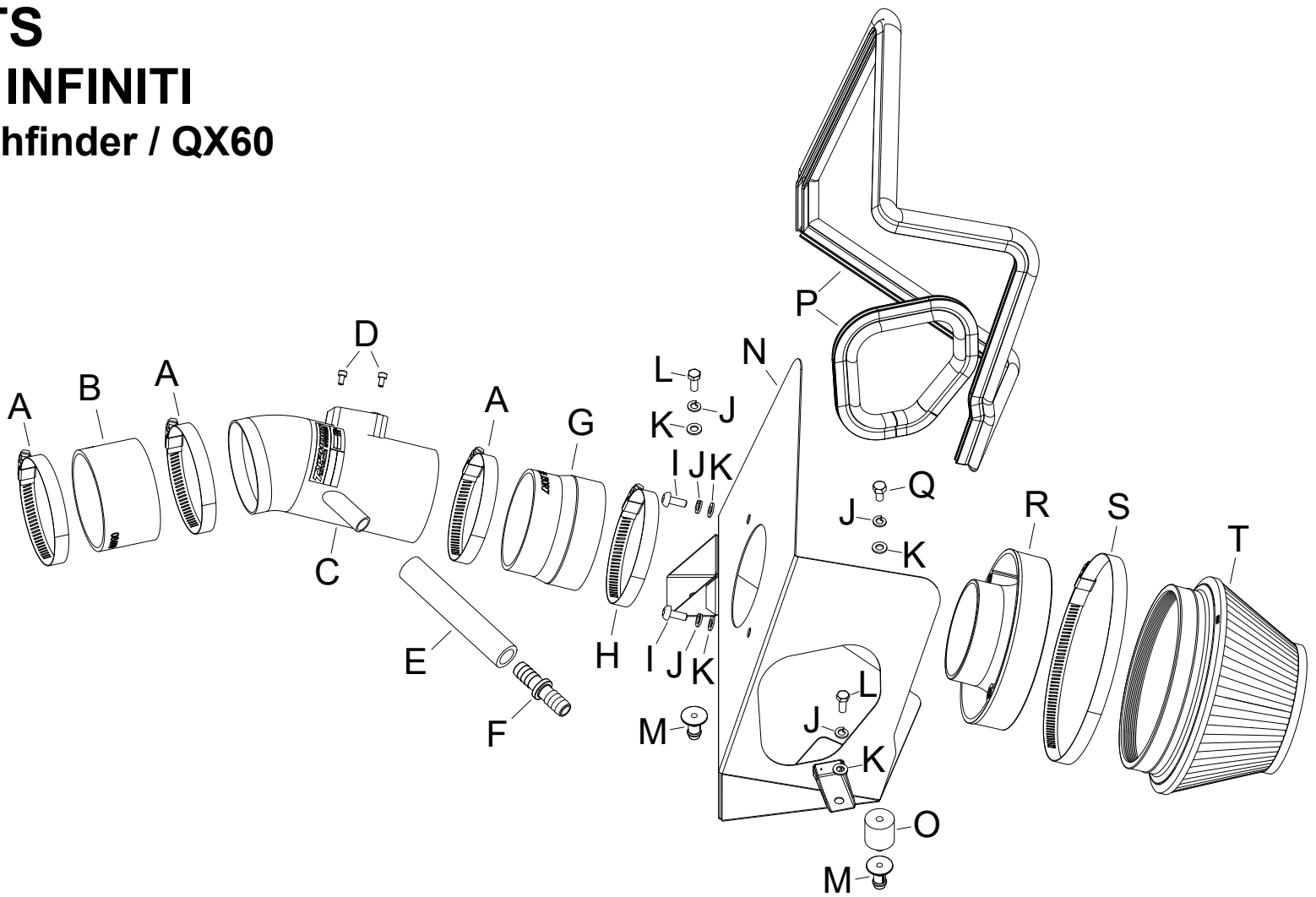

**PARTS LIST:**

Description	Qty.	Part #	Description	Qty.	Part #	Description	Qty.	Part #
A HOSE CLAMP; #52	3	08610	H HOSE CLAMP; #56	1	08620	O STUD; RUBBER MOUNT, M6	1	02033
B HOSE; 3.25"ID X 2"L REIN	1	08690	I BOLT; M6 X 1.00 X 16MM, SS	2	07730	P EDGE TRIM (61")	1	102492
C INTAKE TUBE	1	25804S	J WASHER; M6 SPLIT LOCK ZINC	5	1-3025	Q BOLT; M6 X 1.00 X 12MM, SS	1	07727
D BOLT; M4 - 0.07 8MM, A/H CAP	2	07733	K WASHER; 6MM FLAT, SS	5	08269	R ADAPTER; UNIVERSAL, 6"	1	21512-1
E HOSE; 5/8"ID X 5"L	1	08538	L BOLT; 6MM-1.00 X 16MM, SS	2	07812	S HOSE CLAMP; #104	1	08697
F HOSE MENDER; 1/2" BARBED	1	08686	M MOUNT, PLASTIC AIRBOX	2	8-186-1	T FILTER CHARGER	1	RU-4600
G HOSE; 3.5"ID TO 3.25"ID X 2.5"L	1	08496	N HEAT SHIELD	1	073261			

**NOTE: FAILURE TO FOLLOW INSTALLATION INSTRUCTIONS AND NOT USING THE PROVIDED HARDWARE MAY DAMAGE THE INTAKE TUBE, THROTTLE BODY AND ENGINE.**

**TO START:**

1. Turn off the ignition and disconnect the negative battery cable.  
**NOTE: Disconnecting the negative battery cable erases pre-programmed electronic memories. Write down all memory settings before disconnecting the negative battery cable. Some radios will require an anti-theft code to be entered after the battery is reconnected. The anti-theft code is typically supplied with your owner's manual. In the event your vehicles anti-theft code cannot be recovered, contact an authorized dealership to obtain your vehicles anti-theft code.**



2. Remove the two bolts that secure the fresh air duct and then remove the fresh air duct from the vehicle.



3. Release the spring clamp and then disconnect the negative battery cable.



4. Loosen the hose clamp that secures the factory intake tube to the air filter housing.



5. Remove the bolt which secures the air filter housing to the mount.



6. Partially remove the air filter housing to access the transmission vent line, mass air sensor and wiring harness, disconnect the mass air sensor and wiring harness and trans mission vent line and then remove the air filter housing from the vehicle.  
**NOTE: K&N Engineering, Inc., recommends that customers do not discard factory air intake.**



7. Loosen the hose clamp securing the factory intake tube to the throttle body and then remove it from the vehicle.



8. Remove the mass air sensor from the factory air box and then install it into the K&N intake tube and secure with the provided hardware.



9. Install coupler hose (08690) onto the throttle body and secure with the provided hose clamp. Then install the K&N intake tube into the coupling hose as shown.

**NOTE: Do not completely tighten the hose clamps at this time.**



10. Install the heat shield mounts and rubber mounted stud onto the heat shield as shown.

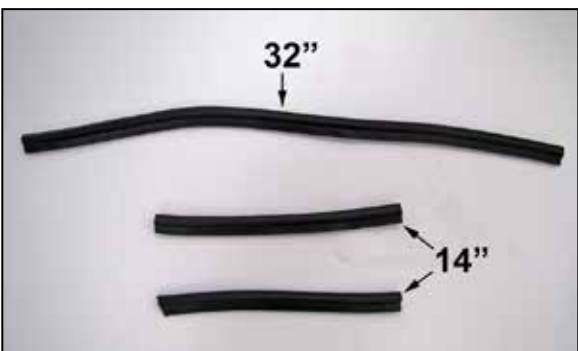

11. Cut the provided edge trim into the lengths of 32", two sections of 14".

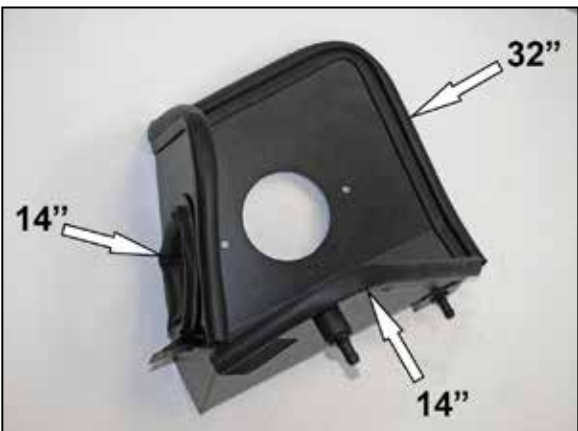

12. Install the edge trim onto the heat shield as shown.



13. Install the K&N filter adapter into the heat shield and secure with the provided hardware.



14. Install the provided coupler hose (08496) onto the filter adapter and secure with the provided hose clamp.



15. Install the heat shield assembly into the vehicle so the mounting studs insert into the factory air filter housing mounting studs and the intake tube inserts into the coupling hose. Secure the heat shield with the provided hardware then adjust the intake tube for best fit and secure with the provided hose clamps.



16. Install the provided hose mender into the provided crankcase vent hose as shown.



17. Install the hose mender into the factory crankcase vent hose and secure with the factory spring clamp then connect the open end of the hose to the port on the K&N intake tube.



18. Install the K&N air filter onto the adapter and secure with the provided hose clamp.



19. Reinstall the fresh air duct so it inserts slightly into the K&N heat shield then secure with the factory hardware.



20. Reconnect the vehicle's negative battery cable. Double check to make sure everything is tight and properly positioned before starting the vehicle.

21. It will be necessary for all K&N high flow intake systems to be checked periodically for realignment, clearance and tightening of all connections. Failure to follow the above instructions or proper maintenance may void warranty.

**ROAD TESTING:**

1. Start the engine with the transmission in neutral or park, and the parking brake engaged. Listen for air leaks or odd noises. For air leaks secure hoses and connections. For odd noises, find cause and repair before proceeding. This kit will function identically to the factory system except for being louder and much more responsive.

2. Test drive the vehicle. Listen for odd noises or rattles and fix as necessary.

3. If road test is fine, you can now enjoy the added power and performance from your kit.

4. K&N Engineering, Inc., requires cleaning the intake system's air filter element every 100,000 miles. When used in dusty or off-road environments, our filters will require cleaning more often. We recommend that you visually inspect your filter once every 25,000 miles to determine if the screen is still visible. When the screen is no longer visible some place on the filter element, it is time to clean it. To clean and re-oil, purchase our filter Recharger service kit, part number 99-5050 or 99-5000 and follow the easy instructions.

**NOT LEGAL FOR SALE OR USE ON ANY POLLUTION CONTROLLED MOTOR VEHICLE IN CALIFORNIA OR STATES ADOPTING CALIFORNIA EMISSION PROCEDURES.**