

K&N TYPHOON INTAKE SYSTEMS

INSTALLATION INSTRUCTIONS

69-5303TS HYUNDAI 2011-13 Elantra L4-1.8L

TOOLS NEEDED:

Ratchet
Extension
10mm Socket
8mm Socket
Pliers
Flat Blade Screwdriver
4mm Allen Wrench

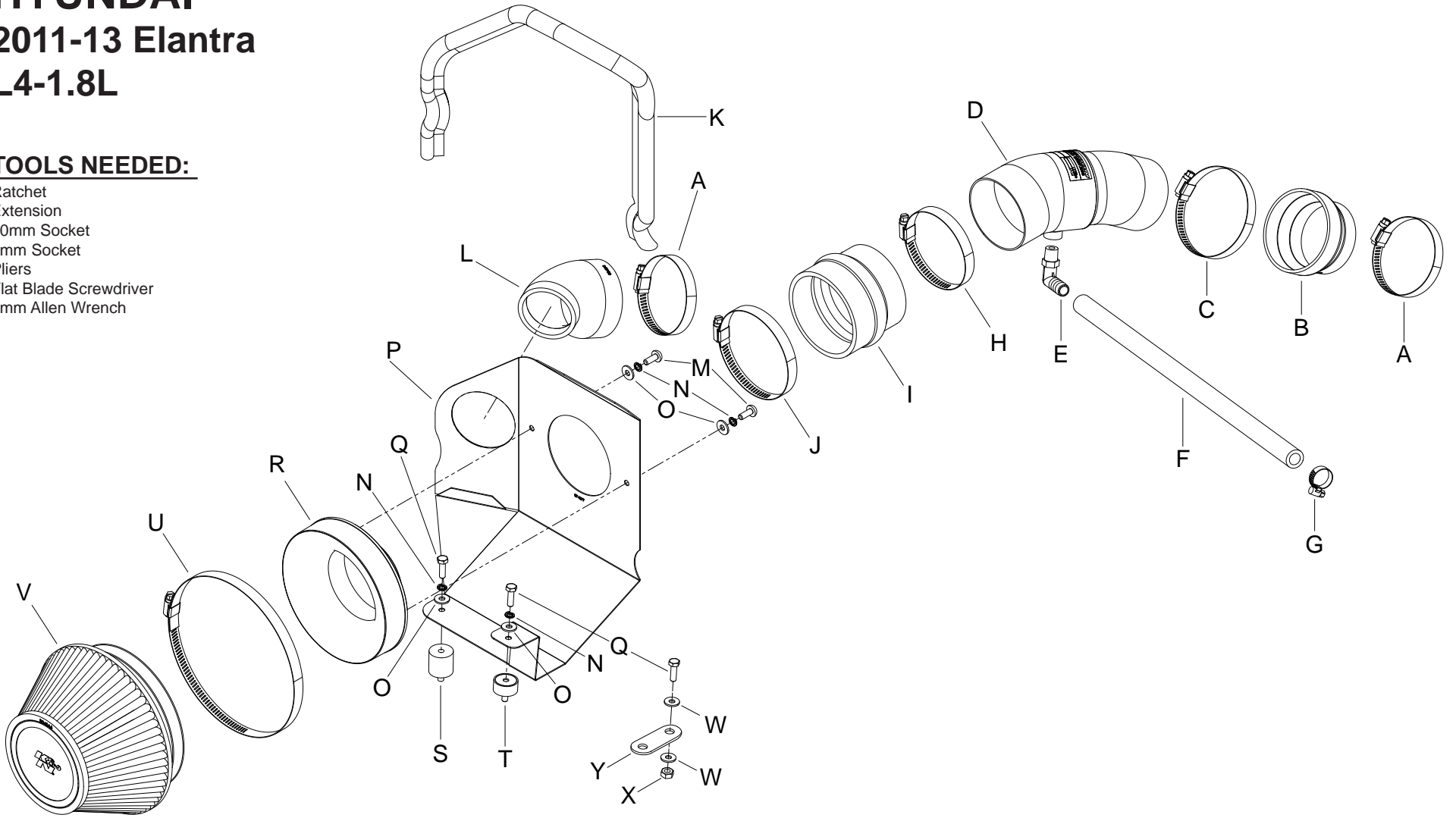

PARTS LIST:

Description	Qty.	Part #	Description	Qty.	Part #	Description	Qty.	Part #
A Hose Clamp #44 Stainless	2	08560	J Hose Clamp #56	1	08620	S Stud; Rubber Mount, M6 X 1, 1" T, M/F	1	02033
B Hose; 3" To 2-3/4" ID X 2" L TPRD Reinforced	1	084036	K Edge Trim (35")	1	102471	T Stud; Rubber Mount, M/F, 1/2" L X 1" W	1	070228
C Hose Clamp #48	1	08601	L Hose; 2-7/8" to 2-1/8" ID X 4-1/4" L 40 DEG	1	084096	U Hose Clamp #104	1	08697
D Intake Tube	1	27496TS	M Bolt; M6 X 1.00 X 16MM, Buttonhead, SS	2	07730	V Air Filter	1	RU-4600
E Vent; 90 DEG, 1/2" Hose, 1/4 NPT, Black	1	08110FK	N Washer; M6 Split Lock Zinc	4	1-3025	W Washer	2	08275
F Hose; 1/2" ID X 19" L	1	084075	O Washer; 6MM Flat, SS	4	08269	X Nut	1	07506
G Hose Clamp #6 Mini	1	08407	P Heat Shield	1	074097	Y Bracket	1	07133
H Hose Clamp #52	1	08610	Q Bolt; 6MM-1.00 X 16MM, SS	3	07812			
I Hose; Hump 3.25/3.50 X 3.00"	1	5-576	R Adapter; Universal, 6" Filter 3.5" Coupler	1	21512-1			

NOTE: FAILURE TO FOLLOW INSTALLATION INSTRUCTIONS AND NOT USING THE PROVIDED HARDWARE MAY DAMAGE THE INTAKE TUBE, THROTTLE BODY AND ENGINE.

TO START:

1. Turn off the ignition and disconnect the negative battery cable.

NOTE: Disconnecting the negative battery cable erases pre-programmed electronic memories. Write down all memory settings before disconnecting the negative battery cable. Some radios will require an anti-theft code to be entered after the battery is reconnected. The anti-theft code is typically supplied with your owner's manual. In the event your vehicles' anti-theft code cannot be recovered, contact an authorized dealership to obtain your vehicles anti-theft code.



2. Lift up the engine cover and remove it from the vehicle.

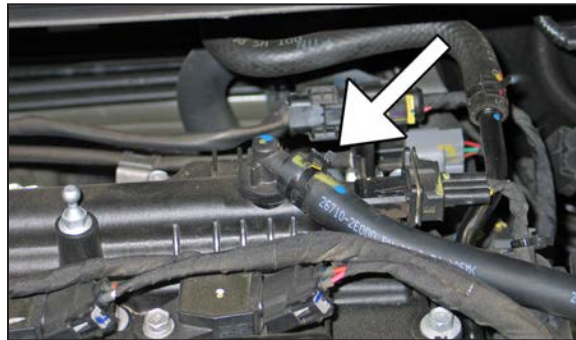

3. Release the spring clamp that secures the crank case vent hose to the valve cover port and then disconnect the crank case vent hose from the valve cover.



4. Loosen the hose clamp that secures the intake tube to the throttle body.

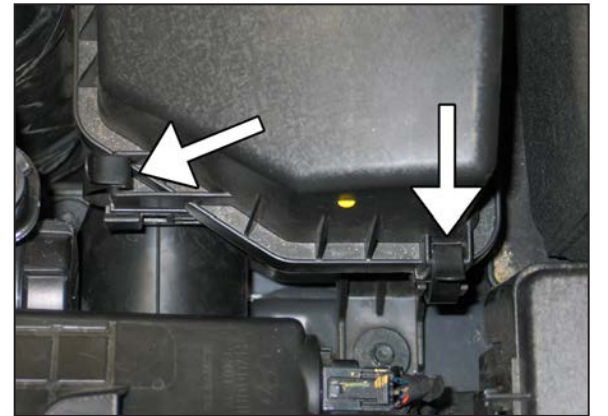

5. Release the two upper air box retaining clips.



6. Remove the upper air box/intake hose assembly from the vehicle.

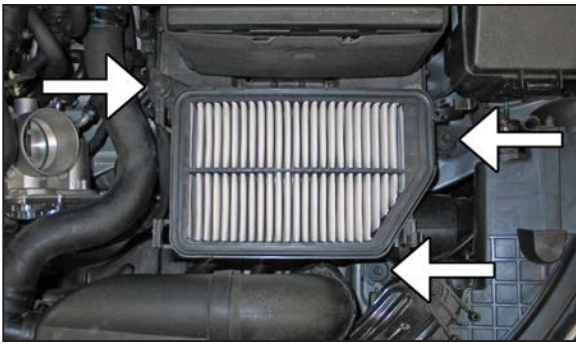

7. Remove the three bolts that secure the lower air box vehicle.



8. Remove the lower air box assembly from the vehicle.

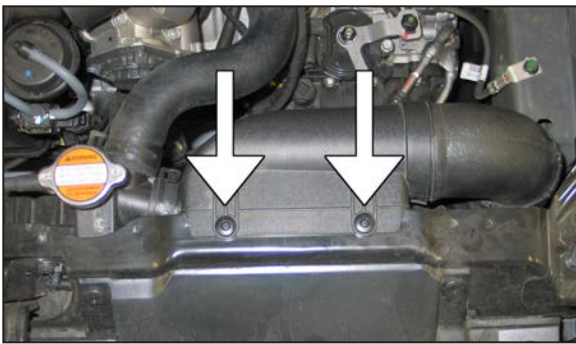

9. Push the centers of the fresh air duct retaining pins down to release the clips.



10. Remove the fresh air intake duct from the vehicle.



11. Remove the fresh air duct from the fresh air scoop.

NOTE: K&N Engineering, Inc., recommends that customers do not discard factory air intake.

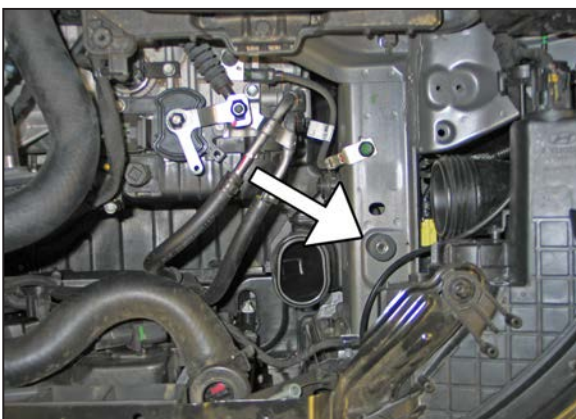

12. Install the 1" rubber mounted stud as shown into the front air box mounting location.



2012 and earlier



2013 and later

13. Install the 1/2" rubber mounted stud into the rear/inner air box mounting box location.
NOTE: On 2011 and 2012 model year vehicles, the rubber mounted stud will go into the inner most threaded hole. On 2013 and later vehicles this position was eliminated and the rubber mounted stud is to be installed in the remaining position.

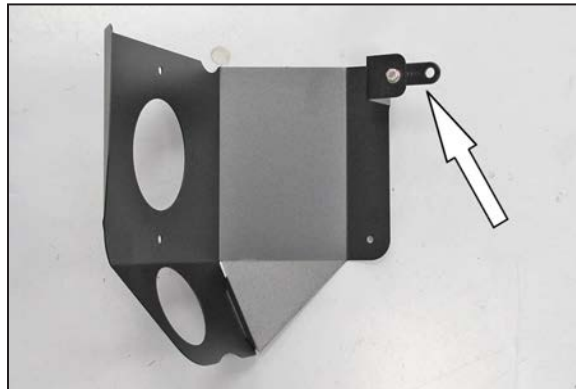

13a. On 2013 and later model vehicles, install the provided bracket (07133) onto the heat shield as shown,

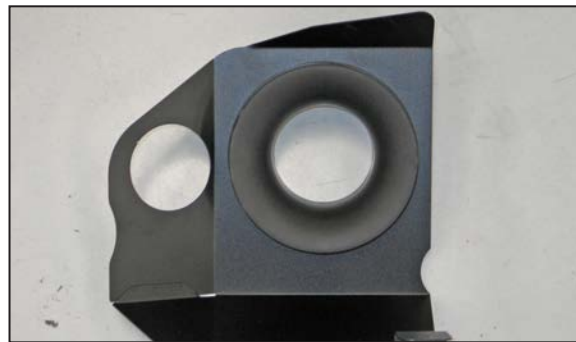

14. Install the filter adapter into the heat shield and secure with the provided hardware.

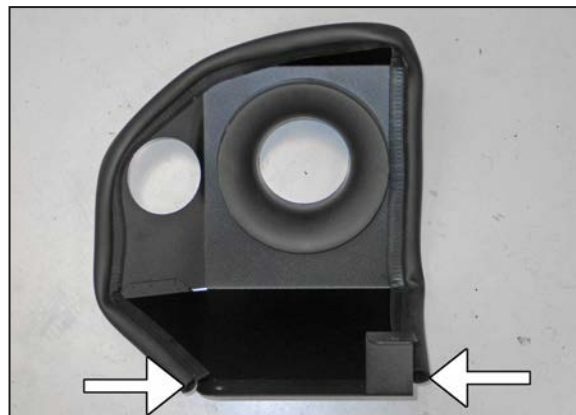

15. Install the provided edge trim onto the heat shield as shown.
NOTE: Some trimming of the edge trim will be necessary.

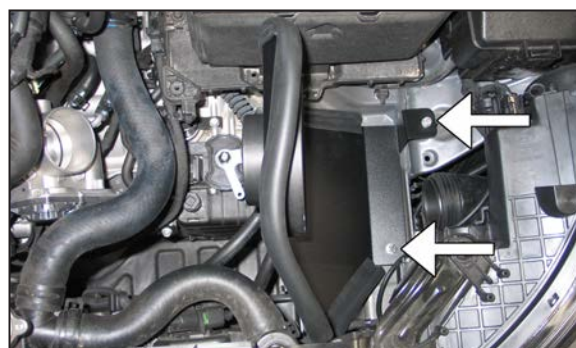

16. Install the heat shield onto the previously installed rubber mounted studs and secure with the provided hardware.



17. Install the provided silicone hose (084036) onto the throttle body and secure with the provided hose clamp.



18. Install the provided hump hose (5-576) onto the filter adapter and secure with the provided hose clamp.



19. Install the provided 90° vent fitting into the K&N® intake tube as shown.
NOTE: Plastic NPT fittings are easy to cross thread. Install the vent fitting "hand" tight, then turn it two complete turns with a wrench.



20. Install the K&N® intake tube into the silicone hump hose and then into the silicone hose attached to the throttle body. Secure with the provided hardware.



21. Install the silicone hose (084096) onto the fresh air intake scoop and secure with the provided hose clamp.



22. Install the fresh air intake scoop assembly so the silicone hose passes through the hole in the heat shield, then secure with the factory retaining clips.

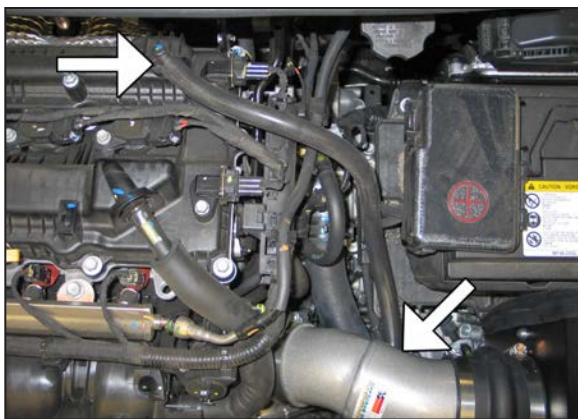

23. Install the provided crank case vent hose onto the 90° fitting in the K&N® intake tube. Attach the opposite end to the valve cover vent port.



24. Install the K&N® air filter and secure with the provided hose clamp.



25. Reinstall the engine cover.



26. Reconnect the vehicle's negative battery cable. Double check to make sure everything is tight and properly positioned before starting the vehicle.

27. It will be necessary for all K&N® high flow intake systems to be checked periodically for realignment, clearance and tightening of all connections. Failure to follow the above instructions or proper maintenance may void warranty.

ROAD TESTING:

1. Start the engine with the transmission in neutral or park, and the parking brake engaged. Listen for air leaks or odd noises. For air leaks secure hoses and connections. For odd noises, find cause and repair before proceeding. This kit will function identically to the factory system except for being louder and much more responsive.

2. Test drive the vehicle. Listen for odd noises or rattles and fix as necessary.

3. If road test is fine, you can now enjoy the added power and performance from your kit.

4. K&N Engineering, Inc., requires cleaning the intake system's air filter element every 100,000 miles. When used in dusty or off-road environments, our filters will require cleaning more often. We recommend that you visually inspect your filter once every 25,000 miles to determine if the screen is still visible. When the screen is no longer visible some place on the filter element, it is time to clean it. To clean and re-oil, purchase our filter Recharger® service kit, part number 99-5050 or 99-5000 and follow the easy instructions.