



# TYPHOON INTAKE SYSTEMS

## INSTALLATION INSTRUCTIONS

**69-4530TS  
CADILLAC  
2009-15 CTS-V  
V8-6.2L SC**

**TOOLS NEEDED:**

- Flat Blade Screw driver
- 10mm socket Ratchet
- Extension
- T15 TORX
- T25 TORX
- Pliers

**PARTS LIST:**

Description	Qty.	Part #
A HOSE CLAMP #64 STAINLESS	4	08645
B HOSE; 4" ID X 1-1/2" L	1	08755
C INTAKE TUBE	1	27563
D VENT; 90°, 1/4NPT TO .375"	1	82632
E BOLT; M4 - 0.07 8MM, A/H CAP	2	07733
F HOSE; 4" ID X 3" L HUMP	1	08418
G EDGE TRIM (39")	1	102496
H INSERT; 3/8-16 X 3/400 X 15/16L	1	08163
I BRACKET; "L", 69-4530, STL	1	064328
J WASHER; 3/8" FLAT WASHER	1	08134
K BOLT; 3/8"-16 X 1-1/4" L SS HEX	1	07779
L BOLT; 6MM-1.00 X 16MM, SS	3	07812
M WASHER; 6MM FLAT, SS	9	08269
N NUT; 6MM NYLOCK, HEXHEAD	2	07512
O BOLT; M6 X 1.00" 12MM, SS	4	07794
P WASHER, M6 SPLIT LOCK ZINC	5	1-3025
Q HEAT SHIELD	1	073189
R THREADED BOSS; 5/8"OD	2	081004
S CABLE TIE; 6", BLACK	1	21594
T BRACKET; "L", 69-4530, STL	1	064329
U ADAPTOR; 57-3058 #454	1	27300
V HOSE CLAMP #104	1	08697
W FILTER CHARGER	1	RC-5138

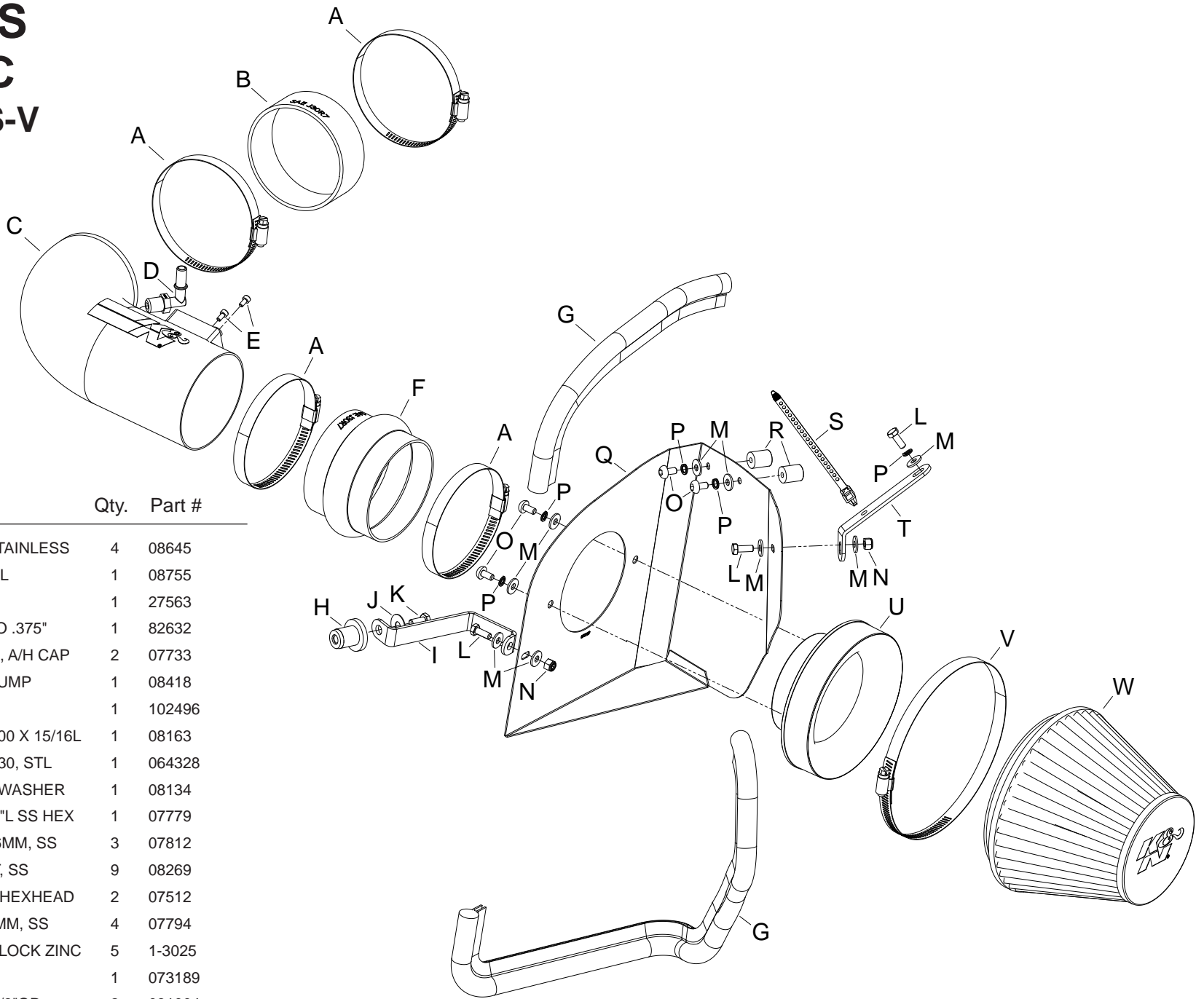

**NOTE: FAILURE TO FOLLOW INSTALLATION INSTRUCTIONS AND NOT USING THE PROVIDED HARDWARE MAY DAMAGE THE INTAKE TUBE, THROTTLE BODY AND ENGINE.**

**TO START:**

1. Turn off the ignition and disconnect the negative battery cable.  
**NOTE: Disconnecting the negative battery cable erases pre-programmed electronic memories. Write down all memory settings before disconnecting the negative battery cable. Some radios will require an anti-theft code to be entered after the battery is reconnected. The anti-theft code is typically supplied with your owner's manual. In the event your vehicles anti-theft code cannot be recovered, contact an authorized dealership to obtain your vehicles anti-theft code.**



2. Lift up and remove the decorative engine cover.



3. Lift up and remove the decorative strut tower cover.



4. Disconnect the mass air sensor electrical connection.



5. Disconnect the crank case vent line from the factory quick disconnect fitting.

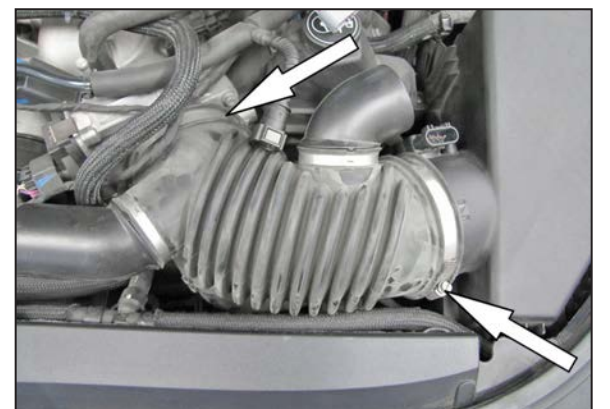

6. Loosen the two hose clamps securing the factory intake tube and remove the intake tube from the vehicle.



7. Release the coolant hose retaining clip, remove the bolt that secures the air box and then move the coolant hose from in front of the air filter housing and inner fender for clearance.



8. Lift up and remove the air filter housing from the vehicle.  
**NOTE: Be patient and use care while removing the air filter housing. It is a tight fit and will require some manipulation to get it removed.**  
**NOTE: K&N Engineering, Inc., recommends that customers do not discard factory air intake.**



9. Install the provided filter adapter into the K&N® heat shield as shown and secure with the provided hardware.

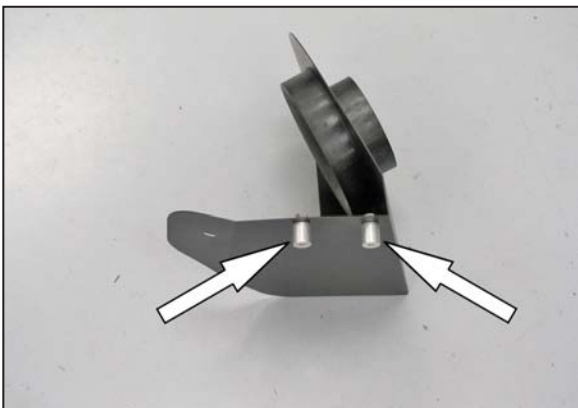

10. Install the two provided cover mounting posts to the heatshield as shown.

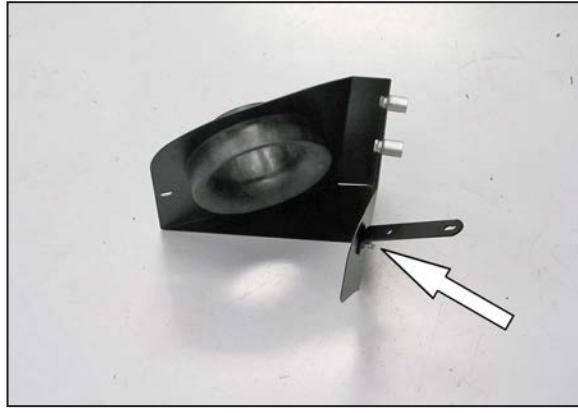

11. Install the heat shield mounting bracket (064329) onto the heat shield using the provided hardware.

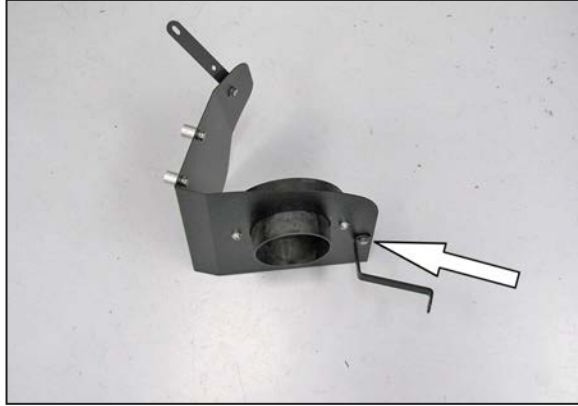

12. Install the heat shield mounting bracket (064328) onto the heat shield and secure with the provided hardware.

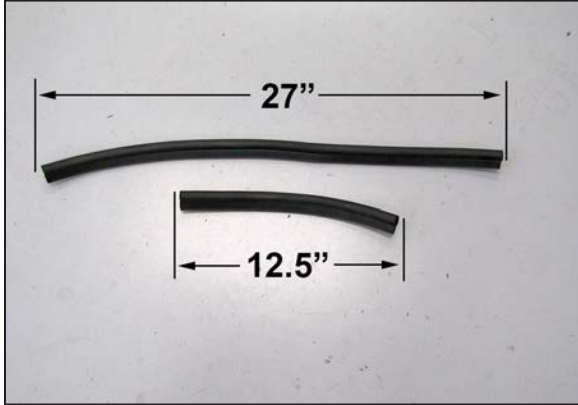

13. Cut the provided edge trim into two sections, one section will be 12-1/2" long and the other section will be 27" long.



14. Install the provided edge trim onto the heat shield as shown.



15. Install the inserted nut onto the mounting bracket as shown.



16. Install the heat shield into the engine compartment so the inserted nut goes into the front air box mount and the bracket aligns with the air filter housing mounting location.

**NOTE: Do not tighten the mounting brackets at this time.**

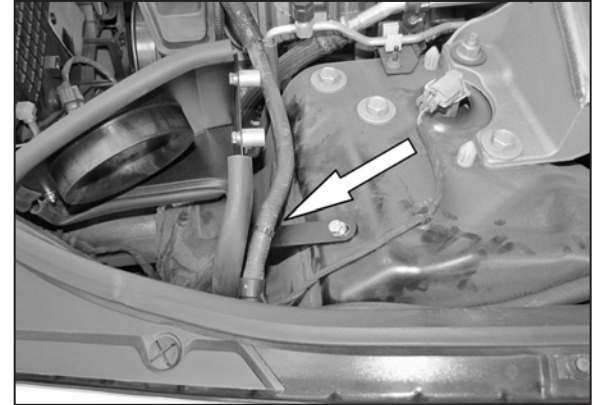

17. Secure the coolant hose to the heat shield mounting bracket using the provided mounting head tie wrap as shown.



18. Install the K&N® air filter onto the adapter and secure with the provided hose clamp. Then tighten the heat shield mounting brackets.



19. Install the provided coupling hose (08755) onto the throttle body and secure with the provided hose clamp.



20. Install the provided hump coupler (08418) onto the filter adapter and secure with the provided hose clamp.



21. Remove the two screws securing the mass air sensor into the factory air filter housing and then remove the sensor from the housing.



22. Install the mass air sensor into the K&N® intake tube and secure with the provided hardware.



23. Install the 90° quick disconnect fitting into the K&N® intake tube as shown.

**NOTE: Plastic NPT fittings are easy to cross thread. Install the vent fitting "hand" tight, then turn it two complete turns with a wrench.**



24. Install the intake tube into the coupling hose at the filter adapter and then into the hose at the throttle body, adjust the hose for best fit and then secure with the provided hose clamps.



25. Reconnect the mass air sensor electrical connection.



26. Connect the crank case vent hose to the quick disconnect fitting.



27. Reinstall the strut tower cover.



28. Reinstall the decorative engine cover.



29. Reconnect the vehicle's negative battery cable. Double check to make sure everything is tight and properly positioned before starting the vehicle.

30. It will be necessary for all K&N® high flow intake systems to be checked periodically for realignment, clearance and tightening of all connections. Failure to follow the above instructions or proper maintenance may void warranty.

#### ROAD TESTING:

1. Start the engine with the transmission in neutral or park, and the parking brake engaged. Listen for air leaks or odd noises. For air leaks secure hoses and connections. For odd noises, find cause and repair before proceeding. This kit will function identically to the factory system except for being louder and much more responsive.

2. Test drive the vehicle. Listen for odd noises or rattles and fix as necessary.

3. If road test is fine, you can now enjoy the added power and performance from your kit.

4. K&N Engineering, Inc., requires cleaning the intake system's air filter element every 100,000 miles. When used in dusty or off-road environments, our filters will require cleaning more often. We recommend that you visually inspect your filter once every 25,000 miles to determine if the screen is still visible. When the screen is no longer visible some place on the filter element, it is time to clean it. To clean and re-oil, purchase our filter Recharger® service kit, part number 99-5050 or 99-5000 and follow the easy instructions.