



AIRCHARGER®

HIGH-FLOW INTAKE KITS

INSTALLATION INSTRUCTIONS

63-3096

CADILLAC

2016-17 CTS-V

V8-6.2L Supercharged

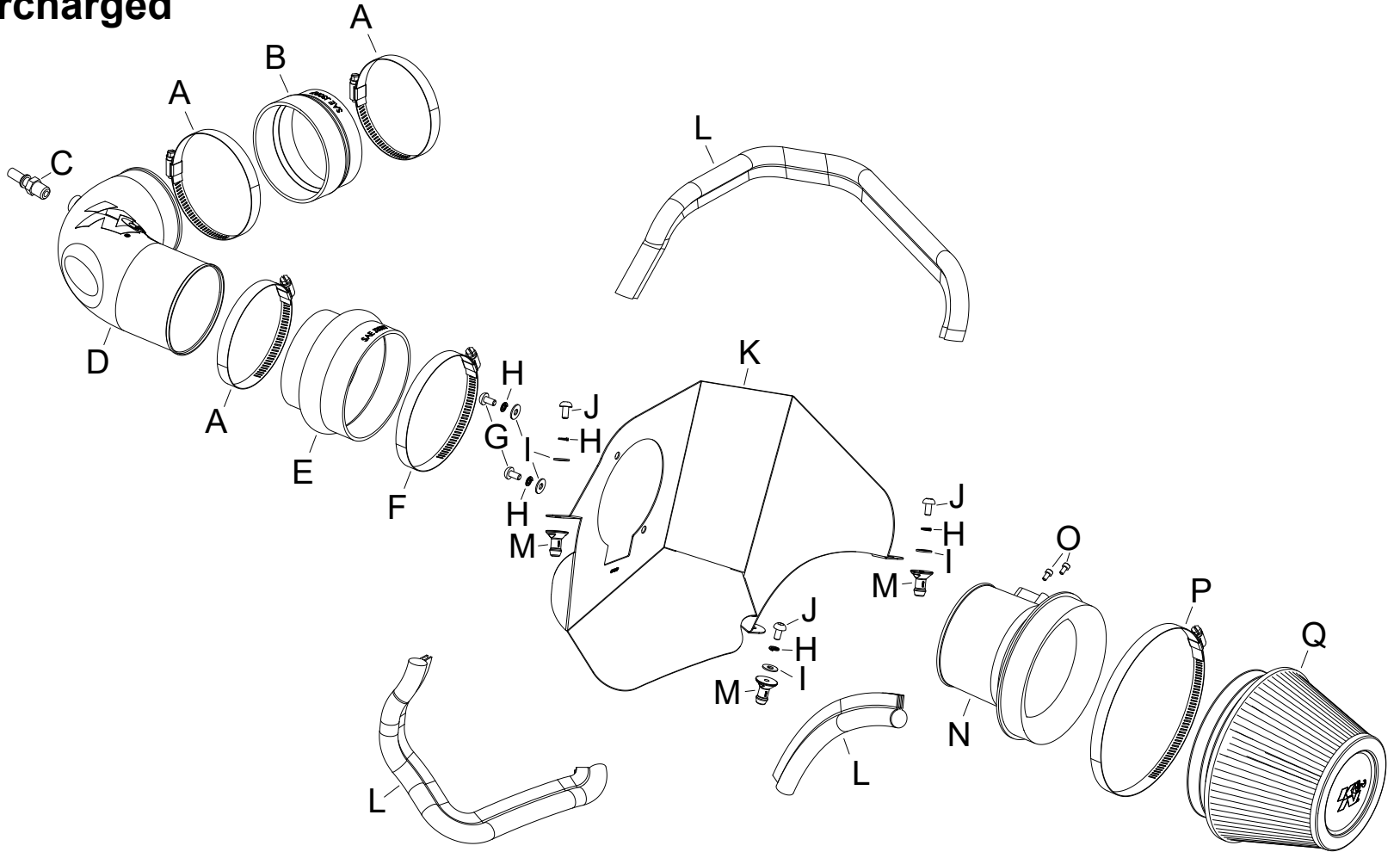

TOOLS NEEDED:

- 10mm wrench
- 5/8" wrench
- 3mm allen key
- 4mm allen key
- t20 torx
- flat blade screw driver

PARTS LIST:

Description	Qty.	Part #	Description	Qty.	Part #	Description	Qty.	Part #
A HOSE CLAMP #64, BLACK ZINC	3	08645K	G BOLT; M6 X 1.00" 12MM, SS	2	07794	M MOUNT, PLASTIC AIRBOX	3	8-186-1
B HOSE; 4" TO 3-13/16" ID X 2" L	1	08618	H WASHER, M6 SPLIT LOCK ZINC	5	1-3025	N ADAPTER; MAF SENSOR	1	088035
C VENT; STRT, 1/4" NPT	1	08938	I WASHER; 6MM FLAT, SS	5	08269	O BOLT; M4 - 0.07 8MM, A/H CAP	2	07733
D INTAKE TUBE	1	087337	J BOLT; M6 X 1.00 X 12MM, SS	3	07727	P HOSE CLAMP; #104	1	08697K
E HOSE; 4-1/2"ID TO 3-7/8"ID X3	1	084101	K HEAT SHIELD	1	073239	Q FILTER CHARGER	1	RP-2960
F HOSE CLAMP #72, BLACK ZINC	1	08671K	L EDGE TRIM (55")	1	102480			

NOTE: FAILURE TO FOLLOW INSTALLATION INSTRUCTIONS AND NOT USING THE PROVIDED HARDWARE MAY DAMAGE THE INTAKE TUBE, THROTTLE BODY AND ENGINE.

TO START:

1. Turn off the ignition and disconnect the negative battery cable.
NOTE: Disconnecting the negative battery cable erases pre-programmed electronic memories. Write down all memory settings before disconnecting the negative battery cable. Some radios will require an anti-theft code to be entered after the battery is reconnected. The anti-theft code is typically supplied with your owner's manual. In the event your vehicles anti-theft code cannot be recovered, contact an authorized dealership to obtain your vehicles anti-theft code.



2. Lift the decorative engine cover and remove it from the engine.



3. Disconnect the mass air sensor electrical connection.



4. Disconnect the crank case vent quick disconnect fitting.



5. Loosen the hose clamps that secure the factory intake hose to the throttle body and air filter housing.



6. Lift the air filter housing assembly and remove it from the vehicle.
NOTE: K&N Engineering, Inc., recommends that customers do not discard factory air intake.



7. Install the K&N® mass air housing into the heat shield and secure with the provided hardware.

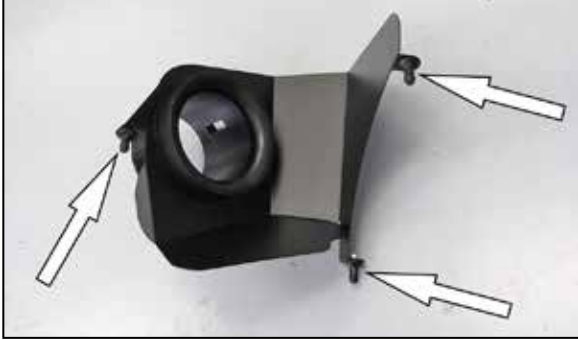

8. Install the provided heat shield mounting posts onto the heat shield and secure with the provided hardware.

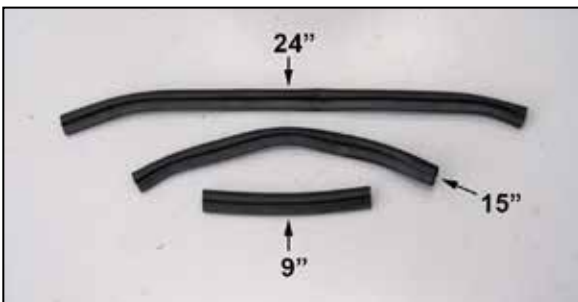

9. Cut the provided edge trim into three sections of 24", 15" and 9" as shown.



10. Install the edge trim onto the heat shield as shown.



11. Remove the mass air sensor from the factory air filter housing.



12. Install the mass air sensor into the K&N® air filter housing and secure with the provided hardware.



13. Install the heat shield assembly into the vehicle so that the mounting studs engage into the factory air filter housing mounting grommets.



14. Install the provided hump coupler hose (084101) onto the mass air sensor housing and secure with the provided hose clamp.



15. Install the provided coupler hose (08618) onto the throttle body and secure with the provided hose clamp.



16. Install the provided NPT quick disconnect fitting into the K&N® intake tube.

NOTE: Plastic NPT fittings are easy to cross thread. Install the vent fitting "hand" tight, then turn it two complete turns with a wrench.



17. Install the intake tube assembly into the hump coupler and then into the coupler at the throttle body, adjust the tube for best fit and then secure with the provided hose clamps.



18. Connect the crank case vent fitting to the quick disconnect fitting installed into the K&N® intake tube.



19. Connect the mass air sensor electrical connection.



20. Install the K&N® air filter and secure with the provided hose clamp.



21. Reinstall the decorative engine cover.



19. Reconnect the vehicle's negative battery cable. Double check to make sure everything is tight and properly positioned before starting the vehicle.

20. It will be necessary for all K&N® high flow intake systems to be checked periodically for realignment, clearance and tightening of all connections. Failure to follow the above instructions or proper maintenance may void warranty.

ROAD TESTING:

1. Start the engine with the transmission in neutral or park, and the parking brake engaged. Listen for air leaks or odd noises. For air leaks secure hoses and connections. For odd noises, find cause and repair before proceeding. This kit will function identically to the factory system except for being louder and much more responsive.

2. Test drive the vehicle. Listen for odd noises or rattles and fix as necessary.

3. If road test is fine, you can now enjoy the added power and performance from your kit.

4. K&N Engineering, Inc., requires cleaning the intake system's air filter element every 100,000 miles. When used in dusty or off-road environments, our filters will require cleaning more often. We recommend that you visually inspect your filter once every 25,000 miles to determine if the screen is still visible. When the screen is no longer visible some place on the filter element, it is time to clean it. To clean and re-oil, purchase our filter Recharger® service kit, part number 99-5050 or 99-5000 and follow the easy instructions.