

BMW 125i F20/21 N20 engine 2012-5/2016

BMW 220i/228i F22/23/87 N20 engine 2014-5/2016

BMW 320i/328i F30/31 N20 engine 2012-7/2015 BMW320iGT/328iGT N20 engine 2013-5/2016

BMW 420i/428i F32/33/36 N20 engine 2013-2016

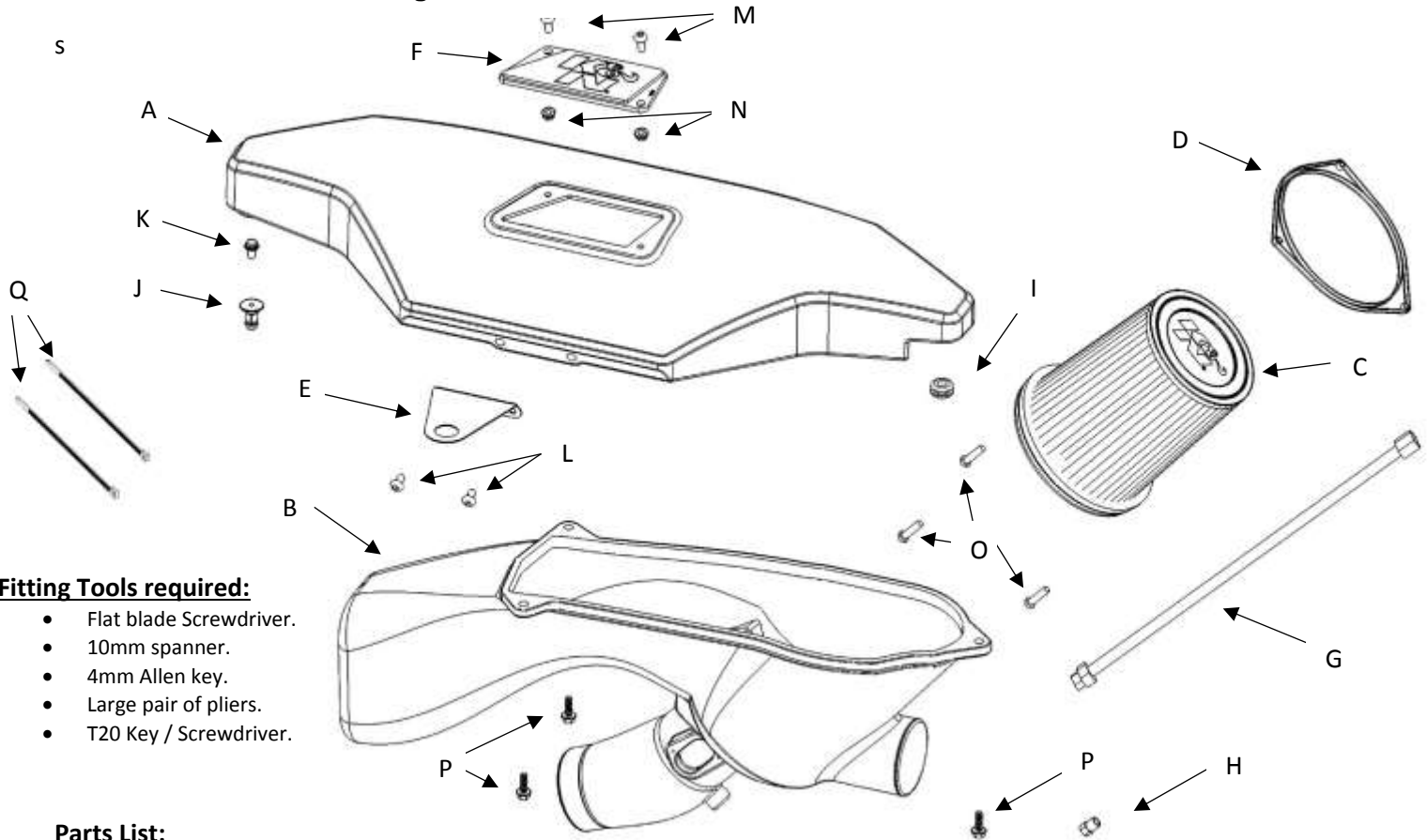

**Fitting Tools required:**

- Flat blade Screwdriver.
- 10mm spanner.
- 4mm Allen key.
- Large pair of pliers.
- T20 Key / Screwdriver.

**Parts List:**

No	Part Number	Description	QTY.
A	9-0449	AIRBOX LID; 57S-2001	1
B	9-0450	AIRBOX BASE; 57S-2001	1
C	RF-5289	AIR FILTER	1
D	7-349	FILTER RETAINER RING	1
E	7-345	AIRBOX PLATE	1
F	08351	K&N LOGO PLATE CLEAR	1
G	8-198	MAS EXTENSION HARNESS WIRE	1
H	08178	PLUG 1/8 NPT PLASTIC	1
I	784638	RUBBER MOUNTING GROMMET	1
J	8-186-1	PLASIC AIRBOX MOUNT	1
K	22224	BOLT M6 X 12MM HEX	1
L	07794	BOLT M6 X 12MM ALLEN	2
M	07730	BOLT M6 x 16MM ALLEN	2
N	44.460.04	NUT M6	2
O	07729	BOLT M6 X 25MM ALLEN	3
P	1-2038	BOLT M6 X 20MM FLANGE	3
Q	21591	CABLE TIE	2



# 57s-2001



## Installation Instructions

1. Unclip the hood release cable from the air filter housing. (Fig. 1)
2. Unclip and remove the electrical plug from the MAS (mass air flow sensor). (Fig. 2)
3. Loosen the hose clamp and remove the intake pipe from the air filter housing. (Fig. 3)
4. Carefully pull the air filter housing assembly out of its mounting grommets and remove the air filter housing from the vehicle. (Fig. 4)
5. Loosen the hose clamp of the intake pipe and unclip the coolant hose from the inlet pipe. (Fig. 5)
6. Remove the inlet pipe from the vehicle. (Fig. 6)
7. Unscrew the MAS from the air filter housing as shown. (Fig. 7)
8. Mount the MAS into the K&N air filter housing base using its original screws. Clean out the inside of the air filter housing making sure no debris is left in the air filter housing. (Fig. 8)
9. Fit the NPT plug into the new K&N intake tube **NOTE:** Plastic vents are easy to cross thread. Install the vent "hand" tight, then turn it two complete turns with a wrench. (Fig. 9)
10. Fit the supplied steel retaining ring over the air filter. (Fig. 10)
11. Fit the filter into the air filter housing base and align the air filter retaining ring with the 3 holes in the air filter housing base. Secure the air filter retaining ring using the 3 M6 x 25mm Allen bolts supplied. Make sure the air filter flange is fitted all the way onto the air filter housing base.(Fig. 11)
12. Fit the MAS harness extension onto the MAS. (Fig. 12)
13. Fit the mounting support bracket onto the air box lid using the 2 M6 x 16 Allen bolts supplied. (Fig. 13)
14. Fit the clear K&N logo plate into the air filter housing lid using the 2 M6x16mm bolts and M6 nuts. (Fig. 14)
15. Fit the rubber grommet into the left air filter housing hole, and fit the plastic stud to the right hole using the M6x12mm bolt. (Fig. 15)
16. Remove the larger rubber grommet from the front of the car and fit this into the hole of the air filter housing lid support bracket as shown. (Fig. 16)
17. Rotate the original hose clamp of the intake hose for better access when securing it in the next step. A 50 degree rotation would be enough. (Fig. 17)
18. Place the air filter housing base into the engine bay make sure the fresh air feed is fitted into the air filter housing base, fit the air box inlet into the intake hose and secure the hose clamp firmly. (Fig.18)
19. Connect the MAS extension to the original MAS plug and secure the wire loom to the hood release cable using the cable ties supplied. (Fig. 19)
20. Fit the air filter housing lid onto the air filter housing base using the 3 M6x20mm bolts supplied. (Fig. 20)
21. Carry out a final height alignment check of the kit fitment and make sure all hardware is secured, installation is now complete.



Fig.#1



Fig.#2



Fig.#3



Fig.#4



Fig.#5



Fig.#6



Fig.#7



Fig.#8



Fig.#9



Fig.#10



Fig.#11



Fig.#12



Fig.#13



Fig.#14



Fig.#15



Fig.#16



Fig.#17



Fig.#18



Fig.#19



Fig.#20