



INSTALLATION INSTRUCTIONS

77-2529KP

FORD / MAZDA

2001-03 Ranger / B4000

2001 Explorer

2001-03 Explorer Sport

*2001-04 Explorer Sport Trac

V6-4.0L SOHC

NOTE: This kit was not designed to fit vehicles with a body lift.

TOOLS NEEDED:

Ratchet
Extension
13mm Socket
10mm Socket
7mm Socket
5mm Allen
Flat Blade Screwdriver
5/8 drill bit
Drill

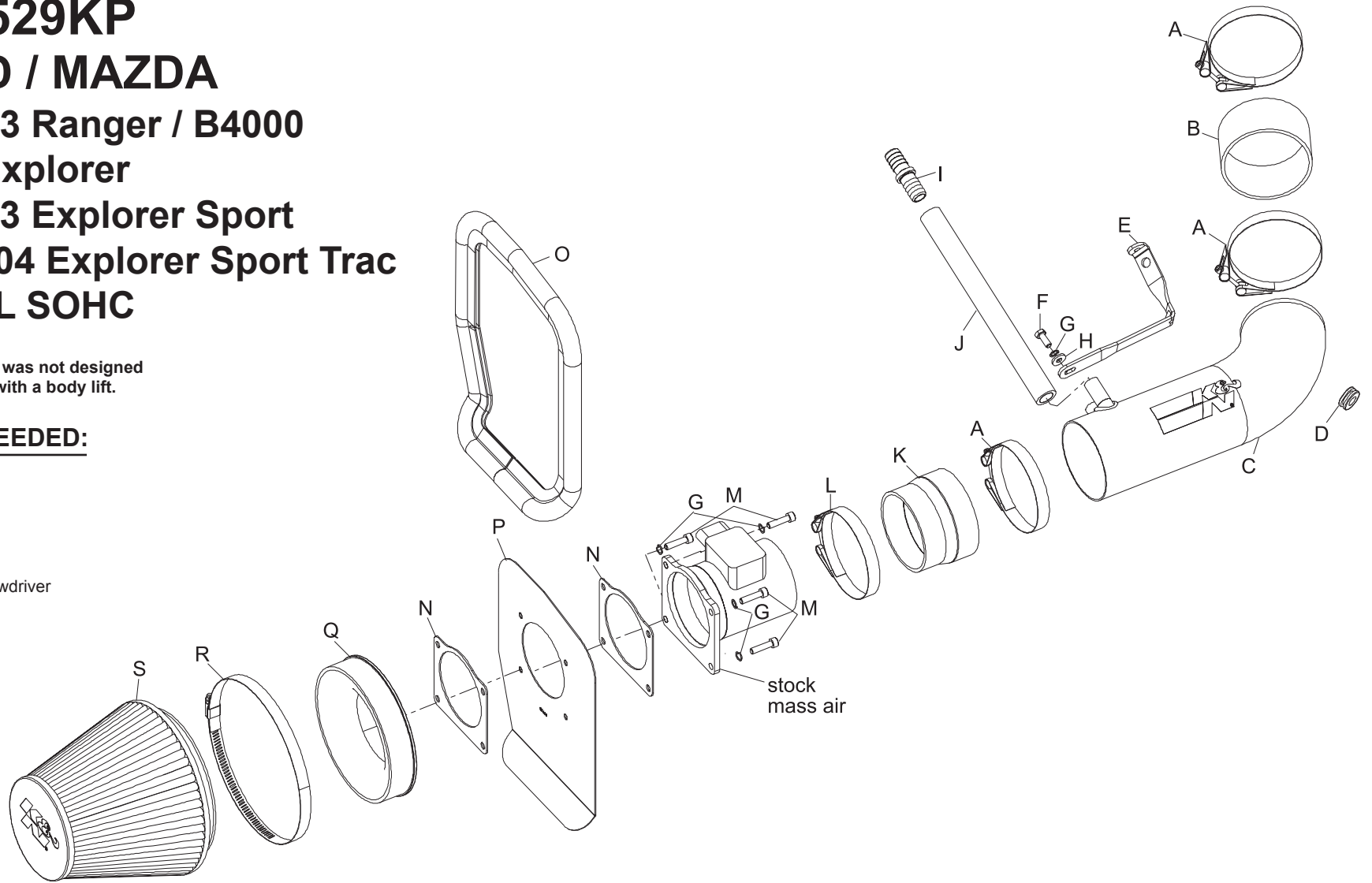

PARTS LIST:

Description	Qty.	Part #	Description	Qty.	Part #	Description	Qty.	Part #
A hose clamp #56	3	08620	H washer; 1/4"idx5/8"od flat	1	08275	O edge trim (33")	1	102498
B silicone hose	1	08630	I hose mender; 5/8"x 5/8"	1	08048	P heat shield	1	07444
C intake tube	1	27357	J silicone hose	1	084047	Q adapter #290	1	21504
D grommets	1	08092	K silicone hose	1	08051	R hose clamp #104	1	08697
E bracket "L"	1	070018	L hose clamp #52	1	08610	S air filter	1	RF-1048
F bolt; 6mm-1.00x16mm hex	1	07703	M bolts; 6mm-1.00 allen	4	07859			
G washer; 1/4" id split lock	5	08198	N mass air gasket	2	09330			

NOTE: FAILURE TO FOLLOW INSTALLATION INSTRUCTIONS AND NOT USING THE PROVIDED HARDWARE MAY DAMAGE THE INTAKE TUBE, THROTTLE BODY AND ENGINE.

TO START:

1. Turn off the ignition and disconnect the negative battery cable.

NOTE: Disconnecting the negative battery cable erases pre-programmed electronic memories. Write down all memory settings before disconnecting the negative battery cable. Some radios will require an anti-theft code to be entered after the battery is reconnected. The anti-theft code is typically supplied with your owner's manual. In the event your vehicles' anti-theft code cannot be recovered, contact an authorized dealership to obtain your vehicles anti-theft code.



2. Disconnect the mass air sensor electrical connection.



3. Loosen and remove the three bolts that secure the throttle body cover, then remove the cover as shown.



4. Remove the crankcase vent hose from the stock intake tube as shown.

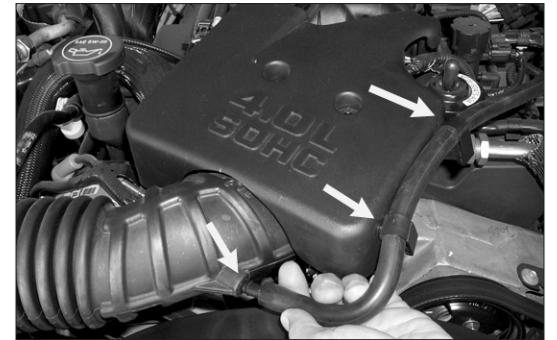

5. On vehicles that come with a second vent line, remove hose from intake tube then release the two clips that retain the hose to the engine cover.



6. Loosen the hose clamp at the throttle body and at the mass air sensor, then remove the stock air intake tube as shown.



7. Using a screwdriver, pry up the bottom of the air cleaner to release the air cleaner from the stock grommets, then remove the air cleaner assembly as shown.

NOTE: K&N Engineering, Inc., recommends that customers do not discard factory air intake.



8. Loosen and remove the four bolts that secure the mass air sensor, then remove the mass air sensor as shown.

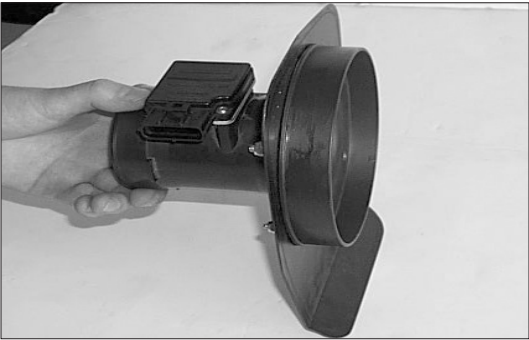

9. Assemble the mass air adapter, gaskets, heat shield and mass air sensor as shown.



10. Apply the trim seal to the heat shield assembly as shown.

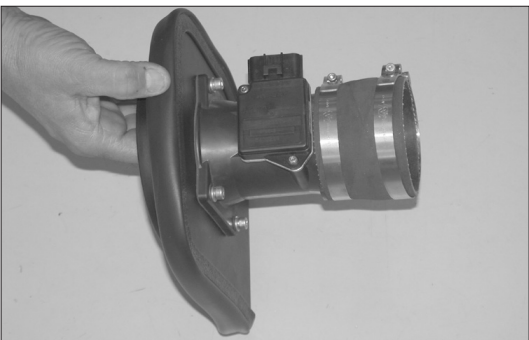

11. Assemble the silicone hose (08051) and the hose clamps onto the heat shield assembly as shown.

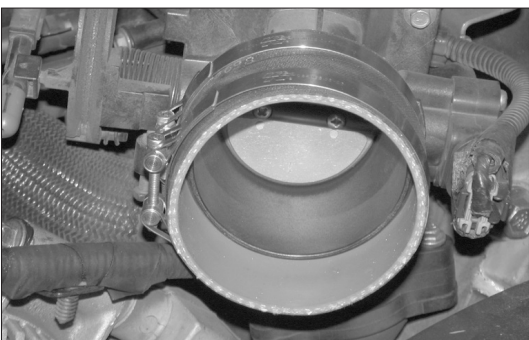

12. Install the silicone hose (08630) and the hose clamps onto the throttle body as shown.

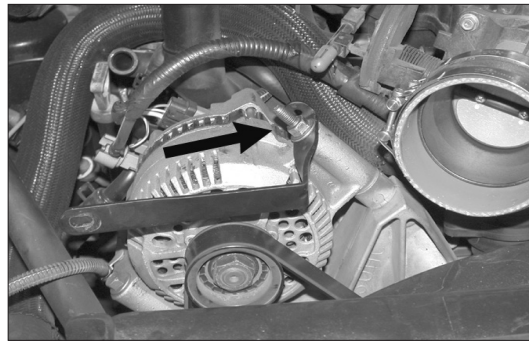

13. Remove the upper alternator bolt and harness clip, and then secure the tube-mounting bracket (070018) to the alternator with the removed bolt.



14. Push the wire harness-retaining clip into the hole on the tube-mounting bracket as shown.
NOTE: Be sure the wire harness is clear of the throttle linkage.



15. Install the K&N® intake tube onto the throttle body and line it up with the tube-mounting bracket, then secure with the hose clamp and hardware provided.

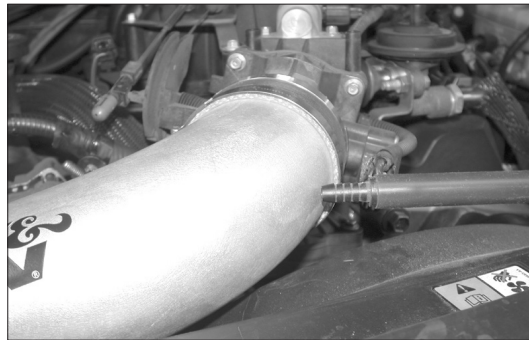

16. On vehicles that come equipped with a second vent line, line up the vent hose on the intake tube and make a mark on the intake tube for drilling.

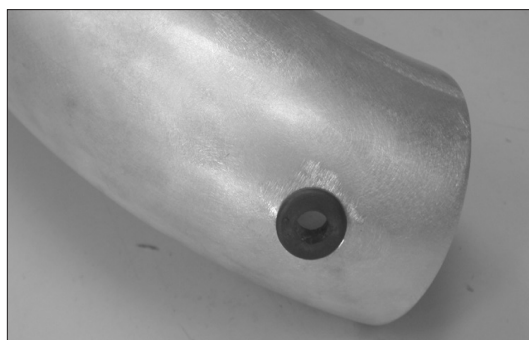

16a. After marking the intake tube, remove the tube from the vehicle and drill a 5/8" hole into the intake tube then install the provided grommet as shown.



17. Re-install the K&N® intake tube onto the throttle body and mounting bracket and then secure with the provided hose clamp and hardware.



18. Remove the factory plastic crank case vent hose from the 90° elbow on the valve cover as shown.

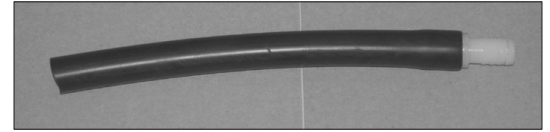

19. Install the provided hose mender into the provided silicone crank case vent hose as shown.

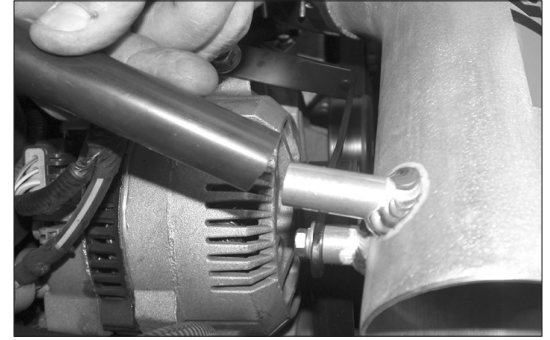

20. Install the crank case vent hose assembly into the 90° fitting at the valve cover and then connect to the vent fitting on the K&N® intake tube as shown.

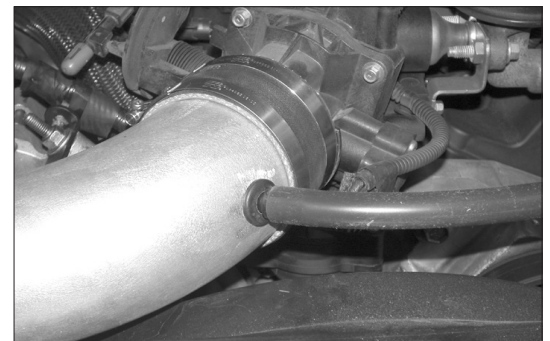

21. Vehicles that come equipped with a second vent line, reconnect as shown

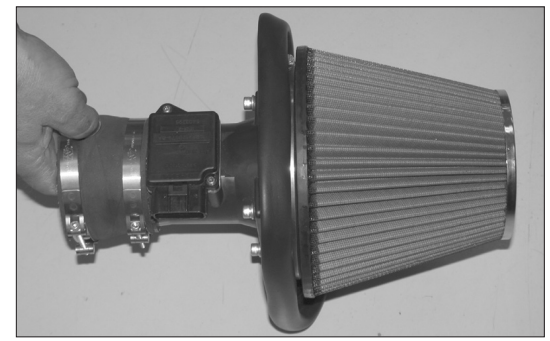

22. Assemble the K&N® air filter onto the heat shield assembly as shown.

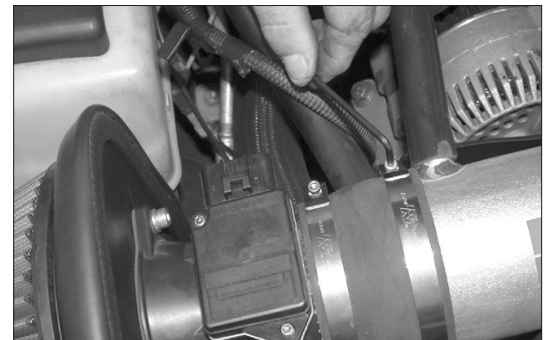

23. Install the heat shield assembly onto the K&N® intake tube and tighten the hose clamp as shown.

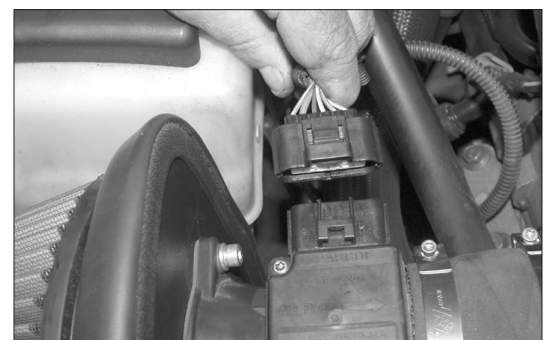

24. Re-connect the mass air sensor electrical connection as shown.

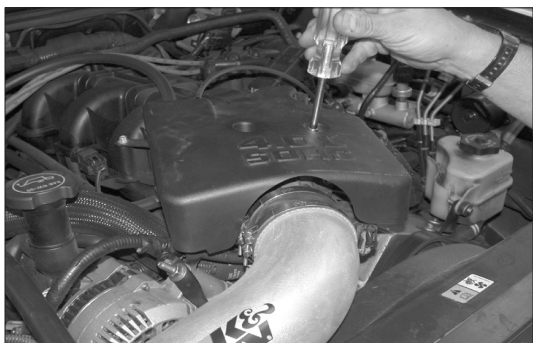

25. Re-install the throttle body cover as shown.



26. Reconnect the vehicle's negative battery cable. Double check to make sure everything is tight and properly positioned before starting the vehicle.

27. The C.A.R.B. exemption sticker, (attached), must be visible under the hood so that an emissions inspector can see it when the vehicle is required to be tested for emissions. California requires testing every two years, other states may vary.

28. It will be necessary for all K&N® high flow intake systems to be checked periodically for realignment, clearance and tightening of all connections. Failure to follow the above instructions or proper maintenance may void warranty.

ROAD TESTING:

1. Start the engine with the transmission in neutral or park, and the parking brake engaged. Listen for air leaks or odd noises. For air leaks secure hoses and connections. For odd noises, find cause and repair before proceeding. This kit will function identically to the factory system except for being louder and much more responsive.

2. Test drive the vehicle. Listen for odd noises or rattles and fix as necessary.

3. If road test is fine, you can now enjoy the added power and performance from your kit.

4. K&N Engineering, Inc., suggests checking the air filter element periodically for excessive dirt build-up. When the element becomes covered in dirt (or once a year), service it according to the instructions on the Recharger® service kit, part number 99-5050 or 99-5000.