



TYPHOON INTAKE SYSTEMS



INSTALLATION INSTRUCTIONS

**69-7202-1
PONTIAC
2005-10 G6
V6-3.5L**

NOTE: E.O. # D-269-37
APPLIES ONLY TO
2005-07 MODEL
YEAR VEHICLES.

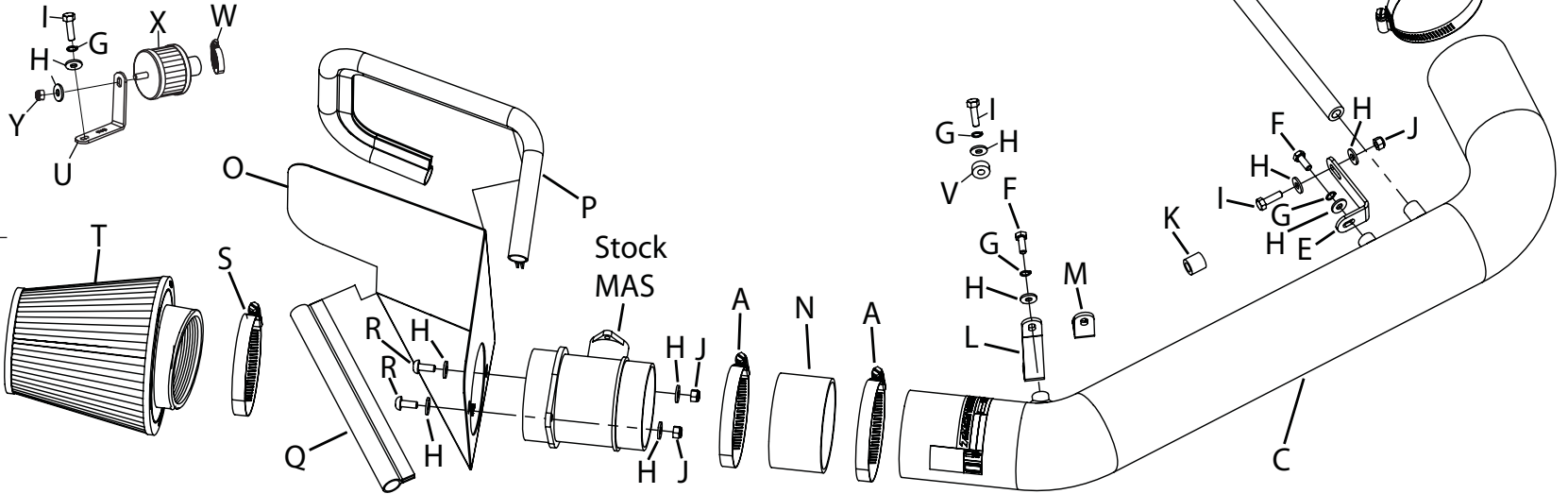

TOOLS NEEDED:

- Flat Blade Screwdriver
- Ratchet
- Extension
- 10mm Socket
- 4mm Allen Wrench
- 10mm Wrench
- T25 Torx Wrench

PARTS LIST:

| Description | Qty. | Part # | Description | Qty. | Part # | Description | Qty. | Part # |
|------------------------------------|------|--------|-------------------------------------|------|--------|------------------------------------|------|---------|
| A Hose Clamp #52 | 4 | 08610 | J Nut; 6mm Nylock, Hex., SS | 3 | 07512 | S Hose Clamp #56 | 1 | 08620 |
| B Hose; 3"ID X 3.25"ID 90 Deg | 1 | 08629 | K Spacer; .625"ODX.375"IDX.625" L | 1 | 07849 | T Air Filter | 1 | RF-1023 |
| C Intake Tube | 1 | 27532 | L Bracket; "L" STL, FB/PC | 1 | 06496 | U Bracket; lg "L", mild stl. TB/PC | 1 | 07177 |
| D Hose; 3/8" X 17"L, Blk., Silic. | 1 | 08404 | M Bracket; Angled Small, STL, FB/PC | 1 | 070049 | V Spacer; .625"odX.250"idx.250"L | 1 | 06555 |
| E Bracket; "L" Fin. | 1 | 070742 | N Hose; 3.25"ID X 2"L, Blk., Silic. | 1 | 08690 | W Hose clamp #16 mini | 1 | 08427 |
| F Bolt; 6mm-1.00 X 16MM, SS | 2 | 07812 | O Heat Shield | 1 | 07352 | X Filter | 1 | 62-1130 |
| G Washer; 1/4" Lock, ZN | 4 | 08198 | P Edge Trim | 1 | 102495 | Y Nut; 1/4-20, nylock, zinc | 1 | 07517 |
| H Washer; 1/4" ID X 5/8" OD - SAE | 11 | 08275 | Q Edge Trim | 1 | 102465 | | | |
| I Bolt; M6 X 1.00" X 20MM Hex., SS | 3 | 07795 | R Bolt; M6X1.00X16MM, Bttnhd, SS | 2 | 07730 | | | |

NOTE: FAILURE TO FOLLOW INSTALLATION INSTRUCTIONS AND NOT USING THE PROVIDED HARDWARE MAY DAMAGE THE INTAKE TUBE, THROTTLE BODY AND ENGINE.

TO START:

1. Turn off the ignition and disconnect the negative battery cable.
NOTE: Disconnecting the negative battery cable erases pre-programmed electronic memories. Write down all memory settings before disconnecting the negative battery cable. Some radios will require an anti-theft code to be entered after the battery is reconnected. The anti-theft code is typically supplied with your owner's manual. In the event your vehicles' anti-theft code cannot be recovered, contact an authorized dealership to obtain your vehicles anti-theft code.



2. Depress the locking tab and disconnect the mass air sensor electrical connection.



3. Remove the oil filler cap. Pull up firmly on the engine cover, removing it from the vehicle.



4. Remove the crank case vent tube from the stock intake tube.



5. Loosen the hose clamp that secures the stock intake to the mass air sensor.



6. Loosen the hose clamp that secures the stock intake tube to the throttle body. Remove the bolt that secures the stock intake tube to the core support.



7. Remove the stock intake tube from the vehicle.



8. Remove the two clamps securing the A/C line to the stock air box.



9. Remove the three bolts that secure the stock air box. On vehicles equipped with air injection, release the retaining clips and unhook the air injection hose from the air box lid.
NOTE: The bolt that secures the A/C line to the factory air box will be re-used.



10. Remove the stock air box from the vehicle.
NOTE: K&N Engineering, Inc., recommends that customers do not discard factory air intake.



10a. On vehicles equipped with air injection, cut the clamp which secures the elbow fitting to the hose and then remove the elbow fitting from the hose.



11. Remove the two clips that secure the mass air sensor harness to the upper intake plenum.



12. Remove the two Torx screws that secure the mass air sensor to the stock air box.



13. Remove the O-ring from the mass air sensor.



14. Install the provided silicone hose (08629) onto the throttle body with the provided hose clamp.

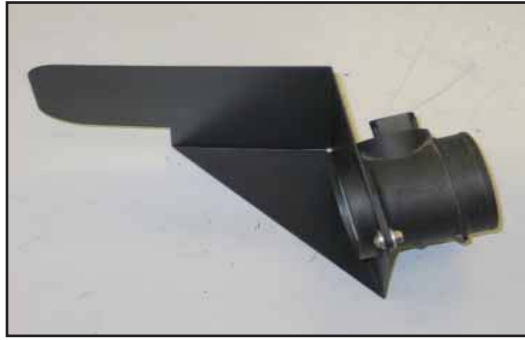

15. Install the mass air sensor onto the heat shield (07352) with the provided hardware as shown.

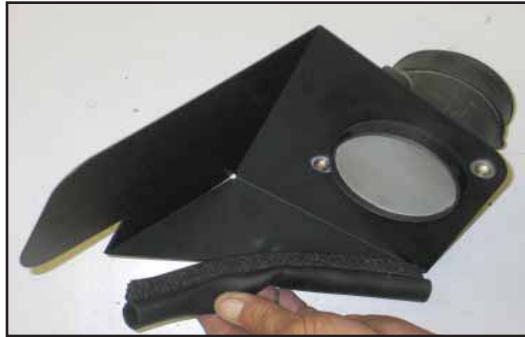

16. Install the provided edge trim (short) onto the heat shield as shown.
NOTE: Some trimming of the edge trim may be necessary.



17. Install the provided edge trim (long) onto the heat shield as shown.
NOTE: Some trimming of the edge trim may be necessary.



18. Install silicone hose (#08690) onto the mass air sensor with the provided hose clamp as shown.



19. Install "L" bracket (#070742) to the 1/4" id hole in the engine lifting bracket using the provided hardware as shown.

NOTE: Some vehicles may have a wiring harness clipped into the 1/4" id hole that will need to be unclipped for bracket installation.



20. On vehicles equipped with the above style heater hose tube, remove the mounting bolt shown.
NOTE: The bolt will be re-used.



20a. On vehicles equipped with the above style heater hose tube, remove the mounting bolt shown.
NOTE: This bolt will be reused in a later step



21. Install the correct tube mounting bracket (06496 or 070049) to match the style heater hose tube as shown in the above photos and secure with the factory bolt removed in step #20a.

NOTE: on vehicles equipped with a vibration dampening shock on the passenger side engine mount, be sure to place the spacer between the mounting bracket and engine. Do not completely tighten at this time.



22. Install the K&N Intake Tube into the silicone hose at the throttle body and align the intake tube with the mounting brackets installed in the previous step. Secure the intake tube with the provided hardware and hose clamp.



23. With the bolt removed in step #9 and spacer (#07849) secure the A/C line to the inner fender as shown.



24. Install the mass air sensor and heat shield assembly. Secure with the provided hose clamp as shown.



25. Cut the end of the crank case vent line, then install the provided silicone vent line onto the stock vent line and then onto the K&N Intake Tube as shown.



26. Install the K&N Air Filter as shown.



26a. On vehicles equipped with air injection system, secure the provided air injection filter to the mounting bracket (07177) as shown.



26b. Secure the air injection filter assembly to the air box mount with the provided hardware and then attach the air injection hose to the filter and secure with the provided hose clamp as shown.



27. Install the engine cover and oil filler cap as shown.

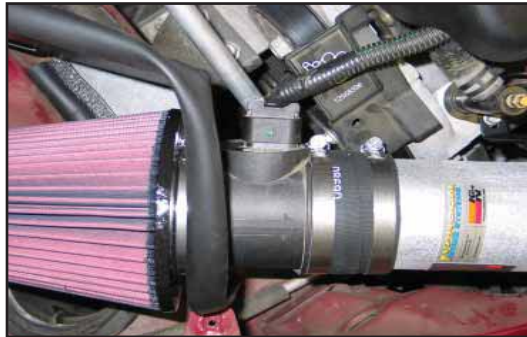

28. Re-connect the mass air sensor as shown.
NOTE: Due to Manufacturer tolerances, it may be necessary to unclip the wiring harness and adjust it for more slack.



29. Reconnect the vehicle's negative battery cable. Double check to make sure everything is tight and properly positioned before starting the vehicle.

30. The C.A.R.B. exemption sticker, (attached), must be visible under the hood so that an emissions inspector can see it when the vehicle is required to be tested for emissions. California requires testing every two years, other states may vary.

31. It will be necessary for all K&N® high flow intake systems to be checked periodically for realignment, clearance and tightening of all connections. Failure to follow the above instructions or proper maintenance may void warranty.

ROAD TESTING:

1. Start the engine with the transmission in neutral or park, and the parking brake engaged. Listen for air leaks or odd noises. For air leaks secure hoses and connections. For odd noises, find cause and repair before proceeding. This kit will function identically to the factory system except for being louder and much more responsive.
2. Test drive the vehicle. Listen for odd noises or rattles and fix as necessary.
3. If road test is fine, you can now enjoy the added power and performance from your kit.
4. K&N Engineering, Inc., suggests checking the air filter element periodically for excessive dirt build-up. When the element becomes covered in dirt (or once a year), service it according to the instructions on the Recharger® service kit, part number 99-5050 or 99-5000