



# AIRCHARGER™

## HIGH-FLOW INTAKE KITS



### INSTALLATION INSTRUCTIONS

**63-3053**  
**PONTIAC**  
**2006 GTO**  
**V8-6.0L**

**TOOLS NEEDED:**

- 10mm Socket
- 10mm Wrench
- 4mm Allen Wrench
- Extension
- Flat Blade Screwdriver
- Ratchet
- T-30 Torx Socket

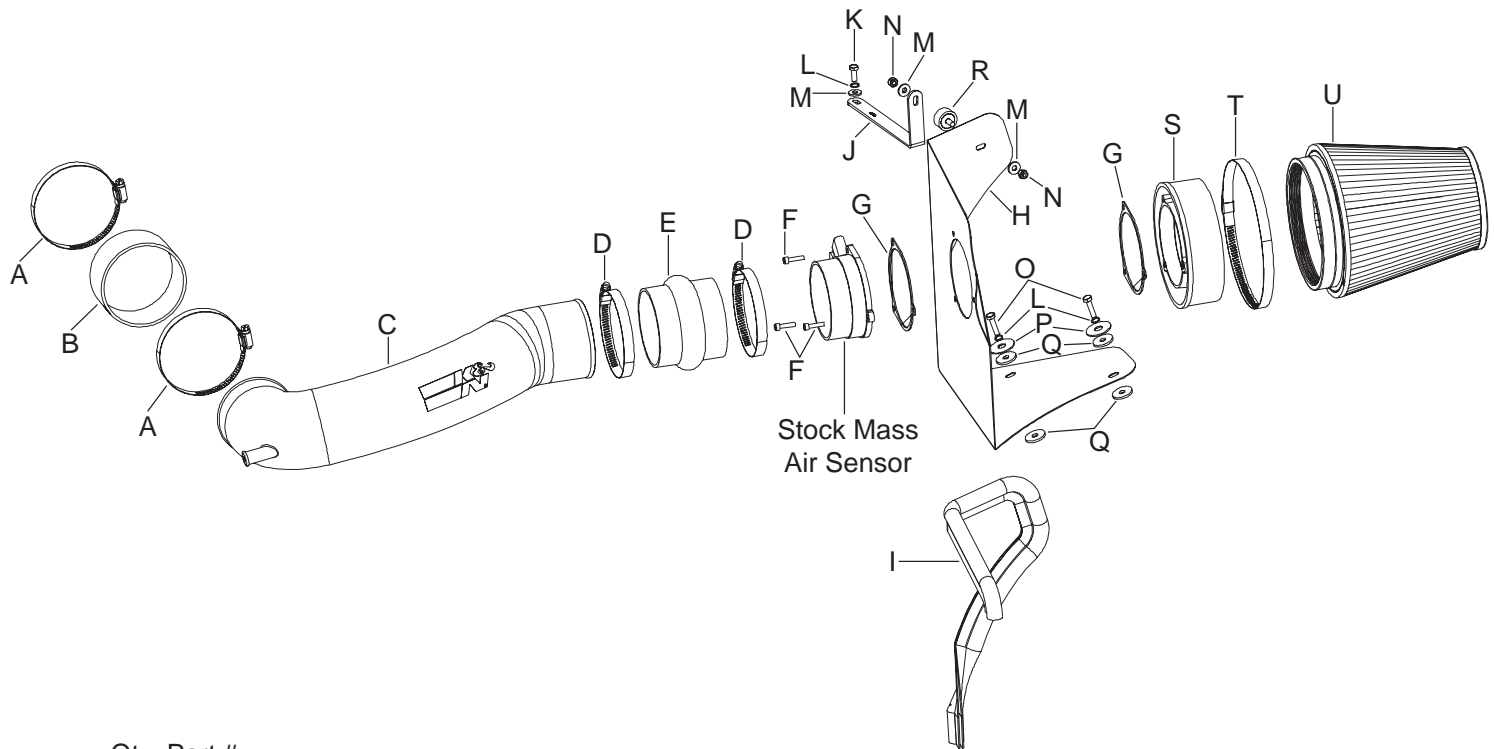

**PARTS LIST:**

Description	Qty.	Part #	Description	Qty.	Part #	Description	Qty.	Part #
A Hose Clamp #64 Stainless	2	08645	H Heat Shield; Mild Stl. TB/PC	1	074041	O Bolt; M6-1.00 X 25mm Hex Hd.	2	07704
B Hose; 4" ID X 2" L Molded	1	08625	I Edge Trim; 3/4" Bulb, Top Loc., 30"L	1	102489	P Washer; 1"D X 1/4 Hole Fender	2	08160
C Intake Tube	1	087170-1	J Bracket; "L", TB/PC	1	07091	Q Washer; 1" X .300 X .100 Rubber	4	21685
D Hose Clamp #56	2	08620	K Bolt; M6-1.00 X 16mm Hex Hd.	1	07703	R Stud; M6-1.00 M/M, Rubber Mntd	1	07027
E Hose; 3-5/8" ID X 3-3/8" L Hump	1	08176	L Washer; 1/4" Lock, Zn	3	08198	S Adaptor; TB/PC #240	1	08783
F Bolt; 5mm- .80 X 20mm, Allen Zn	3	08320	M Washer; 1/4" ID X 5/8" OD - SAE	3	08275	T Hose Clamp #104	1	08697
G Gasket; 1/16" Neoprene	2	09033	N Nut; 6mm Nylock, Hex Hd.	2	07553	U Air Filter	1	RF-1048

**NOTE: FAILURE TO FOLLOW INSTALLATION INSTRUCTIONS AND NOT USING THE PROVIDED HARDWARE MAY DAMAGE THE INTAKE TUBE, THROTTLE BODY AND ENGINE.**

**TO START:**

1. Turn off the ignition and disconnect the negative battery cable.

**NOTE: Disconnecting the negative battery cable erases pre-programmed electronic memories. Write down all memory settings before disconnecting the negative battery cable. Some radios will require an anti-theft code to be entered after the battery is reconnected. The anti-theft code is typically supplied with your owner's manual. In the event your vehicles' anti-theft code cannot be recovered, contact an authorized dealership to obtain your vehicles anti-theft code.**

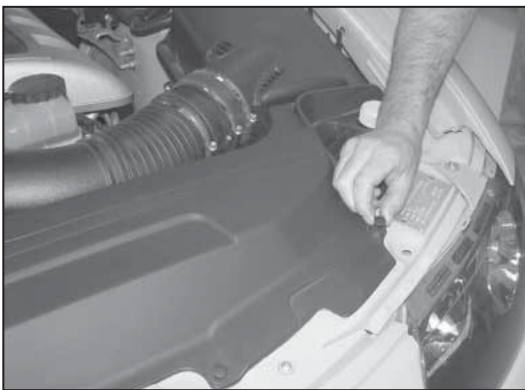

2. Release the center pin on the five radiator cover clips, then remove the clips from the radiator cover.



3. Lift up on the radiator cover and pull back to release from the retaining hook, then remove the cover from the vehicle.

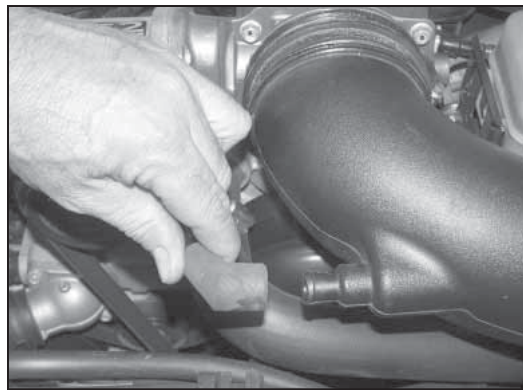

4. Disconnect the crank case vent hose from the factory intake tube as shown.

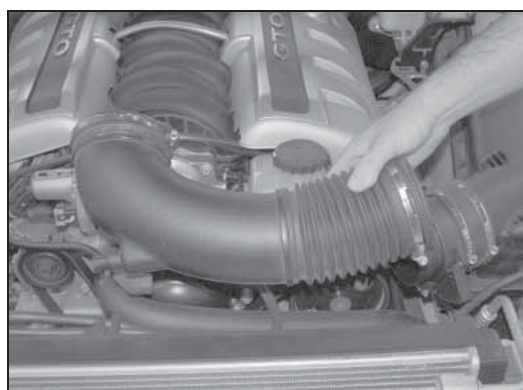

5. Loosen the two intake tube hose clamps, then remove the intake tube from the vehicle.

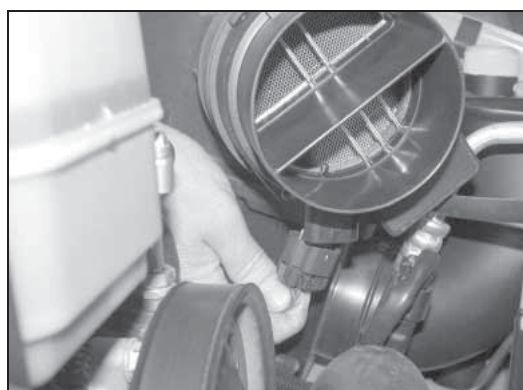

6. Release the mass air sensor electrical connection clip, then disconnect the electrical connection.

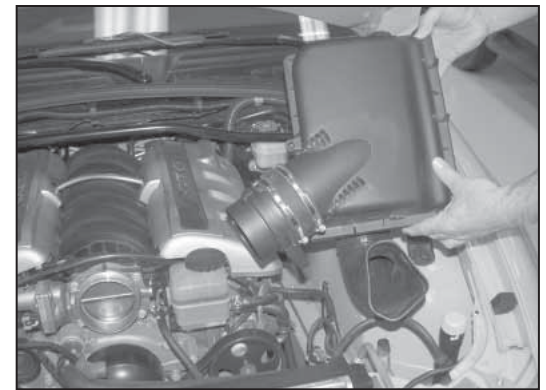

7. Pull up on the air box assembly to dislodge it from the three mounting pins and then remove the air box from the vehicle as shown.

**NOTE: K&N Engineering, Inc., recommends that customers do not discard factory air intake.**

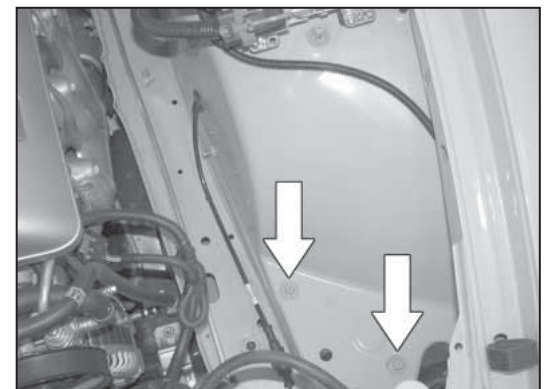

8. Remove the three air box mounting pins shown with a T-30 torx socket.



9. Loosen the hose clamp that secures the mass air sensor to the factory air box, then remove the mass air sensor from the factory air box.

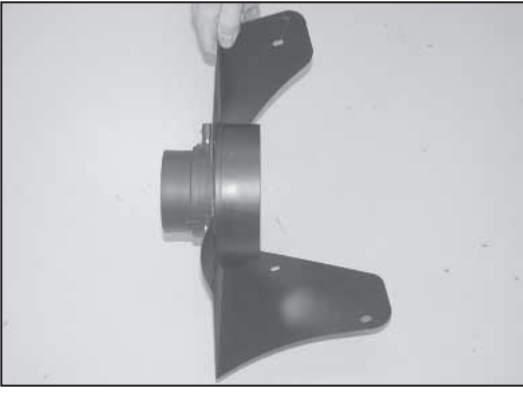

10. Assemble the heat shield and mass air sensor with the provided hardware and gaskets as shown.

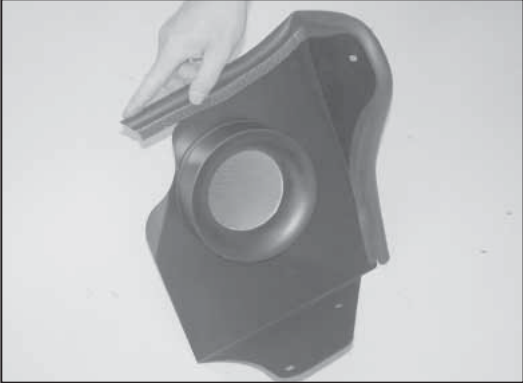

11. Install the edge trim onto the heat shield as shown.

**NOTE: Some trimming of the edge trim may be necessary.**

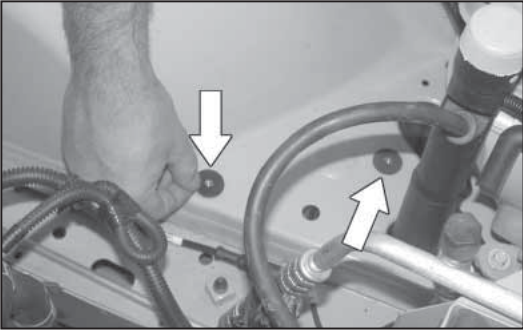

12. Place the two rubber washers onto the inner fender at the lower air box mounting pin locations as shown.

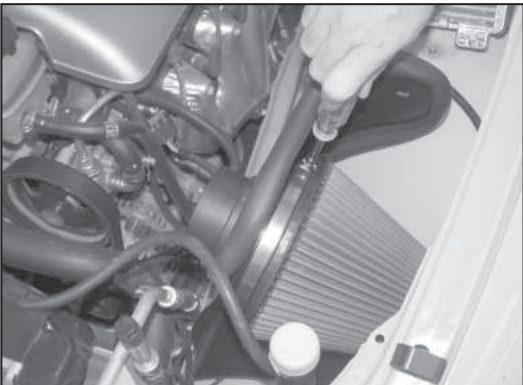

13. Install the heat shield assembly onto the inner fender and start the mount bolts in the air box mounting pin holes, then place the K&N® air filter into position. Tighten the heat shield mounting bolts, then install the K&N® air filter onto the filter adapter and secure with the provided hose clamp.

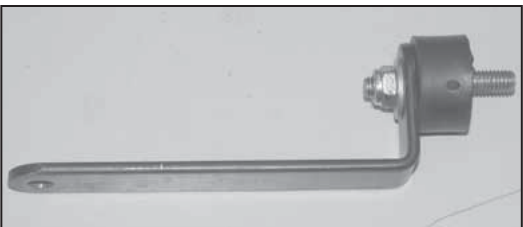

14. Install the rubber-mounted stud onto the heat shield mounting bracket (07091) and secure with the provided hardware as shown.



15. Install the heat shield mounting bracket onto the heat shield and secure the bracket to the inner fender at the upper air box mounting pin location with the provided hardware.

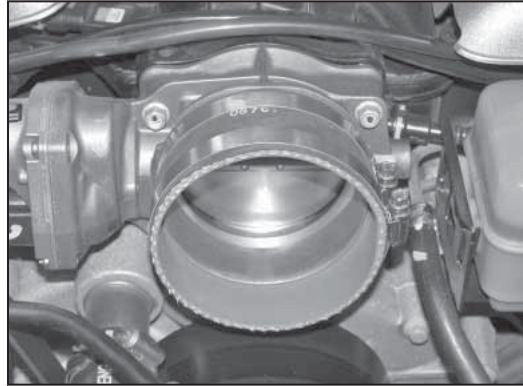

16. Install the silicone hose (08625) onto the throttle body and secure with the provided hose clamps as shown.

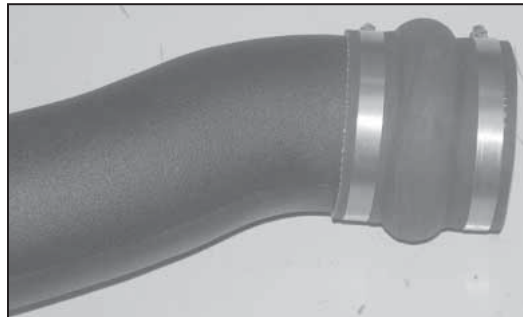

17. Install the silicone hump hose (08176) onto the intake tube as shown and secure with the provided hose clamps as shown.



18. Install the K&N® intake tube into the silicone hose attached to the throttle body and then onto the mass air sensor. Secure with the provided hose clamps as shown.

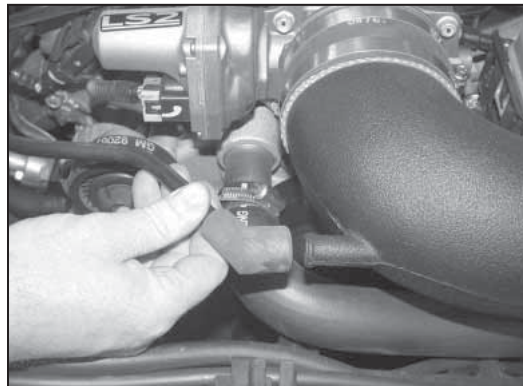

19. Install the crank case vent hose onto the K&N® intake tube as shown.



20. Reinstall the radiator cover and the five mounting clips removed in step #2.

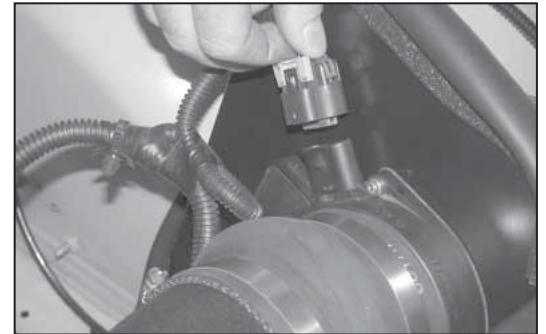

21. Reconnect the mass air sensor electrical connection.

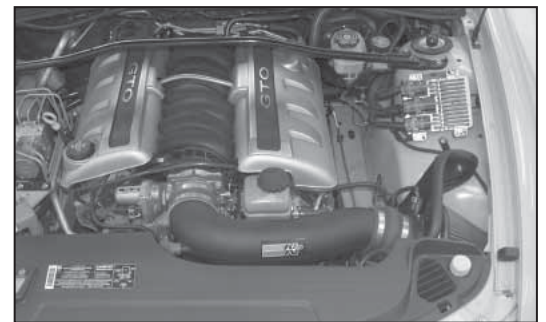

22. Reconnect the vehicle's negative battery cable. Double check to make sure everything is tight and properly positioned before starting the vehicle.

23. It will be necessary for all K&N® high flow intake systems to be checked periodically for realignment, clearance and tightening of all connections. Failure to follow the above instructions or proper maintenance may void warranty.

#### ROAD TESTING:

1. Start the engine with the transmission in neutral or park, and the parking brake engaged. Listen for air leaks or odd noises. For air leaks secure hoses and connections. For odd noises, find cause and repair before proceeding. This kit will function identically to the factory system except for being louder and much more responsive.

2. Test drive the vehicle. Listen for odd noises or rattles and fix as necessary.

3. If road test is fine, you can now enjoy the added power and performance from your kit.

4. K&N Engineering, Inc., requires cleaning the intake system's air filter element every 100,000 miles. When used in dusty or off-road environments, our filters will require cleaning more often. We recommend that you visually inspect your filter once every 25,000 miles to determine if the screen is still visible. When the screen is no longer visible some place on the filter element, it is time to clean it. To clean and re-oil, purchase our filter Recharger® service kit, part number 99-5050 or 99-5000 and follow the easy instructions.