

## Opel/ Vauxhall Corsa D 1.3d/1.4turbo/1.6turbo/1.7d Alfa Romeo Mito 1.6d

### Tools needed for installation:

Flat blade screwdriver  
T25 Torx Screwdriver  
7mm Socket spanner

Description		
A	Air box Lid	A2091-39
B	Intake Pipe	A2009-145C
C	K&N Air Filter	RC-5135
D	Silicon Adaptor Hose	08756
E	2 x Hose Clamps	A2100-04
F	Hose Clamp	A2100-03

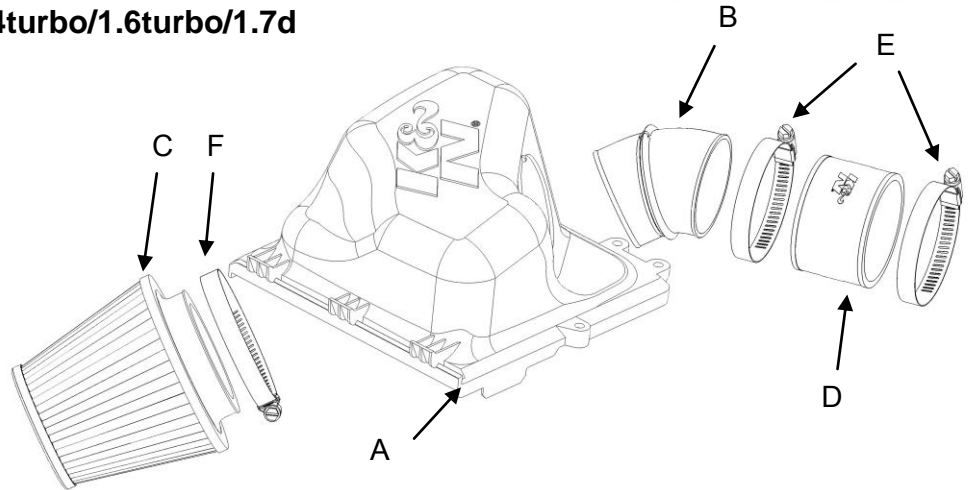

Instruction sheet A2054-780

1. Take the key from the ignition, unclip the electrical plug from the MAS (Mass air Sensor) (Fig. 1)
2. Unscrew the hose clamp and remove the MAS from the airbox lid. (Fig. 2)
3. Remove the 4 screws from the air box lid. (Fig. 3)
4. Remove the original air box lid from the air box base. (Fig. 4)
5. Remove the original air filter from the air box base. (Fig. 5)
6. Fit the intake pipe into the 57s airbox lid (ensure a snap fit). (Fig. 6)
7. Fit the filter onto the intake pipe and secure using the hose clamp supplied. (Fig. 7)
8. Fit the new K&N air box lid onto the air box base using the 4 original screws. (Fig. 8)
9. Fit the silicon adaptor hose onto the intake pipe using the hose clamp supplied. Fit the MAS into the silicon adaptor hose, align for maximum intake hose clearance against the slam panel and secure using the hose clamp supplied. (Fig. 9)
10. Reconnect the electrical connector to the MAS. (Fig. 10)
11. Carry out a final check of all the connections and alignment of the K&N air filter system before starting the engine. Installation is now complete.

**WARNING:** Before starting the engine carry out a final fitment check of the K&N performance kit. It will be necessary for all systems to be checked periodically for realignment, clearance and tightening of all connections. Failure to follow the instructions or proper maintenance may void the warranty.

**FILTER MAINTENANCE:** K&N suggests checking the filter periodically for excessive dirt build-up. When the element becomes covered in dirt (or once a year), service it according to the instructions on the service kit available from your K&N dealer, part number 99-5000EU



Fig. # 1



Fig. # 2



Fig. # 3



Fig. # 4



Fig. # 5



Fig. # 6



Fig. # 7



Fig. # 8

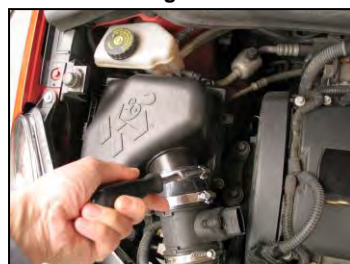

Fig. # 9

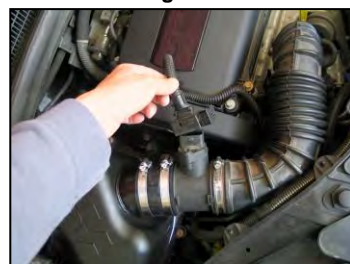

Fig. # 10

