



# INSTALLATION INSTRUCTIONS

**57-3044**  
**PONTIAC**  
**2004 GTO**  
**V8-5.7L**

**TOOLS NEEDED:**

- Flat Blade Screwdriver
- 10mm Wrench
- 1/2" Wrench
- Ratchet
- Extension
- 10mm Socket
- T-30 Torx Socket
- 17mm Socket
- Pliers

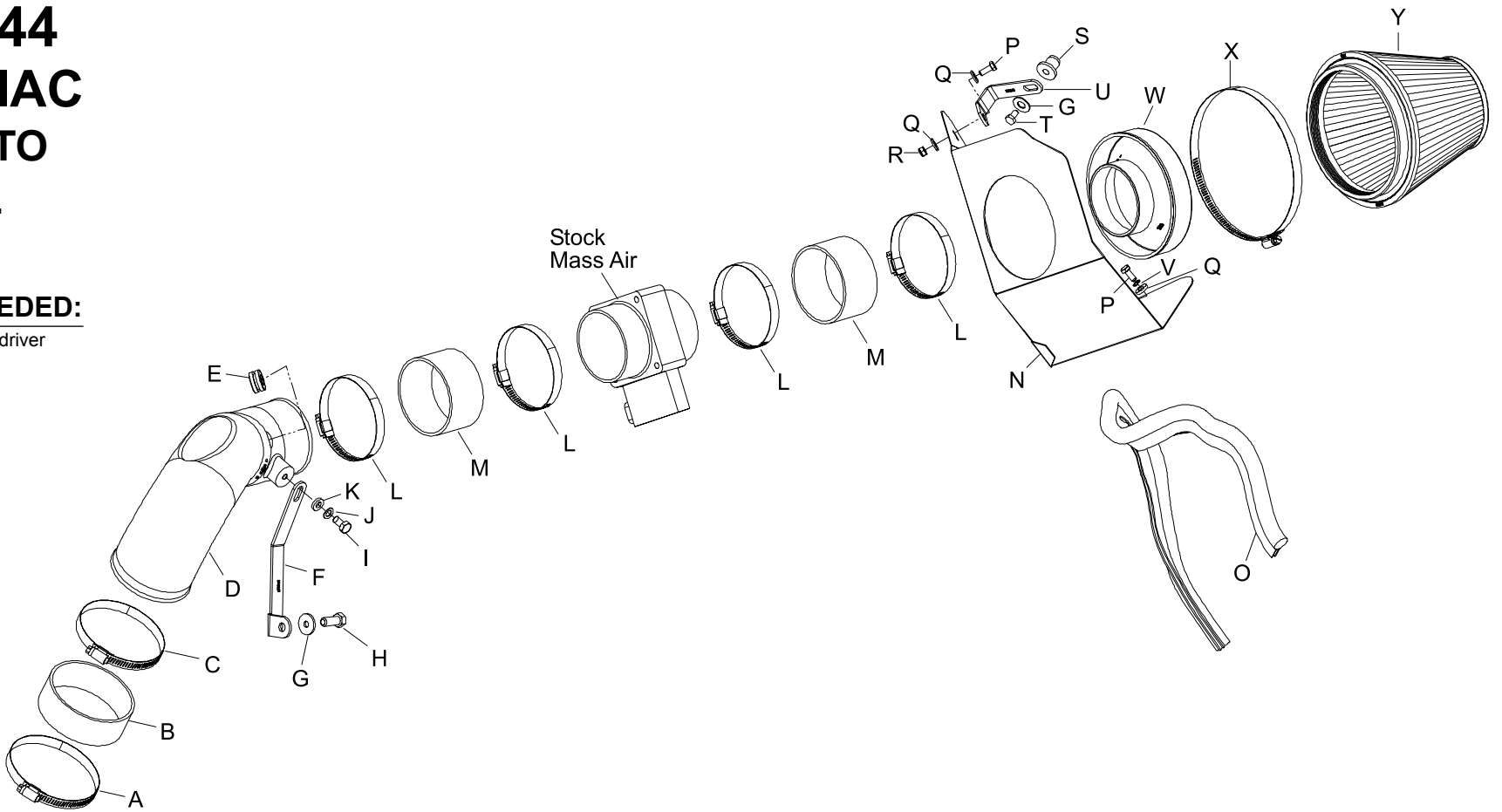

**PARTS LIST:**

Description	Qty.	Part #	Description	Qty.	Part #	Description	Qty.	Part #
A hose clamp, #64	1	08648	J washer; 8mm wave	1	08239	S insert; 5/16"-18x.600"odx 730"L	1	088002
B silicone hose; 4.5" x 1.5"L	1	08755	K washer; 8mm flat, ss	1	08134	T bolt; 5/16"-18 x 1"L, ss	1	07777
C hose clamp; #60	1	08628	L hose clamp; #56	4	08620	U bracket sm. C	1	010062
D intake tube (DY)	1	087125	M silicone hose; 3.5" x 2"L	2	08630	V washer; 1/4"lock	1	08198
E grommet, 1"od, 1/2"id, 1/2"thk	1	08064	N heat shield	1	074026	W filter adapter #380	1	21512-1
F bracket	1	010061	O edge trim 33"L	1	102498	X hose clamp #104	1	08697
G washer; 5/16"id x 5/8"od	2	08276	P bolt; 6mm-1.00 x 16mm, hex	2	07703	Y air filter	1	RF-1048
H bolt; m10-1.5x25mm L	1	07702	Q washer; 1/4"id x 5/8"od, flat	3	08275			
I bolt; m8-1.25 x 16mm hex	1	07844	R nut; 6mm nylock	1	07553			

**NOTE: FAILURE TO FOLLOW INSTALLATION INSTRUCTIONS AND NOT USING THE PROVIDED HARDWARE MAY DAMAGE THE INTAKE TUBE, THROTTLE BODY AND ENGINE.**

**TO START:**

1. Turn off the ignition and disconnect the negative battery cable.

**NOTE: Disconnecting the negative battery cable erases pre-programmed electronic memories. Write down all memory settings before disconnecting the negative battery cable. Some radios will require an anti-theft code to be entered after the battery is reconnected. The anti-theft code is typically supplied with your owner's manual. In the event your vehicles anti-theft code cannot be recovered, contact an authorized dealership to obtain your vehicles anti-theft code.**



2. Release the center pin on the five radiator cover clips. Then remove the clips from the radiator cover.



3. Lift up on the radiator cover and pull back to release from the retaining hook, then remove the cover from the vehicle.



4. Release the air temp. electrical connection clip, then disconnect the electrical connection.



5. Loosen the two intake tube hose clamps, then remove the intake tube from the vehicle.



6. Release the mass air sensor electrical connection clip, then disconnect the electrical connection.



7. Pull the coolant reservoir up and away from the inner fender to release it from the retaining studs.



8. Have an assistant hold the coolant reservoir up, lift up on the air box assembly to release it from the retaining studs. Then remove the air box from the vehicle.

**NOTE: K&N Engineering, Inc., recommends that customers do not discard factory air intake.**



9. Reinstall the coolant reservoir onto the mounting studs as shown.



10. Lift up and pull out the air deflector from behind the head light.

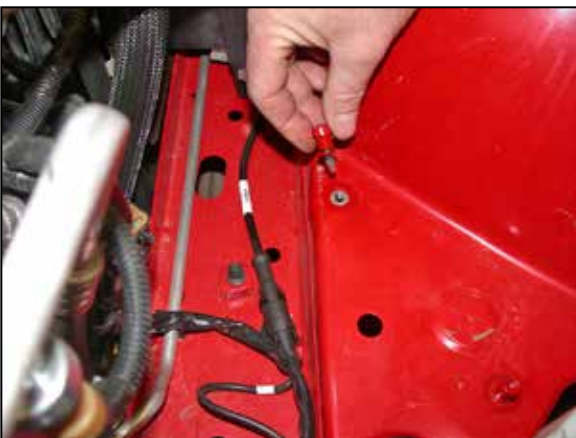

11. Remove the inner airbox mounting stud shown with a T-30 torx socket.



12. Install the tube bracket #010061 using the provided hardware.

**NOTE: The 10mm mounting bolt threads into the threaded, unused hole in the cylinder next to coolant temperature sensor.**



13. Install the silicone (08755) onto the throttle body and secure with the provided hose clamp.



14. Remove the air temperature sensor from the stock intake tube.



15. Install the provided rubber grommet into the K&N® intake tube as shown.



16. Install the air temperature sensor from step #14 into the grommet in the K&N® intake tube as shown.



17. Install the K&N® intake tube onto the throttle body as shown and secure with the provided hose clamp, using the 8mm bolt provided. Secure the K&N® intake tube onto the mounting bracket installed in step #12.



18. Install the provided edge trim onto the heatshield as shown.



19. Install the radiused filter adapter into the K&N® air filter as shown. Secure with the provided hose clamp.



20. Install the provided silicone hose (08630) onto the filter adapter and secure with the provided hose clamp as shown.



21. Using a pair of pliers, loosen the spring clamp on the coolant reservoir hose. rotate the coolant hose 90 degrees down as shown. Then resecure with the stock clamp.

**NOTE: Make sure pressure is released from radiator cap before loosening spring clamp.**



22. Set the heatshield assembly onto the inner fender, then set the air filter assembly between the heatshield and fender as shown.



23. Secure the heatshield to the inner fender with the 6mm bolt provided.

**NOTE: Thread the 6mm bolt into the hole vacated in step #11.**



24. Install the threaded insert into inner fender as shown.



25. Install the heatshield bracket (#010062) onto the heatshield and inner fender and secure with the provided hardware.



26. Loosen the hose clamp that secures the mass air sensor to the factory air box, then remove the mass air sensor from the factory air box.



27. Install the silicone hose (#08630) onto the intake tube side of the mass air sensor and secure with the provided hose clamp.

**NOTE: There is an arrow on the side of the mass air sensor which shows direction of air flow through the sensor and points the intake tube side of the sensor.**



28. Install the mass air sensor assembly onto the K&N® intake tube and secure with the provided hose clamp.



29. Install the air filter assembly onto the K&N® intake tube and secure with the provided hose clamp.



30. Reconnect the mass air sensor electrical connection.



31. Reconnect the temperature sensor electrical connection.



32. Reinstall the radiator cover removed in step #3.



33. Reinstall the five radiator cover retaining clips removed in step #2.



34. Reconnect the vehicle's negative battery cable. Double check to make sure everything is tight and properly positioned before starting the vehicle.

35. The C.A.R.B. exemption sticker, (attached), must be visible under the hood so that an emissions inspector can see it when the vehicle is required to be tested for emissions. California requires testing every two years, other states may vary.

36. It will be necessary for all K&N® high flow intake systems to be checked periodically for realignment, clearance and tightening of all connections. Failure to follow the above instructions or proper maintenance may void warranty.

#### ROAD TESTING:

1. Start the engine with the transmission in neutral or park, and the parking brake engaged. Listen for air leaks or odd noises. For air leaks secure hoses and connections. For odd noises, find cause and repair before proceeding. This kit will function identically to the factory system except for being louder and much more responsive.

2. Test drive the vehicle. Listen for odd noises or rattles and fix as necessary.

3. If road test is fine, you can now enjoy the added power and performance from your kit.

4. K&N Engineering, Inc., requires cleaning the intake system's air filter element every 100,000 miles. When used in dusty or off-road environments, our filters will require cleaning more often. We recommend that you visually inspect your filter once every 25,000 miles to determine if the screen is still visible. When the screen is no longer visible some place on the filter element, it is time to clean it. To clean and re-oil, purchase our filter Recharger® service kit, part number 99-5050 or 99-5000 and follow the easy instructions.