



INSTALLATION INSTRUCTIONS

57-3024
CHEVROLET / GMC
1994-97 S-10 / Sonoma
L4 - 2.2L

NOTE: This kit was not designed to fit vehicles with a body lift.

TOOLS NEEDED:

- Flat Blade Screwdriver
- Ratchet
- Long Extension
- 10mm Socket
- 10mm Wrench
- 4mm Allen Wrench
- 5mm Allen Wrench

PARTS LIST:

Description	Qty.	Part #	Description	Qty.	Part #
A Hose Clamp #48	4	08601	J Bolt 6mm- 1.00 x 20mm F/H/A	1	08376
B Hose; 3" ID X 2-1/2" L Hump	1	087121	K Washer Conical Nylon	1	08180
C Intake Tube	1	26092	L Washer 1/4"ID x 5/8"OD	3	08275
D Black Silicone Hose 1/2"	1	08159	M Nut 6mm, Nylock	2	07553
E Hose Mender	1	08686	N Bolt 6mm- 1.00 x 20mm Allen	1	07852
F Grommet	1	08064	O Heat Shield	1	07428
G Bracket "L" Bend	1	070982	P Edge Trim 39"L	1	102496
H Bracket "Z" Bend	1	070992	Q Air Filter Element	1	RC-4650
I Saddle Bracket	1	078855			

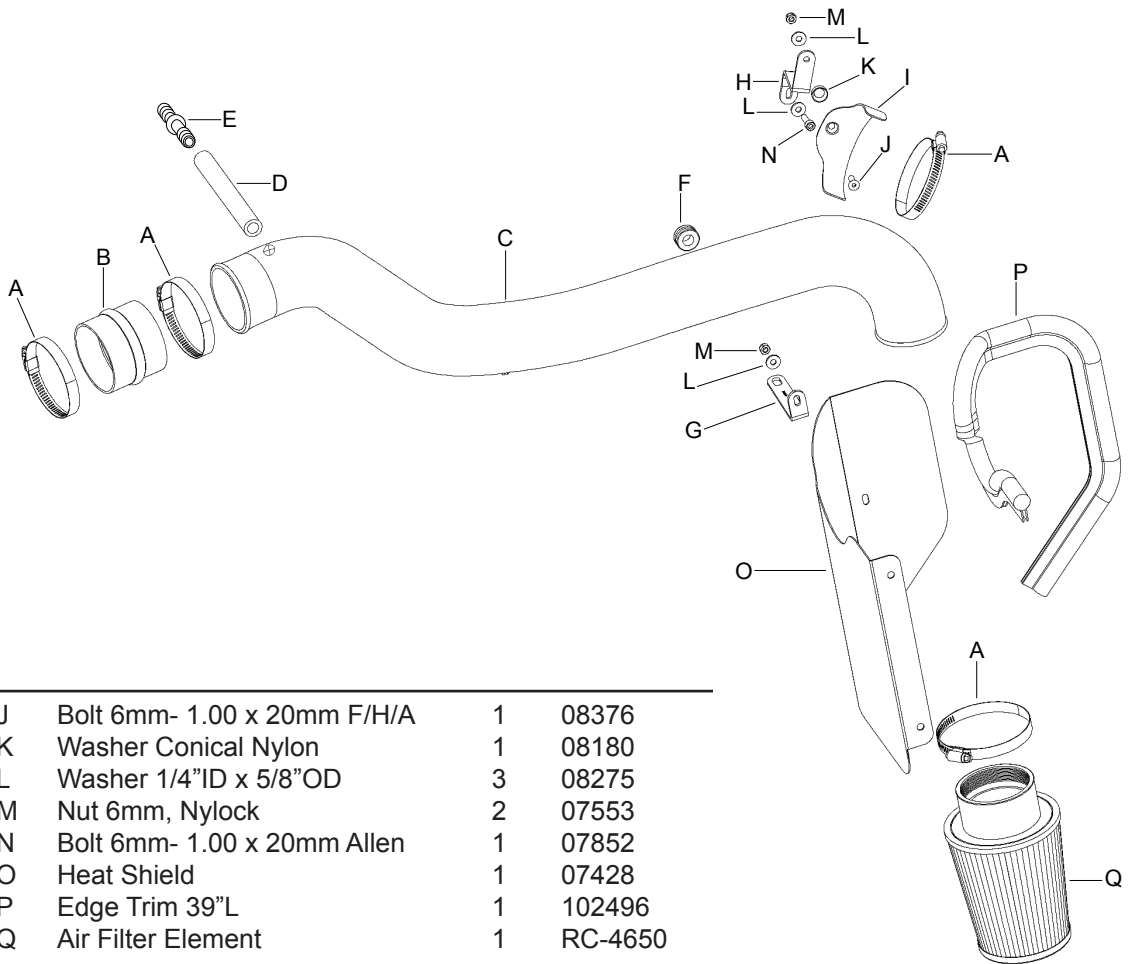

NOTE: FAILURE TO FOLLOW INSTALLATION INSTRUCTIONS AND NOT USING THE PROVIDED HARDWARE MAY DAMAGE THE INTAKE TUBE, THROTTLE BODY AND ENGINE.

TO START:

1. Turn off the ignition and disconnect the negative battery cable.

NOTE: Disconnecting the negative battery cable erases pre-programmed electronic memories. Write down all memory settings before disconnecting the negative battery cable. Some radios will require an anti-theft code to be entered after the battery is reconnected. The anti-theft code is typically supplied with your owner's manual. In the event your vehicles' anti-theft code cannot be recovered, contact an authorized dealership to obtain your vehicles anti-theft code.



2. Disconnect the vehicle's air temperature sensor.



3. Loosen the hose clamp at the air intake plenum.

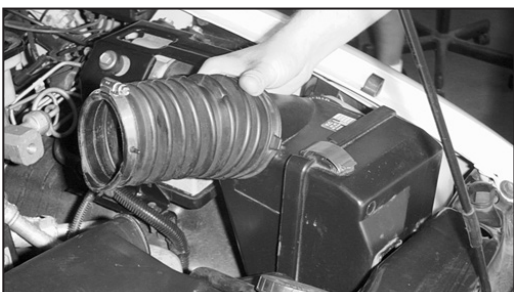

4. Remove the air box from the vehicle by sliding upwards.



5. Remove the air temperature sensor from the stock air intake tube.



6. Loosen the hose clamp at the throttle body.



7. Pull firmly upward to release the air intake plenum from its grommets and remove complete assembly.

NOTE: K&N Engineering, Inc., recommends that customers do not discard factory air intake.

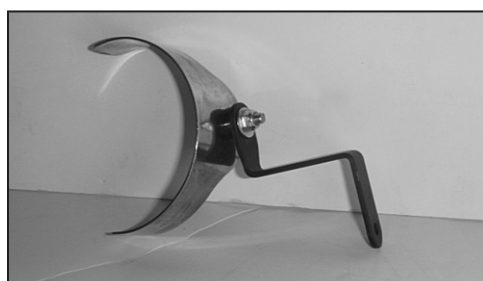

8. Assemble the saddle bracket assembly with the provided hardware as shown.

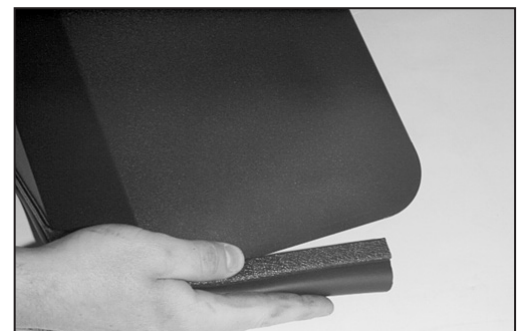

9. Apply the edge trim to heat shield as shown.



10. Attach the "L" bracket and the saddle bracket assembly onto the heat shield and secure with the provided hardware as shown. DO NOT TIGHTEN COMPLETELY.

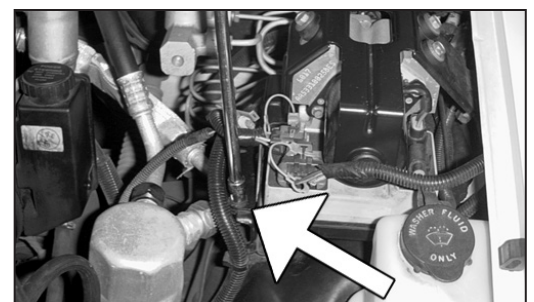

11. Remove the stock hex bolt from the ABS control bracket as shown.



12. Remove the upper hex bolt from the plastic radiator valence.



13. Using a screwdriver pry up the center pin on the lower push clip, then remove the push clip.



14. Install the heat shield assembly as shown.

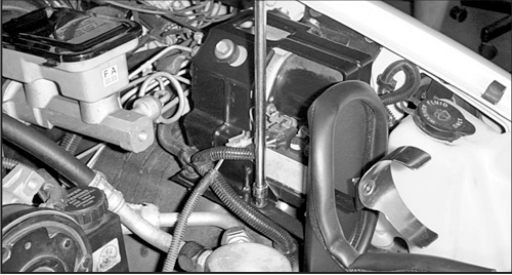

15. Using the hex bolt removed in step 11, secure the "L" bracket to the ABS control bracket.

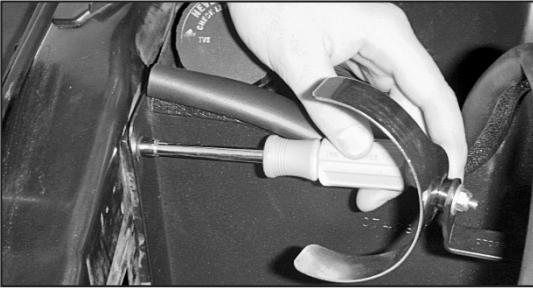

16. Using the hex bolt removed in step 12, secure the upper bolt hole on the heat shield to the radiator core supports as shown.

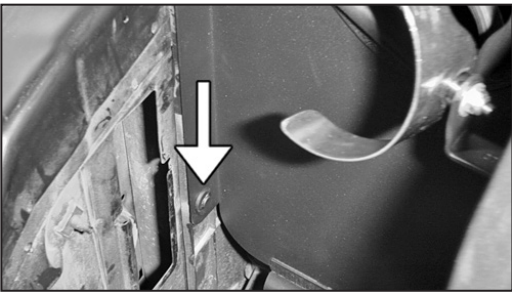

17. Using the push clip removed in step 13, secure the lower hole on the heat shield to the radiator core supports as shown.

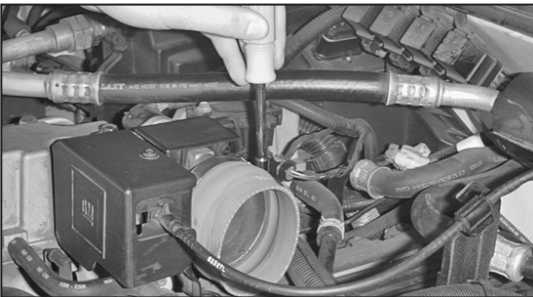

18. Install the silicone hump hose onto the throttle body and secure with the provided hose clamp as shown.

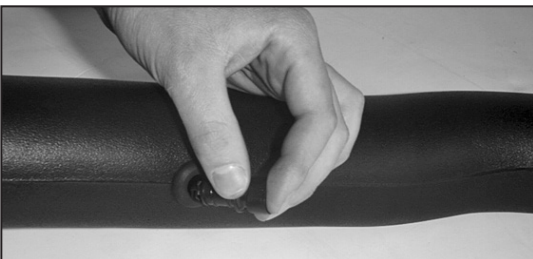

19. Install the provided grommet into the K&N intake tube as shown.

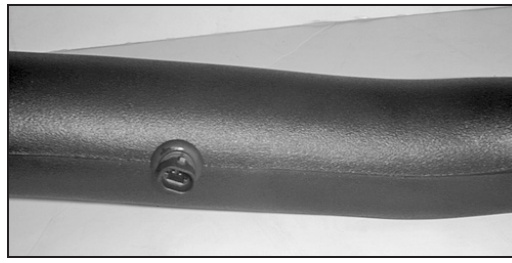

20. Install the air temperature sensor into the grommet in the K&N intake tube.

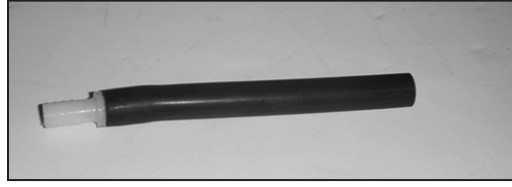

21. Assemble the silicone hose and the hose mender as shown.

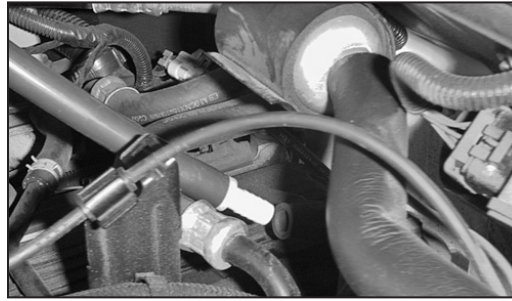

22. Install the silicone hose and hose mender onto the crankcase vent as shown.

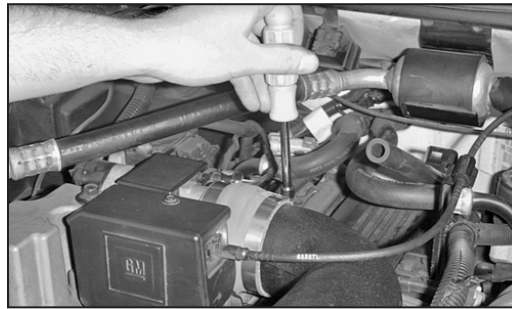

23. Install the K&N intake tube into the silicone hose on the throttle body and secure with the provided hose clamps.

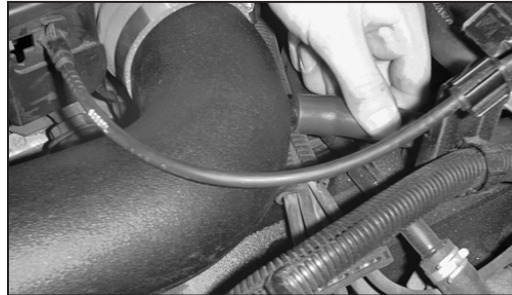

24. Attach the crankcase vent hose to the K&N intake tube.



25. Install the K&N air filter onto the K&N intake tube as shown.



26. Secure the K&N intake tube to the saddle bracket with the provided hose clamp as shown.



27. Reconnect the air temperature sensor electrical connection.

28. Reconnect the vehicle's negative battery cable. Double check to make sure everything is tight and properly positioned before starting the vehicle.

29. The C.A.R.B. exemption sticker, (attached), must be visible under the hood so that an emissions inspector can see it when the vehicle is required to be tested for emissions. California requires testing every two years, other states may vary.

30. **NOTE:** Most General Motors vehicles have the Vehicle Emissions Certification Information (VECI) label affixed to the air filter box. In order to be compliant with California emissions laws, the label **MUST** remain in the engine compartment. If the Vehicle Emission Control Information label is removed during modification, a new replacement label must be obtained and installed in a readily visible position in the engine compartment. The label shall not be affixed to any equipment which is easily detached from the vehicle. We recommend that the label is affixed to the underside of the hood adjacent to the hood latch. The label is Vehicle Identification Number dependent and can be ordered from the vehicle dealership. In order to receive the proper decal please bring your VIN with you. Failure to have the VECI under the hood may result in failure of a pre-registration smog test.

31. It will be necessary for all K&N high flow intake systems to be checked periodically for realignment, clearance and tightening of all connections. Failure to follow the above instructions or proper maintenance may void warranty.

ROAD TESTING:

1. Start the engine with the transmission in neutral or park, and the parking brake engaged. Listen for air leaks or odd noises. For air leaks secure hoses and connections. For odd noises, find cause and repair before proceeding. This kit will function identically to the factory system except for being louder and much more responsive.

2. Test drive the vehicle. Listen for odd noises or rattles and fix as necessary.

3. If road test is fine, you can now enjoy the added power and performance from your kit.

4. K&N Engineering, Inc., requires cleaning the intake system's air filter element every 100,000 miles. When used in dusty or off-road environments, our filters will require cleaning more often. We recommend that you visually inspect your filter once every 25,000 miles to determine if the screen is still visible. When the screen is no longer visible some place on the filter element, it is time to clean it. To clean and re-oil, purchase our filter Recharger service kit, part number 99-5050 or 99-5000 and follow the easy instructions.