



# INSTALLATION INSTRUCTIONS

57-2554

FORD / MAZDA

2002-03 Ranger / B3000

V6 - 3.0L

NOTE: This kit was not designed to fit vehicles with a body lift.

## TOOLS NEEDED:

Flat Blade Screwdriver  
Ratchet  
Extension  
5mm Allen Wrench  
10mm Socket  
13mm Socket  
10mm Wrench  
5/8 Wrench

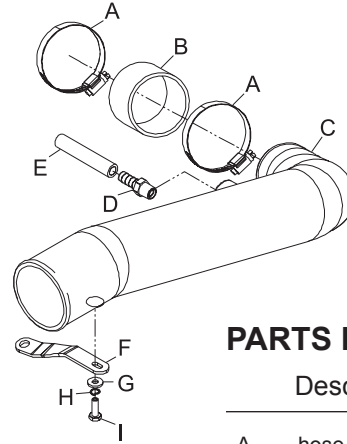
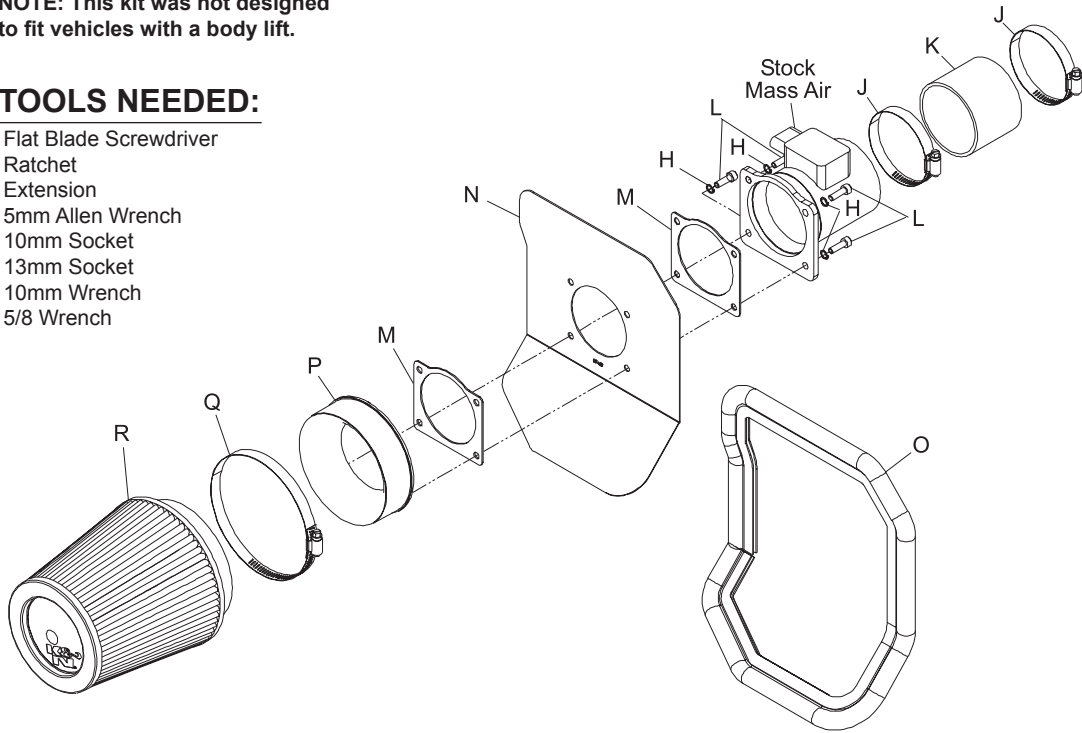

## PARTS LIST:

Description	Qty.	Part #
A hose clamp #36	2	08530
B hose; 2.375" id x 2.0" L	1	08405
C intake tube (DF)	1	087101
D 1/4" npt-3/8" barb	1	08047
E hose; 3/8" id x 3.0" L	1	08462
F bracket	1	07183
G flat washer; 1/4" id x 5/8" od	1	08275
H split lock washer	5	08198
I bolt; 6mm-1.00 x 10mm	1	07863
J hose clamp #44	2	08577
K hose; 3.0" id x 2.0" L	1	08192
L bolt; 6mm-1.00 x 20mm	4	07852
M gasket mass air sensor	2	09202
N heat shield	1	07467
O edge trim 39" L	1	102496
P adaptor #350	1	21510
Q hose clamp #80	1	08694
R filter	1	RF-1037

**NOTE: FAILURE TO FOLLOW INSTALLATION INSTRUCTIONS AND NOT USING THE PROVIDED HARDWARE MAY DAMAGE THE INTAKE TUBE, THROTTLE BODY AND ENGINE.**

## TO START:

1. Turn off the ignition and disconnect the negative battery cable.  
**NOTE: Disconnecting the negative battery cable erases pre-programmed electronic memories. Write down all memory settings before disconnecting the negative battery cable. Some radios will require an anti-theft code to be entered after the battery is reconnected. The anti-theft code is typically supplied with your owner's manual. In the event your vehicles' anti-theft code cannot be recovered, contact an authorized dealership to obtain your vehicles anti-theft code.**

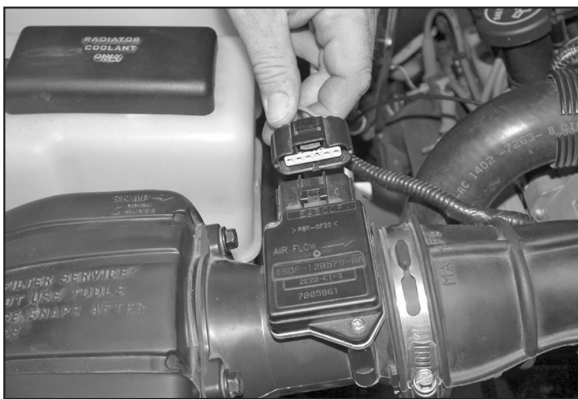

2. Disconnect the mass air electrical connection, then disconnect wiring harness from intake tube.

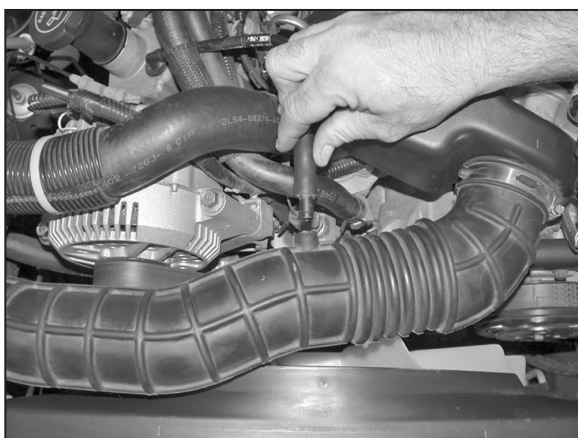

3. Disconnect the crank case vent from intake tube as shown.



4. Loosen the hose clamps at the throttle body and at the mass air sensor, then remove the intake tube as shown.

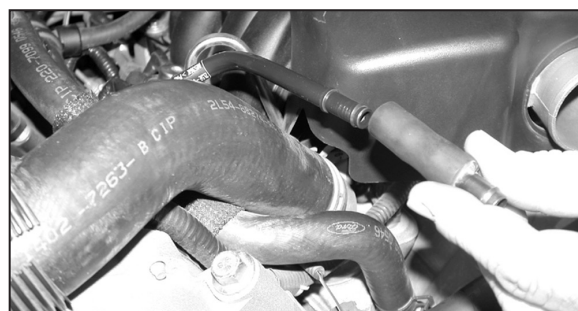

5. Remove rubber hose from crank case vent line as shown.



6. Slide a flat blade screwdriver in between the air cleaner and the air cleaner mounting tray. Pry downwards on the tray, while pulling upwards on the air cleaner assembly to release the assembly from the retaining grommets in the tray.

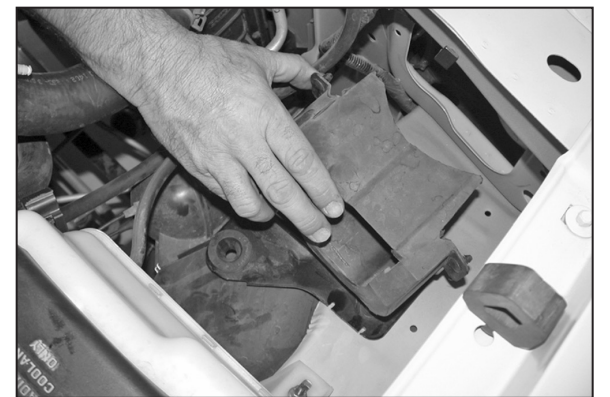

7. Pull firmly on the air inlet duct to release the duct from the radiator core support as shown.  
**NOTE: K&N Engineering, Inc., recommends that customers do not discard factory air intake.**

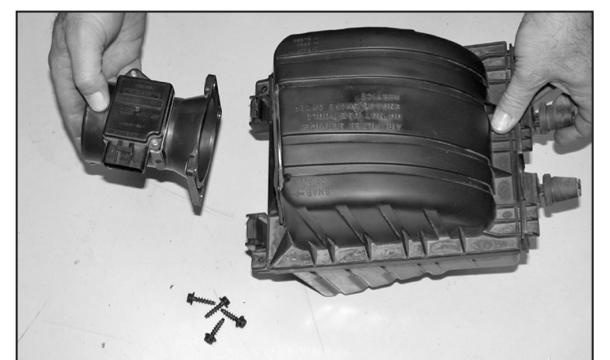

8. Loosen and remove the four hex bolts that secure the mass air sensor, then, remove the mass air sensor from the air cleaner as shown.

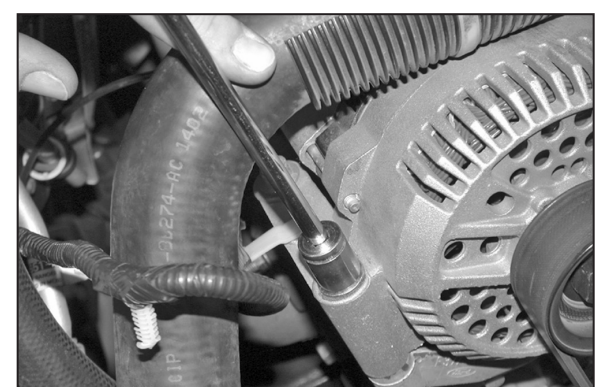

9. Loosen and remove the lower front alternator hex bolt as shown.



10. Mount the provided bracket onto the new K&N® intake tube with the provided hardware as shown.



11. Install the vent fitting into the new intake tube as shown.

**NOTE: Plastic NPT fittings are easy to cross thread. Install the vent fitting "hand" tight, then turn it two complete turns with a wrench.**

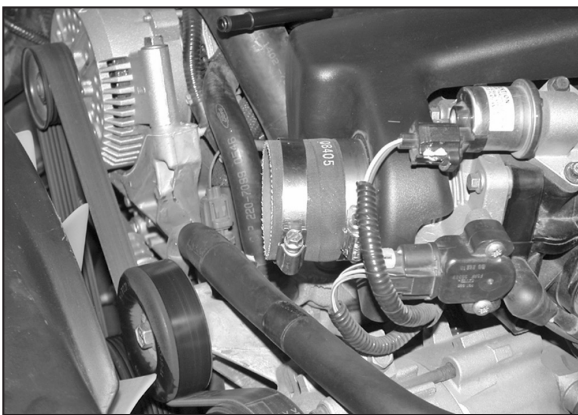

12. Install the provided silicone hose (08405) onto the throttle body as shown.



13. Install the intake tube onto the throttle body, then using the bolt removed in step #9 secure the bracket onto the alternator as shown.



14. Assemble the mass air adaptor, heat shield, gaskets and the mass air sensor as shown using the provided hardware.



15. Install the edge trim onto the heat shield as shown. Trim if needed.

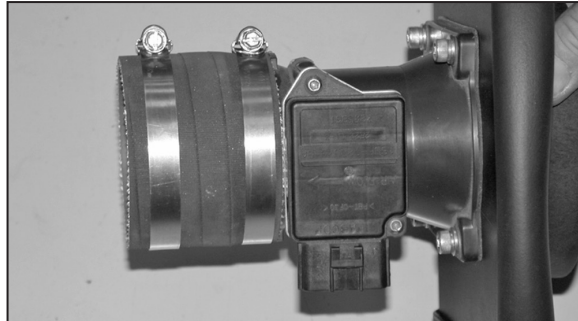

16. Install the silicone hose (08192) onto the throttle body using the provided hose clamps.

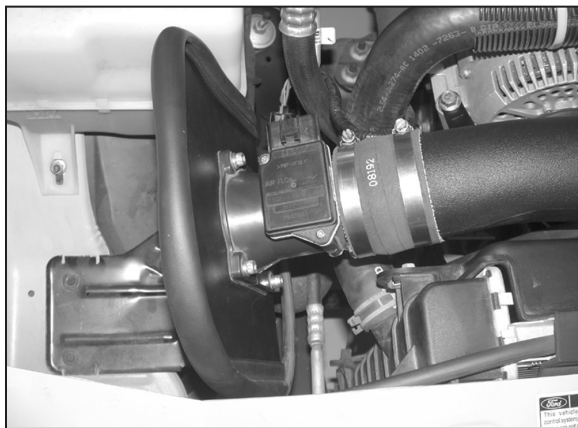

17. Install the mass air assembly onto the intake tube then secure with the provided hose clamps.

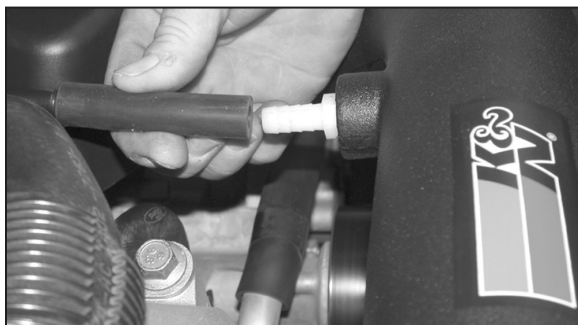

18. Install the provided silicone hose onto the crank case vent line, then attach to the intake tube as shown.



19. Install the K&N® filtercharger onto the mass air assembly as shown.

**NOTE: Drycharger® air filter wrap; part # RF-1037DK is available to purchase separately.**



20. Reconnect the mass air electrical connection as shown.



21. Reconnect the vehicle's negative battery cable. Double check to make sure everything is tight and properly positioned before starting the vehicle.

22. The C.A.R.B. exemption sticker, (attached), must be visible under the hood so that an emissions inspector can see it when the vehicle is required to be tested for emissions. California requires testing every two years, other states may vary.

23. It will be necessary for all K&N® high flow intake systems to be checked periodically for realignment, clearance and tightening of all connections. Failure to follow the above instructions or proper maintenance may void warranty.

#### ROAD TESTING:

1. Start the engine with the transmission in neutral or park, and the parking brake engaged. Listen for air leaks or odd noises. For air leaks secure hoses and connections. For odd noises, find cause and repair before proceeding. This kit will function identically to the factory system except for being louder and much more responsive.

2. Test drive the vehicle. Listen for odd noises or rattles and fix as necessary.

3. If road test is fine, you can now enjoy the added power and performance from your kit.

4. K&N Engineering, Inc., requires cleaning the intake system's air filter element every 100,000 miles. When used in dusty or off-road environments, our filters will require cleaning more often. We recommend that you visually inspect your filter once every 25,000 miles to determine if the screen is still visible. When the screen is no longer visible some place on the filter element, it is time to clean it. To clean and re-oil, purchase our filter Recharger® service kit, part number 99-5050 or 99-5000 and follow the easy instructions.