



# INSTALLATION INSTRUCTIONS

57-2523-2

FORD

1996-01 Mustang SVT Cobra

2001 Mustang GT Bullitt

V8-4.6L

**TOOLS NEEDED:**

- flat blade screwdriver
- phillips screwdriver
- 8mm wrench
- 10mm wrench
- 5mm allen wrench
- ratchet
- socket extension
- 8mm socket
- pair of vise grips
- drill
- 3/16" drill bit

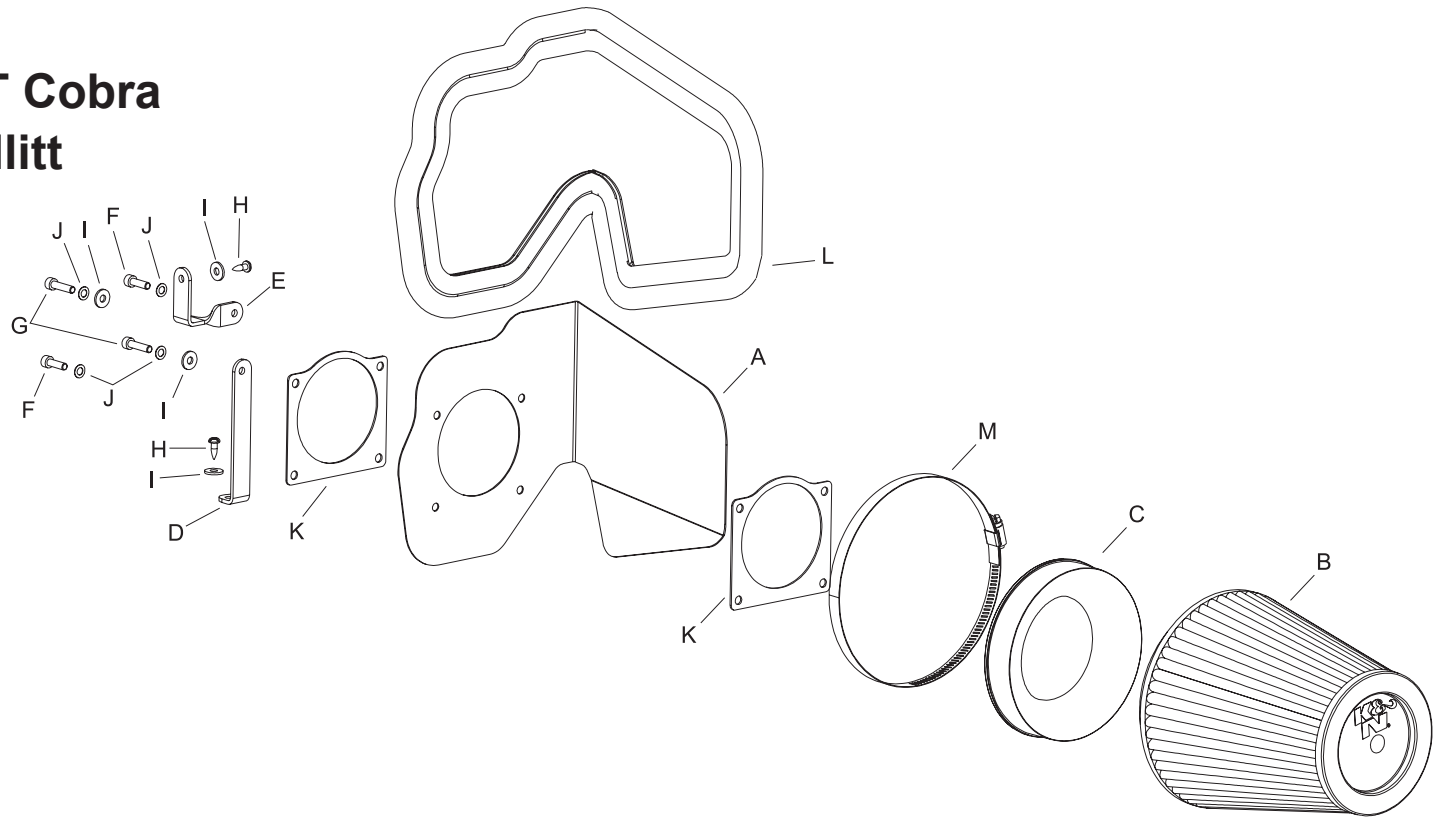

**PARTS LIST:**

Description	Qty.	Part #	Description	Qty.	Part #	Description	Qty.	Part #
A Heat Shield	1	07421	F 6mm-1.00 x 20mm Allen Bolt	2	07852	K Gasket	2	09984
B Air Filter	1	RF-1048	G 6mm-1.00 x 25mm Allen Bolt	2	07859	L Trim Seal 44"L	1	102486
C Adapter	1	08785	H Sheet Metal Screw	2	07788	M Hose Clamp #104	1	08697
D "L" Bracket	1	07089	I Flat Washer	4	08275			
E "L" Twist Bracket	1	07954	J Wave Washer	4	08174			

**NOTE: FAILURE TO FOLLOW INSTALLATION INSTRUCTIONS AND NOT USING THE PROVIDED HARDWARE MAY DAMAGE THE INTAKE TUBE, THROTTLE BODY AND ENGINE.**

**TO START:**

1. Turn off the ignition and disconnect the negative battery cable.  
**NOTE: Disconnecting the negative battery cable erases pre-programmed electronic memories. Write down all memory settings before disconnecting the negative battery cable. Some radios will require an anti-theft code to be entered after the battery is reconnected. The anti-theft code is typically supplied with your owner's manual. In the event your vehicles anti-theft code cannot be recovered, contact an authorized dealership to obtain your vehicles anti-theft code.**

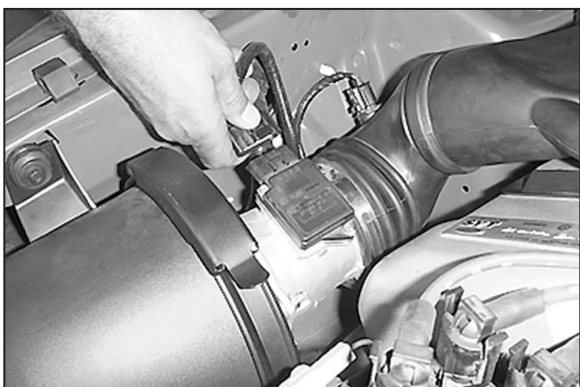

2. Disconnect the mass air sensor electrical connections.

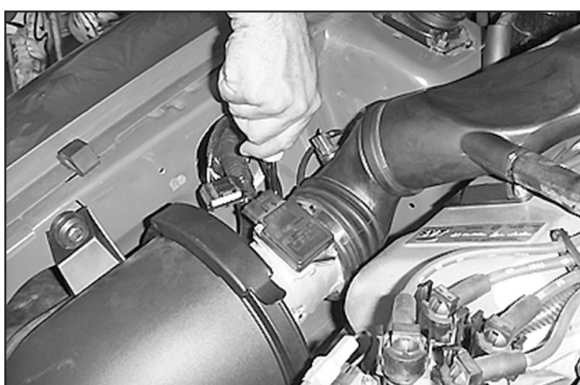

3. Loosen the hose clamp on the intake tube at the mass air sensor.



4. Loosen and remove the bolt that retains the air cleaner assembly.



5. Pull the air cleaner assembly upward and remove from vehicle.  
**NOTE: K&N Engineering, Inc., recommends that customers do not discard factory air intake.**



6. Loosen and remove the four nuts that retain the mass-air sensor to the air cleaner.  
**NOTE: It may be necessary to use a pair of vise grips to hold the studs while loosening the nuts.**

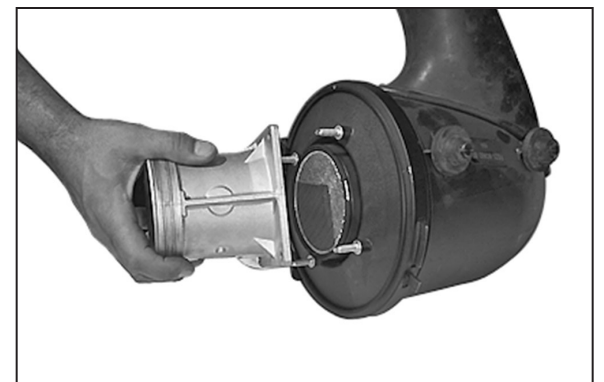

7. Remove the mass air sensor from the air cleaner.  
**NOTE: The screen will not be used.**



8. Assemble the mass air sensor, adapter, gaskets, heat shield and brackets using the hardware provided.



9. Install the mass air assembly into the intake tube.



10. Align the brackets to the inner fender and lower fender then mark.

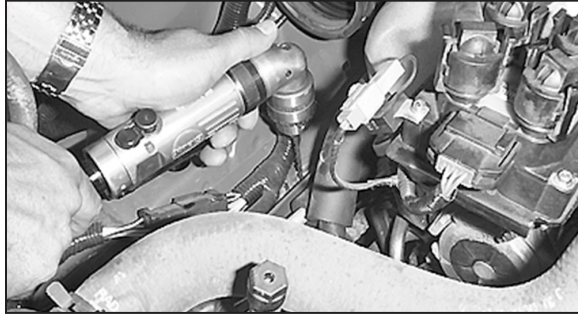

11. Remove the mass air assembly from the vehicle and using a 3/16" drill bit, drill out the two marks.

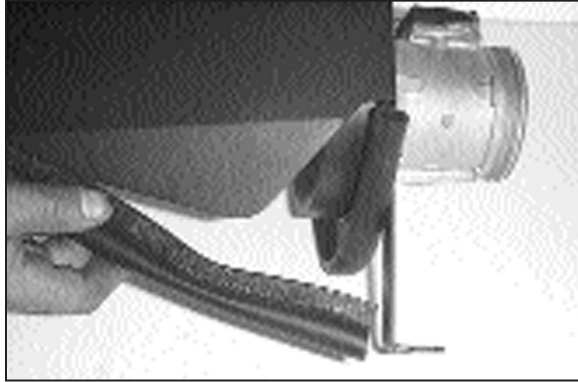

12. Install the trim seal onto the heat shield.

13. Reinstall the mass air assembly into the intake tube and secure the brackets with the sheet metal screws provided.

14. Tighten the hose clamp on the intake tube at the mass air sensor.

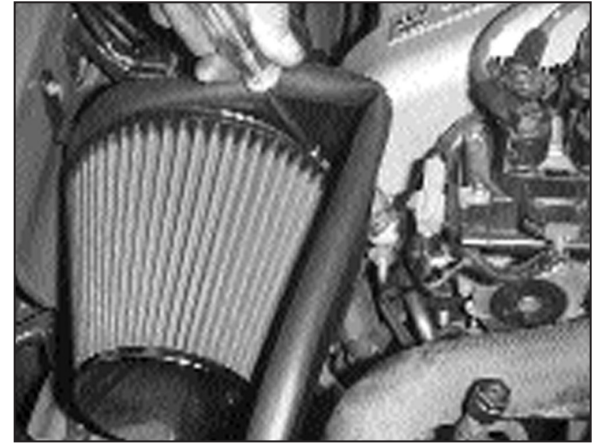

15. Install the [air filter](#) onto the adapter and secure it with the hose clamp provided.

**NOTE: Drycharger® air filter wrap; part # RF-1048DK is available to purchase separately.**

16. Reconnect the vehicle's negative battery cable. Double check to make sure everything is tight and properly positioned before starting the vehicle.

17. The C.A.R.B. exemption sticker, (attached), must be visible under the hood so that an emissions inspector can see it when the vehicle is required to be tested for emissions. California requires testing every two years, other states may vary.

18. It will be necessary for all K&N® high flow intake systems to be checked periodically for realignment, clearance and tightening of all connections. Failure to follow the above instructions or proper maintenance may void warranty.

#### ROAD TESTING:

1. Start the engine with the transmission in neutral or park, and the parking brake engaged. Listen for air leaks or odd noises. For air leaks secure hoses and connections. For odd noises, find cause and repair before proceeding. This kit will function identically to the factory system except for being louder and much more responsive.

2. Test drive the vehicle. Listen for odd noises or rattles and fix as necessary.

3. If road test is fine, you can now enjoy the added power and performance from your kit.

4. K&N Engineering, Inc., requires cleaning the intake system's air filter element every 100,000 miles. When used in dusty or off-road environments, our filters will require cleaning more often. We recommend that you visually inspect your filter once every 25,000 miles to determine if the screen is still visible. When the screen is no longer visible some place on the filter element, it is time to clean it. To clean and re-oil, purchase our filter Recharger® service kit, part number 99-5050 or 99-5000 and follow the easy instructions.