



# INSTALLATION INSTRUCTIONS

**57-1556**  
**DODGE**  
**2007-2010 Nitro**  
**V6-4.0L**

**NOTE:** This kit was not designed to fit vehicles with a body lift.

**TOOLS NEEDED:**

- 10mm Socket
- 10mm Wrench
- Extension
- Flat Blade Screwdriver
- Ratchet

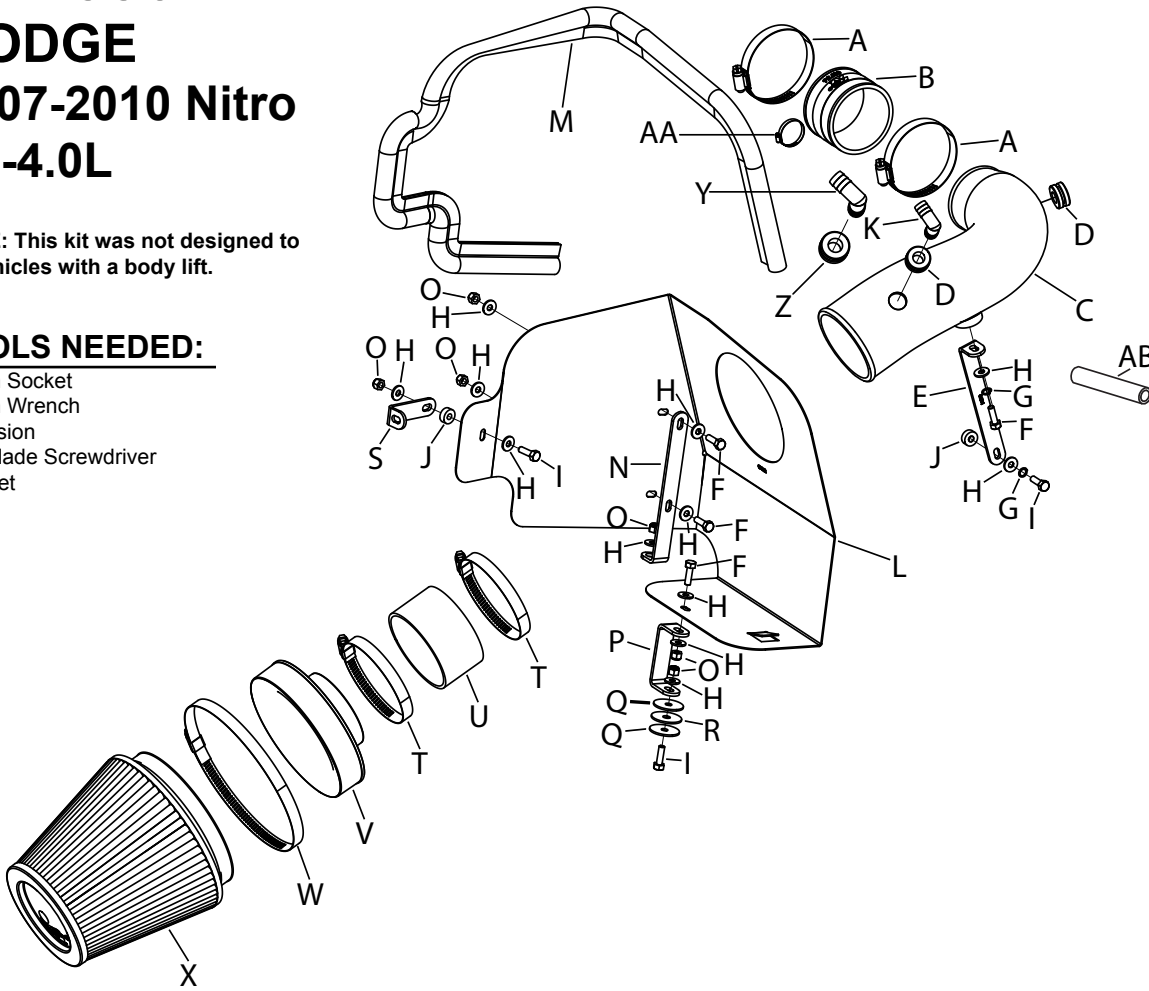

**PARTS LIST:**

Description	Qty.	Part #
A	Hose Clamp; #44	2 08577
B	Hose; 2.75"ID X 2"L, Black Silicone	1 08756
C	Intake Tube	1 087221
D	Grommet; 1"OD, 1/2"ID, 1/2"Thk.	2 08064
E	Bracket; "L", STL, FB/PC	1 06511
F	Bolt; 6MM-1.00 X 16MM, SS	4 07812
G	Washer; 1/4" Lock, ZN	2 08198
H	Washer; 6MM Flat, SS	12 08269
I	Bolt; M6 X 1.00" X 20MM Hex, SS	3 07795
J	Spacer: .625" OD X .250"ID X .250"L	2 06555
K	Vent; 1/2 X 1/2 Plastic Elbow, Blk.	1 08065
L	Heat Shield	1 07362
M	Edge Trim	1 102499
N	Bracket; Lg."L", Mild STL, FB/PC	1 07159
O	Nut; 6MM Nylock, Hex Head, SS	6 07512
P	Bracket; "C", STL, FB/PC	1 070052
Q	Washer; 1.25D X .28	2 08151
R	Washer; 1.25 X .30 X .10 Rubber	1 21708
S	Bracket; "L", STL, FB/PC	1 07805
T	Hose Clamp; #56	2 08620
U	Hose; 3.5"ID X 2"L, Black Silicone	1 08630
V	Adaptor; #380	1 21512-1
W	Hose Clamp #104	1 08697
X	Air Filter	1 RF-1042
Y	Vent; 5/8 Plastic Elbow	1 08072
Z	Grommet; 1-1/8"OD, 5/8"ID, 3/8"Thk.	1 080601
AA	Hose Clamp #10 Mini	1 08411
AB	Hose	1 08538

**NOTE: FAILURE TO FOLLOW INSTALLATION INSTRUCTIONS AND NOT USING THE PROVIDED HARDWARE MAY DAMAGE THE INTAKE TUBE, THROTTLE BODY AND ENGINE.**

**TO START:**

1. Turn the ignition off and disconnect the vehicle's negative battery cable.

**NOTE:** Disconnecting the negative battery cable erases pre-programmed electronic memories. Write down all memory settings before disconnecting the negative battery cable. Some radios will require an anti-theft code to be entered after the battery is reconnected. The anti-theft code is typically supplied with your owner's manual. In the event your vehicles' anti-theft code cannot be recovered, contact an authorized dealership to obtain your vehicles anti-theft code.



2. Disconnect the crank case vent hose from the air box lid as shown, then un-hook the crank case vent tube from the retaining clip.



3. Release the red locking tab, then disconnect the air temperature sensor electrical connection.



4. Loosen the two hose clamps that secure the stock intake tube, then remove the stock intake tube as shown.



5. Pull up firmly on the air box assembly and remove it from the vehicle as shown.  
**NOTE:** The fresh air duct must be disconnected from the air box.  
**NOTE:** K&N Engineering, Inc., recommends that customers do not discard factory air intake.

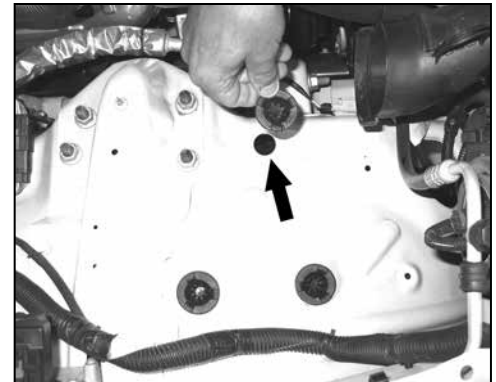

6. Remove the inner air box retaining grommet as shown.

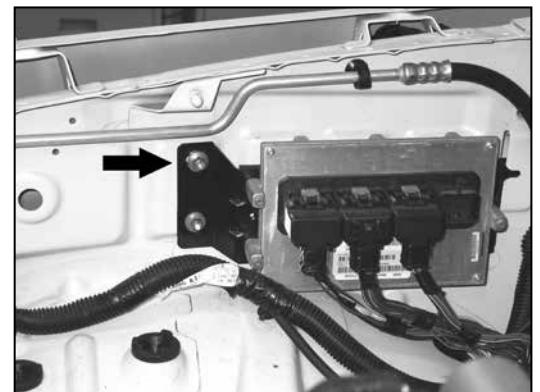

7. On 2007 model year vehicles, remove the ECU mounting nut shown.  
**NOTE:** This nut will be re-used in a later step.



7a. On 2008 and later model vehicles, remove the ECU mounting bolt shown.  
**NOTE:** This bolt will be re-used in a later step.



8. Remove the timing cover bolt (shown).



9. Install silicone hose (#08756) onto the throttle body and secure with the provided hose clamp.



10. Install the tube mounting bracket (#06511) onto the K&N® intake tube (as shown) using the provided hardware.



11. Install the provided grommets into the K&N® intake tube as shown.



12. Install the provided 90° fitting into the grommet installed into the K&N® intake tube as shown.  
**NOTE: On 2008 and later vehicles, it will be necessary to drill out the crank case vent hole to 7/8" id and install the larger grommet provided.**



13. Remove the air temperature sensor from the stock intake tube as shown.



14. Install the air temperature sensor into the grommet installed into the K&N® intake tube as shown.



15. Install the K&N® intake tube into the silicone hose at the throttle body and align the mounting bracket with the timing cover bolt location (removed in step #8).



16. Secure the tube mounting bracket to the timing cover with the provided hardware as shown.

**NOTE: The spacer is to be placed between the bracket and timing cover.**



17. Re-connect the air temperature sensor electrical connection.



18. Connect the crank case vent hose to the 90° fitting installed into the K&N® intake tube as shown.



19. Install the heat shield mounting bracket (#07159) onto the heat shield using the provided hardware as shown.



20. Install the provided edge trim onto the heat shield, starting at the bracket installed in step #19.  
**NOTE: Some trimming of the edge trim may be necessary.**



21. Install the heat shield mounting bracket (#070052) to the bottom of the heat shield using the provided hardware as shown.



22. On 2007 model year vehicles, install the heat shield mounting bracket (#07805) to the side of the heat shield using the provided hardware.  
**NOTE: The provided spacer is to be placed between the bracket and heat shield.**



23. Install the heat shield into the engine compartment. Align the bottom rear mounting bracket with the threaded stud on the lower inner fender. Align the upper rear mounting bracket with the ECU mounting stud. Secure with the factory ECU mounting nut and provided hardware.  
**NOTE: The fresh air duct must be aligned with the mounting tab on the bottom of the heat shield.**

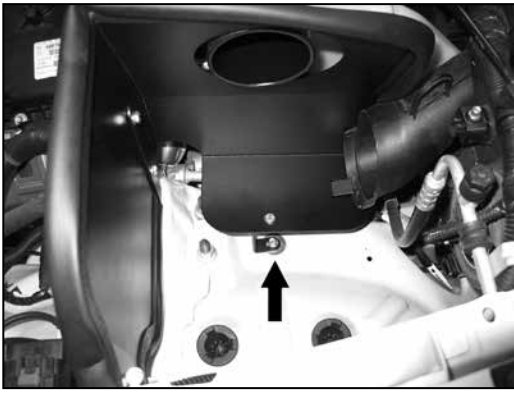

24. Secure the lower mounting bracket to the lower inner fender with the provided hardware.

**NOTE: Access to secure the lower mounting bracket is through the fender well.**

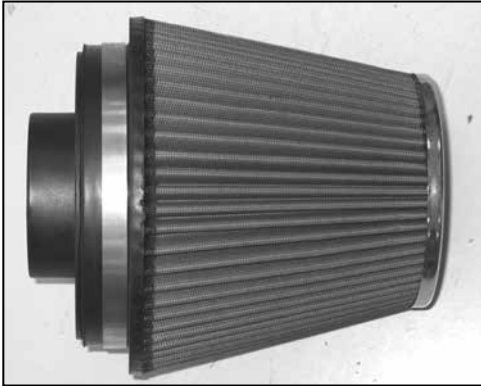

25. Install the provided air filter adapter into the K&N® air filter and secure with the provided hose clamp.



26. Install silicone hose (#08630) onto the [air filter](#) adapter and secure with the provided hose clamp.



27. Install the K&N® filter assembly onto the intake tube and secure with the provided hose clamp. Then connect the crank case vent line to the hose mender as shown and secure with the provided hose clamp.



28. Re-connect the vehicle's negative battery cable. Ensure everything is tight and properly positioned before starting the vehicle.

29. The C.A.R.B. exemption sticker, (attached), must be visible under the hood so that an emissions inspector can see it when the vehicle is required to be tested for emissions. California requires testing every two years, other states may vary.

30. It will be necessary for all K&N® high flow intake systems to be checked periodically for realignment, clearance and tightening of all connections. Failure to follow the above instructions or proper maintenance may void warranty.

#### ROAD TESTING:

1. Start the engine with the transmission in neutral or park, and the parking brake engaged. Listen for air leaks or odd noises. For air leaks secure hoses and connections. For odd noises, find cause and repair before proceeding. This kit will function identically to the factory system except for being louder and much more responsive.

2. Test drive the vehicle. Listen for odd noises or rattles and fix as necessary.

3. If road test is fine, you can now enjoy the added power and performance from your kit.

4. K&N Engineering, Inc., requires cleaning the intake system's air filter element every 100,000 miles. When used in dusty or off-road environments, our filters will require cleaning more often. We recommend that you visually inspect your filter once every 25,000 miles to determine if the screen is still visible. When the screen is no longer visible some place on the filter element, it is time to clean it. To clean and re-oil, purchase our filter Recharger® service kit, part number 99-5050 or 99-5000 and follow the easy instructions.