



# INSTALLATION INSTRUCTIONS

**57-1536**  
**DODGE**  
**2003-06 Viper**  
**V10-8.3L**

**TOOLS NEEDED:**

- Flat Blade Screwdriver
- Phillips Screwdriver
- Pliers

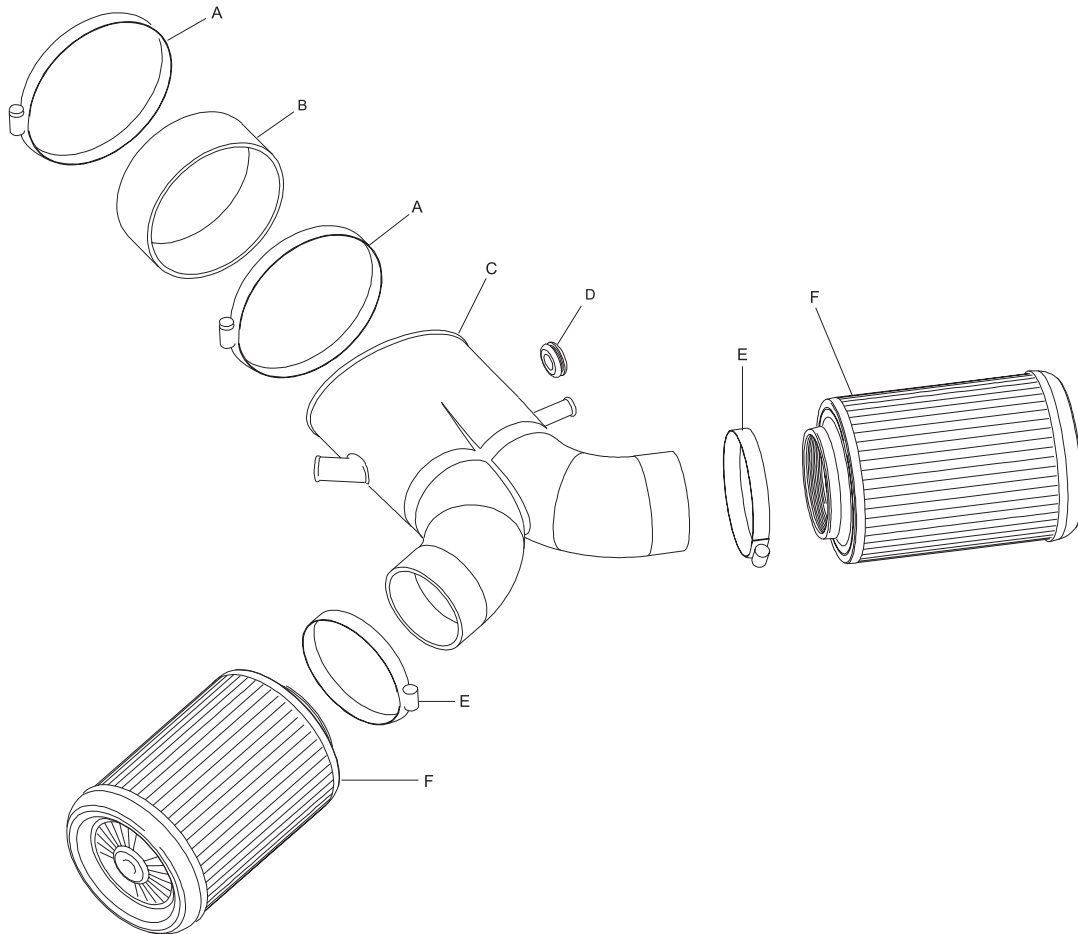

**PARTS LIST:**

	Description	Qty.	Part #
A	hose clamp #72	2	08671
B	silicone hose	1	08540
C	intake tube (DK)	1	087106
D	grommet	1	080544
E	hose clamp #48 mini	2	08605
F	Air Filter	2	RX-2820

**NOTE: FAILURE TO FOLLOW INSTALLATION INSTRUCTIONS AND NOT USING THE PROVIDED HARDWARE MAY DAMAGE THE INTAKE TUBE, THROTTLE BODY AND ENGINE.**

**TO START:**

1. Turn off the ignition and disconnect the negative battery cable.  
**NOTE: Disconnecting the negative battery cable erases pre-programmed electronic memories. Write down all memory settings before disconnecting the negative battery cable. Some radios will require an anti-theft code to be entered after the battery is reconnected. The anti-theft code is typically supplied with your owner's manual. In the event your vehicles' anti-theft code cannot be recovered, contact an authorized dealership to obtain your vehicles anti-theft code.**



2. Disconnect air temp sensor electrical connection.

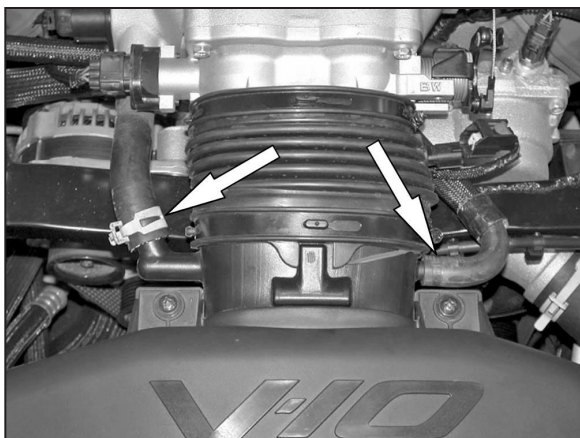

3. Disconnect crank case vent hose and idle air vent hose.



4. Loosen the six airbox cover screws and remove airbox lid.



5. Loosen intake tube hose clamp at throttle body, and remove wing nut under tube. Then remove complete intake assembly.  
**NOTE: K&N Engineering, Inc., recommends that customers do not discard factory air intake.**

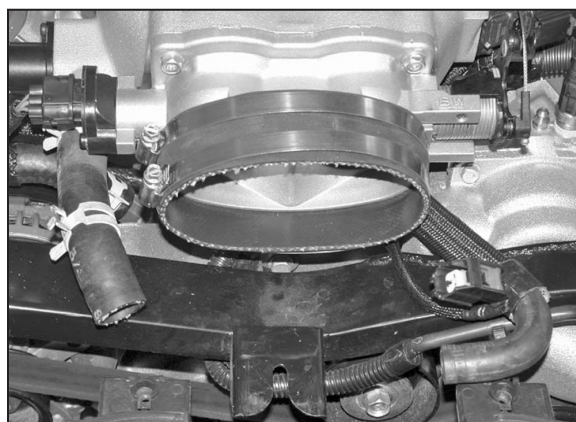

6. Install silicone hose (08540) onto throttle body with hose clamps provided.



7. Install the provided rubber grommet into K&N® intake tube.



8. Remove the air temp sensor from the stock intake tube.



9. Install the air temp sensor into the K&N® intake tube.



10. Install the air filter onto the K&N® intake tube.



11. Install the K&N® intake assembly onto the vehicle as shown.

**NOTE: Position Filterchargers into mounting tabs in lower filter tray.**



12. Reinstall upper airbox cover removed in step #4 and tighten six mounting screws.

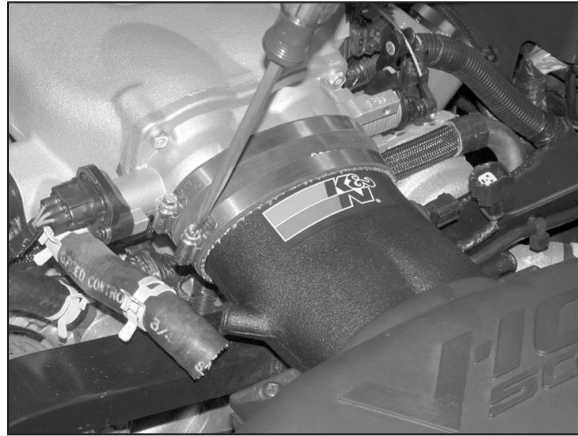

13. Tighten hose clamps at throttle body.



14. Install idle air hose and crank case vent hose onto K&N intake tube as shown.

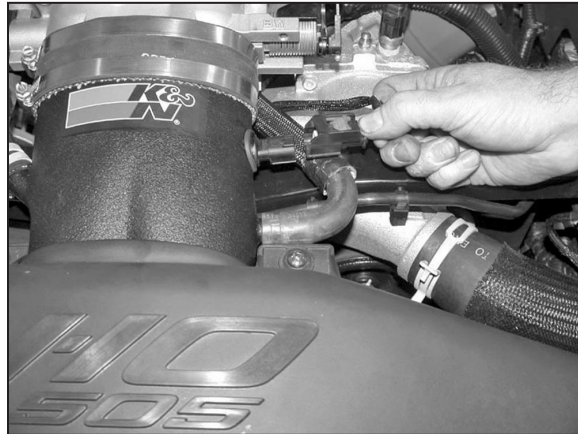

15. Reconnect air temp sensor electrical connection.



16. Reconnect the vehicle's negative battery cable. Double check to make sure everything is tight and properly positioned before starting the vehicle.

17. The C.A.R.B. exemption sticker, (attached), must be visible under the hood so that an emissions inspector can see it when the vehicle is required to be tested for emissions. California requires testing every two years, other states may vary.

18. It will be necessary for all K&N® high flow intake systems to be checked periodically for realignment, clearance and tightening of all connections. Failure to follow the above instructions or proper maintenance may void warranty.

#### ROAD TESTING:

1. Start the engine with the transmission in neutral or park, and the parking brake engaged. Listen for air leaks or odd noises. For air leaks secure hoses and connections. For odd noises, find cause and repair before proceeding. This kit will function identically to the factory system except for being louder and much more responsive.

2. Test drive the vehicle. Listen for odd noises or rattles and fix as necessary.

3. If road test is fine, you can now enjoy the added power and performance from your kit.

4. K&N Engineering, Inc., requires cleaning the intake system's air filter element every 100,000 miles. When used in dusty or off-road environments, our filters will require cleaning more often. We recommend that you visually inspect your filter once every 25,000 miles to determine if the screen is still visible. When the screen is no longer visible some place on the filter element, it is time to clean it. To clean and re-oil, purchase our filter Recharger® service kit, part number 99-5050 or 99-5000 and follow the easy instructions.