



# INSTALLATION INSTRUCTIONS

57-3077

CHEVROLET / GMC

2011-14 Silverado 2500 / 3500HD

2011-14 Sierra 2500 / 3500HD

V8-6.6L Turbo

NOTE: This kit was not designed to fit vehicles with a body lift.

### TOOLS NEEDED:

- 3mm Allen Wrench
- 8mm Socket
- 10mm Socket
- Extension
- Flat Blade Screwdriver
- Phillips Screwdriver
- Ratchet

### PARTS LIST:

Description	Qty.	Part #	Description	Qty.	Part #
A Hose Clamp # 64 Stainless	2	08645	M Washer; 1/4" ID X 5/8" OD- SAE	5	08275
B Hose; 4-3/16"ID X 3"L Hump Reinforced	1	08617	N Heat Shield Lid	1	074093
C Intake Tube	1	087253	O Edge Trim (30")	1	102489
D Hose Clamp # 80 Stainless	4	08685	P Heat Shield	1	074092
E Hose; 4.75"ID X 1.75"L Reinforced	2	08495	Q Bolt; 6mm-1.00 X 16mm, SS	2	07812
F Adapter; MAF Sensor Housing	1	088037-1	R Hose Clamp # 104	1	08697
G Bolt; M4-0.07 8mm, A/H Cap, SS	4	07733	S Air Filter	1	RC-5179
H Intake Tube	1	087254	T Block Off	1	21508
I Bolt; 5mm-.80 X 16mm Hex Head	3	22204	U Gasket	1	09076
J Washer; 5mm Internal Star Cut Lock	3	07724	V Wiring Pigtail	1	21782
K Bolt; M6 X 1.00" X 20mm Hex, SS	3	07795	W Plug	1	09711
L Washer; M6 Split Lock Zinc	5	1-3025			

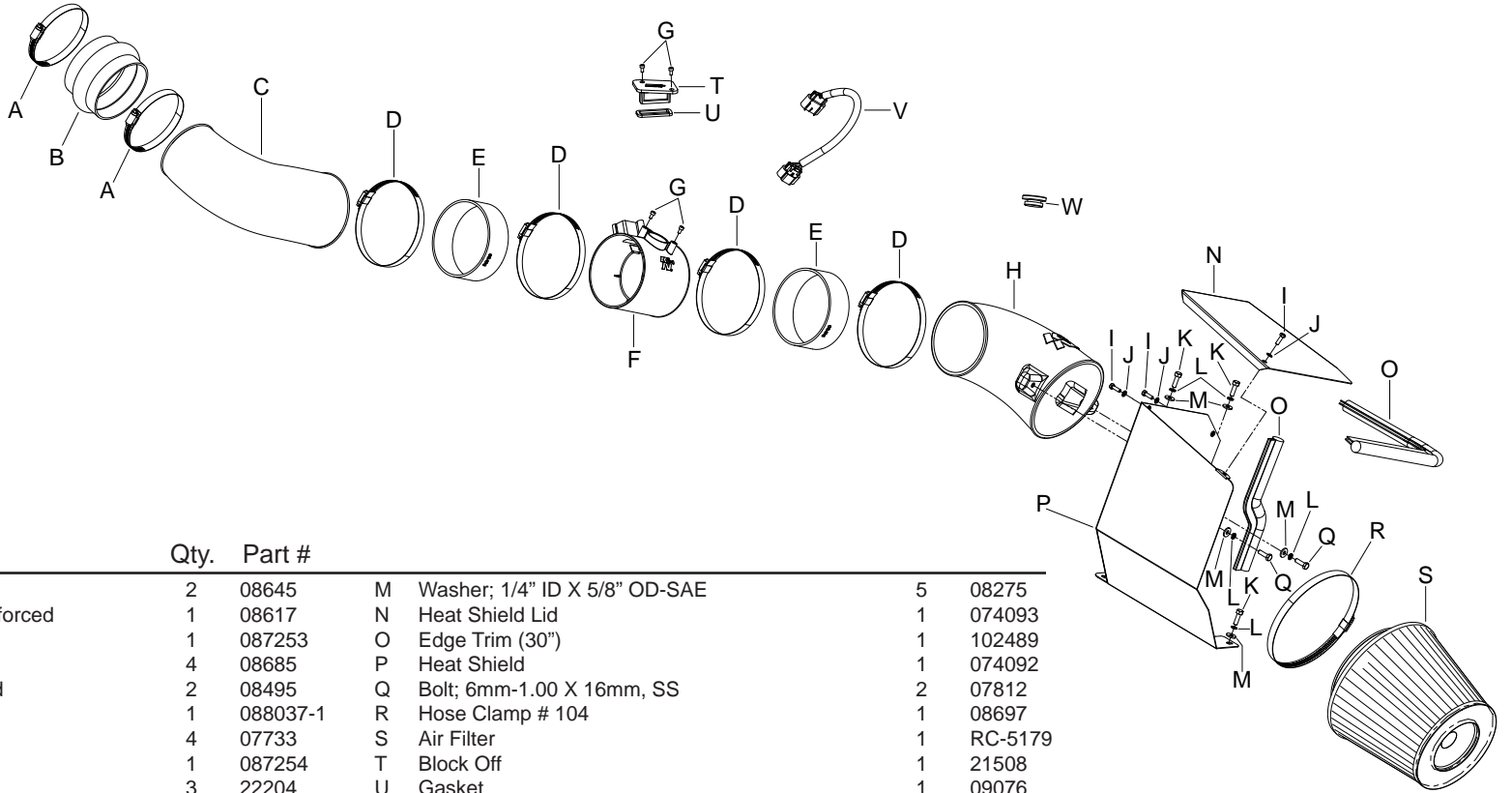

**NOTE: FAILURE TO FOLLOW INSTALLATION INSTRUCTIONS AND NOT USING THE PROVIDED HARDWARE MAY DAMAGE THE INTAKE TUBE, THROTTLE BODY AND ENGINE.**

### TO START:

1. Turn off the ignition and disconnect the negative battery cable.  
**NOTE: Disconnecting the negative battery cable erases pre-programmed electronic memories. Write down all memory settings before disconnecting the negative battery cable. Some radios will require an anti-theft code to be entered after the battery is reconnected. The anti-theft code is typically supplied with your owner's manual. In the event your vehicles' anti-theft code cannot be recovered, contact an authorized dealership to obtain your vehicles anti-theft code.**

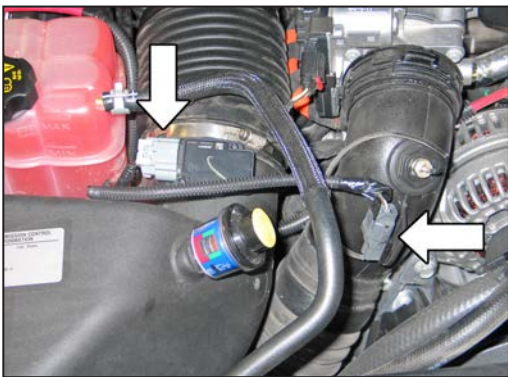

2. Disconnect the mass air sensor and the temperature electrical connection.



3. Loosen the hose clamps that secure the factory intake tube to the turbo inlet and air box.



4. Remove the factory intake tube from the vehicle.



5. Loosen the two screws securing the air box lid and then remove the air box lid and air filter.



6. Lift up the lower air box to dislodge it from the mounting grommets and then remove the lower air box from the vehicle.  
**NOTE: K&N Engineering, Inc., recommends that customers do not discard factory air intake.**

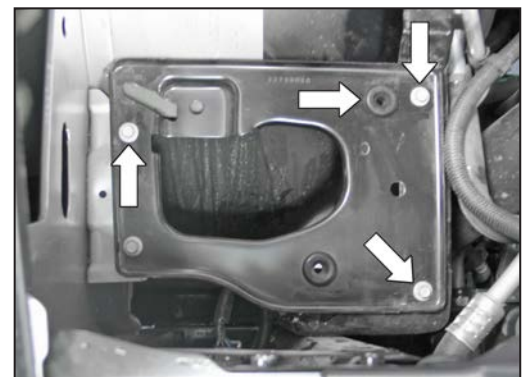

7. Remove the air box mounting grommet and mounting plate bolts shown.



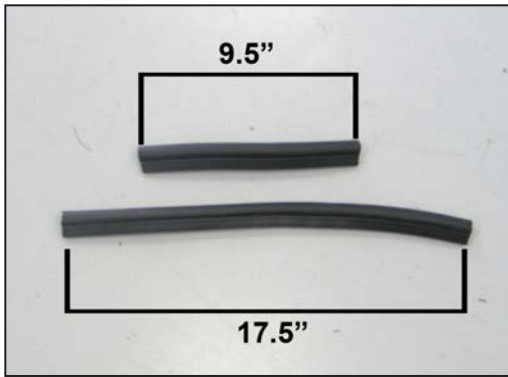

8. Cut the provided edge trim into two sections as shown, one is to be 9.5" long and the other section is to be 17.5" long.

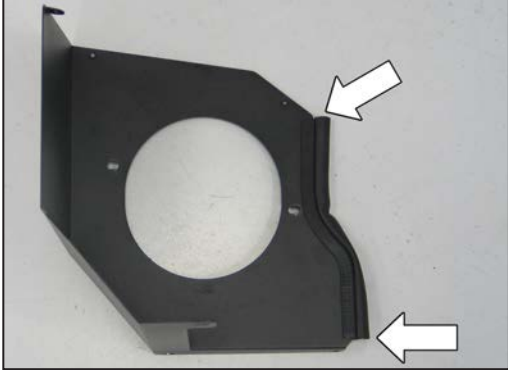

9. Install the 9.5" long section onto the heat shield as shown.



10. Install the 17.5" long section of edge trim onto the heat shield lid as shown.



11. Set the heat shield into position on the air box tray and then secure to the air box tray using the provided hardware.



12. Carefully set the K&N® air filter into position on top of the air box tray.



13. Remove the filter minder and grommet from the factory air box.



14. On vehicles that are equipped with a filter minder, install the provided grommet and the factory filter minder into the K&N® intake tube as shown. On vehicles not equipped with a filter minder, install the provided plug.



15. Install the K&N® intake tube into the heat shield and secure with the provided hardware. Then install the K&N® air filter onto the intake tube and secure with the provided hose clamp.



16. Remove the MAF sensors from the factory air box housing.  
**NOTE: On 2013 and later model year vehicles there will be two sensors that need to be removed.**



17. Install the mass air sensor into the K&N mass air sensor housing and secure with the provided hardware.  
**NOTE: 2013 and later model year vehicles will have two sensors, on 2012 and earlier model year vehicles it will be necessary to install the block-off plate and gasket.**



18. Install the two provided silicone hoses (08495) onto the K&N® mass air sensor housing as shown; secure with the provided hose clamps.  
**NOTE: Be sure to only slide the silicone hoses on half way so enough coupling is available to mount onto the intake tubes.**



19. Install the mass air sensor assembly onto the K&N® intake tube as shown and secure with the provided hose clamp.

**NOTE: Be sure to install the mass air sensor housing in the correct direction, the electrical connection should be pointed towards the passenger side of the vehicle.**



20. Install the provided hump hose (08617) onto the turbo inlet as shown and secure using the provided hose clamp.



21. Install the K&N® intake tube into the silicone hose at the turbo inlet and then into the silicone hose at the mass air sensor. Adjust the tubes and mass air sensor housing for best fit and then secure with the provided hose clamps.



22. Install the heat shield lid onto the heat shield and secure with the provided hardware.



23. Connect the provided MAF extension harness into the factory wiring harness and then connect the open end to the MAF sensor. On models equipped with the second sensor, reconnect the electrical connection at this time also.





24. Reconnect the vehicle's negative battery cable. Double check to make sure everything is tight and properly positioned before starting the vehicle.

25. The C.A.R.B. exemption sticker, (attached), must be visible under the hood so that an emissions inspector can see it when the vehicle is required to be tested for emissions. California requires testing every two years, other states may vary.

26. **NOTE:** Most General Motors vehicles have the Vehicle Emissions Certification Information (VECI) label affixed to the air filter box. In order to be compliant with California emissions laws, the label **MUST** remain in the engine compartment. If the Vehicle Emission Control Information label is removed during modification, a new replacement label must be obtained and installed in a readily visible position in the engine compartment. The label shall not be affixed to any equipment which is easily detached from the vehicle. We recommend that the label is affixed to the underside of the hood adjacent to the hood latch. The label is Vehicle Identification Number dependent and can be ordered from the vehicle dealership. In order to receive the proper decal please bring your VIN with you. Failure to have the VECI under the hood may result in failure of a pre-registration smog test.

27. It will be necessary for all K&N® high flow intake systems to be checked periodically for realignment, clearance and tightening of all connections. Failure to follow the above instructions or proper maintenance may void warranty.

#### ROAD TESTING:

1. Start the engine with the transmission in neutral or park, and the parking brake engaged. Listen for air leaks or odd noises. For air leaks secure hoses and connections. For odd noises, find cause and repair before proceeding. This kit will function identically to the factory system except for being louder and much more responsive.

2. Test drive the vehicle. Listen for odd noises or rattles and fix as necessary.

3. If road test is fine, you can now enjoy the added power and performance from your kit.

4. K&N Engineering, Inc., requires cleaning the intake system's air filter element every 100,000 miles. When used in dusty or off-road environments, our filters will require cleaning more often. We recommend that you visually inspect your filter once every 25,000 miles to determine if the screen is still visible. When the screen is no longer visible some place on the filter element, it is time to clean it. To clean and re-oil, purchase our filter Recharger® service kit, part number 99-5050 or 99-5000 and follow the easy instructions.