



# INSTALLATION INSTRUCTIONS

57-3075

CHEVROLET

2010-14 Camaro

V6-3.6L

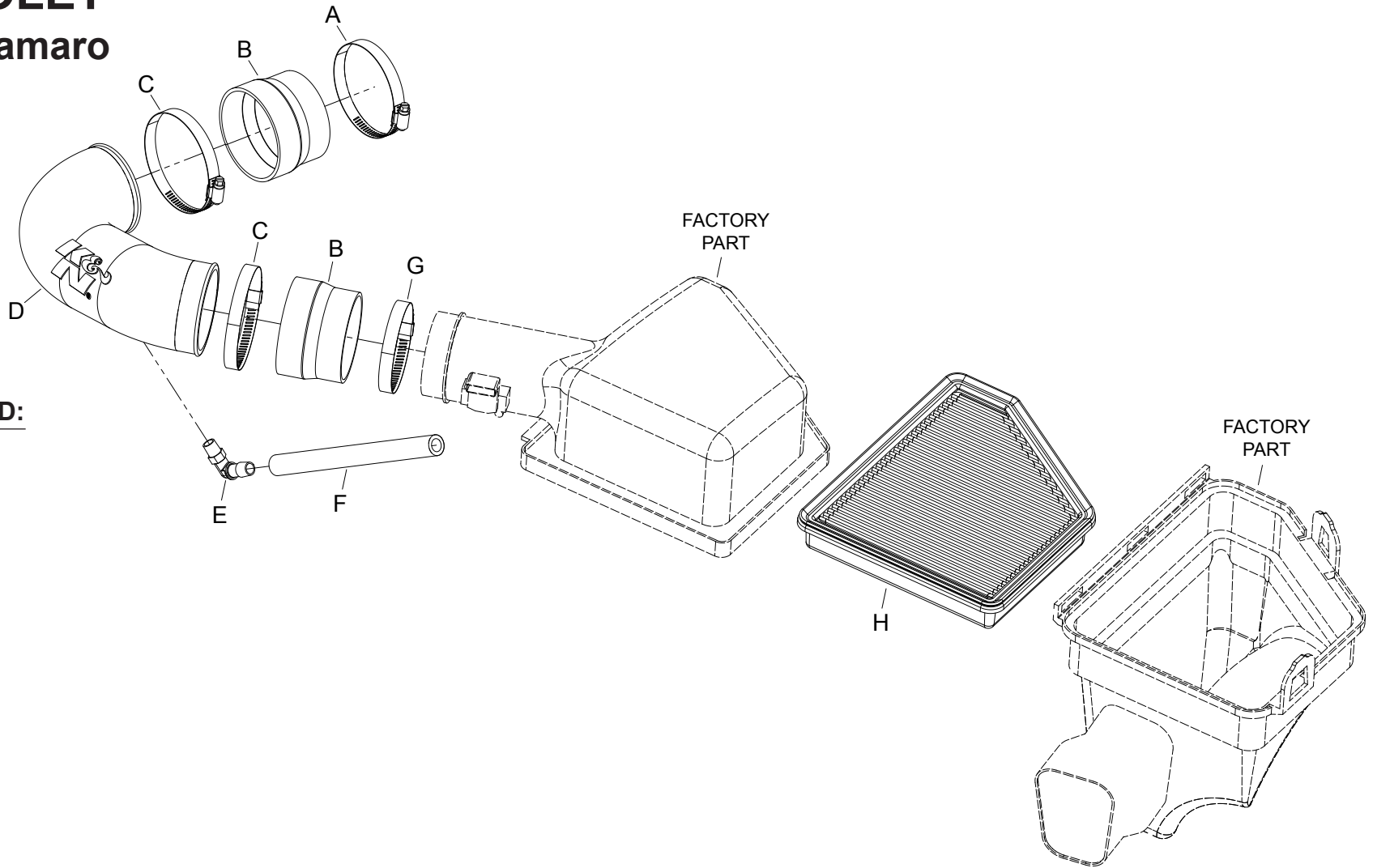

**TOOLS NEEDED:**

- Flat Blade
- Screw driver

**PARTS LIST:**

Description	Qty.	Part #	Description	Qty.	Part #	Description	Qty.	Part #
A Hose Clamp #48	1	08601	D Intake Tube	1	087273	G Hose Clamp #52	1	08610
B Hose; 3.5"ID TO 3.25"ID X 2.5"L	2	08496	E Vent; 90Deg, 1/2" Hose, 1/4"NPT	1	08110FK	H Air Filter	1	33-2434
C Hose Clamp #56	2	08620	F Hose; 1/2" ID X 9"L	1	08401			

**NOTE: FAILURE TO FOLLOW INSTALLATION INSTRUCTIONS AND NOT USING THE PROVIDED HARDWARE MAY DAMAGE THE INTAKE TUBE, THROTTLE BODY AND ENGINE.**

**TO START:**

1. Turn off the ignition and disconnect the negative battery cable.  
**NOTE: Disconnecting the negative battery cable erases pre-programmed electronic memories. Write down all memory settings before disconnecting the negative battery cable. Some radios will require an anti-theft code to be entered after the battery is reconnected. The anti-theft code is typically supplied with your owner's manual. In the event your vehicles anti-theft code cannot be recovered, contact an authorized dealership to obtain your vehicles anti-theft code.**



2. Remove the oil fill cap and then lift up the engine cover and remove it from the engine. Reinstall the oil fill cap at this time.

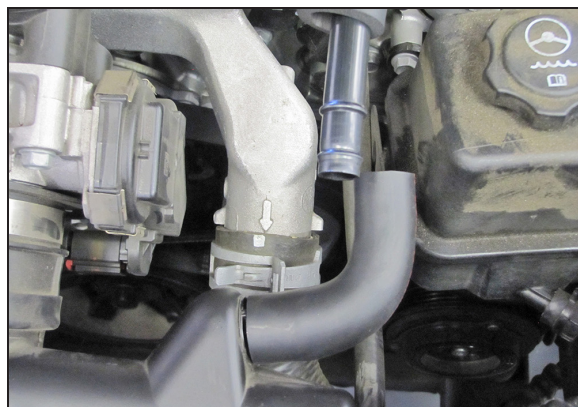

3. Disconnect the Crank case vent hose from the crank case vent tube.



4. Loosen the intake tube mounting clamps and then remove the factory intake tube from the vehicle.  
**NOTE: K&N Engineering, Inc., recommends that customers do not discard factory air intake.**



5. Releases the upper air box cover latches' and lift off the upper air box, then remove the factory air filter.



6. Install the provided K&N® air filter.



7. Reinstall the upper air box cover and latch into place.

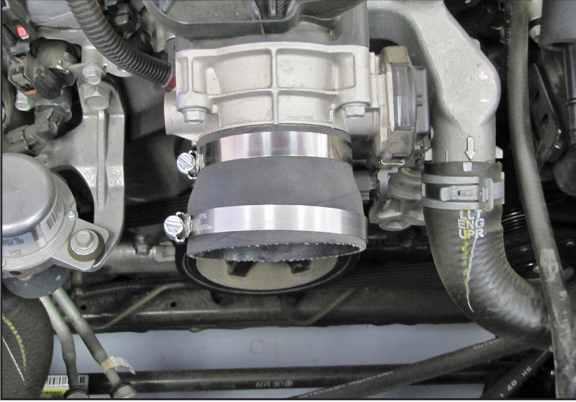

8. Install one of the provided coupling hoses onto the throttle body and secure with the provided hose clamps.

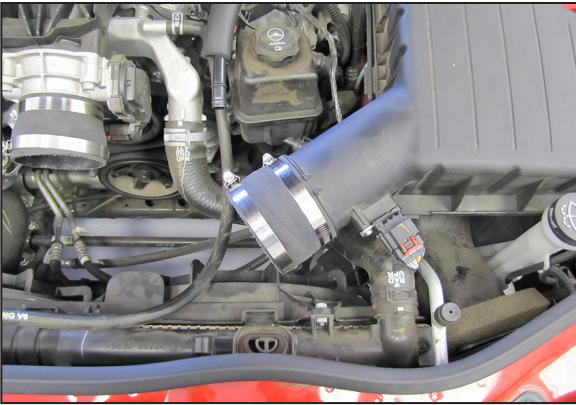

9. Install the remaining coupling hose onto the air box outlet and secure with the provided hose clamps.



10. Install the 90° fitting into the K&N® intake tube as shown.

**NOTE: Plastic NPT fittings are easy to cross thread. Install the vent fitting “hand” tight, then turn it two complete turns with a wrench.**



11. Install the K&N® intake tube into the coupling hose on the air box and then into the hose on the throttle body. Secure the tube with the provided hose clamps.

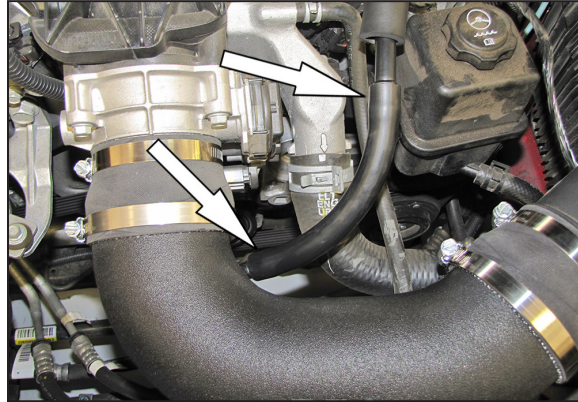

12. Connect the provided crank case breather hose onto the fitting installed into the K&N® intake tube and then attach the open end to the factory crank case vent tube.

**NOTE: Some trimming of the crank case hose will be necessary.**



13. Remove the oil fill cap; reinstall the engine cover and the reinstall the oil cap.



14. Reconnect the vehicle's negative battery cable. Double check to make sure everything is tight and properly positioned before starting the vehicle.

15. The C.A.R.B. exemption sticker, (attached), must be visible under the hood so that an emissions inspector can see it when the vehicle is required to be tested for emissions. California requires testing every two years, other states may vary.

16. It will be necessary for all K&N® high flow intake systems to be checked periodically for realignment, clearance and tightening of all connections. Failure to follow the above instructions or proper maintenance may void warranty.

#### ROAD TESTING:

1. Start the engine with the transmission in neutral or park, and the parking brake engaged. Listen for air leaks or odd noises. For air leaks secure hoses and connections. For odd noises, find cause and repair before proceeding. This kit will function identically to the factory system except for being louder and much more responsive.

2. Test drive the vehicle. Listen for odd noises or rattles and fix as necessary.

3. If road test is fine, you can now enjoy the added power and performance from your kit.

4. K&N Engineering, Inc., requires cleaning the intake system's air filter element every 100,000 miles. When used in dusty or off-road environments, our filters will require cleaning more often. We recommend that you visually inspect your filter once every 25,000 miles to determine if the screen is still visible. When the screen is no longer visible some place on the filter element, it is time to clean it. To clean and re-oil, purchase our filter Recharger® service kit, part number 99-5050 or 99-5000 and follow the easy instructions.