



INSTALLATION INSTRUCTIONS

57-3074

CHEVROLET

2010-14 Camaro SS

V8-6.2L

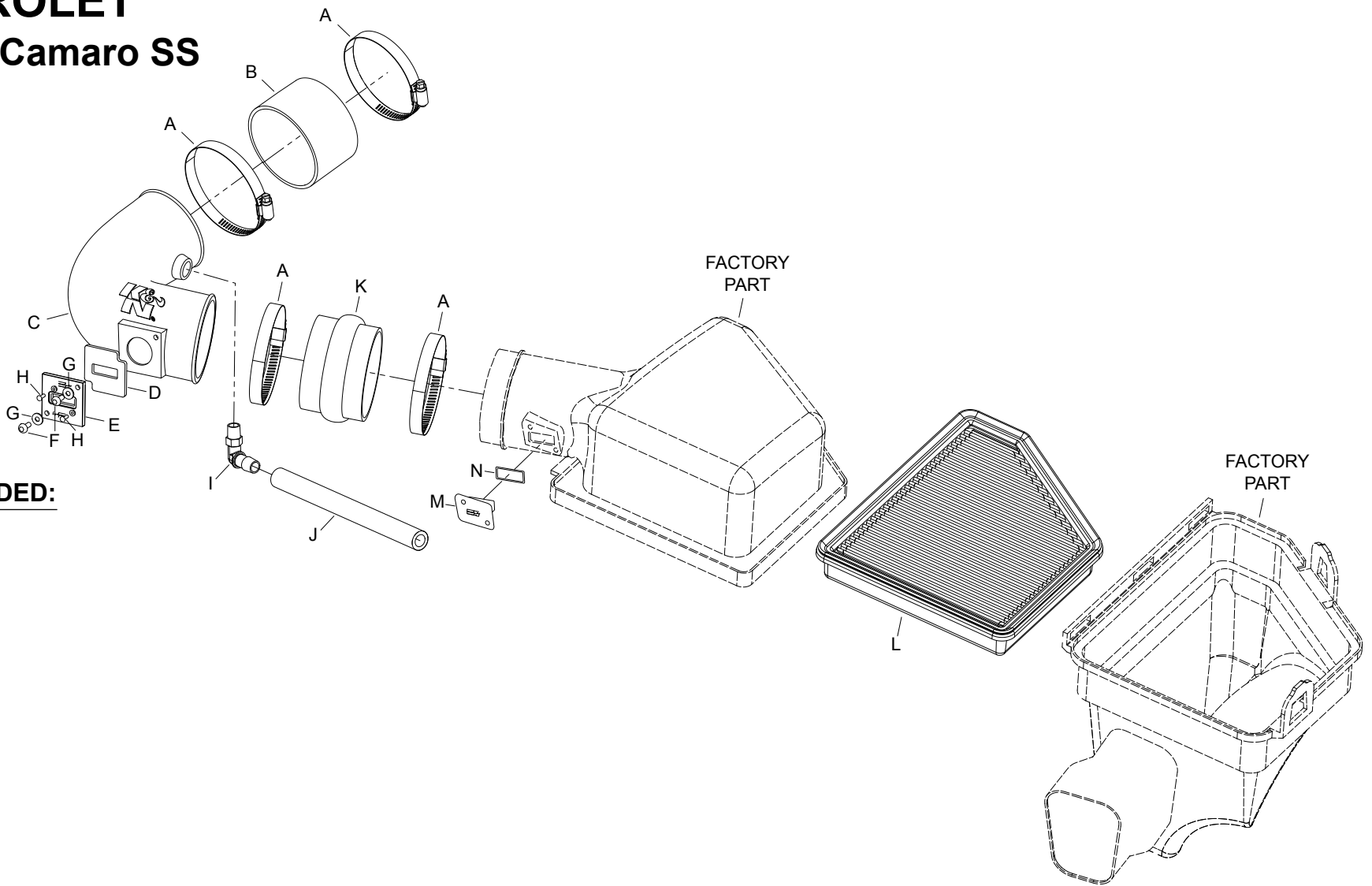

TOOLS NEEDED:

- Flat Blade
- Screw driver

PARTS LIST:

Description	Qty.	Part #	Description	Qty.	Part #	Description	Qty.	Part #
A HOSE CLAMP #64 STAINLESS	4	08645	F BOLT; M6 X 1.00 X 16MM	2	07730	K HOSE; 4" ID X 3" L HUMP	1	08418
B HOSE; 4" ID X 2" L	1	08761	G WASHER; 6MM FLAT, SS	2	08269	L FILTER CHARGER	1	33-2434
C INTAKE TUBE	1	087272	H BOLT; M4 - 0.07 8MM, A/H CAP	2	07733	M BLOCK OFF PLATE; MASS AIR	1	21508
D GASKET; 57-2556, 3/16 PORON	1	09069	I VENT; 1/4NPT, 90DEG., 3/8"	1	08523	N GASKET; MASS AIR SENSOR	1	09076
E ADAPTOR; 57-2556, NYLON 6/6	1	21515	J HOSE; 8MM ID X 21" L	1	08409			

NOTE: FAILURE TO FOLLOW INSTALLATION INSTRUCTIONS AND NOT USING THE PROVIDED HARDWARE MAY DAMAGE THE INTAKE TUBE, THROTTLE BODY AND ENGINE.

TO START:

1. Turn off the ignition and disconnect the negative battery cable.
NOTE: Disconnecting the negative battery cable erases pre-programmed electronic memories. Write down all memory settings before disconnecting the negative battery cable. Some radios will require an anti-theft code to be entered after the battery is reconnected. The anti-theft code is typically supplied with your owner's manual. In the event your vehicles anti-theft code cannot be recovered, contact an authorized dealership to obtain your vehicles anti-theft code.



2. Remove the oil cap and then lift off the engine cover. Reinstall the oil cap.



3. Disconnect the crank case vent tube from the valve cover port.

NOTE: On 2014 and later vehicles, the manufacturer changed the crank case vent system. The crank case vent tube will need to be unhooked from the oil filler cap before the cap can be removed from the engine.



4. Loosen the clamps securing the intake tube to the throttle body and air filter housing and then remove the factory intake tube.

NOTE: K&N Engineering, Inc., recommends that customers do not discard factory air intake.



5. Disconnect the mass air sensor electrical connection.



6. Release the two clips securing the air filter cover and then remove the air filter cover.



7. Remove the mass air sensor from the air filter cover.



8. Using the factory screws from the previous step, install the mass air sensor block off plate and gasket.



9. Install the provided gasket onto the K&N® mass air sensor adapter.



10. Install the mass air sensor into the adapter and secure with the provided hardware.

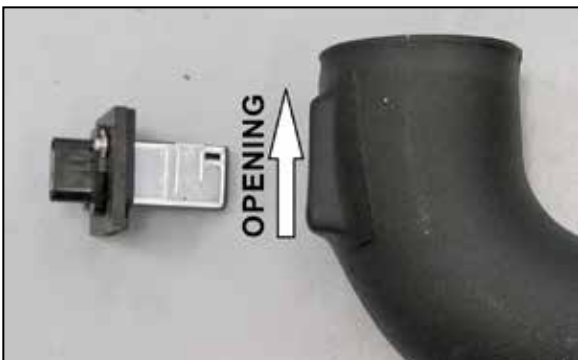

11. Install the mass air sensor assembly into the K&N® intake tube so the opening is pointed towards the air filter end of the tube and secure with the provided hardware.



12. Install the 90° vent fitting into the K&N® intake tube as shown.

NOTE: Plastic NPT fittings are easy to cross thread. Install the vent fitting “hand” tight, then turn it two complete turns with a wrench.



13. Remove the factory air filter and replace with the provided K&N® air filter.



14. Reinstall the air filter cover.



15. Install the provided coupling hose (08761) onto the throttle body and secure with the provided hose clamp.



16. Install the provided coupling hose (08418) onto the air filter cover and secure with the provided hose clamp.



17. Install K&N® intake tube into the hose at the throttle body and then into the hose at the air filter cover, adjust the tube for proper fit and then secure with the provided hose clamps.



18. Connect the provided crank case vent hose to the fitting in the K&N® intake tube and then onto the valve cover port.

NOTE: On 2014 and later model vehicles, see the next step for crank case vent hose to engine connection.



18a. On 2014 and later vehicles, it will be necessary to cut the crank case vent tube as shown. Then connect the Cut section of tube to the oil filler cap. Attach the supplied hose to the to the trimmed section of crank case vent tube,



19. Reconnect the mass air sensor electrical connection.



20. Reinstall the engine cover, Reconnect the negative battery cable. Double check to make sure everything is tight and properly positioned before starting the vehicle.

21. The C.A.R.B. exemption sticker, (attached), must be visible under the hood so that an emissions inspector can see it when the vehicle is required to be tested for emissions. California requires testing every two years, other states may vary.

22. It will be necessary for all K&N® high flow intake systems to be checked periodically for realignment, clearance and tightening of all connections. Failure to follow the above instructions or proper maintenance may void warranty.

ROAD TESTING:

1. Start the engine with the transmission in neutral or park, and the parking brake engaged. Listen for air leaks or odd noises. For air leaks secure hoses and connections. For odd noises, find cause and repair before proceeding. This kit will function identically to the factory system except for being louder and much more responsive.

2. Test drive the vehicle. Listen for odd noises or rattles and fix as necessary.

3. If road test is fine, you can now enjoy the added power and performance from your kit.

4. K&N Engineering, Inc., requires cleaning the intake system's air filter element every 100,000 miles. When used in dusty or off-road environments, our filters will require cleaning more often. We recommend that you visually inspect your filter once every 25,000 miles to determine if the screen is still visible. When the screen is no longer visible some place on the filter element, it is time to clean it. To clean and re-oil, purchase our filter Recharger® service kit, part number 99-5050 or 99-5000 and follow the easy instructions.