

Thin Wall Impact Socket

KT No. & D1



6835M

3/4"

- DIN 3121

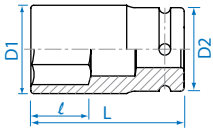

KT NO.	mm	D1 mm	D2 mm	ℓ mm	L mm	g	kg	1/24
683517M	17	28.0	44	16	60	346	6	48
683519M	19	30.0	44	16	60	351	6	48
683521M	21	33.0	44	18	60	369	6	48
683522M	22	34.0	44	18	60	372	6	48
683523M	23	35.0	44	23	60	373	6	48
683524M	24	36.5	44	23	60	382	6	48
683526M	26	39.0	44	25	80	397	1	24
683527M	27	40.0	44	26	80	424	1	24
683529M	29	43.0	44	26	80	455	1	24
683530M	30	44.0	44	26	80	555	1	24
683532M	32	46.5	44	26	80	512	1	24

6935M

3/4"

- DIN 3121

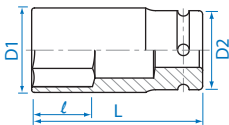

KT NO.	mm	D1 mm	D2 mm	ℓ mm	L mm	g	kg	1/24
693519M	19	30.0	44	16	90	513	1	24
693521M	21	33.0	44	18	90	546	1	24
693522M	22	34.0	44	18	90	541	1	24
693523M	23	35.0	44	23	90	519	1	24
693524M	24	36.5	44	23	90	573	1	24
693526M	26	39.0	44	25	90	578	1	24
693527M	27	40.0	44	27	90	574	1	24
693529M	29	43.0	44	27	90	578	1	24
693530M	30	44.0	44	27	90	622	1	24
693532M	32	46.5	44	30	90	683	1	24

6935S

3/4"

- ANSI / ASME B107.2

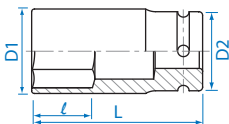

KT NO.	inch	D1 mm	D2 mm	ℓ mm	L mm	g	kg	1/24
693524S	3/4	30.0	38	16	90	370	1	24
693526S	13/16	33.0	38	18	90	380	1	24
693528S	7/8	34.0	38	18	90	385	1	24
693530S	15/16	36.5	38	23	90	415	1	24
693532S	1	38.0	38	23	90	500	1	24
693534S	1-1/16	40.0	44	25	90	654	1	24
693536S	1-1/8	43.0	44	25	90	680	1	24
693538S	1-3/16	44.0	44	27	90	684	1	24
693540S	1-1/4	46.5	44	30	90	733	1	24

Impact Star Socket

6575M

3/4"

- For torx external screw
- DIN 3121

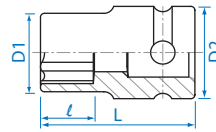

KT NO.	Size	D1 mm	D2 mm	ℓ mm	L mm	g	kg	1/24
657524M	E24	32.5	44.0	17.0	50	334	6	48
657526M	E26	35.0	44.0	19.0	60	402	6	48
657528M	E28	36.5	44.0	25.5	60	401	6	48
657530M	E30	37.5	44.0	27.0	65	428	1	24
657532M	E32	39.5	44.0	29.0	65	447	1	24

Deep Impact Star Socket

6475M

3/4"

- For torx external screw
- DIN 3121
- For the operation of cylinder head bolts
- E18 application MAN M 2000 / Bus with D 08 engine
- E20 application MAN F 2000 / F 90/ F 8/ Bus with D 25 and D 28 engines
- E24 application MAN D20 engine

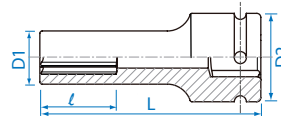

KT NO.	Size	D1 mm	D2 mm	ℓ mm	L mm	g	kg	1/24
647518M	E18	26.5	44.0	12.5	110	592	1	10
647520M	E20	29.0	44.0	14.0	110	627	1	10
647522M	E22	31.0	44.0	15.0	110	662	1	10
647524M	E24	32.5	44.0	17.0	110	693	1	10

Rear Wheel Socket

KT No. & D1



6514M

3/4"

- 4 points
- DIN 3121

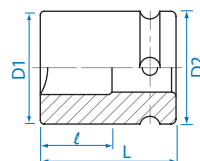

KT NO.	Size	D1 mm	D2 mm	ℓ mm	L mm	g	kg	1/24
651417M	17	39.8	34	28	53	353	1	24
651419M	19	39.8	34	28	53	339	1	24
651420M	20	41.8	36	28	53	381	1	24
651421M	21	41.8	36	28	53	369	1	24



KT NO.	inch	D1 mm	D2 mm	ℓ mm	L mm		
443534S	1-1/16	38	30	27	80	364	5 / 60
443536S	1-1/8	41	30	27	80	407	5 / 50
443538S	1-3/16	42	30.5	30	80	418	5 / 50
443540S	1-1/4	46	30	32	80	499	1 / 24

Impact Socket Set

4466MP **4466SP** **1/2"**

- Deep impact socket
- Stand size (mm) :
415 x 336 x 320



4466MP / 4466SP

KT NO.	PC.	Contents	Each Q'ty	
4466MP	166	4435M	8, 9, 10, 11, 12, 13, 14	8
			15, 16, 17, 18, 19, 20	7
			21, 22, 23, 24	7
			25, 26, 27, 28, 29	6
			30, 32	5
4466SP	110	4435S	5/16, 3/8, 7/16, 1/2, 9/16	8
			5/8, 11/16, 3/4, 13/16, 7/8, 15/16	7
			1, 1-1/16, 1-1/8	6
			1-3/16, 1-1/4	5

Packing NO.	Spec.		Cuff
4466MP-A	87103	6.37	0.67
4466MP-DA	166 PC. socket content	22.06	0.38
4466MP-DB		24.10	0.45
4466SP-A	87103	6.37	0.67
4466SP-D	110 PC. socket content	28.0	0.47

Impact Thin Wall Socket

KT No. & D1

4835M **1/2"**

- DIN 3121

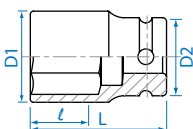

KT NO.	mm	D1 mm	D2 mm	ℓ mm	L mm		
483510M	10	16	25	20	52	93	10 / 180
483511M	11	17	25	20	52	88	10 / 180
483512M	12	18	25	20	52	92	10 / 180
483513M	13	19	25	20	52	95	10 / 180
483514M	14	21	25	20	52	99	10 / 180
483516M	16	23	25	20	52	101	8 / 80
483517M	17	25	25	23	52	106	8 / 80
483519M	19	27	30	23	52	150	8 / 80
483521M	21	29	30	25	52	142	8 / 80
483522M	22	31	30	25	52	158	8 / 80
483523M	23	32	30	26	52	172	8 / 80
483524M	24	33	30	26	52	165	8 / 80
483526M	26	36	30	27	65	241	6 / 60
483527M	27	37	30	27	65	249	6 / 60
483530M	30	41	30.5	27	65	294	5 / 50
483535M	35	46	30	32	70	367	1 / 24

4930M **1/2"**

- DIN 3121

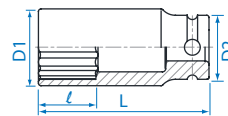

KT NO.	mm	D1 mm	D2 mm	ℓ mm	L mm		
493008M	8	13.2	25	20	78	118	6 / 120
493009M	9	14.0	25	20	78	118	6 / 120
493010M	10	15.5	25	20	80	134	6 / 120
493011M	11	16.7	25	20	80	136	6 / 120
493012M	12	18.0	25	20	80	142	6 / 120
493013M	13	19.0	25	20	80	165	6 / 120
493014M	14	20.5	25	20	80	153	6 / 120
493015M	15	21.5	30	20	80	204	6 / 96
493016M	16	23.0	30	20	80	219	6 / 96
493017M	17	24.5	30	23	80	218	6 / 96
493018M	18	25.5	30	23	80	267	6 / 96
493019M	19	27.0	30	23	80	241	6 / 96
493020M	20	28.0	30	23	80	235	6 / 96
493021M	21	29.0	30	25	80	241	6 / 96
493022M	22	30.5	30	25	80	252	5 / 60
493023M	23	32.0	30	26	80	267	5 / 60
493024M	24	33.0	30	26	80	277	5 / 60
493027M	27	37.0	30	27	80	318	5 / 60
493030M	30	40.5	30	27	80	355	5 / 50
493032M	32	42.5	30	27	80	356	5 / 50
493036M	36	45.5	30	32	80	361	1 / 24

4935M **1/2"**

- DIN 3121

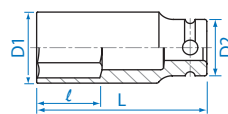

KT NO.	mm	D1 mm	D2 mm	ℓ mm	L mm		
493510M	10	15.5	25	20	80	133	6 / 120
493511M	11	16.7	25	20	80	134	6 / 120
493512M	12	18.0	25	20	80	140	6 / 120
493513M	13	19.0	25	20	80	142	6 / 120
493514M	14	20.5	25	20	80	142	6 / 120

KT NO.	mm	D1 mm	D2 mm	ℓ mm	L mm		
493516M	16	23.0	30	20	80	201	6 / 96
493517M	17	24.5	30	23	80	211	6 / 96
493519M	19	27.0	30	23	80	222	6 / 96
493521M	21	29.0	30	25	80	230	6 / 96
493522M	22	30.5	30	25	80	261	5 / 60
493523M	23	32.0	30	26	80	273	5 / 60
493524M	24	33.0	30	26	80	285	5 / 60
493526M	26	35.5	30	27	80	303	5 / 60
493527M	27	37.0	30	27	80	335	5 / 60
493530M	30	40.5	30	27	80	376	5 / 50

Impact Thin Wall Socket

4935S 1/2"

- ANSI / ASME B107.2

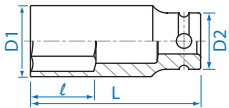

KT NO.	inch	D1 mm	D2 mm	ℓ mm	L mm		
493510S	5/16	13.0	25	20	80	129	6 / 120
493512S	3/8	16.0	25	20	80	144	6 / 120
493514S	7/16	16.7	25	20	80	148	6 / 120
493516S	1/2	19.0	25	20	80	159	6 / 120
493518S	9/16	20.5	25	20	80	165	6 / 120
493520S	5/8	23.0	25	20	80	167	6 / 96
493522S	11/16	24.5	30	23	80	235	6 / 96
493524S	3/4	27.0	30	23	80	224	6 / 96
493526S	13/16	29.0	30	25	80	250	6 / 96
493528S	7/8	30.5	30	25	80	260	5 / 60
493530S	15/16	33.0	30	26	80	336	5 / 60
493532S	1	34.0	30	26	80	356	5 / 60
493534S	1-1/16	37.0	30	27	80	405	5 / 60
493536S	1-1/8	39.0	30	27	80	355	5 / 50
493538S	1-3/16	40.5	30	27	80	417	5 / 50
493540S	1-1/4	42.5	30	27	80	389	5 / 50

Extra Thin Wall Impact Socket

4415M 1/2"

- Finishing - phosphate sunk
- For aluminum alloy wheel
- Material - chrome molybdenum alloy steel
- Super thin wall version has less strength than standard deep one
- DIN 3121

Thin walled design (D1)

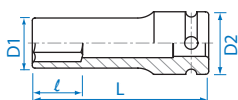

KT NO.	mm	D1 mm	D2 mm	ℓ mm	L mm		
441517M	17	23.8	25	17	80	163	6 / 96
441519M	19	25.8	30	20	80	214	6 / 96
441521M	21	27.8	30	22	80	221	6 / 96
441522M	22	29.5	30	24	80	238	6 / 96

Wheel Nut Impact Socket

KT No. & D1



- Material - chrome molybdenum alloy steel
- Durable outer sleeve protects polished wheels and lug nuts
- plastic sleeve thin wall version

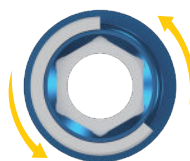

4945MX 1/2"

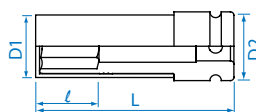

17mm

19mm

21mm

KT NO.	mm	D1 mm	D2 mm	ℓ mm	L mm		
494517MX	17	27.3	30	26	85	213	5 / 60
494519MX	19	29.3	30	26	85	232	5 / 60
494521MX	21	30.9	30	26	85	243	5 / 60

4955MX 1/2"

new



17mm

19mm

21mm

KT NO.	mm	D1 mm	D2 mm	ℓ mm	L mm		
495517MX	17	27.3	30	23	150	310	2 / 48
495519MX	19	29.3	30	23	150	339	2 / 48
495521MX	21	30.9	30	23	150	413	2 / 48

Double - Ended Impact Socket

4915M 1/2"

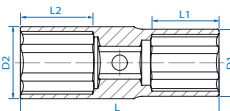

KT NO.	mm / inch	D1 mm	D2 mm	L mm	L1 mm	L2 mm		
49151719M	17 x 19	26	28	77	22	26	210	6 / 96
49151921M	19 x 21	26	28	77	23	26	200	6 / 96
49152122M	21 x 22	30	32	77	20	26	310	5 / 60
49152123M	21 x 23	30	32	77	22	26	310	5 / 60
49152426S	3/4" x 13/16"	26	28	77	23	26	200	6 / 96



Impact Star Socket

4575M

1/2"

- For torx external screw
- DIN 3121

KT NO.	Size	D1 mm	D2 mm	ℓ mm	L mm		
457510M	E10	14.0	25.0	7.5	38	68	10 / 200
457512M	E12	15.9	25.0	9.0	38	68	10 / 200
457514M	E14	17.7	25.0	10.0	38	71	10 / 200
457516M	E16	20.0	25.0	11.0	38	75	10 / 200
457518M	E18	22.0	25.0	12.5	38	78	10 / 200
457520M	E20	24.5	30.0	14.0	38	120	10 / 160

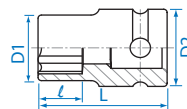

Impact Bit Socket

4015M

4015S 1/2"

- Hexagon head
- DIN 3121



KT NO.	mm	L mm	Max. torq N-m		
401505M	H5	80	36.0	73	6 / 120
401506M	H6	80	62.4	77	6 / 120
401507M	H7	80	97.0	84	6 / 120
401508M	H8	80	144.0	86	6 / 120
401509M	H9	80	229.0	97	6 / 120
401510M	H10	80	264.0	100	6 / 120
401512M	H12	80	480.0	117	6 / 120
401513M	H13	80	518.0	128	6 / 120
401514M	H14	80	650.0	137	6 / 120
401517M	H17	80	715.0	217	6 / 96
401519M	H19	80	786.0	246	6 / 96

KT NO.	inch	L mm	Max. torq N-m		
401508S	1/4	80	93.6	77	6 / 120
401510S	5/16	80	144.0	86	6 / 120
401512S	3/8	80	264.0	100	6 / 120
401516S	1/2	80	518.0	126	6 / 120

4053

4063 1/2"

- For torx internal screw
- DIN 3121



KT NO.	Size	L mm		
405320	T20	60	64	10 / 180
405325	T25	60	65	10 / 180
405327	T27	60	66	10 / 180
405330	T30	60	66	10 / 180
405340	T40	60	68	10 / 180
405345	T45	60	73	10 / 180
405350	T50	60	78	10 / 180
405355	T55	60	87	10 / 180
405360	T60	60	93	10 / 180
405370	T70	60	104	10 / 180
406325	T25	100	72	6 / 120
406327	T27	100	76	6 / 120
406330	T30	100	78	6 / 120
406340	T40	100	81	6 / 120
406345	T45	100	88	6 / 120
406350	T50	100	97	6 / 120
406355	T55	100	117	6 / 120
406360	T60	100	137	6 / 120



- Air pressure must not exceed 90PSI (6.3bar)
- Adjust your air tool to its lowest torque output, should this torque level not be enough, increase it gradually

4055M

4055S 1/2"

- Hexagon head
- DIN 3121

- Hexagon head
- ANSI / ASME B107.2



KT NO.	mm	L mm	Max. torq N-m		
405504M	H4	60	20.8	64	10 / 180
405505M	H5	60	36.0	67	10 / 180
405506M	H6	60	62.4	71	10 / 180
405507M	H7	60	97.0	74	10 / 180
405508M	H8	60	144.0	79	10 / 180
405510M	H10	60	264.0	87	10 / 180
405512M	H12	60	480.0	98	10 / 180
405513M	H13	60	518.0	104	10 / 180
405514M	H14	60	650.0	110	10 / 180
405516M	H16	60	680.0	125	10 / 180
405517M	H17	60	715.0	178	10 / 80
405518M	H18	60	740.0	186	10 / 80
405519M	H19	60	786.0	195	10 / 80

KT NO.	inch	L mm	Max. torq N-m		
405506S	3/16	60	36.0	65	10 / 180
405508S	1/4	60	93.6	72	10 / 180
405510S	5/16	60	144.0	78	10 / 180
405512S	3/8	60	264.0	86	10 / 180
405514S	7/16	60	420.0	93	10 / 180
405516S	1/2	60	518.0	104	10 / 180

4056M 1/2"

- Spline head
- DIN 3121



KT NO.	Size	L mm	Max. torq N-m		
405608M	M 8	60	62.4	73	10 / 180
405610M	M10	60	144.0	81	10 / 180
405612M	M12	60	229.0	88	10 / 180

Impact Bit Socket KT No. & D1

3065M 3/8"

- For hexagon head screw
- DIN 3121



KT NO.	mm	L mm	Max. torq N-m		
306504M	H4	90	20.8	39	8 / 160
306505M	H5	90	36.0	44	8 / 160
306506M	H6	90	62.4	50	8 / 160
306508M	H8	90	144.0	66	8 / 160
306510M	H10	90	264.0	86	8 / 160

3053 3/8"

- For torx internal screw
- DIN 3121



KT NO.	Size	L mm		
305310	T10	55	35	12 / 360
305315	T15	55	34	12 / 360
305320	T20	55	35	12 / 360
305325	T25	55	36	12 / 360
305327	T27	55	36	12 / 360
305330	T30	55	36	12 / 360
305340	T40	55	39	12 / 360
305345	T45	55	43	12 / 360
305350	T50	55	44	12 / 360
305355	T55	55	52	12 / 288
305360	T60	55	60	12 / 288
306320	T20	90	42	8 / 160
306325	T25	90	42	8 / 160
306327	T27	90	43	8 / 160
306330	T30	90	45	8 / 160
306340	T40	90	50	8 / 160
306345	T45	90	57	8 / 160
306350	T50	90	64	8 / 160
306355	T55	90	82	8 / 160

Impact Accessory

3862P 3/8"

- Adapter
- Convert to 1/4" drive
- 3862P → Max. torque : 62 N-m
- DIN 3121



KT NO.	Spec.	D mm		
3862P	3/8" F x 1/4" M	20.8	32	24 / 384

3864P 3/8"

- Adapter
- Convert to 1/2" drive
- DIN 3121



KT NO.	Spec.	D mm		
3864P	3/8" F x 1/2" M	20.8	53	24 / 384

3147 3/8"

- Bit holder



KT NO.	Size	L mm		
314708S	1/4"	40	41	12 / 420
314710S	5/16"	40	43	12 / 420
314710M	10mm	40	42	12 / 420

3260P 3/8"

- Extension bar
- DIN 3121



KT NO.	Overall length inch	mm		
3260-03P	3	75	98	6 / 120
3260-04P	4	100	121	8 / 160
3260-05P	5	125	147	8 / 144
3260-06P	6	150	169	5 / 100
3260-08P	8	200	217	6 / 72
3260-10P	10	250	264	6 / 54

3796P 3/8"

- Universal joint
- DIN 3121

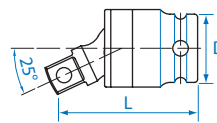

KT NO.	Overall length inch	mm	D mm		
3796P	2	50	22	87	10 / 200

90608 3/8"

- Locking pin
- Chrome vanadium steel
- DIN 3129



KT NO.	Disp.	∅	d / l	Applied to socket sizes
90608	pin	2.5	14	3535M (6~12 mm) 3535S (1/4~1/2 inch)
				3435M (6~12 mm) 3435S (1/4~1/2 inch)
				3055M (4~12 mm) 3055S (3/16~1/2 inch)
				3065M (4~10 mm) 3053 (T10~T15)
				3575M (E5~E14)
3053.3055.3065.3147.3862.3864				
90609	pin	2.5	16	3535M (13~19 mm) 3535S (9/16~3/4 inch)
				3435M (13~24 mm) 3435S (9/16~7/8 inch)
				3260.3796

Impact Accessory

KT No. & D1



6260

- Extension bar
- DIN 3121

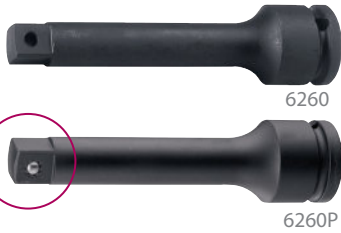

6260

6260P

KT NO.	Overall length		g	kg
	inch	mm		
6260-04	4	100	566	2 / 20
6260-07	7	175	864	2 / 20
6260-10	10	250	1145	1 / 16
6260-13	13	330	1450	1 / 10
6260-04P	4	100	566	2 / 20
6260-07P	7	175	864	2 / 20
6260-10P	10	250	1145	1 / 16
6260-13P	13	330	1450	1 / 10

6864

- Adapter
- Convert to 1/2" drive
- 6864 → Max. torque : 512 N·m
- DIN 3121



6864 / 6864P
6868 / 6868P

6864 & 6868

6864P & 6868P

KT NO.	Spec.	D (mm)	g	kg
6864	3/4"F x 1/2"M	44	311	6 / 48
6868	3/4"F x 1"M	44	445	6 / 48
6864P	3/4"F x 1/2"M	44	311	6 / 48
6868P	3/4"F x 1"M	44	445	6 / 48

6874

- Adapter
- Convert to 1/2" drive
- 6874 → Max. torque : 768 N·m
- DIN 3121



6874 / 6874P

6874

6874P

KT NO.	Spec.	D (mm)	g	kg
6874	3/4"F x 1/2"M	38	233	6 / 48
6874P	3/4"F x 1/2"M	38	233	6 / 48

90403

- Locking ring
- High tensile rubber material

90404

90405 3/4"

90603

90604

90607 3/4"

- Locking pin
- Chrome vanadium steel
- DIN 3129

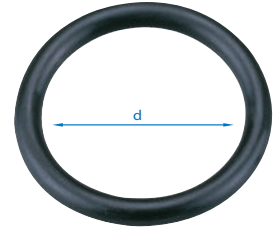

90603
90604
90607

90403
90404
90405

KT NO. Desp. ø d / l Applied to socket sizes

90403	ring	3.5	33	6015M (14~19mm) 6435S (3/4"~1") 6510M (17~30mm) 6535S (11/16"~1-3/16") 6515M (17~30mm) 6935S (3/4"~1") 6874
90607	pin	3.0	30	
90404	ring	5.5	37	6535M (17~46mm) 6535S (1-1/4"~1-13/16") 6435M (19~46mm) 6435S (1-1/16"~1-13/16") 6935M (19~32mm) 6935S (1-1/16"~1-1/4") 6015M (21~27mm) 6260.6797.6798.6864
90603	pin	4.0	35	6530M (17~46mm) 6868 6835M (17~32mm) 609616M.609622M
90405	ring	5.5	44	6535M (48~65mm) 6535S (1-7/8"~2-3/8") 6435M (48~50mm) 6435S (1-7/8"~2")
90604	pin	4.0	45	

Impact Bit Socket Set

6411MP

3/4"

Metal case size (mm) :
270 x 100 x 49 (0.048 cuft)



11 PC.

Contents

kg 2.77 kg / 1 / 8

	6096M	16, 22
	1740	H10, H12, H14, H17
	1954	H19, H22, H24, H27, H32

[View other impact sockets and sets made by KING TONY on our website.](#)