

KENWOOD

KDC-268U
KDC-168U
KDC-138U

KDC-118
KDC-MP168U

CD-RECEIVER
INSTRUCTION MANUAL



JVCKENWOOD Corporation

PANDORA®

For your records

Record the serial number, found on the back of the unit, in the spaces designated on the warranty card, and in the space provided below. Refer to the model and serial numbers whenever you call upon your Kenwood dealer for information or service on the product.

Model KDC-268U/ KDC-168U/ KDC-138U/ KDC-118/ KDC-MP168U

Serial number _____



CONTENTS

BEFORE USE	2
BASICS	3
GETTING STARTED	4
1 Select the display language and cancel the demonstration	
2 Set the clock and date	
3 Set the initial settings	
RADIO	5
CD/USB/iPod/ANDROID	7
Pandora® (for KDC-268U / KDC-168U)	10
iHeartRadio® (for KDC-268U / KDC-168U)	11
AUX	12
AUDIO SETTINGS	13
DISPLAY SETTINGS	14
TROUBLESHOOTING	15
REFERENCES	17
Maintenance	
More information	
INSTALLATION/ CONNECTION	20
SPECIFICATIONS	22

BEFORE USE

IMPORTANT

- To ensure proper use, please read through this manual before using this product. It is especially important that you read and observe Warning and Caution in this manual.
- Please keep the manual in a safe and accessible place for future reference.

▲ WARNING

- **Do not operate any function that takes your attention away from safe driving.**
- **Do not ingest the battery, Chemical Burn Hazard**

The remote control supplied with this product contains a coin/button cell battery.

If the coin/button cell battery is swallowed, it can cause severe internal burns in just 2 hours and can lead to death.

Keep new and used batteries away from children.

If the battery compartment does not close securely, stop using the product and keep it away from children.

If you think batteries might have been swallowed or placed inside any part of the body, seek immediate medical attention.

▲ Caution

Volume setting:

- Adjust the volume so that you can hear sounds outside the car to prevent accidents.
- Lower the volume before playing digital sources to avoid damaging the speakers by the sudden increase of the output level.

General:

- Avoid using the external device if it might hinder safe driving.
- Make sure all important data has been backed up. We shall bear no responsibility for any loss of recorded data.
- Never put or leave any metallic objects (such as coins or metal tools) inside the unit, to prevent a short circuit.
- If a disc error occurs due to condensation on the laser lens, eject the disc and wait for the moisture to evaporate.
- Depending on the types of cars, the antenna will automatically extend when you turn on the unit with the antenna control wire connected (➔ 21). Turn off the unit or change the source to STANDBY when parking at a low ceiling area.

Remote control (RC-406):

- Do not leave the remote control in hot places such as on the dashboard.
- The Lithium battery is in danger of explosion if replaced incorrectly. Replace it only with the same or equivalent type.
- The battery pack or batteries shall not be exposed to excessive heat such as sunshine, fire or the like.

How to read this manual

- Operations are explained mainly using buttons on the faceplate of **KDC-268U**.
- English indications are used for the purpose of explanation. You can select the display language from the [FUNCTION] menu. (➔ 5)
- [XX] indicates the selected items.
- (➔ XX) indicates references are available on the stated page.

BASICS

Faceplate

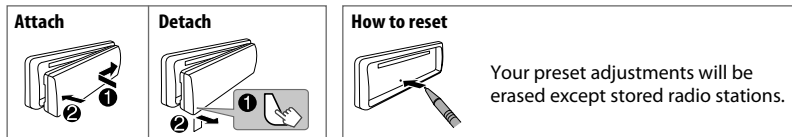
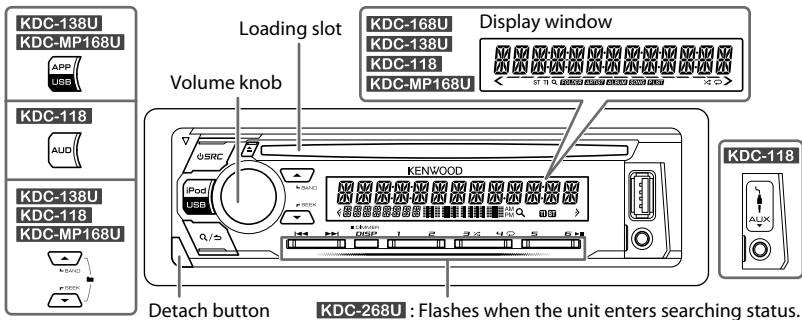

To	On the faceplate
Turn on the power	Press SRC . • Press and hold to turn off the power.
Adjust the volume	Turn the volume knob.
Select a source	Press SRC repeatedly.
Change the display information*	Press DISP repeatedly. (➡ 19)

* **KDC-MP168U**: You can also turn off the display information by pressing **DISP** repeatedly.

Remote control (RC-406)

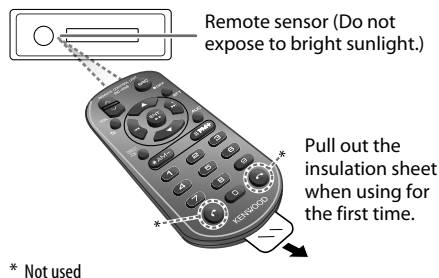

* Not used

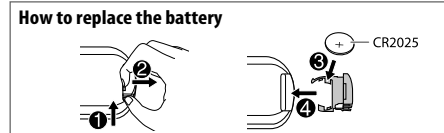

To	On the remote control
Turn on the power	Press and hold SRC to turn off the power. (Pressing SRC does not turn on the power.)
Adjust the volume	Press VOL ▲ or VOL ▼ . • Press and hold VOL ▲ to continuously increase the volume to 15.
Select a source	Press ATT during playback to attenuate the sound. • Press again to cancel.
Change the display information*	Press SRC repeatedly. (Not available)

GETTING STARTED

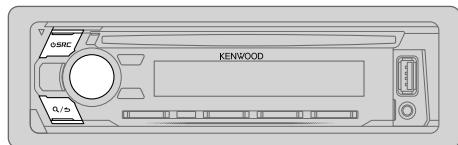

1 Select the display language and cancel the demonstration

When you turn on the power (or after you reset the unit), the display shows: "SEL LANGUAGE" → "PRESS" → "VOLUME KNOB"

- 1 Turn the volume knob to select [ENG] (English) or [SPA] (Spanish), then press the knob.
[ENG] is selected for the initial setup.
Then, the display shows: "CANCEL DEMO" → "PRESS" → "VOLUME KNOB".
- 2 Press the volume knob.
[YES] is selected for the initial setup.
- 3 Press the volume knob again.
"DEMO OFF" appears.

2 Set the clock and date

- 1 Press the volume knob to enter [FUNCTION].
- 2 Turn the volume knob to select [CLOCK], then press the knob.

To adjust the clock

- 3 Turn the volume knob to select [CLOCK ADJUST], then press the knob.
- 4 Turn the volume knob to make the settings, then press the knob.
Hour → Minute
- 5 Turn the volume knob to select [CLOCK FORMAT], then press the knob.
- 6 Turn the volume knob to select [12H] or [24H], then press the knob.

To set the date

- 7 Turn the volume knob to select [DATE FORMAT], then press the knob.
- 8 Turn the volume knob to select [DD/MM/YY] or [MM/DD/YY], then press the knob.
- 9 Turn the volume knob to select [DATE SET], then press the knob.
- 10 Turn the volume knob to make the settings, then press the knob.
Day → Month → Year or Month → Day → Year
- 11 Press and hold Q/5 to exit.

To return to the previous setting item, press Q/5.

3 Set the initial settings

- 1 Press SRC repeatedly to enter STANDBY.
- 2 Press the volume knob to enter [FUNCTION].
- 3 Turn the volume knob to select an item (see the following table), then press the knob.
- 4 Repeat step 3 until the desired item is selected or activated.
- 5 Press and hold Q/5 to exit.

To return to the previous setting item, press Q/5.

Default: **XX**

AUDIO CONTROL	
SWITCH PREOUT	REAR/SUBWOOFER or REAR/SUB-W : Selects whether rear speakers or a subwoofer are connected to the line out terminals on the rear (through an external amplifier). (→ 21)
SP SELECT	OFF/ 5/4/ 6 × 9/6/ OEM : Selects according to the speaker size (5 inches or 4 inches, 6×9 inches or 6 inches) or OEM speakers for optimum performance.
DISPLAY	
EASY MENU	(For KDC-268U) When entering [FUNCTION]... ON : ZONE 1 illumination changes to white color ; OFF : ZONE 1 illumination remains as [COLOR SELECT] color. (→ 15) • ZONE 2 illumination changes to white color when you enter [FUNCTION], irregardless of the [EASY MENU] setting. • Refer to the illustration on page 14 for ZONE identification.

GETTING STARTED

TUNER SETTING

PRESET TYPE **NORMAL**: Memorizes one station for each preset button in each band (FM1/FM2/FM3/AM). ; **MIX**: Memorizes one station for each preset button, regardless of the selected band.

SYSTEM

KEY BEEP **ON**: Activates the keypress tone. ; **OFF**: Deactivates.

SOURCE SELECT

PANDORA SRC (For **KDC-268U** / **KDC-168U**)
ON: Enables PANDORA in source selection. ; **OFF**: Disables. (➡ 10)

IHEART SRC (For **KDC-268U** / **KDC-168U**)
ON: Enables IHEARTRADIO in source selection. ; **OFF**: Disables. (➡ 11)

BUILT-IN AUX **ON**: Enables AUX in source selection. ; **OFF**: Disables. (➡ 12)

CD READ **1**: Automatically distinguishes between audio file disc and music CD. ; **2**: Forces to play as a music CD. No sound can be heard if an audio file disc is played.

F/W UPDATE (except for **KDC-118**)

UPDATE SYSTEM

F/W UP xxxx **YES**: Starts upgrading the firmware. ; **NO**: Cancels (upgrading is not activated).

CLOCK

CLOCK DISPLAY **ON**: The clock time is shown on the display even when the unit is turned off. ; **OFF**: Cancels.

ENGLISH Select the display language for **[FUNCTION]** menu and music information if applicable.

ESPAÑOL By default, **[ENGLISH]** is selected.

RADIO

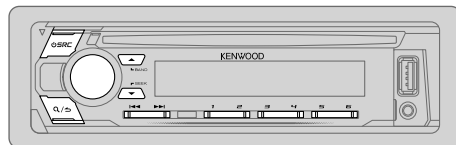

Search for a station

- 1 Press **⏻ SRC** repeatedly to select **TUNER**.
 - 2 Press **▲ BAND** repeatedly (or press **#FM+/*AM-** on the remote control) to select FM1/FM2/FM3/AM.
 - 3 Press **◀◀ / ▶▶** (or press **◀◀ / ▶▶ (+)** on the remote control) to search for a station.
- To change the searching method for **◀◀ / ▶▶**: Press **▼ SEEK** repeatedly.
AUTO1 : Automatically search for a station.
AUTO2 : Search for a preset station.
MANUAL : Manually search for a station.
 - To store a station: Press and hold one of the number buttons (**1** to **6**).
 - To select a stored station: Press one of the number buttons (**1** to **6**) (or press one of the number buttons (**1** to **6**) on the remote control).

Direct Access Tuning (using the remote control)

- 1 Press **DIRECT** to enter Direct Access Tuning.
 - 2 Press the number buttons to enter a frequency.
 - 3 Press **ENT ▶ ||** to search for a station.
- To cancel, press **⏻** or **DIRECT**.
 - If no operation is done for 10 seconds after step **2**, Direct Access Tuning is automatically canceled.

RADIO

Other settings

- 1 Press the volume knob to enter [FUNCTION].
- 2 Turn the volume knob to select an item (see the following table), then press the knob.
- 3 Repeat step 2 until the desired item is selected or activated.
- 4 Press and hold \mathcal{Q} / \mathcal{S} to exit.

To return to the previous setting item, press \mathcal{Q} / \mathcal{S} .

Default: **XX**

TUNER SETTING	
AUTO MEMORY	YES: Automatically starts memorizing 6 stations with good reception. ; NO: Cancels. • Selectable only if [NORMAL] is selected for [PRESET TYPE]. (\Rightarrow 5)
MONO SET	ON: Improves the FM reception, but the stereo effect may be lost. ; OFF: Cancels.
NEWS SET	(For KDC-MP168U) ON: The unit will temporarily switch to News Programme if available. ; OFF: Cancels.
REGIONAL	(For KDC-MP168U) ON: Switches to another station only in the specific region using the "AF" control. ; OFF: Cancels.
AF SET	(For KDC-MP168U) ON: Automatically searches for another station broadcasting the same program in the same Radio Data System network with better reception when the current reception is poor. ; OFF: Cancels.
TI	(For KDC-268U / KDC-MP168U) ON: Allows the unit to temporarily switch to Traffic Information if available ("TI" lights up). ; OFF: Cancels.
PTY SEARCH	(For KDC-268U / KDC-MP168U) Select the available Program Type (see the following), then, press \mathcal{Q} / \mathcal{S} to start.

CLOCK

TIME SYNC (For **KDC-268U** / **KDC-MP168U**)
ON: Synchronizes the unit's time to the Radio Broadcast Data System/Radio Data System station time. ; **OFF:** Cancels.

Available Program Type for [PTY SEARCH]

(For **KDC-268U**)

SPEECH : NEWS, INFORM (information), SPORTS, TALK, LANGUAGE, REL TALK (religious talk), PERSONLTY (personality), PUBLIC, COLLEGE, HABL ESP (spanish talk), WEATHER
MUSIC : ROCK, CLS ROCK (classic rock), ADLT HIT (adult hits), SOFT RCK (softrock), TOP 40, COUNTRY, OLDIES, SOFT, NOSTALGA (nostalgia), JAZZ, CLASSICL (classical), R & B (rhythm and blues), SOFT R&B (soft rhythm and blues), REL MUSC (religious music), MUSC ESP (spanish music), HIP HOP

(For **KDC-MP168U**)

SPEECH : NEWS, AFFAIRS, INFO (information), SPORT, EDUCATE, DRAMA, CLS CULTURE, SCIENCE, VARIED, WEATHER, FINANCE, CHILDREN, SOCIAL, RELIGION, PHONE IN, TRAVEL, LEISURE, DOCUMENT
MUSIC : POP M (music), ROCK M (music), EASY M (music), LIGHT M (music), CLASSICS, OTHER M (music), JAZZ, COUNTRY, NATION M (music), OLDIES, FOLK M (music)

The unit will search for the Program Type categorized under [SPEECH] or [MUSIC] if selected.

- [MONO SET]/[NEWS SET]/[REGIONAL]/[AF SET]/[TI]/[PTY SEARCH] is selectable only when the band is FM1/FM2/FM3.
- If the volume is adjusted during reception of traffic information or news bulletin, the adjusted volume is memorized automatically. It will be applied the next time traffic information or news bulletin is turned on.

CD/USB/iPod/ANDROID

Start playback

The source changes automatically and playback starts.

CD

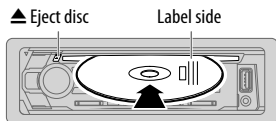

USB input terminal

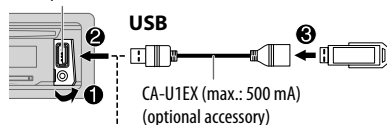

iPod/iPhone

KCA-iP102/KCA-iP103 (optional accessory)*1 or accessory of the iPod/iPhone*2



ANDROID*3

Micro USB 2.0 cable*2 (commercially available)

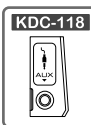
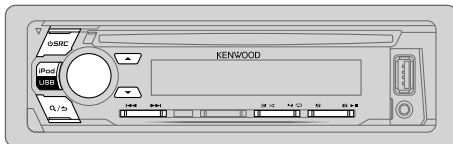

Selectable sources:

KDC-268U / KDC-168U : CD/USB/iPod/ANDROID

KDC-138U / KDC-MP168U : CD/USB/ANDROID

KDC-118 : CD

- To directly select USB/iPod/ANDROID source, press **iPod USB** or **APP USB**.

To	On the faceplate	On the remote control
Playback/pause	Press 6 ► II .	Press ENT ► II .
Reverse/Fast-forward*4	Press and hold ◀◀ / ▶▶ .	Press and hold ◀◀ / ▶▶ (+).
Select a track/file	Press ◀◀ / ▶▶ .	Press ◀◀ / ▶▶ (+).
Select a folder*5	Press ▲ / ▼ .	Press #FM+ / *AM- .

*1 KCA-iP102 : 30-pin type, KCA-iP103 : Lightning type



*2 Do not leave the cable inside the car when not using.

*3 When connecting an Android device, "Press [VIEW] to install KENWOOD MUSIC PLAY APP" is shown. Follow the instructions to install the application.

*4 For ANDROID: Applicable only when [BROWSE MODE] is selected. (➡ 8)

*5 For CD: Only for MP3/WMA files. This does not work for iPod/ANDROID.

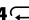
CD/USB/iPod/ANDROID

To	On the faceplate
Repeat play* ⁶	Press 4  repeatedly. TRACK REPEAT/ALL REPEAT: Audio CD FILE REPEAT/FOLDER REPEAT/ALL REPEAT: MP3/WMA/ WAV/FLAC file FILE REPEAT/FOLDER REPEAT/REPEAT OFF: iPod or ANDROID
Random play* ⁶	Press 3  repeatedly. DISC RANDOM/RANDOM OFF: Audio CD FOLDER RANDOM/RANDOM OFF: MP3/WMA/WAV/FLAC file, iPod or ANDROID Press and hold 3  to select ALL RANDOM.* ⁷

*⁶ For iPod/ANDROID: Applicable only when [MODE OFF]/[BROWSE MODE] is selected.

*⁷ For CD: Only for MP3/WMA files.

Select control mode

While in iPod source, press **iPod USB** repeatedly.

MODE ON : Control iPod using the iPod itself. However, you can still play/pause, file skip, fast-forward or reverse from this unit.

MODE OFF : Control iPod from this unit.

While in ANDROID source, press **iPod USB** or **APP USB** repeatedly.

BROWSE MODE : Control Android device from this unit via KENWOOD MUSIC PLAY application installed in the Android device.

HAND MODE : Control Android device using the Android device itself via other media player applications installed in the Android device. However, you can still play/pause and file skip from this unit.

Select a file from a folder/list

For iPod/ANDROID, applicable only when [MODE OFF]/[BROWSE MODE] is selected.

- 1 Press **Q** / .
- 2 Turn the volume knob to select a folder/list, then press the knob.
- 3 Turn the volume knob to select a file, then press the knob.

Quick Search (applicable only for CD, USB and ANDROID source)

If you have many files, you can search through them quickly.

Turn the volume knob quickly to browse through the list quickly.

Skip Search (applicable only for iPod and ANDROID source)

Press **◀◀** / **▶▶** to search at a preset skip search ratio. (→ 9, [SKIP SEARCH])

- Pressing and holding **◀◀** / **▶▶** searches at a 10% ratio.

Alphabet search (applicable only for iPod and ANDROID source)

You can search for a file according to the first character.

For iPod source

- 1 Turn the volume knob quickly to enter character search.
- 2 Turn the volume knob to select the character.
 - Select “*” to search for a character other than A to Z, 0 to 9.
- 3 Press **◀◀** / **▶▶** to move to the entry position.
 - You can enter up to 3 characters.
- 4 Press the volume knob to start searching.

For ANDROID source

- 1 Press **▲** / **▼** to enter character search.
- 2 Turn the volume knob to select the character.
 - ^A^: Upper case letters (A to Z)
 - _A_: Lower case letters (a to z)
 - 0-: Numbers (0 to 9)
 - ***: Character other than A to Z, 0 to 9
- 3 Press the volume knob to start searching.

CD/USB/iPod/ANDROID

- To return to the root folder/first file/top menu, press **5**.
- To return to the previous setting item, press **Q/↵**.
- To cancel, press and hold **Q/↵**.

Direct Music Search (using the remote control)

- 1 Press **DIRECT**.
- 2 Press the number buttons to enter a track/file number.
- 3 Press **ENT ▶ ||** to search for music.

- To cancel, press **↵** or **DIRECT**.
- Not available if Random Play is selected.
- Not applicable for iPod and ANDROID source.

Select music drive (except for [KDC-118])

While in USB source, press **iPod USB** or **APP USB** repeatedly.

Stored songs in the following drive will be played back.

- Selected internal or external memory of a smartphone (Mass Storage Class).
- Selected drive of a multiple drives device.

Listen to Tuneln Radio/Tuneln Radio Pro/Aupeo (for [KDC-268U] / [KDC-168U])

While listening to Tuneln Radio, Tuneln Radio Pro or Aupeo, connect the iPod/iPhone to the USB input terminal of the unit.

- The unit will output the sound from these applications.

Other settings

- 1 Press the volume knob to enter [FUNCTION].
- 2 Turn the volume knob to select an item (see the following table), then press the knob.
- 3 Repeat step 2 until the desired item is selected or activated.
- 4 Press and hold **Q/↵** to exit.

To return to the previous setting item, press **Q/↵**.

Default: **XX**

USB	
MUSIC DRIVE	DRIVE CHANGE: The next drive ([DRIVE 1] to [DRIVE 5]) is selected automatically and playback starts. Repeat steps 1 to 3 to select the following drives.
SKIP SEARCH	0.5%/1%/5%/10%: While listening to iPod or ANDROID source, selects the skip search ratio over the total files.

Preparation:

Install the latest version of the Pandora application on your device (iPhone/iPod touch), then create an account and log in to Pandora.

- Select [ON] for [PANDORA SRC] in [SOURCE SELECT]. (→ 5)

Start listening

- 1 Open the Pandora application on your device.
- 2 Connect your device to the USB input terminal.

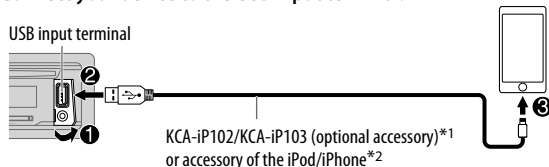

The source changes to PANDORA and broadcast starts.

To	On the faceplate	On the remote control
Playback/pause	Press 6 ► II .	Press ENT ► II .
Skip a track	Press ► ▶ .	Press ► ▶ (+).
Thumbs up or thumbs down*3	Press ▲ / ▼ .	Press #FM+ / *AM- .

*1 KCA-iP102 : 30-pin type, KCA-iP103 : Lightning type

*2 Do not leave the cable inside the car when not using.

*3 If thumbs down is selected, the current track is skipped.

Create and save a new station

- 1 Press **Q** / **↵**.
- 2 Turn the volume knob to select [NEW STATION], then press the knob.
- 3 Turn the volume knob to select [FROM ARTIST] or [FROM TRACK], then press the knob.
A new station is created based on the artist or current song.
- 4 Press and hold one of the number buttons (**1** to **5**) to store.

To select a stored station: Press one of the number buttons (**1** to **5**).

Search for a registered station

- 1 Press **Q** / **↵**.
- 2 Turn the volume knob to select an item, then press the knob.
[BY DATE]: According to the registered date
[A-Z]: By alphabetical order
- 3 Turn the volume knob (or press **▲** / **▼** on the remote control) to select the desired station.
- 4 Press the volume knob (press **ENT** ► **II** on the remote control) to confirm.

To cancel, press and hold **Q** / **↵**.

Bookmark current song information

Press and hold the volume knob.

"BOOKMARKED" appears and the information is stored to your device.

- The bookmark is available on your Pandora account but not on this unit.

Delete a station

While listening to PANDORA...

- 1 Press **Q/↵**.
- 2 Turn the volume knob to select [STATION DEL], then press the knob.
- 3 Turn the volume knob to select [BY DATE] or [A-Z], then press the knob.
- 4 Turn the volume knob to select the desired station to delete, then press the knob.
- 5 Turn the volume knob to select [YES], then press the knob.
- 6 Press and hold **Q/↵** to exit.

To return to the previous setting item, press **Q/↵**.

Preparation:

Install the latest version of iHeart Link for KENWOOD application on your device (iPhone/iPod touch), then create an account and log in to iHeartRadio.

- Select [ON] for [IHEART SRC] in [SOURCE SELECT]. (→ 5)

Start listening

- 1 Open the iHeart Link application on your device.
- 2 Connect your device to the USB input terminal.

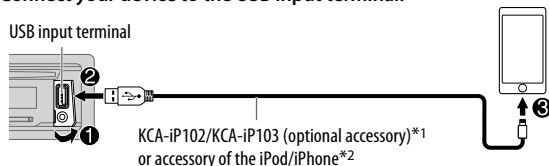

- 3 Press **⏻ SRC** repeatedly to select IHEARTRADIO.
Broadcast starts automatically.

To	On the faceplate	On the remote control
Playback/pause	Press 6 ► II .	Press ENT ► II .
Skip a track for custom station	Press ►► I .	Press ►► I (+) .
Thumbs up or thumbs down*3 for custom station	Press ▲ / ▼ .	(Not available)
Create a new/custom station	Press 1 .	(Not available)
Add to favorite stations for live station	Press 2 .	(Not available)
Scan for live station	Press 3 .	(Not available)

*1 KCA-iP102 : 30-pin type, KCA-iP103 : Lightning type

*2 Do not leave the cable inside the car when not using.

*3 If thumbs down is selected, the current track is skipped.

Search for a station

- 1 Press **Q/↵**.
- 2 Turn the volume knob to select a category, then press the knob.
- 3 Turn the volume knob (or press **▲/▼** on the remote control) to select the desired station.
- 4 Press the volume knob (or press **ENT ▶||** on the remote control) to confirm.

When a city list appears, you can skip cities in alphabetical order.

To cancel, press and hold **Q/↵**.

Skip cities by alphabetical order

While a city list appears during search...

- 1 Turn the volume knob quickly to enter character search.
- 2 Turn the volume knob or press **◀◀ / ▶▶** to select the character to be searched for.
- 3 Press **▲/▼** to move to the previous/next page.
- 4 Press the volume knob to start searching.

To cancel, press and hold **Q/↵**.

Delete a station

While listening to iHEARTRADIO...

- 1 Press the volume knob to enter [FUNCTION].
- 2 Turn the volume knob to select [SYSTEM], then press the knob.
- 3 Turn the volume knob to select [STATION DEL], then press the knob.
- 4 Turn the volume knob to select [LIVE] or [CUSTOM], then press the knob.
- 5 Turn the volume knob to select the desired station to delete, then press the knob.
- 6 Turn the volume knob to select [YES], then press the knob.
- 7 Press and hold **Q/↵** to exit.

To return to the previous setting item, press **Q/↵**.

AUX

Preparation:

Select [ON] for [BUILT-IN AUX] in [SOURCE SELECT]. (→ 5)

Start listening

- 1 Connect a portable audio player (commercially available).

Auxiliary input jack

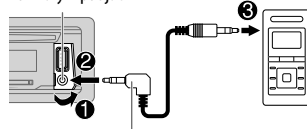

Portable audio player

3.5 mm (1/8") stereo mini plug with "L" shaped connector (commercially available)

- 2 Press **⏻ SRC** repeatedly to select AUX.
- 3 Turn on the portable audio player and start playback.

Set the AUX name

While listening to a portable audio player connected to the unit...

- 1 Press the volume knob to enter [FUNCTION].
- 2 Turn the volume knob to select [SYSTEM], then press the knob.
- 3 Turn the volume knob to select [AUX NAME SET], then press the knob.
- 4 Turn the volume knob to select an item, then press the knob.
AUX (default)/DVD/PORTABLE/GAME/VIDEO/TV
- 5 Press and hold **Q/↵** to exit.

To return to the previous setting item, press **Q/↵**.

AUDIO SETTINGS

While listening to any source...

- 1 Press the volume knob to enter [FUNCTION].
For **KDC-118**: Press **AUD** to enter [AUDIO CONTROL] directly.
- 2 Turn the volume knob to select an item (see the following table), then press the knob.
- 3 Repeat step 2 until the desired item is selected or activated.
- 4 Press and hold **Q**/**↵** to exit.

To return to the previous setting item, press **Q**/**↵**.

(or using the remote control)

- 1 Press **AUD** to enter [AUDIO CONTROL].
- 2 Press **▲**/**▼** to select an item, then press **ENT ▶II**.

Default: **XX**

AUDIO CONTROL		
SUB-W LEVEL	-15 to +15 (0)	Adjusts the subwoofer output level.
BASS LEVEL	-8 to +8 (+2)	Adjusts the level to memorize for each source. (Before making an adjustment, select the source you want to adjust.)
MID LEVEL	-8 to +8 (+1)	
TRE LEVEL	-8 to +8 (+1)	

EQ PRO (This setting is stored to [USER].)

BASS ADJUST	BASS CTR FRQ	60HZ/80HZ/100HZ/200HZ or 60/80/100/200: Selects the center frequency.
	BASS LEVEL	-8 to +8 (+2): Adjusts the level.
	BASS Q FACTOR	1.00/1.25/1.50/2.00: Adjusts the quality factor.
	BASS EXTEND	ON: Turns on the extended bass. ; OFF: Cancels.
MID ADJUST	MID CTR FRQ	0.5KHZ/1.0KHZ/1.5KHZ/2.5KHZ: Selects the center frequency.
	MID LEVEL	-8 to +8 (+1): Adjusts the level.
	MID Q FACTOR	0.75/1.00/1.25: Adjusts the quality factor.
TRE ADJUST	TRE CTR FRQ	10.0KHZ/12.5KHZ/15.0KHZ/17.5KHZ: Selects the center frequency.
	TRE LEVEL	-8 to +8 (+1): Adjusts the level.
PRESET EQ		DRIVE EQ/TOP40/POWERFUL/ROCK/POPS/EASY/JAZZ/NATURAL/USER: Selects a preset equalizer suitable to the music genre. (Select [USER] to use the settings made in [EQ PRO].) [DRIVE EQ] is a preset equalizer that reduces noise outside the car or running noise of the tyres.
BASS BOOST		LEVEL1/LEVEL2/LEVEL3 or LV1/LV2/LV3: Selects your preferred bass boost level. ; OFF: Cancels.
LOUDNESS		LEVEL1/LEVEL2 or LV1/LV2: Selects your preferred low and high frequencies boost to produce a well-balanced sound at a low volume level. ; OFF: Cancels.
SUBWOOFER SET		ON: Turns on the subwoofer output. ; OFF: Cancels.

AUDIO SETTINGS

LPF SUBWOOFER	THROUGH: All signals are sent to the subwoofer. ; 85HZ/120HZ/160HZ: Audio signals with frequencies lower than 85 Hz/120 Hz/160 Hz are sent to the subwoofer.
SUB-W PHASE	REVERSE (180°)/NORMAL (0°): Selects the phase of the subwoofer output to be in line with the speaker output for optimum performance. (Selectable only if a setting other than [THROUGH] is selected for [LPF SUBWOOFER] .)
FADER	R15 to F15 (0): Adjusts the rear and front speaker output balance.
BALANCE	L15 to R15 (0): Adjusts the left and right speaker output balance.
VOLUME OFFSET	For AUX: -8 to +8 (0) ; For other sources: -8 to 0 : Preset the initial volume level of each source. (Before adjustment, select the source you want to adjust.)
SOUND RECNSTR (Sound reconstruction)	ON: Creates realistic sound by compensating the high-frequency components and restoring the rise-time of the waveform that are lost in audio data compression. ; OFF: Cancels.

- **[SUB-W LEVEL]/[SUBWOOFER SET]/[LPF SUBWOOFER]/[SUB-W PHASE]** is selectable only if **[SWITCH PREOUT]** is set to **[SUBWOOFER]** or **[SUB-W]**. (→ 4)
- **[SUB-W LEVEL]/[LPF SUBWOOFER]/[SUB-W PHASE]** is selectable only if **[SUBWOOFER SET]** is set to **[ON]**. (→ 13)

DISPLAY SETTINGS

(For **KDC-268U**)

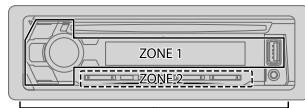

ALL ZONE

(For **KDC-168U** / **KDC-138U** / **KDC-MP168U**)

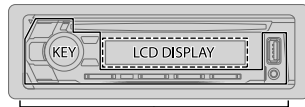

ALL ZONE

(For **KDC-118**)

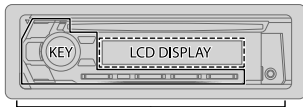

ALL ZONE

Set the dimmer

Press and hold **DISP (DIMMER)** to turn on or off the dimmer.

- If you have set **[DIMMER TIME]** (→ 15), it will be canceled once you press and hold this button.

Other settings

- 1 Press the volume knob to enter **[FUNCTION]**.
- 2 Turn the volume knob to select an item (→ 15), then press the knob.
- 3 Repeat step 2 until the desired item is selected/activated or follow the instructions stated on the selected item.
- 4 Press and hold **Q/↵** to exit.

To return to the previous setting item, press **Q/↵**.

DISPLAY SETTINGS

Default: **XX**

DISPLAY	
COLOR SELECT	<p>(For KDC-268U)</p> <p>Select color for ALL ZONE, ZONE 1 and ZONE 2 separately.</p> <ol style="list-style-type: none"> 1 Select a zone. (See illustration on page 14.) 2 Select a color for the selected zone. VARIABLE SCAN/CUSTOM R/G/B/preset colors* <p>To make your own color, select [CUSTOM R/G/B]. The color you have made will be stored in [CUSTOM R/G/B].</p> <ol style="list-style-type: none"> 1 Press the volume knob to enter the detailed color adjustment. 2 Press ◀◀ / ▶▶ to select the color (R/G/B) to adjust. 3 Turn the volume knob to adjust the level (0 to 9), then press the knob.
DIMMER	<p>Dim the illumination.</p> <p>ON: Dimmer is turned on. ; OFF: Cancels.</p> <p>DIMMER TIME: Set the dimmer on and off time.</p> <ol style="list-style-type: none"> 1 Turn the volume knob to adjust the [ON] time, then press the knob. 2 Turn the volume knob to adjust the [OFF] time, then press the knob. <p>(Default: [ON]: PM6:00 or 6:00PM; [OFF]: AM6:00 or 6:00AM)</p>
BRIGHTNESS	<ol style="list-style-type: none"> 1 Select a zone. (See illustration on page 14.) 2 0 — 31: Select your preferred brightness level for the selected zone.
TEXT SCROLL	<p>AUTO/ONCE: Select whether to scroll the display information automatically, or scroll only once. ; OFF: Cancels.</p>

* Preset colors: **RED1/RED2/RED3/PURPLE1/PURPLE2/PURPLE3/PURPLE4/BLUE1/BLUE2/BLUE3/SKYBLUE1/SKYBLUE2/LIGHTBLUE/AQUA1/AQUA2/GREEN1/GREEN2/GREEN3/YELLOWGREEN1/YELLOWGREEN2/YELLOW/ORANGE1/ORANGE2/ORANGERED**

TROUBLESHOOTING

	Symptom	Remedy
General	Sound cannot be heard.	<ul style="list-style-type: none"> • Adjust the volume to the optimum level. • Check the cords and connections.
	"MISWIRING CHECK WIRING THEN PWR ON" appears.	Turn the power off, then check to be sure the terminals of the speaker wires are insulated properly. Turn the power on again.
	"PROTECTING SEND SERVICE" appears.	Send the unit to the nearest service center.
	<ul style="list-style-type: none"> • Sound cannot be heard. • The unit does not turn on. • Information shown on the display is incorrect. 	Clean the connectors. (➡ 17)
Radio	The unit does not work at all.	Reset the unit. (➡ 3)
	<ul style="list-style-type: none"> • Radio reception is poor. • Static noise while listening to the radio. 	Connect the antenna firmly.
CD/USB/iPod	Disc cannot be ejected.	Press and hold ▲ to forcibly eject the disc. Be careful not to drop the disc when it is ejected. If this does not solve the problem, reset the unit. (➡ 3)
	Noise is generated.	Skip to another track or change the disc.
	Tracks do not play back as you intended them to play.	Playback order is determined when files are recorded.
	"READING" keeps flashing.	Do not use too many hierarchical levels or folders.
	Elapsed playing time is not correct.	This is caused by how the tracks are recorded.
	Correct characters are not displayed (e.g. album name).	<ul style="list-style-type: none"> • This unit can only display uppercase letters, numbers, and a limited number of symbols. • Depending on the display language you have selected (➡ 5), some characters may not be displayed correctly.
	"NA FILE"	Make sure the disc contains supported audio files. (➡ 18)
	"NO DISC"	Insert a playable disc into the loading slot.

TROUBLESHOOTING

Symptom	Remedy
CD/iPod	"TOC ERROR" Make sure the disc is clean and inserted properly.
	"PLEASE EJECT" Reset the unit. If this does not solve the problem, consult your nearest service center.
	"READ ERROR" Copy the files and folders onto the USB device again. If this does not solve the problem, reset the USB device or use another USB device.
	"NO DEVICE" Connect a USB device, and change the source to USB again.
	"COPY PRO" A copy-protected file is played.
	"NA DEVICE" Connect a supported USB device, and check the connections.
	"NO MUSIC" Connect a USB device that contains playable audio files.
	"iPod ERROR" <ul style="list-style-type: none"> Reconnect the iPod. Reset the iPod.
ANDROID	<ul style="list-style-type: none"> Sound cannot be heard during playback. Sound output only from the Android device.
	<ul style="list-style-type: none"> Reconnect the Android device. If in [HAND MODE], launch any media player application on the Android device and start playback. If in [HAND MODE], relaunch the current media player application or use another media player application. Restart the Android device. If this does not solve the problem, the connected Android device is unable to route the audio signal to unit. (➡ 18)
	Cannot playback at [BROWSE MODE] . <ul style="list-style-type: none"> Make sure KENWOOD MUSIC PLAY APP is installed on the Android device. (➡ 7) Reconnect the Android device and select the appropriate control mode. If this does not solve the problem, the connected Android device does not support [BROWSE MODE]. (➡ 18)
	"NO DEVICE" or "READING" keeps flashing. <ul style="list-style-type: none"> Switch off the developer options on the Android device. Reconnect the Android device. If this does not solve the problem, the connected Android device does not support [BROWSE MODE]. (➡ 18)

Symptom	Remedy
ANDROID	Playback is intermittent or sound skips. Turn off the power saving mode on the Android device.
	"ANDROID ERROR"/"NA DEVICE" <ul style="list-style-type: none"> Reconnect the Android device. Restart the Android device.
	"ADD ERROR" New station creation is unsuccessful.
	"CHECK DEVICE" Check the Pandora application on your device.
	"NO SKIPS" The skip limit has been reached.
Pandora	"NO STATIONS" No stations are found.
	"STATION LIMIT" The number of registered stations has reached its limit. Retry after deleting unnecessary stations from your device.
	"CONNECT ERROR" Communication is unstable.
	"RATING ERROR" Registration of thumbs up/thumbs down has failed due to insufficient network connectivity.
	"THUMBS N/A" Registration of thumbs up/thumbs down is not allowed.
iHeartRadio	"LICENSE ERROR" You try to access from a country which Pandora is not deliverable.
	iHeartRadio station cannot be selected. If "Explicit Content" in [Account Settings] is checked in the web version of iHeartRADIO, custom stations become unavailable.
	"CANNOT CREATE" Custom station name creation is unsuccessful.
	"CANNOT SAVE" Addition to the favorite category failed.
	"DISCONNECTED" Check the connection to the device.
	"NO SKIPS" The skip limit has been reached. Retry later.
	"NO STATIONS" No stations are found.
	"NOT CONNECTED" Link to the application is impossible.
	"IHEARTLINK UP" Make sure you have installed the latest version of the iHeart Link for KENWOOD application on your device.

TROUBLESHOOTING

Symptom	Remedy
iHeartRadio	"PLEASE LOGIN" You haven't log in. Log in again.
	"STATION NOT AVAILABLE" Broadcast from the station is over.
	"STATION NOT SELECTED" No station is selected.
	"STREAM ERROR" Broadcast data is interrupted.
	"THUMB FAILED" Registration of Thumbs Up/Down has failed.
	"TIMED OUT" The request has resulted in time-out.

Muting upon the reception of a phone call

Connect the MUTE wire to your telephone using a commercial telephone accessory. (➔ 21)

When a call comes in, "CALL" appears. (The audio system pauses.)

- To continue listening to the audio system during a call, press **SRC**. "CALL" disappears and the audio system resumes.

When the call ends, "CALL" disappears. (The audio system resumes.)

REFERENCES

Maintenance

Cleaning the unit

Wipe off dirt on the faceplate with a dry silicone or soft cloth.

Cleaning the connector

Detach the faceplate and clean the connector gently with a cotton swab, being careful not to damage the connector.

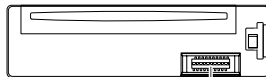

Connector (on the reverse side of the faceplate)

Handling discs

- Do not touch the recording surface of the disc.
- Do not stick tape etc. on the disc, or use a disc with tape stuck on it.
- Do not use any accessories for the disc.
- Clean from the center of the disc and move outward.
- Clean the disc with a dry silicone or soft cloth. Do not use any solvents.
- When removing discs from this unit, pull them out horizontally.
- Remove burrs from the center hole and disc edge before inserting a disc.

More information

- For:
- Latest firmware updates and latest compatible item list
 - Any other latest information

General

- This unit can only play the following CDs:



REFERENCES

Playable files

- Playable audio file:
For disc: MP3 (.mp3), WMA (.wma)
For USB mass storage class device: MP3 (.mp3), WMA (.wma), WAV (.wav), FLAC (.flac)
- Playable disc media: CD-R/CD-RW/CD-ROM
- Playable disc file format: ISO 9660 Level 1/2, Joliet, Long file name
- Playable USB device file system: FAT12, FAT16, FAT32

Even when audio files comply with the standards listed above, playback may be impossible depending on the types or conditions of media or device.

Unplayable discs

- Discs that are not round.
- Discs with coloring on the recording surface or discs that are dirty.
- Recordable/ReWritable discs that have not been finalized.
- 8 cm CD. Attempting to insert using an adapter may cause malfunction.

About USB devices

- You cannot connect a USB device via a USB hub.
- Connecting a cable whose total length is longer than 5 m may result in abnormal playback.
- This unit cannot recognize a USB device whose rating is other than 5 V and exceeds 1 A.

About iPod/iPhone

Made for

- iPod touch (2nd, 3rd, 4th, 5th, and 6th generation)
- iPod classic
- iPod nano (3rd, 4th, 5th, 6th, and 7th generation)
- iPhone 3G, 3GS, 4, 4S, 5, 5S, 5C, 6, 6 Plus, 6S, 6S Plus, SE
- You cannot operate iPod if “KENWOOD” or “✓” is displayed on iPod.
- Depending on the version of the operating system of the iPod/iPhone, some functions may not operate on this unit.

About Android device

- This unit supports Android OS 4.1 and above.
- Some Android devices (with OS 4.1 and above) may not fully support Android Open Accessory (AOA) 2.0.
- If the Android device supports both mass storage class device and AOA 2.0, this unit always playback via AOA 2.0 as priority.

About Pandora

- Pandora is only available in certain countries.
- Because Pandora is a third-party service, the specifications are subject to change without prior notice. Accordingly, compatibility may be impaired, or some or all of the services may become unavailable.
- Some functions of Pandora cannot be operated from this unit.

About iHeartRadio

- iHeartRadio® is a third-party service, therefore the specifications are subject to change without prior notice. Accordingly, compatibility may be impaired or some or all of the services may become unavailable.
- Some iHeartRadio® functionality cannot be operated from this unit.

REFERENCES

Change the display information

Each time you press **DISP**, the display information changes.

- If the information is unavailable or not recorded, "NO TEXT", "NO INFO", or other information (eg. station name, playing time) appears.

Source name	Display information	
	KDC-268U	KDC-168U / KDC-138U / KDC-118 / KDC-MP168U
STANDBY	Source name (Date/Clock)	Source name ➡ (*) ➡ Clock ➡ (back to the beginning)
TUNER	Frequency (Date/Clock)	Frequency ➡ (*) ➡ Clock ➡ (back to the beginning)
	(For FM Radio Broadcast Data System stations only) Station name (Date/Clock) ➡ Radio text (Date/Clock) ➡ Radio text+ (R.TEXT+) ➡ Title (Artist) ➡ Title (Date/Clock) ➡ Frequency (Date/Clock) ➡ (back to the beginning)	(For FM Radio Data System stations only) Station name ➡ (*) ➡ Radio text ➡ Radio text+ ➡ Title/Artist ➡ Frequency ➡ Clock ➡ (back to the beginning)
CD or USB	(For CD-DA) Track title (Artist) ➡ Track title (Disc name) ➡ Track title (Date/Clock) ➡ Playing time (Date/Clock) ➡ (back to the beginning)	(For CD-DA) Disc name/Artist ➡ (*) ➡ Track title/Artist ➡ Playing time ➡ Clock ➡ (back to the beginning)
	(For MP3/WMA/WAV/FLAC files) Track title (Artist) ➡ Track title (Album title) ➡ Track title (Date/Clock) ➡ File name (Folder name) ➡ File name (Date/Clock) ➡ Playing time (Date/Clock) ➡ (back to the beginning)	(For MP3/WMA/WAV/FLAC files) Track title/Artist ➡ (*) ➡ Album title/artist ➡ Folder name ➡ File name ➡ Playing time ➡ Clock ➡ (back to the beginning)
iPod or ANDROID	When [MODE OFF]/[BROWSE MODE] is selected. (➡ 8) Track title (Artist) ➡ Track title (Album name) ➡ Track title (Date/Clock) ➡ Playing time (Date/Clock) ➡ (back to the beginning)	When [MODE OFF]/[BROWSE MODE] is selected. (➡ 8) Track title/Artist ➡ (*) ➡ Album title/Artist ➡ Playing time ➡ Clock ➡ (back to the beginning)
PANDORA	Station name (Date/Clock) ➡ Shared/Radio station (Date/Clock) ➡ Track title (Artist) ➡ Track title (Album title) ➡ Track title (Date/Clock) ➡ Playing time (Date/Clock) ➡ (back to the beginning)	Station name ➡ (*) ➡ Shared/Radio station ➡ Track title ➡ Artist ➡ Album title ➡ Playing time ➡ Clock ➡ (back to the beginning)
IHEARTRADIO	Station name (Date/Clock) ➡ Track title (Artist) ➡ Track title (Date/Clock) ➡ (back to the beginning)	Station name ➡ (*) ➡ Track title/Artist ➡ Clock ➡ (back to the beginning)
AUX	Source name (Date/Clock)	Source name ➡ (*) ➡ Clock ➡ (back to the beginning)

* Only for **KDC-MP168U**: Turn off the display information.

▲ Warning

- The unit can only be used with a 12 V DC power supply, negative ground.
- Disconnect the battery's negative terminal before wiring and mounting.
- Do not connect Battery wire (yellow) and Ignition wire (red) to the car chassis or Ground wire (black) to prevent a short circuit.
- Insulate unconnected wires with vinyl tape to prevent a short circuit.
- Be sure to ground this unit to the car's chassis again after installation.

▲ Caution

- For safety's sake, leave wiring and mounting to professionals. Consult the car audio dealer.
- Install this unit in the console of your vehicle. Do not touch the metal parts of this unit during and shortly after use of the unit. Metal parts such as the heat sink and enclosure become hot.
- Do not connect the \ominus wires of speakers to the car chassis or Ground wire (black), or connect them in parallel.
- Mount the unit at an angle of less than 30°.
- If your vehicle wiring harness does not have the ignition terminal, connect Ignition wire (red) to the terminal on the vehicle's fuse box which provides 12 V DC power supply and is turned on and off by the ignition key.
- Keep all cables away from heat dissipate metal parts.
- After the unit is installed, check whether the brake lamps, blinkers, wipers, etc. on the car are working properly.
- If the fuse blows, first make sure the wires are not touching car's chassis, then replace the old fuse with one that has the same rating.

Basic procedure

- 1 Remove the key from the ignition switch, then disconnect the \ominus terminal of the car battery.
- 2 Connect the wires properly.
See Wiring connection. (→ 21)
- 3 Install the unit to your car.
See Installing the unit (in-dash mounting).
- 4 Connect the \ominus terminal of the car battery.
- 5 Reset the unit. (→ 3)

Installing the unit (in-dash mounting)

1

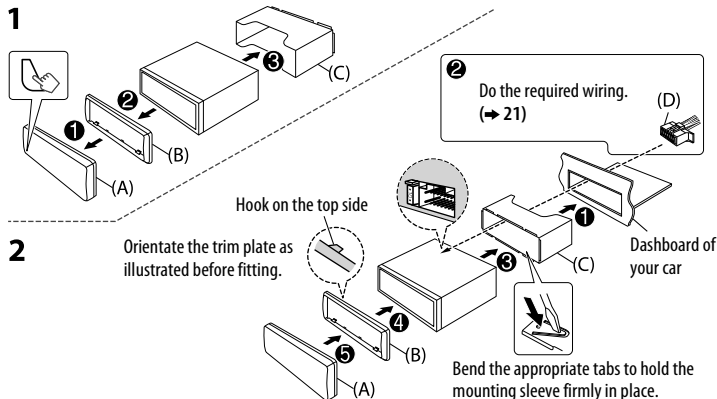

2

When installing without the mounting sleeve

- 1 Remove the mounting sleeve and trim plate from the unit.
 - 2 Align the holes in the unit (on both sides) with the vehicle mounting bracket and secure the unit with screws (supplied/commercially available).
- ▲ Use only the specified screws. Using wrong screws might damage the unit.

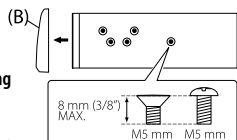

How to remove the unit

- 1 Detach the faceplate.
- 2 Fit the catch pin on the extraction keys into the holes on both sides of the trim plate, then pull it out.
- 3 Insert the extraction keys deeply into the slots on each side, then follow the arrows as shown on the illustration.

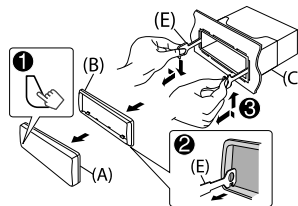

Wiring connection

IMPORTANT: We recommend installing the unit with a commercially available custom wiring harness specific for your car and leave this job to professionals for your safety. Consult your car audio dealer.

When connecting to an external amplifier, connect its ground wire to the car's chassis to avoid damaging the unit.

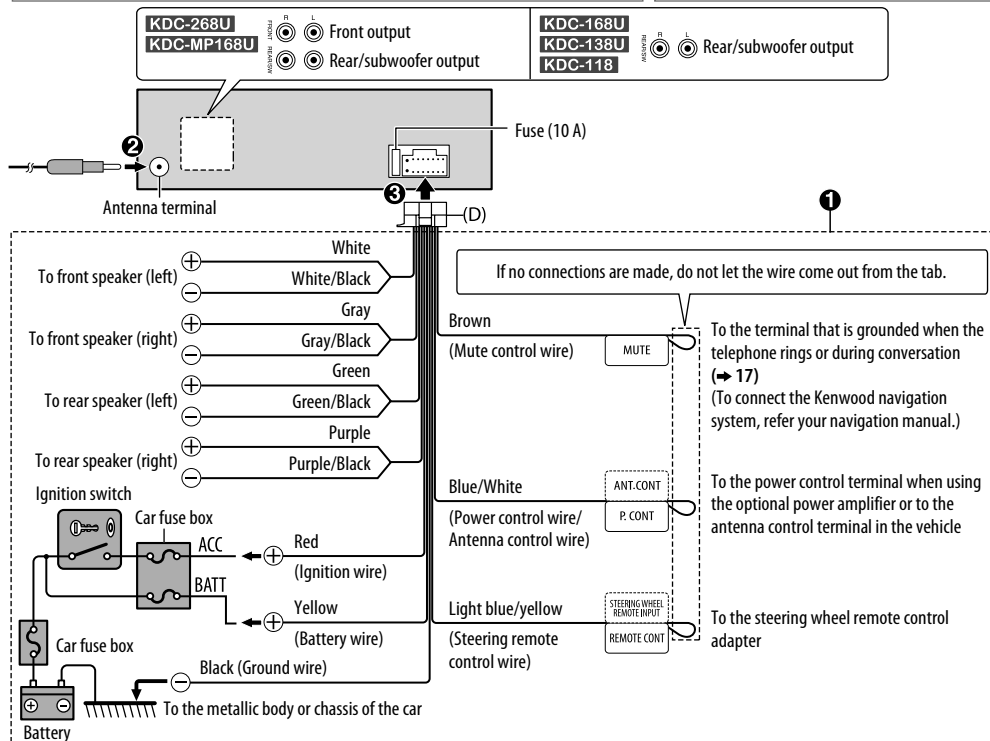

Part list for installation

(A) Faceplate

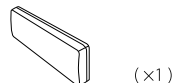

(B) Trim plate

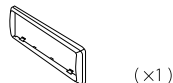

(C) Mounting sleeve

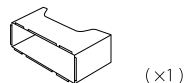

(D) Wiring harness

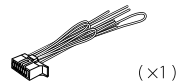

(E) Extraction key

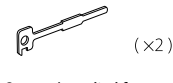

(F) Screws (supplied for KDC-MP168U)

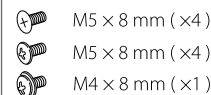

SPECIFICATIONS

Subject to change without notice.

Tuner	FM Frequency Range	KDC-268U / KDC-168U / KDC-138U / KDC-118 : 87.9 MHz — 107.9 MHz (200 kHz space) KDC-MP168U : 87.5 MHz — 108.0 MHz (50 kHz space)
	Usable Sensitivity (S/N = 26 dB)	8.2 dBf (0.71 μ V/75 Ω)
	Quieting Sensitivity (DIN S/N = 46 dB)	17.2 dBf (2.0 μ V/75 Ω)
	Frequency Response (± 3 dB)	30 Hz — 15 kHz
	Signal-to-Noise Ratio (MONO)	64 dB
	Stereo Separation (1 kHz)	40 dB
AM	Frequency Range	530 kHz — 1 700 kHz (10 kHz space)
	Usable Sensitivity (S/N = 20 dB)	29 dB μ (28.2 μ V)

CD player	Laser Diode	GaAlAs
	Digital Filter (D/A)	8 times over sampling
	Spindle Speed	500 rpm — 200 rpm (CLV)
	Wow & Flutter	Below measurable limit
	Frequency Response (± 1 dB)	20 Hz — 20 kHz
	Total Harmonic Distortion (1 kHz)	0.01 %
	Signal-to-Noise Ratio (1 kHz)	105 dB
	Dynamic Range	90 dB
	Channel Separation	85 dB
	MP3 Decode	Compliant with MPEG-1/2 Audio Layer-3
	WMA Decode	Compliant with Windows Media Audio

USB (except for KDC-118)	USB Standard	USB 1.1, USB 2.0 Full Speed
	File System	FAT12/16/32
	Maximum Supply Current	DC 5 V \leq 1 A
	MP3 Decode	Compliant with MPEG-1/2 Audio Layer-3
	WMA Decode	Compliant with Windows Media Audio
	WAV Decode	Linear-PCM
	FLAC Decode	FLAC file (Up to 48 kHz/16 bit)

Audio	Maximum Output Power	50 W \times 4
	Full Bandwidth Power	22 W \times 4 (at less than 1 % THD)
	Speaker Impedance	4 Ω — 8 Ω
	Tone Action	Bass 100 Hz \pm 8 dB
		Middle 1.0 kHz \pm 8 dB
		Treble 12.5 kHz \pm 8 dB
	Preout Level/Load (CD)	2 500 mV/10 k Ω
	Preout Impedance	\leq 600 Ω

Auxiliary	Frequency Response (± 3 dB)	20 Hz — 20 kHz
	Input Maximum Voltage	1 000 mV
	Input Impedance	30 k Ω

General	Operating Voltage	14.4 V (10.5 V — 16 V allowable)
	Maximum Current Consumption	10 A
	Operational Temperature Range	−10°C — +60°C
	Installation Size (W \times H \times D)	182 mm \times 53 mm \times 158 mm (7-3/16" \times 2-1/16" \times 6-1/4")
	Net Weight (includes Trimplate, Mounting Sleeve)	1.3 kg (2.9 lbs)