



For 2005-2010
Ford F-150
Trucks

Regulatory Compliance



PRE-INSTALLATION INFORMATION

- Estimated Time** 60 minutes
- Tools Needed** 1/4" Flat Blade Screwdriver
Short (<1.5 in long) #2 Philips Screwdriver
OR #2 Philips Drill Bit and Socket Wrench
- In the Box** (x2) Model 6146 Fog Lights
(x2) Mounting Buckets
(One labeled part A, one labeled part B)

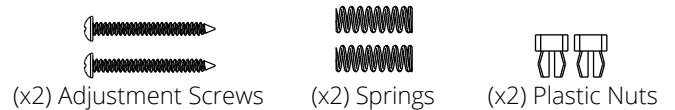

- Wire Functions** Black = Ground
Red = Power
- Input Voltage** 12V DC
- Operating Voltage** 10-15V DC

Pre-Installation Guidelines

1. Read all safety notes and mounting guidelines before installing the product. Verify that all parts listed under "In the Box" are present and complete.
2. Inspect the product for damage. **DO NOT** install the product if there is any damage. Contact the authorized retailer where you purchased it to initiate a warranty claim if there is damage.
3. Verify that all power supply and/or charging systems comply to the specified voltage limits for the light.

To properly install this light you should have a good understanding of automotive electrical procedures and systems, and proficiency in the installation of headlights. **IF YOU DO NOT, PLEASE SEEK PROFESSIONAL ASSISTANCE.**

PRODUCT WARRANTY:
If you have issues with a J.W. Speaker product, please contact the authorized retailer where you purchased it.

Glossary:

Mounting Buckets (2): Included in the kit, and used to fit the Model 6146 into the Ford F-150 (below).

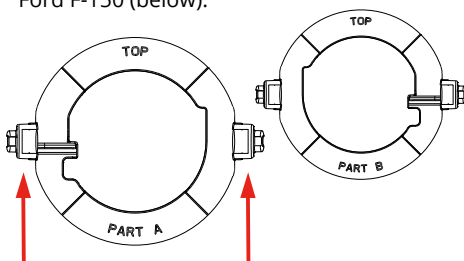

Post: The circular extremities on the mounting bucket that snap into the shroud.

Adjustment Arm: The plastic appendage on the back of the mounting buckets and shroud that holds the adjustment springs and screws.

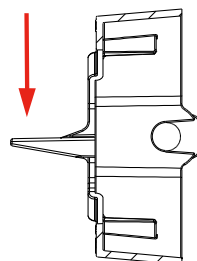

Shroud: The plastic "bucket" inside the bumper which holds the fog light assembly (below).



Mounting Tabs: The tabs located on either side of the shroud where the posts snap into place.

Installation Instructions

NOTE: You will install the first lamp completely before removing the second. The second lamp is necessary for aiming the first fog light.

1. From beneath the vehicle, disconnect the wire harness from the rear of **DRIVER SIDE** light only.



2. Using the #2 Phillips screwdriver or socket wrench, carefully remove the adjustment screw. Pull out and discard the springs and screws.



3A-1. DRIVER SIDE: Facing the front of the vehicle, locate the mounting tab on the **RIGHT** side of the stock fog light. Use the flat blade screwdriver to depress the mounting tab until the post is released from the mounting tab.



3A-2. Using one hand at the front and one at the back of the light, wiggle the stock fog light free from the shroud. **Caution: If you depress the LEFT side first, the light will get stuck. Avoid applying excessive force as it may break off the mounting tab inside the shroud.**



4. Orient the back of the mounting bucket so the word **"TOP"** is at the top. Insert the plastic nut into the square hole of the tab from the **BOTTOM**. It will snap into place.

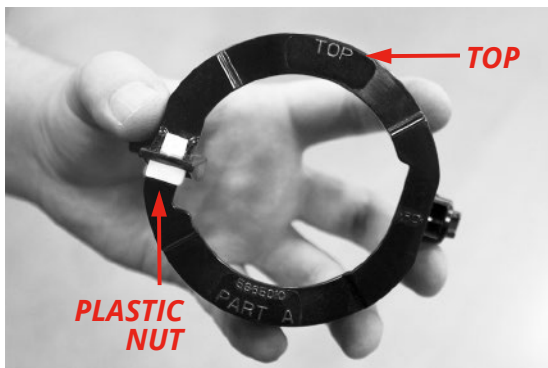

5. Holding the J.W. Speaker lights face-down, orient them so that the breather patch is at the **TOP** and the wiring is on the **LEFT**.

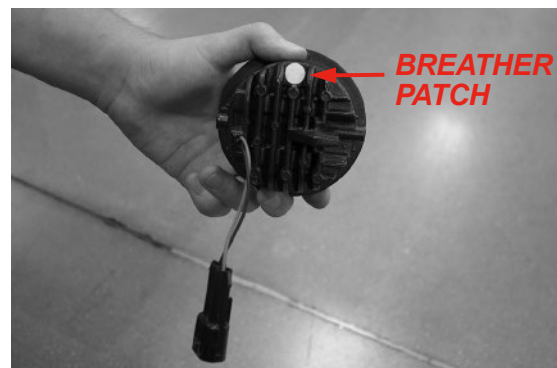

6. Feed the wire on the **BACK** of the light through the mounting bucket and orient the plastic mounting bucket with the **"TOP"** text at the **TOP** of the light.

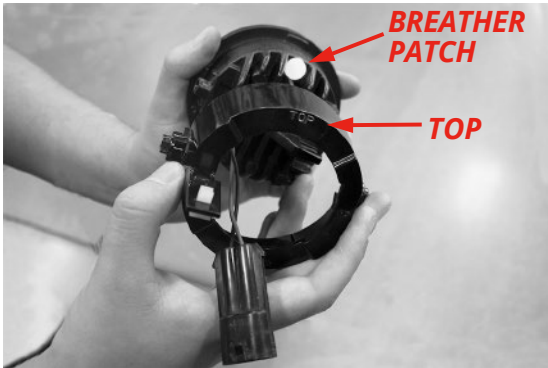

7. Insert the mounting bucket onto the light, starting side with the adjustment arm. Squeeze the top and bottom of the mounting bucket so that it widens slightly at the sides. There will be an audible snap when it is properly seated. **Caution: Starting from the other side will not allow the mounting bucket to attach to the fog light.**



8: Take the light with the **"TOP"** text on top (when looking at the light from the back), and feed the wires through the hole in the shroud. Ensure that the **"SPEAKER"** logo is right-side up across the bottom of the front of the light. **Caution: If installed incorrectly, the light pattern will be upside-down and will NOT be street legal.**

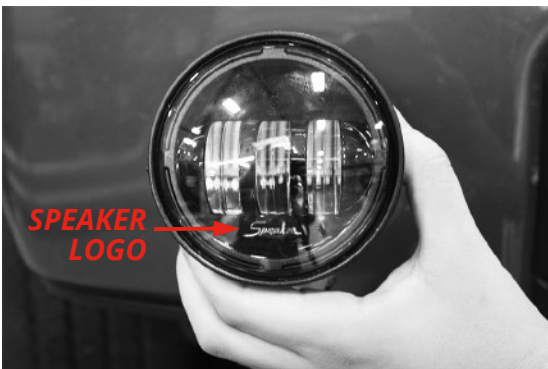

9. Guide the **LEFT** post on the mounting bucket into the mounting tab on the shroud. Once inserted, push the **RIGHT** post into place. The light should pivot freely up and down (about 10 degrees).

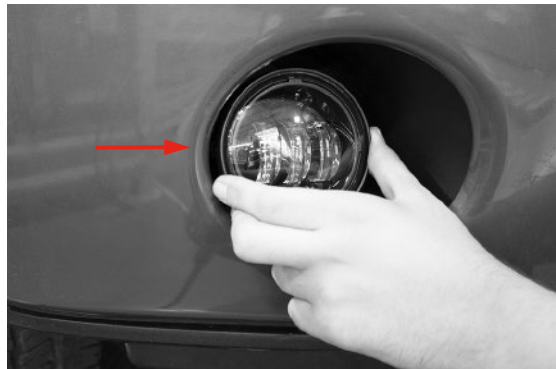

Caution: If the light does not pivot freely up and down, the installation was not done properly. Remove the light and start over from step 8 and verify that the mounting bucket has been properly attached.

If installed incorrectly, use the flathead screwdriver to pry the mounting bucket from between the post and fog light housing.

10. From underneath the vehicle, verify that the adjustment arm on the back of the mounting bucket and the shroud are on the same side. Insert the spring between the aligned adjustment arms.

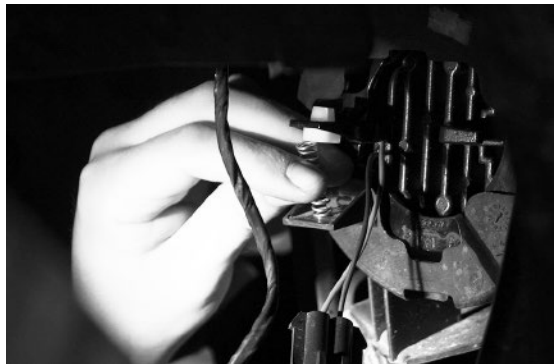

11. Insert the adjustment screw from the bottom of the aligned adjustment arms, through the spring, into the plastic nut. Turn the adjustment screw until it engages the plastic nut. Compare the pattern of the light coming from the 2 fog lamps as the shine on the wall by covering and uncovering each lamp individually."



12. Using the #2 Phillips screwdriver or socket wrench, rotate the adjustment screw (clockwise to raise, counterclockwise to lower) on the rear of the lamp to aim the light like the existing fog light. **NOTE: The horizon (cut-off from light to dark) of the two lamps must align.**

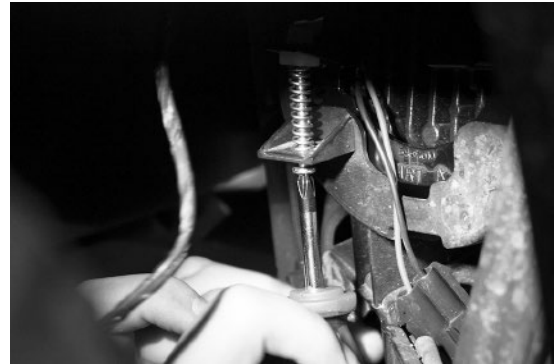

13. Reconnect the wire harness. **Optional:** The wire harness may be secured behind the mounting bucket with a zip tie (not included) to prevent accidental disconnection of the light.



Repeat steps 1-13 to install the light into the shroud for the **PASSENGER SIDE** using the specific instructions for 3B-1 and 3B-2 below:

3B-1: PASSENGER SIDE: Facing the front of the vehicle, locate the mounting tab on the **LEFT** side of the stock fog light. Use the flat blade screwdriver to depress the mounting tab until the post is released from the mounting tab.



3B-2: Using one hand at the front and one at the back of the light, wiggle the stock fog light free from the shroud.

Caution: If you depress the RIGHT side first, the light will get stuck. Avoid applying excessive force as it may break off the mounting tab inside the shroud.



18. Reconnect the vehicle's battery. Turn on the lights to ensure that they are correctly installed and functioning. If they do not turn on, please check your electrical connections.