



KD-AR765S / KD-R760 / KD-R660 / KD-AR565 / KD-R460

CD RECEIVER

INSTRUCTION MANUAL

Please read all instructions carefully before operation to obtain the best possible performance from the unit.

JVCKENWOOD Corporation



For customer Use:

Enter below the Model No. and Serial No. which are located on the top or bottom of the cabinet. Retain this information for future reference.

Model No. _____
Serial No. _____

CAUTION

Use of controls or adjustments or performance of procedures other than those specified herein may result in hazardous radiation exposure.

In compliance with Federal Regulations, following are reproductions of labels on, or inside the product relating to laser product safety.

JVC KENWOOD Corporation
2967-3, ISHIKAWA-MACHI,
HACHIOJI-SHI, TOKYO, JAPAN

THIS PRODUCT COMPLIES WITH DHHS RULES 21CFR
SUBCHAPTER J IN EFFECT AT DATE OF MANUFACTURE.

Location : Top Plate

FCC WARNING

This equipment may generate or use radio frequency energy. Changes or modifications to this equipment may cause harmful interference unless the modifications are expressly approved in the instruction manual. The user could lose the authority to operate this equipment if an unauthorized change or modification is made.

FCC NOTE

This equipment has been tested and found to comply with the limits for a Class B digital device, pursuant to Part 15 of the FCC Rules. These limits are designed to provide reasonable protection against harmful interference in a residential installation. This equipment may cause harmful interference to radio communications, if it is not installed and used in accordance with the instructions. However, there is no guarantee that interference will not occur in a particular installation. If this equipment does cause harmful interference to radio or television reception, which can be determined by turning the equipment off and on, the user is encouraged to try to correct the interference by one or more of the following measures:

- Reorient or relocate the receiving antenna.
- Increase the separation between the equipment and receiver.
- Connect the equipment into an outlet on a circuit different from that to which the receiver is connected.
- Consult the dealer or an experienced radio/TV technician for help.

BEFORE USE

▲ Warning

Do not operate any function that takes your attention away from safe driving.

▲ Caution

Volume setting:

- Adjust the volume so that you can hear sounds outside the car to prevent accidents.
- Lower the volume before playing digital sources to avoid damaging the speakers by the sudden increase of the output level.

General:

- Avoid using the external device if it might hinder safe driving.
- Make sure all important data has been backed up. We shall bear no responsibility for any loss of recorded data.
- Never put or leave any metallic objects (such as coins or metal tools) inside the unit, to prevent a short circuit.
- If a disc error occurs due to condensation on the laser lens, eject the disc and wait for the moisture to evaporate.

Remote control (RM-RK52):

- Do not leave the remote control in hot places such as on the dashboard.
- The Lithium battery is in danger of explosion if replaced incorrectly. Replace it only with the same or equivalent type.
- The battery pack or batteries shall not be exposed to excessive heat such as sunshine, fire or the like.
- Keep the battery out of reach of children and in its original packaging when not in used. Dispose of used batteries promptly. If swallowed, contact a physician immediately.

Maintenance

Cleaning the unit: Wipe off dirt on the faceplate with a dry silicone or soft cloth.

Cleaning the connector: Detach the faceplate and clean the connector gently with a cotton swab, being careful not to damage the connector.

Handling discs:

- Do not touch the recording surface of the disc.
- Do not stick tape etc. on the disc, or use a disc with tape stuck on it.
- Do not use any accessories for the disc.
- Clean from the center of the disc and move outward.
- Clean the disc with a dry silicone or soft cloth. Do not use any solvents.
- When removing discs from this unit, pull them out horizontally.
- Remove burrs from the center hole and disc edge before inserting a disc.



Connector (on the reverse side of the faceplate)

BASICS

Faceplate

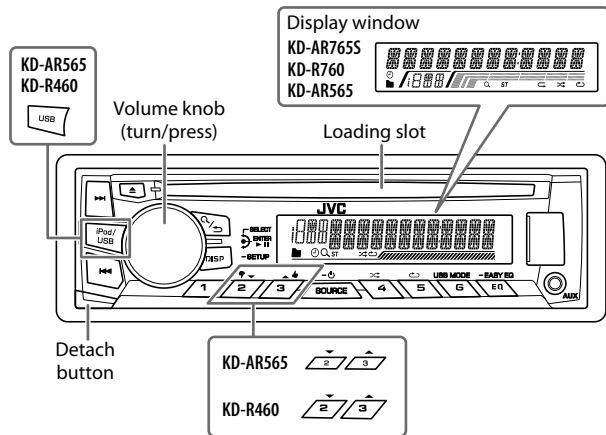

Attach

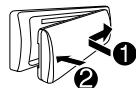

Detach

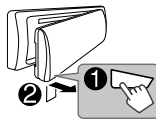

How to reset

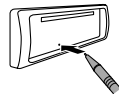

Your preset adjustments will also be erased.

Remote control (RM-RK52)

Remote sensor (Do not expose to bright sunlight.)

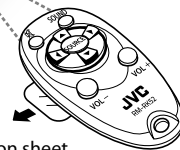

Pull out the insulation sheet when using for the first time.

How to replace the battery



To	On the faceplate	On the remote control
Turn on the power	Press SOURCE-⏻ . • Press and hold to turn off the power.	—
Adjust the volume	Turn the volume knob. Press the volume knob to mute the sound or pause playback. • Press again to cancel.	Press VOL + or VOL - . Press MUTE to mute the sound or pause playback. • Press again to cancel.
Select a source	• Press SOURCE-⏻ repeatedly. • Press SOURCE-⏻ , then turn the volume knob within 2 seconds. • Press iPod / USB or USB to select iPod or USB source directly.	Press SOURCE repeatedly.
Change the display information	Press DISP-SETUP repeatedly. (→ 19)	—

GETTING STARTED

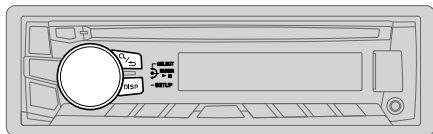

1 Cancel the demonstration

- 1 Press and hold **DISP-SETUP**.
- 2 Turn the volume knob to select [DEMO], then press the knob.
- 3 Turn the volume knob to select [DEMO OFF], then press the knob.
- 4 Press **DISP-SETUP** to exit.

2 Set the clock

- 1 Press and hold **DISP-SETUP**.
- 2 Turn the volume knob to select [CLOCK], then press the knob.
- 3 Turn the volume knob to select [CLOCK SET], then press the knob.
- 4 Turn the volume knob to make the settings, then press the knob.
Day → Hour → Minute
- 5 Turn the volume knob to select [24H/ 12H], then press the knob.
- 6 Turn the volume knob to select [12 HOUR] or [24 HOUR], then press the knob.
- 7 Press **DISP-SETUP** to exit.

To return to the previous setting item, press \mathcal{Q} / \mathcal{D} .

3 Set the basic settings

- 1 Press and hold **DISP-SETUP**.
- 2 Turn the volume knob to make a selection (see the following table), then press the knob.
- 3 Repeat step 2 until the desired item is selected or activated.
- 4 Press **DISP-SETUP** to exit.

To return to the previous setting item, press \mathcal{Q} / \mathcal{D} .

Default: **XX**

SETTINGS

BEEP **ON**: Activates the keypress tone. ; **OFF**: Deactivates.

SRC SELECT

AM* **ON**: Enables AM in source selection. ; **OFF**: Disables.

PANDORA* (For KD-AR765S / KD-R760 / KD-R660)
ON: Enables PANDORA in source selection. ; **OFF**: Disables.

IHEART* (For KD-AR765S / KD-R760 / KD-R660)
ON: Enables IHEARTRADIO in source selection. ; **OFF**: Disables.

AUX* **BT ADAPTER**: Selects when the KS-BTA100 Bluetooth adapter is connected to the AUX jack. (\rightarrow 8) ; **ON**: Enables AUX in source selection. ; **OFF**: Disables.

F/W UPDATE

SYSTEM

F/W xxxxx **YES**: Starts upgrading the firmware. ; **NO**: Cancels (upgrading is not activated).

CLOCK

CLOCK SYNC **AUTO**: The clock time is automatically set using the Clock Time (CT) data in FM Radio Broadcast Data System signal. ; **OFF**: Cancels.

CLOCK DISP **ON**: The clock time is shown on the display even when the unit is turned off. ; **OFF**: Cancels.

* Not displayed when the corresponding source is selected.

CD / USB / iPod / ANDROID

Start playback

The source changes automatically and playback starts.

CD

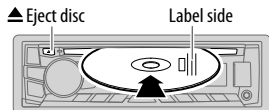

USB input terminal

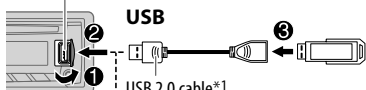

USB 2.0 cable*1
(commercially available)

iPod/iPhone

(for KD-AR765S /
KD-R760 / KD-R660)

(Accessory of the iPod/
iPhone)*1

ANDROID*2

Micro USB 2.0 cable*1
(commercially available)

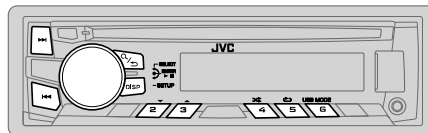

To	On the faceplate	On the remote control
Reverse / Fast-forward*3	Press and hold ◀◀ / ▶▶L	Press and hold ◀ / ▶.
Select a track/file	Press ◀◀ / ▶▶L	Press ◀ / ▶.
Select a folder*4	Press 3 ▲ / 2 ▼.	Press ▲ / ▼.
Repeat play*5	Press 5 ↺ repeatedly. TRACK RPT/ RPT OFF : Audio CD or JVC Playlist Creator (JPC) / JVC Music Control (JMC) file (➔ 19)	
	TRACK RPT/ FOLDER RPT/ RPT OFF : MP3/WMA/WAV file	
	ONE RPT/ ALL RPT/ RPT OFF : iPod or ANDROID	
Random play*5	Press 4 ⇄ repeatedly. ALL RND/ RND OFF : Audio CD	
	FOLDER RND/ ALL RND/ RND OFF : MP3/WMA/WAV file or JPC / JMC file	
	SONG RND/ ALL RND/ RND OFF : iPod or ANDROID	

*1 Do not leave the cable inside the car when not using.

*2 When connecting an Android device, "Press [VIEW] to install JVC MUSIC PLAY APP" is shown. Follow the instructions to install the application. You can also install the latest version of JVC MUSIC PLAY application on your Android device before connecting. (➔ 18)

*3 For ANDROID: Applicable only when [AUTO MODE] is selected. (➔ 6)

*4 For CD: Only for MP3/WMA files. This does not work for iPod/ ANDROID.

*5 For iPod/ ANDROID: Applicable only when [HEAD MODE]/ [AUTO MODE] is selected. (➔ 6)

CD / USB / iPod / ANDROID

To	On the faceplate
Select control mode	<p>While in iPod source, press 6 USB MODE repeatedly.</p> <p>HEAD MODE: Control from the unit.</p> <p>IPHONE MODE: Control from the iPod/iPhone. However, you can still play/pause or file skip from the unit.</p> <p>While in ANDROID source, press 6 USB MODE repeatedly.</p> <p>AUTO MODE: Control from the unit (using JVC MUSIC PLAY application).</p> <p>AUDIO MODE: Control other media player applications from the Android device (without using JVC MUSIC PLAY application). However, you can still play/pause or file skip from the unit.</p>
Select music drive	<p>Press 6 USB MODE repeatedly.</p> <p>The stored songs in the following start playback.</p> <ul style="list-style-type: none">Selected internal or external memory of a smartphone (Mass Storage Class).Selected drive of a multiple drives device.

Change the playback speed of the Audiobook

(For KD-AR765S / KD-R760 / KD-R660)

While listening to the iPod and [HEAD MODE] is selected (➔ Select control mode)...

- 1 Press and hold **DISP-SETUP**.
- 2 Turn the volume knob to select [IPOD], then press the knob.
- 3 Press the volume knob to select [AUDIOBOOKS].
- 4 Turn the volume knob to make a selection, then press the knob.
0.5× SPEED / 1× SPEED / 2× SPEED: Select the desired playback speed of the Audiobooks sound file in your iPod/iPhone.
(Default: Depends on your iPod/iPhone setting.)
- 5 Press **DISP-SETUP** to exit.

To return to the previous setting item, press **Q/↵**.

Select a file from a folder/list

- 1 Press **Q/↵**.
- 2 Turn the volume knob to select a folder/list, then press the knob.
- 3 Turn the volume knob to select a file, then press the knob.

Quick Search

If you have many files, you can search through them quickly.

For MP3/WMA/WAV or JPC / JMC file:

Turn the volume knob quickly.

For iPod:

You can search for a file according to the first character.

Press **3 ▲ / 2 ▼** or turn the volume knob quickly to select the desired character (A to Z/ 0 to 9/ OTHERS).

- Select "OTHERS" if the first character is other than A to Z, 0 to 9.

- To return to the previous setting item, press **Q/↵**.
- To cancel, press and hold **Q/↵**.
- For iPod, applicable only when [HEAD MODE] is selected. (➔ Select control mode)
- For ANDROID, applicable only when [AUTO MODE] is selected. (➔ Select control mode)

RADIO

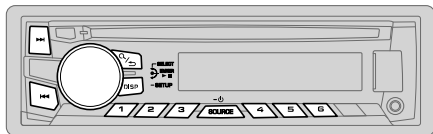

“ST” lights up when receiving an FM stereo broadcast with sufficient signal strength.

Search for a station

- 1 Press **SOURCE**- repeatedly to select FM or AM.
- 2 Press (or press on RM-RK52) to search for a station automatically.
(or)
Press and hold (or press and hold on RM-RK52) until “M” flashes, then press repeatedly to search for a station manually.

Settings in memory

You can store up to 18 stations for FM and 6 stations for AM.

Store a station

While listening to a station...

Press and hold one of the number buttons (1 to 6).

(or)

- 1 Press and hold the volume knob until “PRESET MODE” flashes.
- 2 Turn the volume knob to select a preset number, then press the knob.

The preset number flashes and “MEMORY” appears.

Select a stored station

Press one of the number buttons (1 to 6).

(or)

- 1 Press / .
- 2 Turn the volume knob to select a preset number, then press the knob to confirm.

Other settings

- 1 Press and hold **DISP-SETUP**.
- 2 Turn the volume knob to select [TUNER], then press the knob.
- 3 Turn the volume knob to make a selection (see the following table), then press the knob.
- 4 Repeat step 3 until the desired item is selected/activated or follow the instructions stated on the selected item.
- 5 Press **DISP-SETUP** to exit.

To return to the previous setting item, press / .

Default: **XX**

RADIO TIMER	Turns on the radio at a specific time regardless of the current source. <ol style="list-style-type: none">1 ONCE/ DAILY/ WEEKLY/ OFF: Select how often the timer will be turned on.2 FM/ AM/ SIRIUS XM*1: Select the source.3 01 to 18 (for FM/ SIRIUS XM)/ 01 to 06 (for AM): Select the preset station.4 Set the activation day*2 and time. “” lights up when complete. Radio Timer will not activate for the following cases.<ul style="list-style-type: none">• The unit is turned off.• [OFF] is selected for [AM] in [SRC SELECT] after Radio Timer for AM is selected. (→ 4)
--------------------	--

*1 For KD-AR765S: Selectable only when SiriusXM Vehicle Tuner is connected.

*2 Selectable only when [ONCE] or [WEEKLY] is selected in step 1.

RADIO

Default: **XX**

SSM	SSM 01 – 06 / SSM 07 – 12 / SSM 13 – 18: Automatically presets up to 18 stations for FM. "SSM" stops flashing when the first 6 stations are stored. Select SSM 07 – 12 / SSM 13 – 18 to store the following 12 stations.
IF BAND	AUTO: Increases the tuner selectivity to reduce interference noises from adjacent FM stations. (Stereo effect may be lost.) ; WIDE: Subjects to interference noises from adjacent FM stations, but sound quality will not be degraded and the stereo effect will remain.
MONO	Displayed only when the source is FM. ON: Improves the FM reception, but the stereo effect will be lost. ; OFF: Cancels.
AREA	AREA US: For North/Central/South America, AM/FM intervals: 10 kHz/200 kHz. ; AREA SA: For some South American countries, AM/FM intervals: 10 kHz/50 kHz. ; AREA EU: For any other areas, AM/FM intervals: 9 kHz/50 kHz.
PTY SEARCH	Select a PTY code (see below). If there is a station broadcasting a program of the same PTY code as you have selected, that station is tuned in.

PTY code: NEWS, INFORM (information), SPORTS, TALK, ROCK, CLS ROCK (classic rock), ADLT HIT (adult hits), SOFT RCK (softrock), TOP 40, COUNTRY, OLDIES, SOFT, NOSTALGA (nostalgia), JAZZ, CLASSICL (classical), R & B (rhythm and blues), SOFT R&B (soft rhythm and blues), LANGUAGE, REL MUSC (religious music), REL TALK (religious talk), PERSNLTY (personality), PUBLIC, COLLEGE, HABL ESP (Spanish talk), MUSC ESP (Spanish music), HIP HOP, WEATHER

AUX

Use a portable audio player

1 Connect a portable audio player (commercially available).

3.5 mm (1/8") stereo mini plug with "L" shaped connector (commercially available)

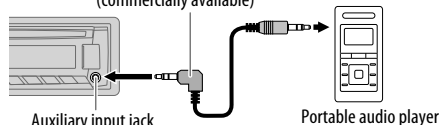

2 Select [ON] for [AUX] in [SRC SELECT]. (→ 4)

3 Press **SOURCE**- repeatedly to select **AUX**.

4 Turn on the portable audio player and start playback.



Use a 3-core plug head stereo mini plug for optimum audio output.

Use a Bluetooth® device

1 Connect the Bluetooth adapter, KS-BTA100 (separately purchased).

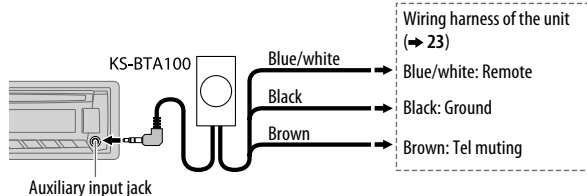

2 Register (pair) the Bluetooth device with KS-BTA100.

3 Select [BT ADAPTER] for [AUX] in [SRC SELECT]. (→ 4)

4 Press **SOURCE**- repeatedly to select **BT AUDIO**.

5 Start using the Bluetooth device.

For details, refer to the instruction manual of KS-BTA100.

Pandora® (for KD-AR765S / KD-R760 / KD-R660)

Preparation:

Install the latest version of the Pandora application on your device (iPhone/ iPod touch), then create an account and log in to Pandora.

- Select [ON] for [PANDORA] in [SRC SELECT]. (→ 4)

Start listening

- 1 Open the Pandora application on your device.
- 2 Connect your device to the USB input terminal.

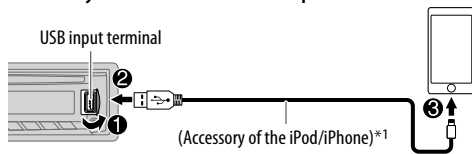

The source changes to PANDORA and broadcast starts.

To	On the faceplate	On the remote control
Playback / pause	Press the volume knob.	Press
Skip a track	Press	Press
Thumbs up or thumbs down*2	Press 3 / 2 .	Press / .

*1 Do not leave the cable inside the car when not using.

*2 If thumbs down is selected, the current track is skipped.

Create and save a new station

- 1 Press / .
- 2 Turn the volume knob to select [NEW STATION], then press the knob.
- 3 Turn the volume knob to select [FROM TRACK] or [FROM ARTIST], then press the knob.

A new station is created based on the current song or artist.

- 4 Press and hold number button **1**, **4**, **5** or **6** to store.

To select a stored station, press number button **1**, **4**, **5** or **6**.

Search for a registered station

- 1 Press / .
- 2 Turn the volume knob to make a selection, then press the knob.
[BY DATE]: According to the registered date.
[A-Z]: Alphabetical order.
- 3 Turn the volume knob to the desired station, then press the knob.

To cancel, press and hold / .

Bookmark a song or artist information

- 1 Press and hold the volume knob.
- 2 Turn the volume knob to make a selection, then press the knob.
[THIS TRACK]: Current song information
[THIS ARTIST]: Current artist information
"BOOKMARKED" appears and the information is stored to your device.
The bookmark is available on your Pandora account but not on this unit.

iHeartRadio® (for KD-AR765S / KD-R760 / KD-R660)

Preparation:

Install the latest version of iHeart Link for JVC application on your device (iPhone/ iPod touch), then create an account and log in to iHeartRadio.

- Select [ON] for [IHEART] in [SRC SELECT]. (→ 4)

Start listening

- 1 Open the iHeart Link application on your device.
- 2 Connect your device to the USB input terminal.

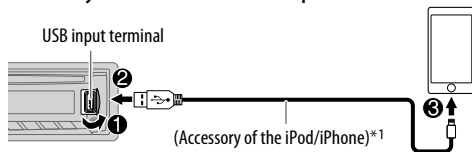

- 3 Press **SOURCE** \ominus repeatedly to select IHEARTRADIO.
Broadcast starts automatically

To	On the faceplate	On the remote control
Playback / pause	Press the volume knob.	Press \times .
Skip a track for custom station	Press \gg .	Press \blacktriangleright .
Thumbs up or thumbs down for custom station*2	Press 3 \blacktriangle / 2 \blacktriangledown .	Press \blacktriangle / \blacktriangledown .
Create a new/custom station	Press and hold the volume knob.	—
Add to favorite stations for live station	Press 1 .	—
Scan for live station	Press 4 .	—

*1 Do not leave the cable inside the car when not using.

*2 If thumbs down is selected, the current track is skipped.

Search for a station

- 1 Press \mathcal{Q} / \mathcal{S} .
- 2 Turn the volume knob to select a category, then press the knob.
- 3 Turn the volume knob to the desired station, then press the knob.

When a city list appears, you can skip cities in alphabetical order.

To cancel, press and hold \mathcal{Q} / \mathcal{S} .

Skip cities by alphabetical order

While a city list appears during search...

- 1 Turn the volume knob quickly to enter character search.
- 2 Turn the volume knob or press **3** \blacktriangle / **2** \blacktriangledown to select the character to be search for.
- 3 Press the volume knob to start searching.

To cancel, press and hold \mathcal{Q} / \mathcal{S} .

SiriusXM® Radio (for KD-AR765S)

Only SiriusXM® brings you more of what you love to listen to, all in one place. Get over 140 channels, including commercial-free music plus the best sports, news, talk, comedy and entertainment. Welcome to the world of satellite radio. A SiriusXM Vehicle Tuner and Subscription are required.

Preparation:

- 1 Connect the optional SiriusXM Vehicle Tuner (commercially available).

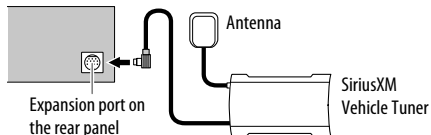

- 2 Check your Radio ID for activation.

The SiriusXM Radio ID is required for activation and can be found by tuning to Channel 0 as well as on the label found on the SiriusXM Connect tuner and its' packaging.

The Radio ID does not include the letters I, O, S or F.

- 3 Press **SOURCE** repeatedly to select SIRIUS XM to start updating.

Start listening

- 1 Press **SOURCE** repeatedly to select SIRIUS XM.
- 2 Press **Q** / **▷**.
"Q" lights up.
- 3 Turn the volume knob to select a CATEGORY, then press the knob.
- 4 Turn the volume knob to select a category from the list, then press the knob.
If "ALL CHANNEL" is selected, all the available channels will be shown.
- 5 Turn the volume knob to select a channel, then press the knob.
(or)
Press **◀◀** / **▶▶** to search for a channel manually.
• Pressing and holding **◀◀** / **▶▶** changes the channel rapidly.

If a locked channel or a mature channel is selected, a pass code input screen appears. Enter the pass code to receive the channel. (→ 13)

Store a channel

You can store up to 18 channels.

To	Do this
Store a channel	Press and hold one of the number buttons (1 to 6). <ol style="list-style-type: none">1 Press and hold the volume knob until "PRESET MODE" flashes.2 Turn the volume knob to select a preset number, then press the knob. The preset number flashes and "MEMORY" appears.
Select a stored channel	Press one of the number buttons (1 to 6). <ol style="list-style-type: none">1 Press Q / ▷.2 Turn the volume knob to select PRESET, then press the knob.3 Turn the volume knob to select a preset number, then press the knob.
	Press ▲ / ▼ on RM-RK52.

SiriusXM® Radio

SiriusXM Replay™

- 1 Press the volume knob.
“⏸” lights up and the unit memorizes this paused position.
- 2 Press the volume knob to start Replay.
Replay starts from the paused position in step 1.

During Replay...

To	On the faceplate	On the remote control
Playback / pause	Press the volume knob.	Press
Skip the current song backward/forward	Press / .	Press / .
Rewind / Fast-forward	Press and hold / .	Press and hold / .
Go to Live and exit Reply	Press and hold the volume knob. 1 Press / . 2 Turn the volume knob to select LIVE, then press the knob.	

SmartFavorites and TuneStart™

User preset channels are initially assigned as the SmartFavorites channels. SmartFavorite channel is available with SXV200 or later SiriusXM tuner models. SiriusXM Vehicle Tuner automatically buffers the broadcast audio content of the SmartFavorites channels in the background.

- **Using SXV200:** This unit can assign a maximum of 6 SmartFavorites channels. If you try to assign the 7th channel, an error beep tone will be heard. Initially, preset channels 1 to 6 are assigned as SmartFavorites. **Using SiriusXM tuner models later than SXV200:** This unit can assign a maximum of 18 SmartFavorites channels. Initially, all preset channels are assigned as SmartFavorites.
- “*” appears at the last character of the channel name for the SmartFavorites channels.

When you select a SmartFavorites channel, you can rewind and replay up to 30 minutes of any of the missed news, talk, sports or music content.

- Playback starts from the beginning of the song if [TUNE START] is set to [ON] (→ 13) for most music channels stored as a SmartFavorite.

To	On the faceplate
Select a stored SmartFavorite channel	Press one of the number buttons (1 to 6). 1 Press / . 2 Turn the volume knob to select a preset number, then press the knob to confirm.
Cancel SmartFavorites channels	1 Press / . 2 Turn the volume knob to select PRESET, then press the knob. 3 Turn the volume knob to select a preset number, then press and hold the knob. “*” are removed from the last character.
Reassign SmartFavorites channels	Repeat steps 1 to 3 of cancelling SmartFavorites channels. “*” appears at the last character.

TuneScan™

You can get a short preview of the songs that you have missed on each of your SmartFavorite music channels or current tuned music channel.

- 1 Press / .
 - 2 Turn the volume knob to select TUNE SCAN, then press the knob.
Scanning start for the first 6 seconds of the recorded music contents.
- To listen to the current song, press the volume knob to stop scanning. The unit continues playing the current song.
 - To select the previous/next song, press / .
 - To cancel scanning, press and hold the volume knob. Playback returns to the channel before you enter TuneScan.

SiriusXM® Radio

SiriusXM settings

- 1 Press and hold **DISP-SETUP**.
- 2 Turn the volume knob to select [SIRIUS XM], then press the knob.
- 3 Turn the volume knob to make a selection (see the following table), then press the knob.
- 4 Repeat step 3 until the desired item is selected/activated or follow the instructions stated on the selected item.
- 5 Press **DISP-SETUP** to exit.

To return to the previous setting item, press **Q** / **↵**.

Default: **XX**

CH LOCK	To unlock settings: <ol style="list-style-type: none">1 Turn the volume knob to select a number.2 Press ◀◀ / ▶▶ to move to the entry position.3 Repeat steps 1 and 2 to enter the current pass code. (Initial pass code is 0000.)4 Press the volume knob to confirm.
CODE SET	<ol style="list-style-type: none">1 Press the volume knob to enter [NEW CODE].2 Turn the volume knob to select a number.3 Press ◀◀ / ▶▶ to move to the entry position.4 Repeat steps 2 and 3 to enter a new 4-digit pass code.5 Press the volume knob to confirm.6 Repeat steps 2 to 5 to reconfirm the pass code. <ul style="list-style-type: none">• Make a note of the new pass code to enter channel lock settings from next time.
LOCK SET	MATURE CH: Selects the SiriusXM-defined lock setting. ; USER DEFINED: Selects the user-defined lock setting. ; OFF: Cancels.
CH EDIT *1	<ol style="list-style-type: none">1 Turn the volume knob to select a category, then press the knob.2 Turn the volume knob to select a channel you want to lock, then press the knob. "L" appears in front of the channel number.3 Press and hold Q / ↵ to exit.
CH CLEAR *1	YES: Clears all the locked channels. ; NO: Cancels.

TUNE START *2	ON: Selected SmartFavorite channel starts playback from the beginning of the song. ; OFF: Cancels.
SIGNAL LVL	NO SIGNAL/ WEAK/ GOOD/ STRONG: Shows the strength of the current received signal.
BUF USAGE	0% — 100% (0): Shows the memory usage for Replay buffer.
SXM RESET	YES: Resets stored channel and lock setting to default. ; NO: Cancels.

*1 Displayed only when [USER DEFINED] is selected.

*2 Available only if the connected SiriusXM Vehicular Tuner is SXV200 or later that supports SmartFavorites.

AUDIO SETTINGS

To	On the faceplate
Select a preset equalizer	<p>Press EQ-EASY EQ repeatedly.</p> <p>Press EQ-EASY EQ, then turn the volume knob within 2 seconds.</p> <p>Preset equalizer: FLAT (default), HARD ROCK, JAZZ, POP, R&B, TALK, USER1, USER2, VOCAL BOOST, BASS BOOST, CLASSICAL, DANCE</p>
Store your own sound settings	<ol style="list-style-type: none"> 1 Press and hold EQ-EASY EQ. 2 Turn the volume knob to select [EASY EQ], then press the knob. 3 Turn the volume knob to select [USER1] or [USER2], then press the knob. 4 Turn the volume knob to make a selection, then press the knob. <p>SUB.W SP*1*2: 00 to +06 (Default: <u>03</u>)</p> <p>SUB.W*1*3: -08 to +08 <u>00</u></p> <p>BASS LVL: -06 to +06 <u>00</u></p> <p>MID LVL: -06 to +06 <u>00</u></p> <p>TRE LVL: -06 to +06 <u>00</u></p> <ul style="list-style-type: none"> • To return to the previous setting item, press \mathcal{Q} / \rightarrow. • To exit, press EQ-EASY EQ.

Other settings

- 1 Press and hold **DISP-SETUP**.
- 2 Turn the volume knob to make a selection (see the following table), then press the knob.
- 3 Repeat step 2 until the desired item is selected/activated or follow the instructions stated on the selected item.
- 4 Press **DISP-SETUP** to exit.

To return to the previous setting item, press \mathcal{Q} / \rightarrow .

Default: **XX**

EQ SETTING

EQ PRESET FLAT / HARD ROCK / JAZZ / POP / R&B / TALK / USER1 / USER2 / VOCAL BOOST / BASS BOOST / CLASSICAL / DANCE: Selects a preset equalizer.

EASY EQ

- 1 USER1 / USER2: Select a preset name.
- 2 Adjust your own sound settings.

SUB.W SP*1*2:	00 to +06	(Default: <u>03</u>)
SUB.W*1*3:	-08 to +08	<u>00</u>
BASS LVL:	-06 to +06	<u>00</u>
MID LVL:	-06 to +06	<u>00</u>
TRE LVL:	-06 to +06	<u>00</u>

PRO EQ

- 1 USER1 / USER2: Select a preset name.
- 2 BASS / MIDDLE / TREBLE: Select a sound tone.
- 3 Adjust the sound elements of the selected sound tone.

BASS	Frequency: 60 / 80 / 100 / 200 HZ	(Default: <u>80 HZ</u>)
	Level: -06 to +06	<u>00</u>
	Q: Q1.0 / Q1.25 / Q1.5 / Q2.0	<u>Q1.0</u>
MIDDLE	Frequency: 0.5 / 1.0 / 1.5 / 2.5 KHZ	(Default: <u>1.0 KHZ</u>)
	Level: -06 to +06	<u>00</u>
	Q: Q0.75 / Q1.0 / Q1.25	<u>Q1.25</u>
TREBLE	Frequency: 10.0 / 12.5 / 15.0 / 17.5 KHZ	(Default: <u>10.0 KHZ</u>)
	Level: -06 to +06	<u>00</u>
	Q: Q FIX	<u>Q FIX</u>

*1 Displayed only when [SUB.W] is set to [ON]. (\rightarrow 15)

*2 Displayed only when [SPK/PRE OUT] is set to [SUB.W/SUB.W]. (\rightarrow 15)

*3 Displayed only when [SPK/PRE OUT] is set to [REAR/SUB.W] or [SUB.W/SUB.W]. (\rightarrow 15)

AUDIO SETTINGS

AUDIO	
BASS BOOST	+01 / +02: Selects your preferred bass boost level. ; OFF: Cancels.
LOUD	01 / 02: Boosts low or high frequencies to produce a well-balanced sound at low volume. ; OFF: Cancels.
SUB.W LEVEL*4	<p>SPK-OUT*5 00 to +06 (+03): Adjusts the output level of the subwoofer connected via speaker lead. (→ 23)</p> <p>PRE-OUT*6 −08 to +08 (00): Adjusts the output level of the subwoofer connected to the lineout terminals (SW or REAR/SW) through an external amplifier. (→ 23)</p>
SUB.W*6	ON / OFF: Turns on or off the subwoofer output.
SUB.W LPF*4	THROUGH: All signals are sent to the subwoofer. ; LOW 55HZ / MID 85HZ / HIGH 120HZ: Audio signals with frequencies lower than 55 Hz/ 85 Hz/ 120 Hz are sent to the subwoofer.
SUB.W PHASE*4	REVERSE (180°) / NORMAL (0°): Selects the phase of the subwoofer output to be in line with the speaker output for optimum performance. (Selectable only if a setting other than [THROUGH] is selected for [SUB.W LPF].)
FADER	R06 — F06 (00): Adjusts the front and rear speaker output balance.
BALANCE*7	L06 — R06 (00): Adjusts the left and right speaker output balance.
VOL ADJUST	−05 — +05 (00): Presets the volume adjustment level of each source (compared to the FM volume level). Before adjustment, select the source you want to adjust. ("VOL ADJ FIX" appears if FM is selected.)
AMP GAIN	LOW POWER: Limits the maximum volume level to 30. (Select if the maximum power of each speaker is less than 50 W to prevent damaging the speakers.) ; HIGH POWER: The maximum volume level is 50.

D.T.EXP (Digital Track Expander) **ON:** Creates realistic sound by compensating the high-frequency components and restoring the rise-time of the waveform that are lost in audio data compression. ; **OFF:** Cancels.

TEL MUTING*8 **ON:** Mutes the sounds while using the cellular phone (not connected through KS-BTA100). ; **OFF:** Cancels.

SPK/PRE OUT Selects the appropriate setting to get the desired output. (→ 15, 16)

*4 Displayed only when [SUB.W] is set to [ON].

*5 Displayed only when [SPK/PRE OUT] is set to [SUB.W/SUB.W].

*6 For unit with 3-pair lineout terminals: Displayed only when [SPK/PRE OUT] is set to [REAR/REAR] or [SUB.W/SUB.W].

For unit with 2-pair or 1-pair lineout terminals: Displayed only when [SPK/PRE OUT] is set to [REAR/SUB.W] or [SUB.W/SUB.W].

*7 This adjustment will not affect the subwoofer output.

*8 Does not work if [BT ADAPTER] is selected for [AUX] in [SRC SELECT]. (→ 4)

SPK/PRE OUT

 **Connection via lineout terminals (→ 23)**

(For KD-AR765S)

Setting	Lineout terminal		
	FRONT	REAR	SW
REAR/REAR	Front speakers output	Rear speakers output	Subwoofer output
REAR/SUB.W	—	—	—
SUB.W/SUB.W	Front speakers output	L (left): Subwoofer output R (right): (Mute)	Subwoofer output

AUDIO SETTINGS

(For **KD-R760 / KD-R660**)

Setting	Lineout terminal	
	FRONT	REAR/SW
REAR/REAR	Front speakers output	Rear speakers output
REAR/SUB.W	Front speakers output	Subwoofer output
SUB.W/SUB.W	Front speakers output	Subwoofer output

(For **KD-AR565 / KD-R460**)

Setting	Lineout terminal	
	REAR/SW	
REAR/REAR	Rear speakers output	
REAR/SUB.W	Subwoofer output	
SUB.W/SUB.W	Subwoofer output	

Connection via speaker leads (→ 23)

Setting	Rear speaker lead	
	L (left)	R (right)
REAR/REAR	Rear speakers output	Rear speakers output
REAR/SUB.W	Rear speakers output	Rear speakers output
SUB.W/SUB.W	Subwoofer output	(Mute)

If **[SUB.W/SUB.W]** is selected:

- **[HIGH 120HZ]** is selected in **[SUB.W LPF]** and **[THROUGH]** is not available.
- **[R01]** is selected in **[FADER]** and selectable range is **[R06]** to **[00]**

DISPLAY SETTINGS

KD-AR765S / KD-R760

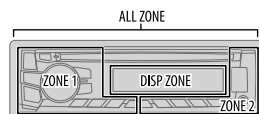

KD-AR565



KD-R660 / KD-R460

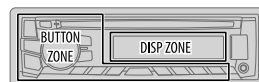

- 1 Press and hold **DISP-SETUP**.
- 2 Turn the volume knob to make a selection (see the following table), then press the knob.
- 3 Repeat step 2 until the desired item is selected/activated or follow the instructions stated on the selected item.
- 4 Press **DISP-SETUP** to exit.

To return to the previous setting item, press **Q** / **↩**.

Default: **XX**

DISPLAY

DIMMER	<p>Selects the display and button illumination adjusted in the [BRIGHTNESS] setting.</p> <p>OFF: Selects the day adjustments. ; ON: Selects the night adjustments. ; DIMMER TIME: Adjusts the dimmer on and off time. Turn the volume knob to adjust the [ON] time, then press the knob. Turn the volume knob to adjust the [OFF] time, then press the knob. (Default: [ON]: 18:00 or 6:00 PM [OFF]: 6:00 or 6:00 AM)</p> <p>AUTO: Changes between the day and night adjustments when you turn off or on the car headlights.*1</p> <p>For KD-AR765S / KD-R760 / KD-AR565, the display and button colors change according to the settings made on [COLOR].</p>
---------------	--

*1 The illumination control wire connection is required. (→ 23)

DISPLAY SETTINGS

BRIGHTNESS	Sets the button, display and USB input terminal brightness for day and night separately. 1 DAY / NIGHT: Select day or night. 2 Select a zone for setting. (→ 16) 3 Set the brightness level (00 to 31). (Default: DAY: 31 ; NIGHT: 15)
SCROLL *2	ONCE: Scrolls the display information once. ; AUTO: Repeats scrolling at 5-second intervals. ; OFF: Cancels.
COLOR (for KD-AR765S / KD-R760)	
PRESET	You can select a color for [ALL ZONE] , [ZONE 1] , [DISP ZONE] , or [ZONE 2] separately. For [ALL ZONE] , you can also select a color pattern. Default color: ALL ZONE: [COLOR 06] , ZONE 1: [COLOR 06] , DISP ZONE: [COLOR 01] , ZONE 2: [COLOR 27] 1 Select a zone for setting. (→ 16) 2 Select a color for the selected zone. <ul style="list-style-type: none">COLOR 01 to COLOR 29USER: The color you have created for [DAY COLOR] or [NIGHT COLOR] is shown.COLOR FLOW01 to COLOR FLOW03: Color changes at different speeds.GROOVE/ TECHNO/ EMOTION/ RELAX/ SPECTRUM/ SWEEP/ POP: The selected color pattern is shown.*3 (Selectable only when [ALL ZONE] is selected in step 1.)

*2 Some characters or symbols will not be shown correctly (or will be blanked).

*3 If one of these color pattern is selected, the **[ZONE 1]**, **[DISP ZONE]**, **[ZONE 2]** illumination color will change to the default color.

DAY COLOR	Store your own day and night colors for different zone. 1 Select a zone for setting. (→ 16) 2 RED / GREEN / BLUE: Select a primary color. 3 00 to 31: Select the level.
NIGHT COLOR	Repeat steps 2 and 3 for all the primary colors. <ul style="list-style-type: none">Your setting is stored to [USER] in [PRESET].If [00] is selected for all primary colors for [DISP ZONE], nothing appears on the display.
COLOR GUIDE	ON: Changes the button, display, USB input terminal and auxiliary input jack illumination when settings are performed on menu and list search. Display zone will automatically change depending on volume level. ; OFF: Cancels.
COLOR (for KD-AR565)	
PRESET	Select a color for [BUTTON ZONE] . Default: [COLOR 06] <ul style="list-style-type: none">COLOR 01 to COLOR 29USER: The color you have created for [DAY COLOR] or [NIGHT COLOR] is shown.COLOR FLOW01 to COLOR FLOW03: Color changes at different speeds.
DAY COLOR	Store your own day and night colors. 1 RED / GREEN / BLUE: Select a primary color. 2 00 to 31: Select the level.
NIGHT COLOR	Repeat steps 1 and 2 for all the primary colors. <ul style="list-style-type: none">Your setting is stored to [USER] in [COLOR].
MENU COLOR	ON: Changes the button illumination to white color when settings are performed on menu and list search. ; OFF: Cancels.

[NIGHT COLOR] or **[DAY COLOR]** is changed by turning on or off your car's headlight.

MORE INFORMATION

About discs and audio files

- This unit can only play the following CDs:



- This unit can play back multi-session discs; however, unclosed sessions will be skipped during playback.
- **Unplayable discs:**
 - Discs that are not round.
 - Discs with coloring on the recording surface or discs that are dirty.
 - Recordable/ReWritable discs that have not been finalized.
 - 8 cm CD. Attempting to insert using an adapter may cause malfunction.
- **DualDisc playback:** The Non-DVD side of a “DualDisc” does not comply with the “Compact Disc Digital Audio” standard. Therefore, the use of Non-DVD side of a DualDisc on this product cannot be recommended.
- **Playable files:**
 - File extensions: MP3 (.mp3), WMA (.wma)
 - Bit rate: MP3: 8 kbps — 320 kbps
WMA: 32 kbps — 192 kbps
 - Sampling frequency:
MP3: 48 kHz, 44.1 kHz, 32 kHz, 24 kHz, 22.05 kHz, 16 kHz, 12 kHz, 11.025 kHz, 8 kHz
WMA: 8 kHz — 48 kHz
 - Variable bit rate (VBR) files.
- **Maximum number of characters for file/folder name:**
It depends on the disc format used (includes 4 extension characters—<.mp3> or <.wma>.
 - ISO 9660 Level 1 and 2: 32 characters
 - Romeo: 32 characters
 - Joliet: 32 characters
 - Windows long file name: 32 characters

About USB devices

- This unit can play MP3/WMA/WAV files stored on a USB mass storage class device.
- You cannot connect a USB device via a USB hub.
- Connecting a cable whose total length is longer than 5 m may result in abnormal playback.
- The maximum number of characters for:
 - Folder names: 64 characters
 - File names: 64 characters
 - MP3 Tag: 64 characters
 - WMA Tag: 64 characters
 - WAV Tag: 64 characters
- This unit can recognize a total of 20 480 files, 999 folders (999 files per folder including folder without unsupported files), and of 8 hierarchies.
- This unit cannot recognize a USB device whose rating is other than 5 V and exceeds 1 A.

About iPod/iPhone

Made for

- iPod touch (2nd, 3rd, 4th, and 5th generation)
- iPod classic
- iPod nano (3rd, 4th, 5th, 6th, and 7th generation)
- iPhone 3G, 3GS, 4, 4S, 5, 5S, 5C
- It is not possible to browse video files on the “Videos” menu in [HEAD MODE].
- The song order displayed on the selection menu of this unit may differ from that of the iPod/iPhone.
- If some operations are not performed correctly.

About Android device

- This unit supports Android OS 4.1 and above.
- Some Android devices (with OS 4.1 and above) may not fully support Android Open Accessory (AOA) 2.0.
- If the Android device supports both mass storage class device and AOA 2.0, this unit always playback via AOA 2.0 as priority.

MORE INFORMATION

About Pandora

- Pandora is available only in the U.S., Australia and New Zealand.
- Because Pandora is a third-party service, the specifications are subject to change without prior notice. Accordingly, compatibility may be impaired, or some or all of the services may become unavailable.
- Some functions of Pandora cannot be operated from this unit.

About iHeartRadio

- iHeartRadio® is a third-party service, therefore the specifications are subject to change without prior notice. Accordingly, compatibility may be impaired or some or all of the services may become unavailable.
- Some iHeartRadio® functionality cannot be operated from this unit.

About JVC Playlist Creator and JVC Music Control

- This unit supports the PC application JVC Playlist Creator and Android™ application JVC Music Control.
- When you play audio file with song data added using the JVC Playlist Creator or JVC Music Control, you can search for audio file by Genres, Artists, Albums, Playlists, and Songs.
- JVC Playlist Creator and JVC Music Control.

Change the display information

Press **DISP-SETUP** repeatedly.

FM or AM	Station name (PS)*1 → Frequency → Program type (PTY)*1*2 → Title*1*2 → Day/Clock → (back to the beginning) *1 For FM Radio Broadcast Data System stations only. *2 If unavailable, "NO PTY" / "NO TEXT" appears.
CD or USB	Playing time → Day/Clock → Disc name*3 → Album title/Artist*4 → Track title*5 → Folder/file name*6 → (back to the beginning) *3 Only for CD-DA: If not recorded, "NO NAME" appears. *4 Only for MP3/WMA/WAV files: If not recorded, "NO NAME" appears. *5 If not recorded, "NO NAME" appears. *6 Only for MP3/WMA/WAV files.
USB-IPOD USB-ANDROID	Playing time → Day/Clock → Album title/Artist*7 → Track title*7 → (back to the beginning) *7 If not recorded, "NO NAME" appears.
PANDORA	Station name → Album title/Artist → Track title → Playing time → Day/Clock → (back to the beginning)
IHEART	Station name → Track title*8 → Track Artist*8 → Day/Clock → (back to the beginning) *8 If unavailable, station name appears.
SiriusXM	Channel no./Channel name → Artist → Song title → Content information → Category name → Day/Clock → (back to the beginning)
AUX	AUX ↔ Day/Clock
BT AUDIO	BT AUDIO ↔ Day/Clock

TROUBLESHOOTING

	Symptom	Remedy
General	Sound cannot be heard.	<ul style="list-style-type: none"> Adjust the volume to the optimum level. Check the cords and connections.
	“MISWIRING CHECK WIRING THEN PWR ON” appears.	Turn the power off, then check to be sure the terminals of the speaker wires are insulated properly. Turn the power on again.
	“PROTECTING SEND SERVICE” appears.	Send the unit to the nearest service center.
	Source cannot be selected.	Check the [SRC SELECT] setting. (➔ 4)
Radio	<ul style="list-style-type: none"> Radio reception is poor. Static noise while listening to the radio. 	<ul style="list-style-type: none"> Connect the antenna firmly. Pull the antenna out all the way.
	Disc cannot be ejected.	Press and hold ▲ to forcibly eject the disc. Be careful not to drop the disc when it is ejected.
CD / USB / iPod	“IN DISC” appears.	Make sure nothing is blocking the loading slot when you eject the disc.
	“PLEASE” and “EJECT” appear alternately.	Press ▲, then insert the disc correctly.
	Playback order is not as intended.	The playback order is determined by the file name (USB) or the order in which files were recorded (disc).
	Elapsed playing time is not correct.	This depends on the recording process earlier.
	“NOT SUPPORT” appears and track skips.	Check whether the track is a playable format. (➔ 18)
	“READING” keeps flashing.	<ul style="list-style-type: none"> Do not use too many hierarchical levels and folders. Reload the disc or reattach the USB device.
“CANNOT PLAY” flashes and/or connected device cannot be detected.	<ul style="list-style-type: none"> Check whether the connected device is compatible with this unit and ensure the files are in supported formats. (➔ 18) Reattach the device. 	

	Symptom	Remedy
CD / USB / iPod	The iPod/iPhone does not turn on or does not work.	<ul style="list-style-type: none"> Check the connection between this unit and iPod/iPhone. Detach and reset the iPod/iPhone using hard reset.
	Correct characters are not displayed.	This unit can only display uppercase letters, numbers, and a limited number of symbols.
	<ul style="list-style-type: none"> Sound cannot be heard during playback. Sound output only from the Android device. 	<ul style="list-style-type: none"> Reconnect the Android device. If in [AUDIO MODE], launch any media player application on the Android device and start playback. If in [AUDIO MODE], relaunch the current media player application or use another media player application. Restart the Android device. If this does not solve the problem, the connected Android device is unable to route the audio signal to unit. (➔ 18)
ANDROID	Cannot playback at [AUTO MODE].	<ul style="list-style-type: none"> Make sure JVC MUSIC PLAY APP is installed on the Android device. (➔ 5) Reconnect the Android device and select the appropriate control mode. (➔ 6) If this does not solve the problem, the connected Android device does not support [AUTO MODE]. (➔ 18)
	“NO DEVICE” or “READING” keeps flashing.	<ul style="list-style-type: none"> Switch off the developer options on the Android device. Reconnect the Android device. If this does not solve the problem, the connected Android device does not support [AUTO MODE]. (➔ 18)
	Playback is intermittent or sound skips.	Turn off the power saving mode on the Android device.
	“CANNOT PLAY”	<ul style="list-style-type: none"> Make sure Android device contains playable audio files. Reconnect the Android device. Restart the Android device.
Pandora	“ADD ERROR” “SEARCH ERR”	New station creation is unsuccessful.
	“CHK DEVICE”	Check the Pandora application on your device.
	“NO SKIPS”	The skip limit has been reached.

TROUBLESHOOTING

	Symptom	Remedy
Pandora	"NO STATIONS"	No stations are found.
	"STATION LMT"	The number of registered stations has reached its limit. Retry after deleting unnecessary stations from your device.
	"UPGRADE APP"	Make sure you have installed the latest version of the Pandora application on your device.
	"CONNECT ERR"	Communication is unstable.
	"RATING ERR"	Registration of thumbs up/thumbs down has failed.
	"LICENSE ERR"	You try to access from a country which Pandora is not deliverable.
iHeartRadio	Station cannot be selected.	If "Explicit Content" in [Account Settings] is checked in the web version of iHeartRADIO, custom stations become unavailable.
	"CREATE ERR"	Custom station name creation is unsuccessful.
	"SAVE ERROR"	Addition to the favorite category failed.
	"DISCONNECTED"	Check the connection to the device.
	"NO SKIPS"	The skip limit has been reached. Retry later.
	"NO STATIONS"	No stations are found.
	"NOT CONNCTD"	Link to the application is impossible.
	"UPDATE APP"	Make sure you have installed the latest version of the iHeart Link for JVC application on your device.
	"PLS LOGIN"	You haven't log in. Log in again.
	"STATION NOT AVAILABLE"	Broadcast from the station is over.
	"STATION NOT SELECTED"	No station is selected.
	"STREAM ERR"	Broadcast data is interrupted.
	"THUMBS ERR"	Registration of Thumbs Up/Down has failed.
"TIMED OUT"	The request has resulted in time-out.	

	Symptom	Remedy
SiriusXM® Radio	"CH LOCKED LOCK CODE?"	The selected channel is locked. Enter the correct pass code to unlock. (➔ 13)
	"CHAN UNSUB"	The selected channel is unsubscribed.
	"CH UNAVAIL"	The selected channel is unavailable.
	"CHK ANTENNA"	Check the antenna and its connection are in good condition.
	"CHECK TUNER"	Make sure the SiriusXM Vehicle Tuner is connected to the unit.
	"NO SIGNAL"	Make sure the antenna is mounted outside the vehicle.
	"SUBSCRIPTION UPDATED – PRESS ENTER TO CONTINUE."	Your subscription is updated. Press the volume knob to continue.
	"CODE ERROR"	Make sure you have entered the correct pass code. (➔ 13)
	"NO CONTENT"	There is insufficient content to start TuneScan.
	"SCAN CANCEL"	TuneScan has been aborted.

▲ Warning

- The unit can only be used with a 12 V DC power supply, negative ground.
- Disconnect the battery's negative terminal before wiring and mounting.
- Do not connect Battery wire (yellow) and Ignition wire (red) to the car chassis or Ground wire (black) to prevent a short circuit.
- Insulate unconnected wires with vinyl tape to prevent a short circuit.
- Be sure to ground this unit to the car's chassis again after installation.

▲ Caution

- For safety's sake, leave wiring and mounting to professionals. Consult the car audio dealer.
- Install this unit in the console of your vehicle. Do not touch the metal parts of this unit during and shortly after use of the unit. Metal parts such as the heat sink and enclosure become hot.
- Do not connect the \ominus wires of speakers to the car chassis or Ground wire (black), or connect them in parallel.
- Connect speakers with a maximum power of more than 50 W. If the maximum power of the speakers is lower than 50 W, change the [AMP GAIN] setting to avoid damaging the speakers. (→ 15)
- Mount the unit at an angle of less than 30°.
- If your vehicle wiring harness does not have the ignition terminal, connect Ignition wire (red) to the terminal on the vehicle's fuse box which provides 12 V DC power supply and is turned on and off by the ignition key.
- Keep all cables away from heat dissipate metal parts.
- After the unit is installed, check whether the brake lamps, blinkers, wipers, etc. on the car are working properly.
- If the fuse blows, first make sure the wires are not touching car's chassis, then replace the old fuse with one that has the same rating.

Basic procedure

- 1 Remove the key from the ignition switch, then disconnect the \ominus terminal of the car battery.**
- 2 Connect the wires properly.**
See Wiring connection. (→ 23)
- 3 Install the unit to your car.**
See Installing the unit (in-dash mounting).
- 4 Connect the \ominus terminal of the car battery.**
- 5 Reset the unit. (→ 3)**

Installing the unit (in-dash mounting)

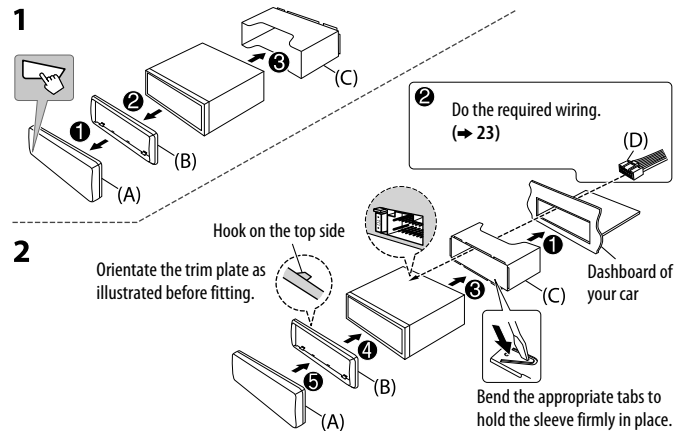

When installing without the mounting sleeve

- ▲ Use only the specified screws. Using wrong screws might damage the unit.

Flat or round head screws (not supplied)
M5 × 8 mm (M5 × 3/8")

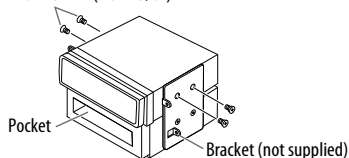
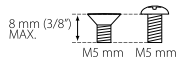

How to remove the unit

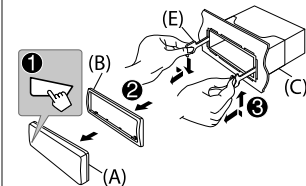

Wiring connection

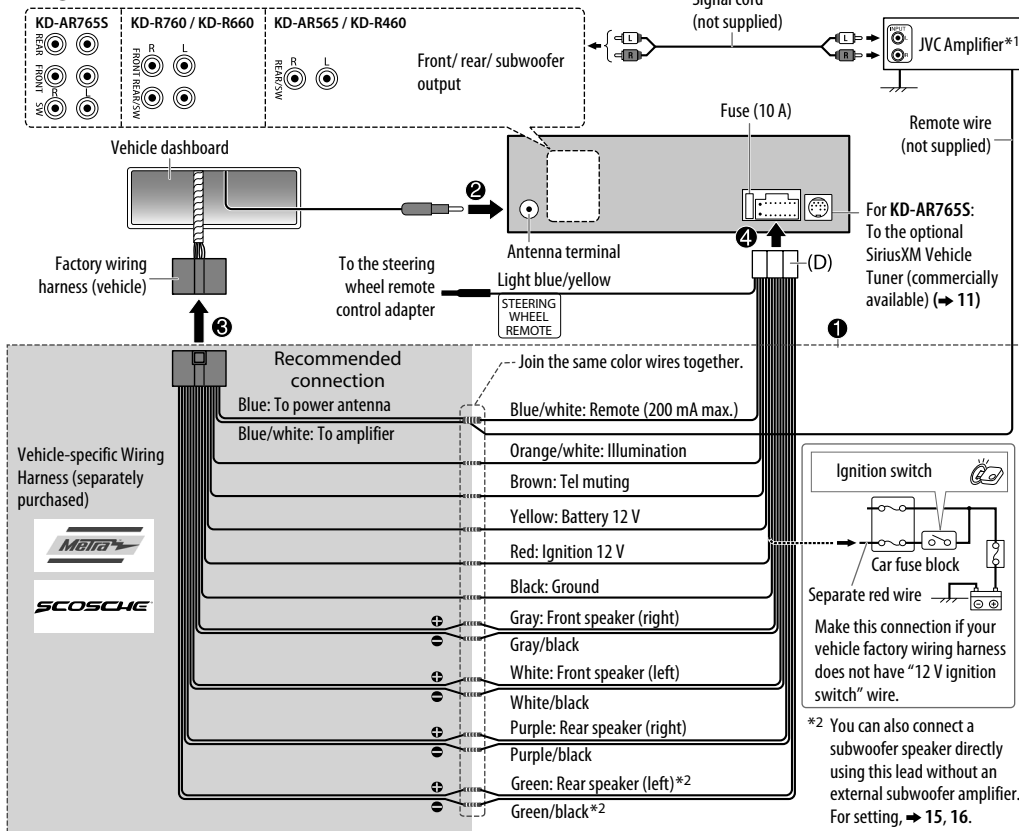

*1 Firmly connect the ground wire of the amplifier to the car's chassis to avoid damaging the unit.

Part list for installation

(A) Faceplate

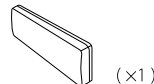

(B) Trim plate

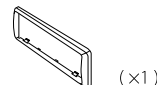

(C) Mounting sleeve

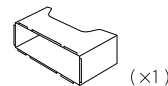

(D) Wiring harness

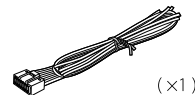

(E) Extraction key



SPECIFICATIONS

Subject to change without notice.

Tuner	FM	Frequency Range	87.9 MHz — 107.9 MHz (200 kHz step) 87.5 MHz — 108.0 MHz (50 kHz step)
		Channel Space Selection	50 kHz/200 kHz
		Usable Sensitivity (S/N = 26 dB)	8.2 dBf (0.71 μ V/75 Ω)
	AM	Quieting Sensitivity (DIN S/N = 46 dB)	17.2 dBf (2.0 μ V/75 Ω)
		Frequency Response (\pm 3 dB)	30 Hz — 15 kHz
		Signal-to-Noise Ratio (MONO)	64 dB
		Stereo Separation (1 kHz)	40 dB
		Frequency Range	530 kHz — 1 700 kHz (10 kHz step) 531 kHz — 1 611 kHz (9 kHz step)
		Channel Space Selection	9 kHz/10 kHz
		Usable Sensitivity (S/N = 20 dB)	29 dB μ (28.2 μ V)

CD player	Laser Diode	GaAIAs
	Digital Filter (D/A)	8 times over sampling
	Spindle Speed	500 rpm — 200 rpm (CLV)
	Wow & Flutter	Below measurable limit
	Frequency Response (\pm 1 dB)	20 Hz — 20 kHz
	Total Harmonic Distortion (1 kHz)	0.01 %
	Signal-to-Noise Ratio (1 kHz)	105 dB
	Dynamic Range	90 dB
	Channel Separation	85 dB
	MP3 Decode	Compliant with MPEG-1/2 Audio Layer-3
WMA Decode	Compliant with Windows Media Audio	

USB	USB Standard	USB 1.1, USB 2.0 (Full speed)
	Compatible Devices	Mass storage class
	File System	FAT12/ 16/ 32
	Maximum Supply Current	DC 5 V --- 1 A
	MP3 Decode	Compliant with MPEG-1/2 Audio Layer-3
	WMA Decode	Compliant with Windows Media Audio
WAV Decode	Linear-PCM	
Auxiliary	Frequency Response (\pm 3 dB)	20 Hz — 20 kHz
	Input Maximum Voltage	1 000 mV
	Input Impedance	30 k Ω
Audio	Maximum Output Power	50 W \times 4 or 50 W \times 2 + 50 W \times 1 (Subwoofer = 4 Ω)
	Full Bandwidth Power (at less than 1 % THD)	22 W \times 4
	Speaker Impedance	4 Ω — 8 Ω
	Preout Level/Load (CD/USB)	2 500 mV/10 k Ω
	Preout Impedance	\leq 600 Ω
	General	Operating Voltage (10.5 V — 16 V allowable)
Maximum Current Consumption		10 A
Operating Temperature Range		0°C to +40°C
Installation Size (W \times H \times D)		182 mm \times 53 mm \times 158 mm (7-3/16" \times 2-1/8" \times 6-1/4")
Weight		1.2 kg (2.65 lbs)

- Microsoft and Windows Media are either registered trademarks or trademarks of Microsoft Corporation in the United States and/or other countries.
- “Made for iPod,” and “Made for iPhone” mean that an electronic accessory has been designed to connect specifically to iPod, or iPhone, respectively, and has been certified by the developer to meet Apple performance standards. Apple is not responsible for the operation of this device or its compliance with safety and regulatory standards. Please note that the use of this accessory with iPod or iPhone may affect wireless performance.
- iPhone, iPod, iPod classic, iPod nano, and iPod touch are trademarks of Apple Inc., registered in the U.S. and other countries.
- Lightning is a trademark of Apple Inc.
- Pandora, the Pandora logo, and the Pandora trade dress are trademarks or registered trademarks of Pandora Media, Inc., used with permission.
- iHeartRadio® is a registered mark of Clear Channel Broadcasting, Inc. in the United States and other countries. Such marks are used under license.
- Sirius, XM and all related marks and logos are trademarks of Sirius XM Radio Inc. All rights reserved.
- Android is trademark of Google Inc.