



05-10 Toyota Tacoma Reg., Access, Double Cab

51-712, 51-714, 51-716

TUBE STEP INSTALLATION SHEET

- STEP 1** REMOVE ALL CONTENTS FROM THE BRACKET BOX AND CHECK FOR CORRECT QUANTITY AND ANY DAMAGED PARTS
- STEP 2** REMOVE FACTORY PLASTIC SCREW PLUGS FROM BOTTOM ROCKER PANEL AND THE RUBBER PLUG FROM THE FACTORY BODY HOLE. INSERT FRAME LOCKER INTO FACTORY BODY HOLE AS DESCRIBED IN FIG. 1 AND FIG. 2.
- STEP 3** INSTALL FRONT AND REAR BRACKETS USING HARDWARE DESCRIBED. HAND TIGHTEN ALLOWING FOR FINAL ADJUSTMENTS.
- STEP 4** BOLT THE TUBE TO THE BRACKETS USING HARDWARE DESCRIBED. HAND TIGHTEN THE BOLTS. ALIGN THE TUBE WITH THE TRUCK AND TIGHTEN THE TUBE STEP BOLTS FIRST TO 65 FT./LBS. THEN TIGHTEN THE BRACKET BOLTS TO 35 FT./LBS.
- STEP 5** REPEAT STEPS 2 THROUGH 6 FOR INSTALLATION OF PASSENGER SIDE

QTY.	PARTS LIST	QTY.	PARTS LIST
2	714 FRONT BRACKETS	8	8 MM LOCK WASHERS
2	714 REAR BRACKETS	4	½" – 13 X 1-3/4" HEX BOLT
8	8 MM – 1.25 X 25 8.8 HEX BOLTS	4	½ FLAT WASHERS
8	8 MM FLAT WASHERS	4	½" LOCK WASHERS
2	TUBE STEPS	2	FRAME LOCKER BOLT

MAINTENANCE AND CARE

Only use mild soap for regular cleaning. For heavy build up, a solution of ammonia and water can be used. Never use an abrasive material, i.e. steel wool, for cleaning purposes. Use terry cloth towels wiping in the direction of the tube at all times.

RV05.18.07

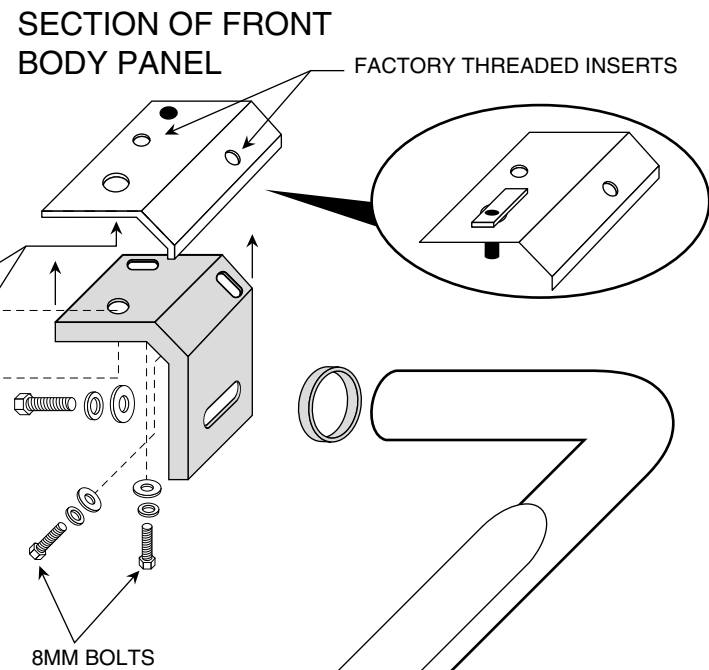
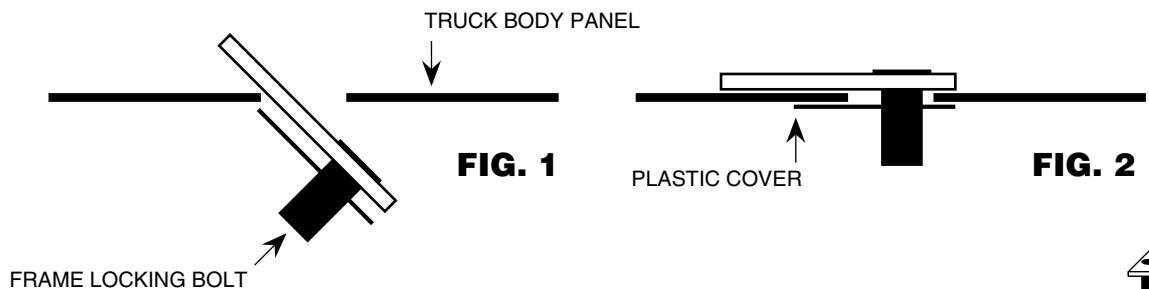

05-07 Toyota Tacoma Reg, Access, & Double Cab

