



04-08 Nissan Titan King Cab and Crew Cab

51-910,912

TUBE STEP INSTALLATION SHEET

- STEP 1** REMOVE ALL CONTENTS FROM THE BRACKET BOX AND CHECK FOR CORRECT QUANTITY AND ANY DAMAGED PARTS
- STEP 2** REMOVE FRONT AND REAR BODY MOUNT BOLTS. REPLACE BOLT WITH BRACKET. HAND TIGHTEN AT THIS TIME TO ALLOW FOR FINAL ADJUSTMENTS.
- STEP 3** TAKE ONE TUBE AND BOLT IT TO THE FRONT BRACKET FIRST, USING THE ½" BOLTS, LOCKWASHERS, AND FLATWASHERS SUPPLIED. MAKE SURE TO USE THE PLASTIC O-RING SUPPLIED ON THE TUBE ENDS. HAND TIGHTEN THE BOLTS MAKING SURE TO LEAVE THEM LOOSE ENOUGH FOR FINAL ADJUSTMENTS.
- STEP 4** ALIGN THE TUBE WITH THE TRUCK AND TIGHTEN THE TUBE STEP BOLTS FIRST TO 65 FT./LBS. THEN TIGHTEN THE BRACKET BOLTS TO 65 FT./LBS.
- STEP 5** BOLT STUPPORT STRAPS TO THE BRACKET WITH THE SUPPLIED 5/16" BOLTS, LOCKEWASHERS, AND FLATWASHERS. ALIGN STRAP TO THE INSIDE OF THE BODY MOUNT AND USE THE SELF TAPPING SCREW TO ATTACH TO THE FRAME. TIGHTEN THE 5/16" BOLT TO 35 FT/LBS.
- STEP 6** REPEAT STEPS 2 THROUGH 5 FOR INSTALLATION OF PASSENGER SIDE

554 BOLT KIT

2	1512 Front Bracket	4	1/2" Lock Washer
2	1512 Rear Bracket	4	1/2" Flat Washer
4	1/2" - 13 x 1 - 3/4" Hex Bolt	2	5/16" - 18 x 1" Hex Bolt
2	1/4" - 14 x 1" Self Tapping Screw	2	5/16" Hex Nut
2	5/16" Flat Washer	2	5/16" Lock Washer
2	6 1/2" Straps	2	Tube Steps

MAINTENANCE AND CARE

Only use mild soap for regular cleaning. For heavy build up, a solution of ammonia and water can be used. Never use and abrasive material, i.e. steel wool, for cleaning purposes. Use terry cloth towels wiping in the direction of the tube at all times.

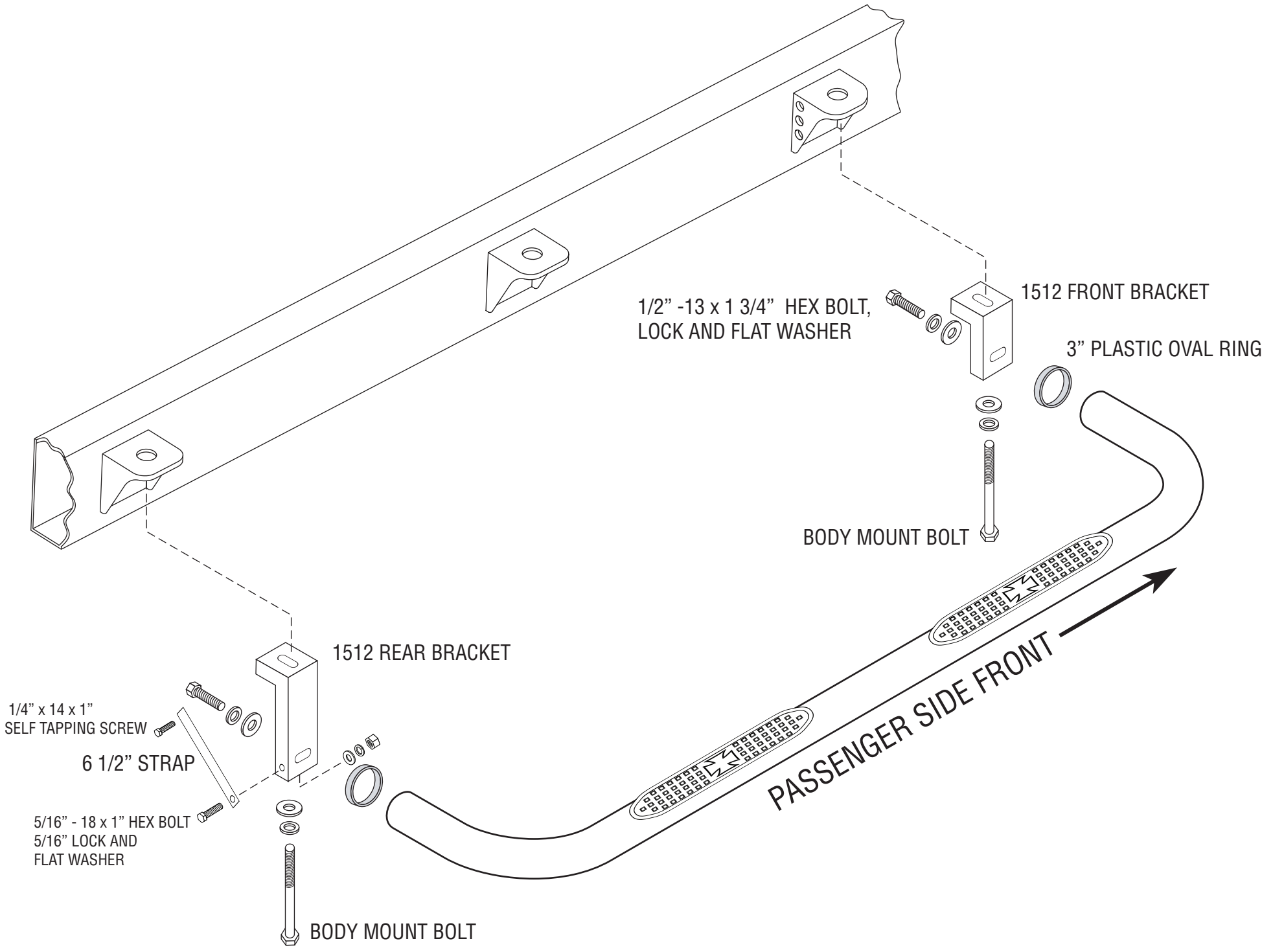

1/2" -13 x 1 3/4" HEX BOLT,
LOCK AND FLAT WASHER

1512 FRONT BRACKET

3" PLASTIC OVAL RING

BODY MOUNT BOLT

1512 REAR BRACKET

1/4" x 14 x 1"
SELF TAPPING SCREW

6 1/2" STRAP

5/16" - 18 x 1" HEX BOLT
5/16" LOCK AND
FLAT WASHER

BODY MOUNT BOLT

PASSENGER SIDE FRONT