



# 88-98 GM C/K Regular & Extended Cab

51-500,502,504,506,508 41-500,502,504,506

## TUBE STEP INSTALLATION SHEET



FIG 1



FIG 2



FIG 3

**STEP 1** Remove front and rear body mount bolts. Replace with M12 & 4-3/4" bolt, lock washer, & flat washer supplied in the bracket kit. Adding the front and rear bracket under the lower body bushing and tighten these bolts to allow for minor adjustments. (Fig 1-3)

**STEP 2** Take one tube and bolt it to the front bracket using 1/2" bolts, lock washers, & flat washers supplied. Make sure to use the plastic O-ring supplied on the tube ends. Hand tighten the bolts making sure to leave them loose enough for final adjustments. Align the tube to your liking on the truck. Tighten the body mount bolts to 65 ft lbs first. Then tighten the tube step bolts to 65 ft lbs.

Repeat the steps for the other side of the vehicle.

**STEP 3**

QTY	PART S LIST	QTY	PARTS LIST
2	1500 Front Bracket	4	1/2" - 13 x 1-3/4" Hex Bolt
2	1500 Rear Bracket	8	1/2" Flat Washer
4	M12-1.75x120MM (4 -3/4") Bolt	8	1/2" Lock Washer

### MAINTENANCE AND CARE

Only use mild soap for regular cleaning. For heavy build up, a solution of ammonia and water can be used. Never use an abrasive material, i.e. steel wool, for cleaning purposes. Use terry cloth towels wiping in the direction of the tube at all times.

**FRONT Bracket**    **REAR Bracket**

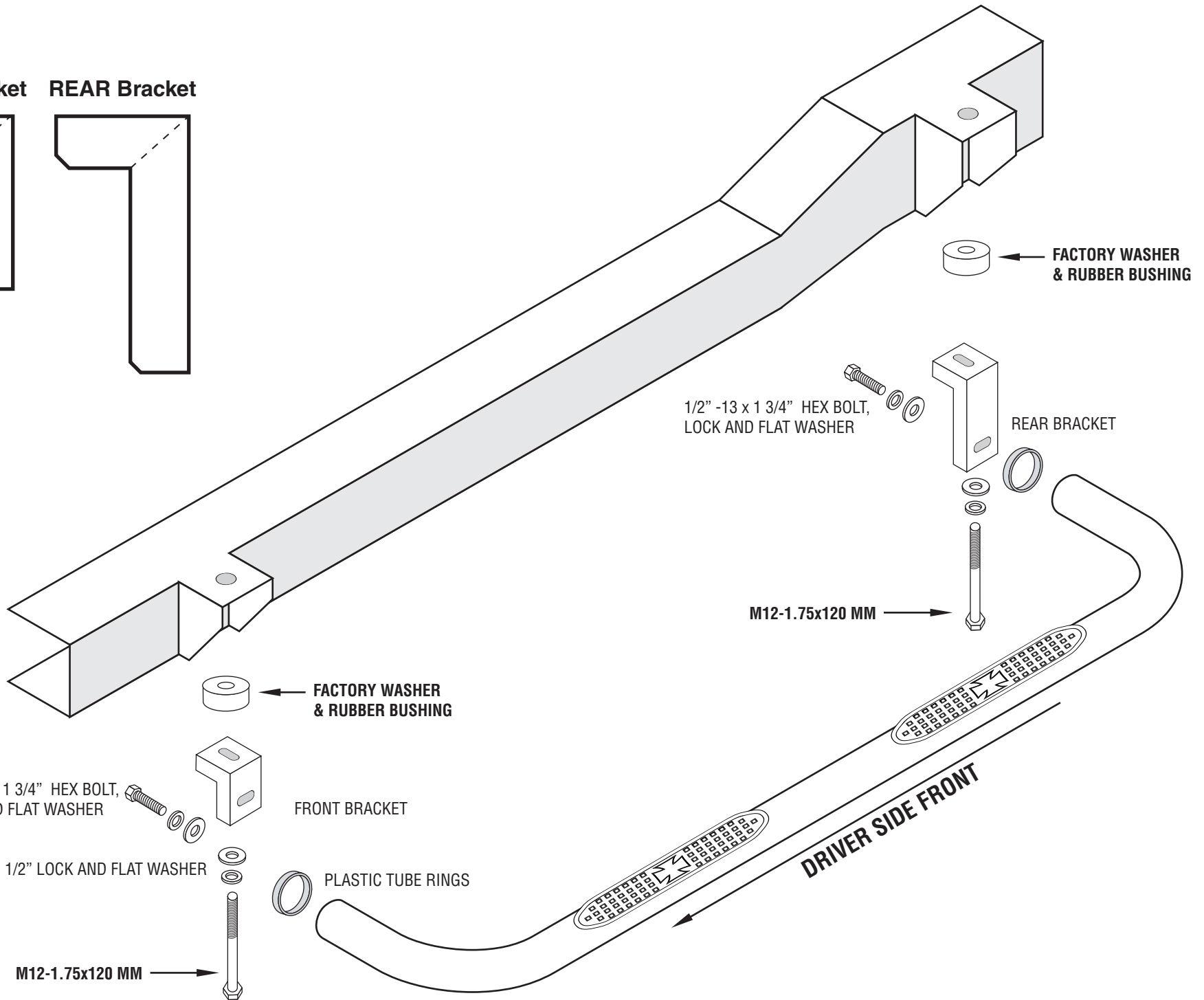
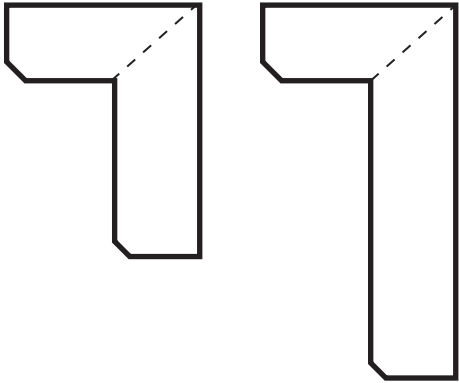

**FACTORY WASHER & RUBBER BUSHING**

**1/2" -13 x 1 3/4" HEX BOLT, LOCK AND FLAT WASHER**

**REAR BRACKET**

**M12-1.75x120 MM**

**FACTORY WASHER & RUBBER BUSHING**

**1/2" -13 x 1 3/4" HEX BOLT, LOCK AND FLAT WASHER**

**FRONT BRACKET**

**1/2" LOCK AND FLAT WASHER**

**PLASTIC TUBE RINGS**

**M12-1.75x120 MM**

**DRIVER SIDE FRONT**