

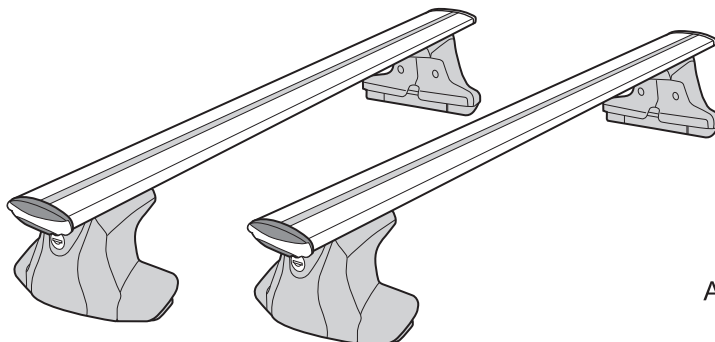

XS250

Installation Instructions

XS250



Aero Base Bar (Sold separately)

- Read the INNO common instruction manual (the accompanying sheet) as well.
- Keep this instruction manual in a safe place.
- Maximum load capacity: 75kg/165lbs. However, it varies depending on the car model.
- The maximum load capacity is 5 bicycles. However, it varies depending on the car model. (Drive the car at 50 mph/80km/h or less when 5 bicycles are loaded.)
- Drive the car at 50 mph/80km/h or less when the attachment is installed outside the stay.
- Stay may shift depending on driving conditions such as rough roads. Should the stay shift, loosen the mounting hook, return the hook to the original installation position as stated in the mounting hook installation instructions and remount.

Product contents

① **x4**

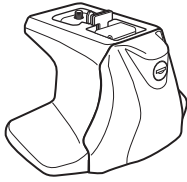

② **x2**

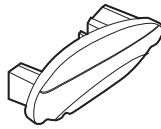

③ **x2**

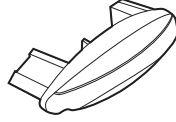

④ **x4**

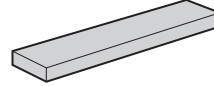

⑤ **x4**

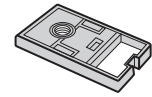

⑥ **x1**

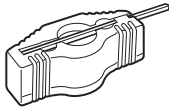

⑦ **x4**



⑧ **x4**



⑨ **x4**



⑩ **x1**



⑪ **x1**

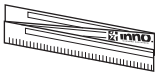

⑫ **x1**



⑬ **x2**

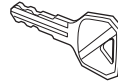

⑭ **x1**

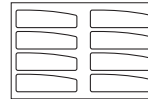

⑮ **x1**



⑯ **x1**



⑰ **x4**

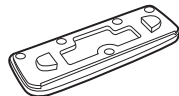

⑱ **x4**

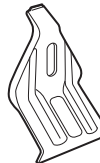

⑲ **x1**



No.	EN : Parts	
①	Aero Base Stay	
②	End Garnish L	
③	End Garnish R	
④	Inner Block	
⑤	Inner plate	
⑥	Torque knob	
⑦	Flange washer	
⑧	Nylon washer	
⑨	Bolt	
⑩	Wrench	
⑪	Measuring Tape	
⑫	Bar sticker	
⑬	Key	
⑭	Specification sticker	
⑮	INNO Common Installation Instructions	
⑯	XS250 Installation instructions	
⑰	Base	Fit Hooks (Sold separately)
⑱	Hook	
⑲	Mounting hook installation instructions	

Additional Tool Required



Scissors

Mounting hook installation instructions (included with mounting hook) are also required.

There are two aero base bars, one for front and another for rear.
Reference the mounting hook installation instructions to find the length of (A) to determine the front and rear bar.

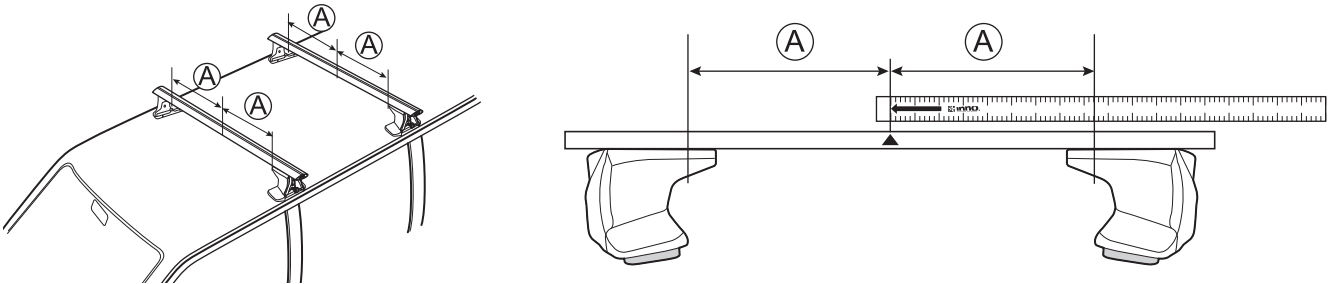

Affix the ▲ bar sticker (▲F for front, ▲R for rear) on the bottom face of the aero base bars (bars sold separately).

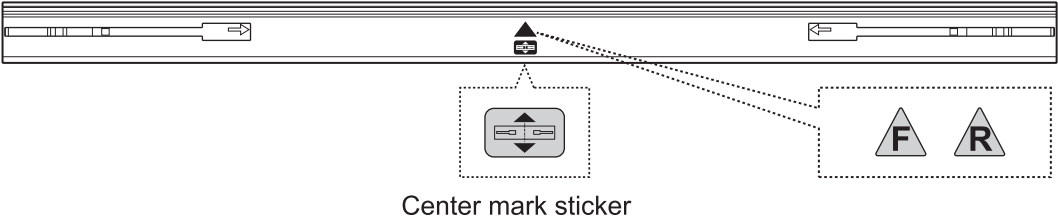

2

Push the slider out of the bar.

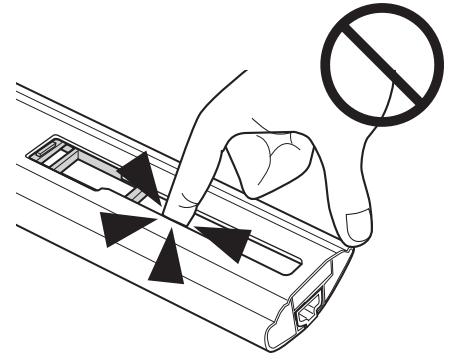
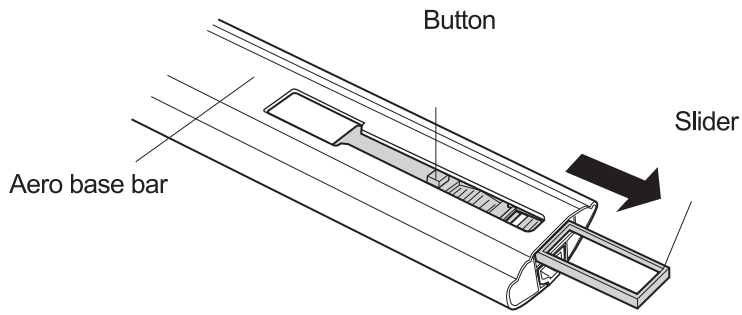

3

Turn the bar upside down, ① insert inner plate, and ② push slider back into the bar.

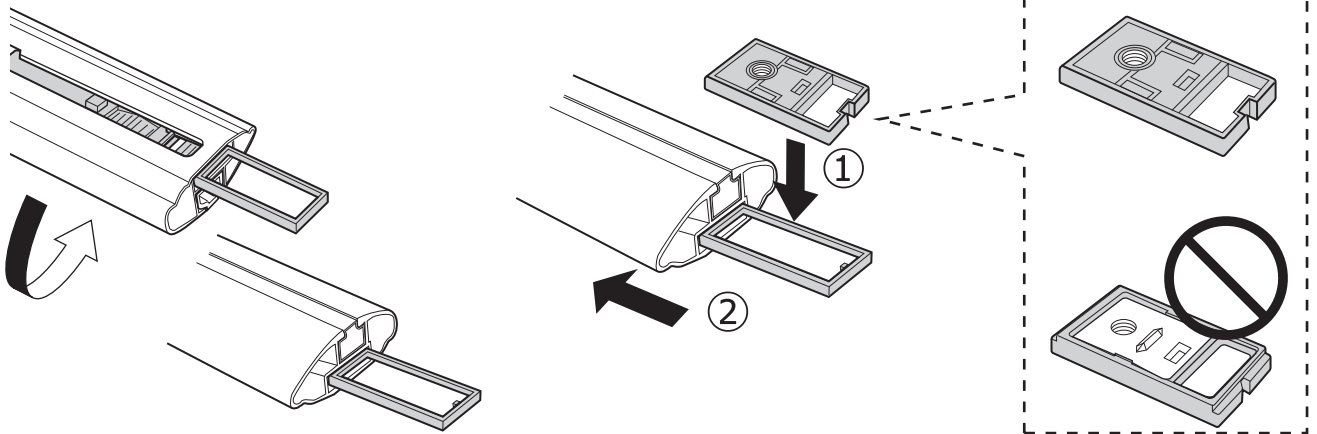

4

① While pressing button, ② push slider further inside.

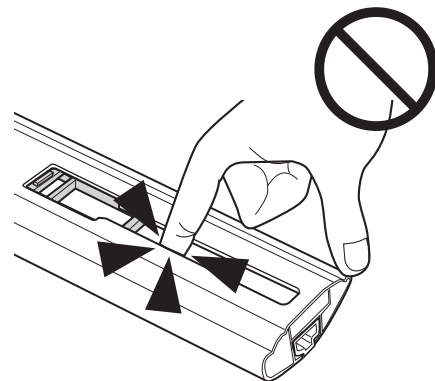
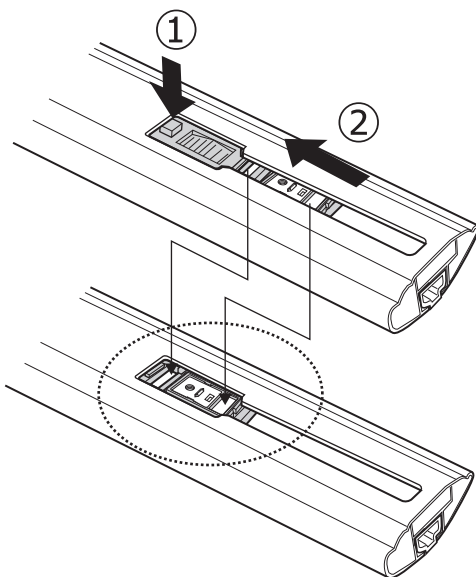

5

Affix the specification sticker in the relevant language on the stay. (on one of any stay)

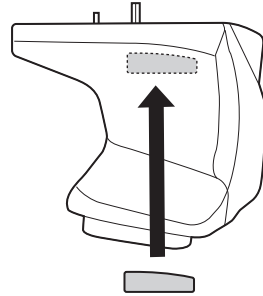

6

Unlock and remove the cover.

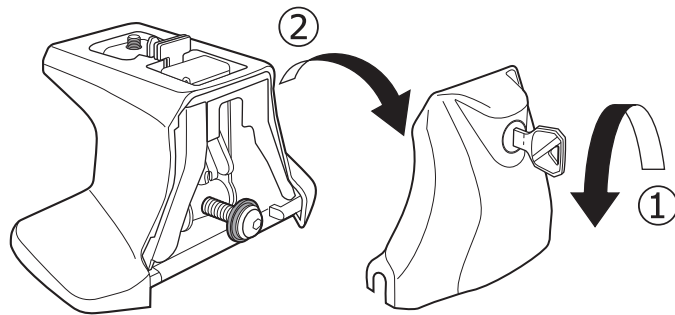

7

Remove ① bolt, ② nylon washer (white), and ③ flange washer (black).

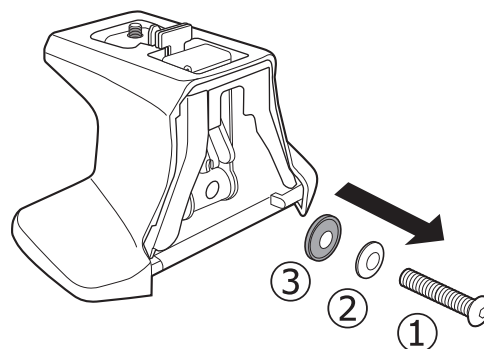

8

Insert the aero base stay into the inner plate, and slide it to the outside.

(Stay does not have a L or R.)

- ① Push in the drum nut.
- ② While the drum nut is pushed in, insert the aero base stay into the inner plate.
- ③ Slide it to the bar outer side.

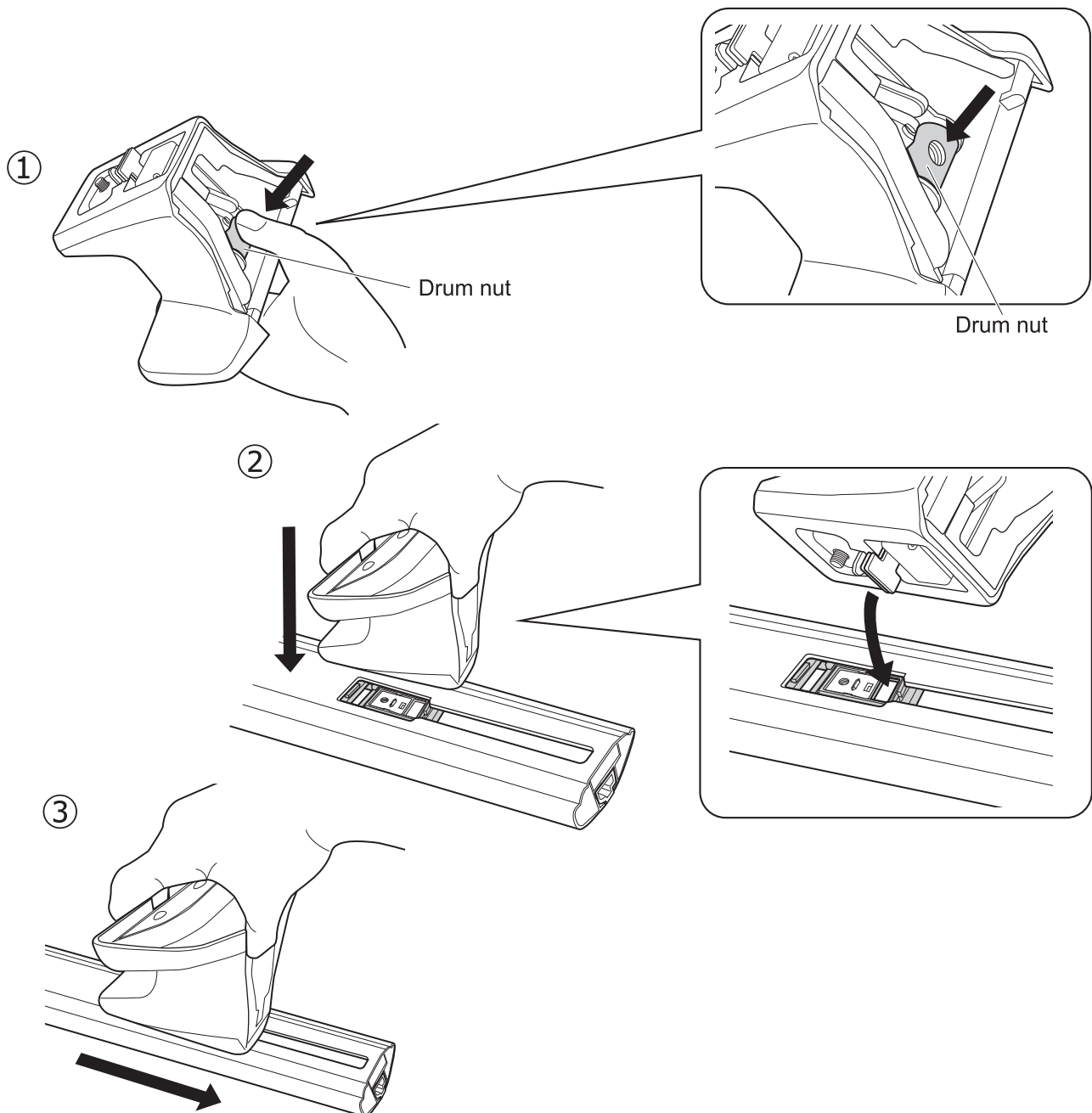

9

In order to evenly position and center the bar between the stays, align the measuring tape and the bar, then set the stay position in accordance with dimension (A) as described in the mounting hook installation instructions.

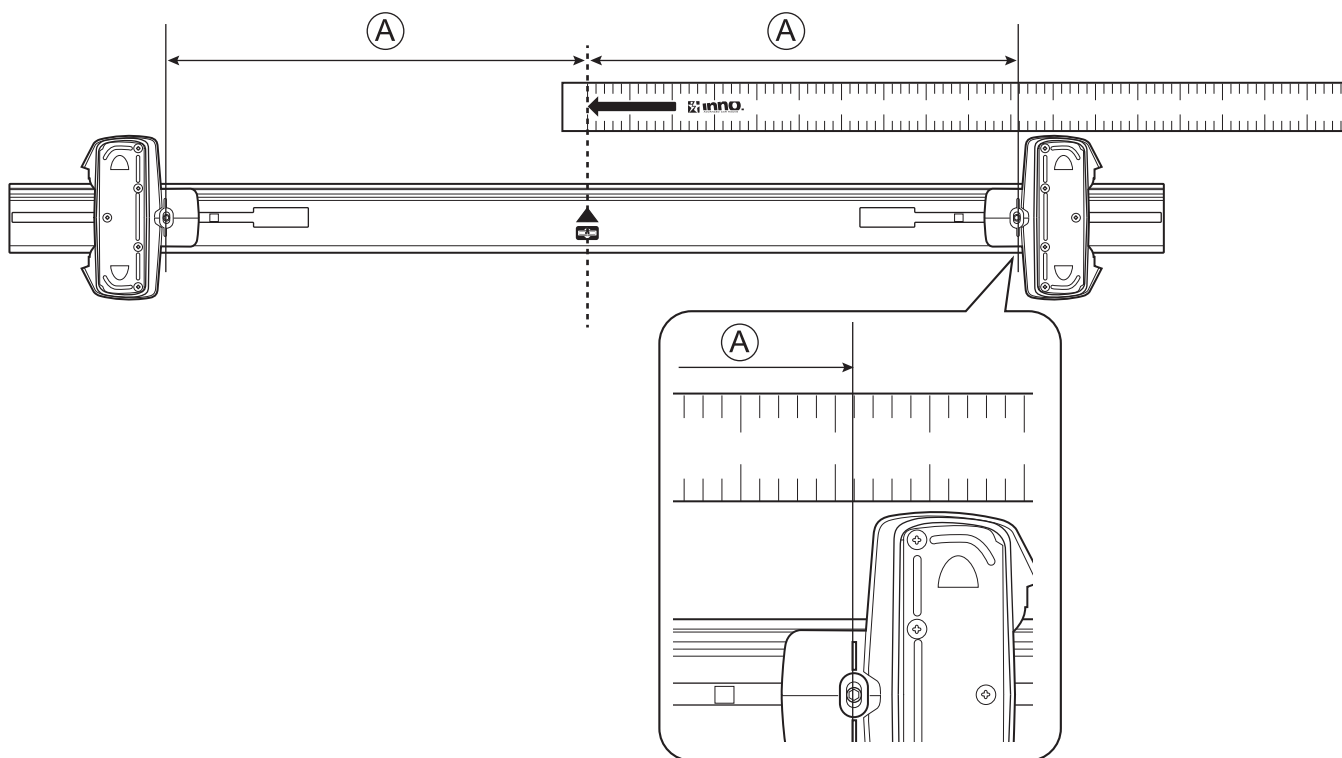

- ① Push in the drum nut.
- ② While the drum nut is pushed in, slide the aero base stay to align.
- ③ Release the drum nut, and temporarily set the stay position.

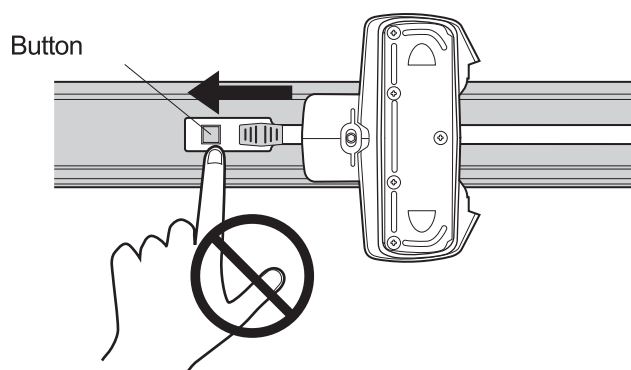
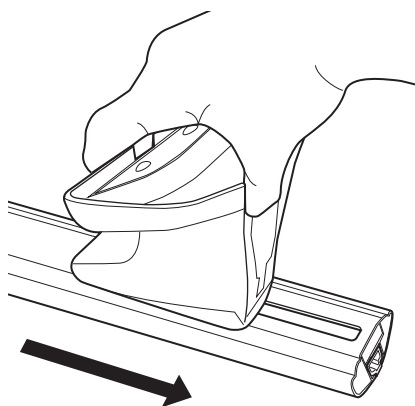

Adjust it in the movable range without pushing the button.

When not using the included measuring tape.
In order to evenly position and center the bar between the stays, align the stay position with dimension \textcircled{A} in the stay as described in the mounting hook installation instructions.

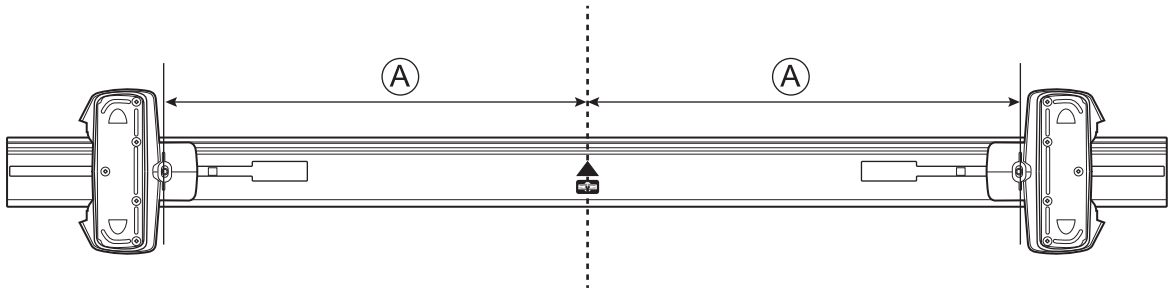

Securely tighten the stay bolt using the wrench included in the package.

Hold the longer section.

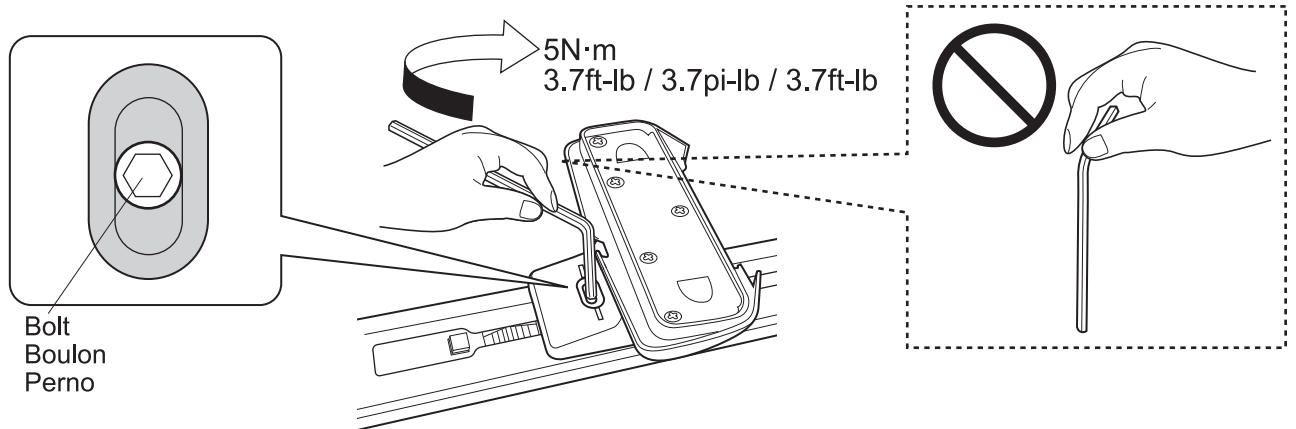

Warning

This is an important bolt for safety. Hold the longer section of the Hex wrench, and firmly tighten the bolt to prevent looseness.

This bolt is for securing the stay to the bar.

There is no problem when the aero base stay rotates back and forth around the bolt.

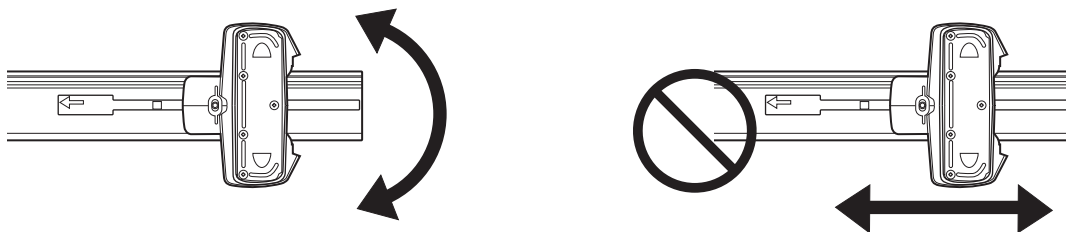

11

Use a measuring tape to reconfirm that the stay position is aligned with dimension **A** as described in the mounting hook installation instructions. If the stay position is not in accordance, redo from Procedure **9** .

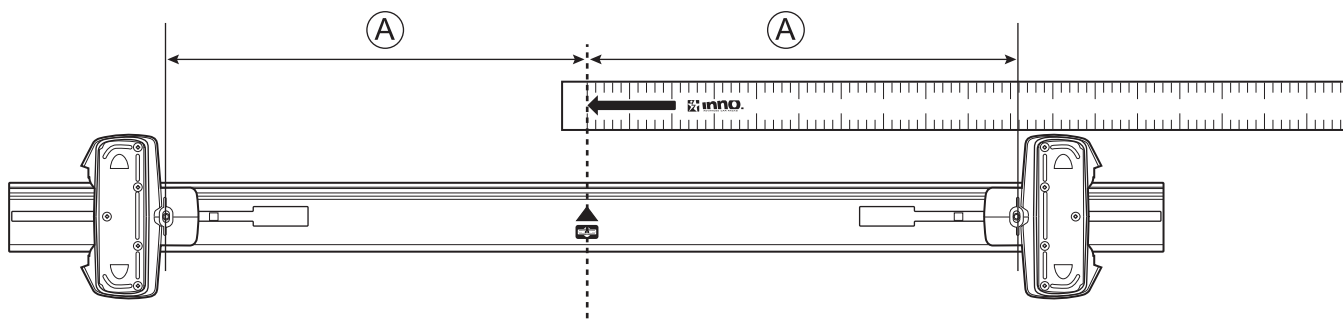

When not using the included measuring tape.

Reconfirm that the stay position is aligned with dimension **A** as described in the mounting hook installation instructions. If the stay position is not in accordance, redo from Procedure **9** .

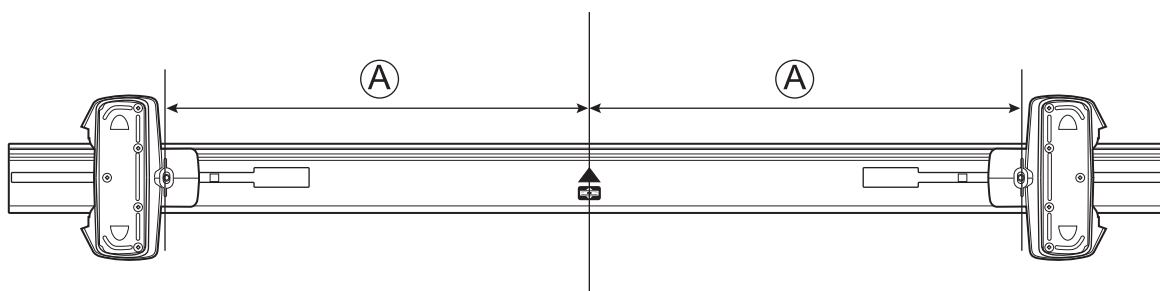

12

Write down the part numbers of the hooks and bases (found in the SU mounting hook installation instructions) in the spaces provided below.

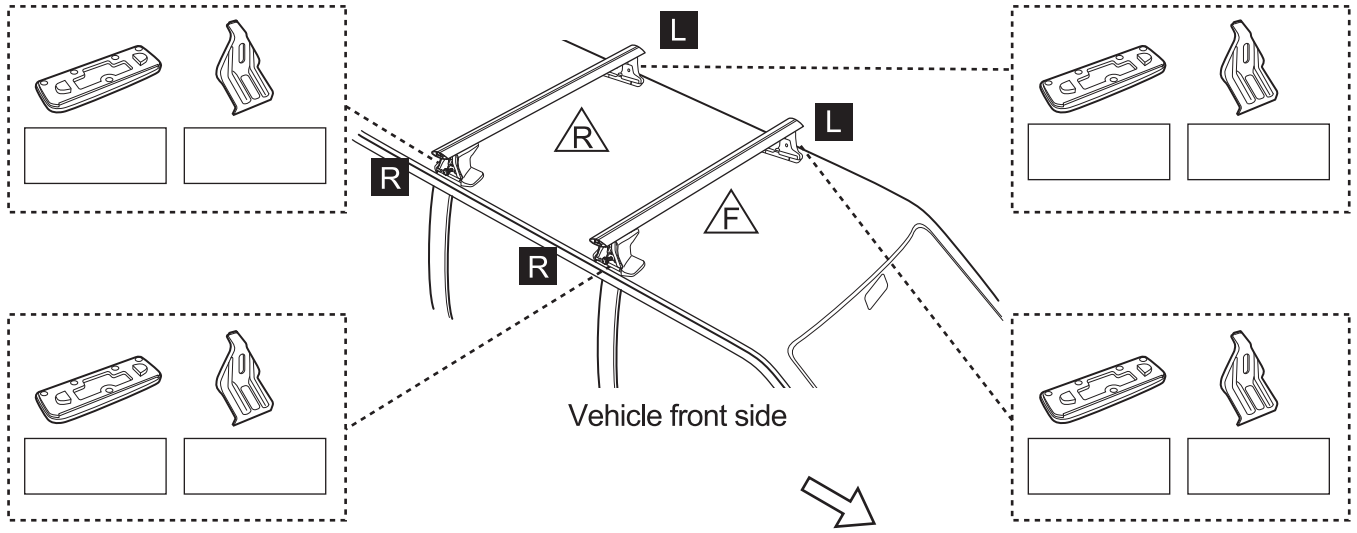

13

Mount the base to the stay in accordance with the combination written in Procedure 12 .

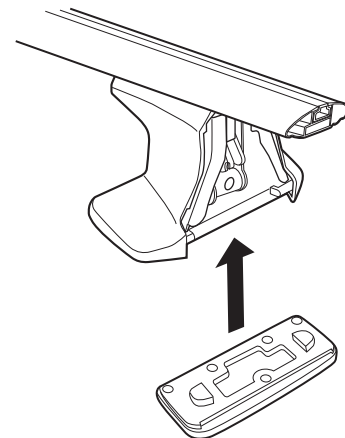

14

Place the carrier on the vehicle in accordance with the combination written in Procedure 12 . Follow the SU mounting hook installation instructions for mounting dimension, hook mounting position, and base mounting position.

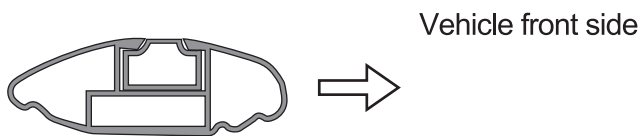

Check the bar direction, and place the aero base stay on the vehicle

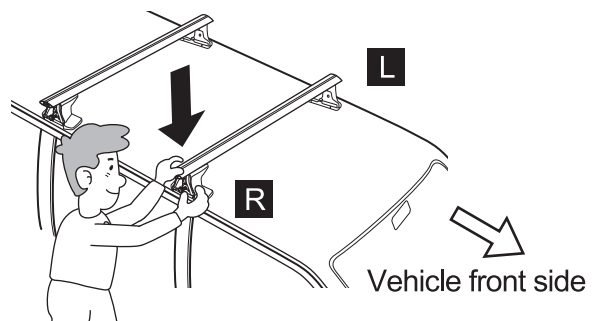

15

Insert the inner block into the inner bar end completely and cut the protruding portion.

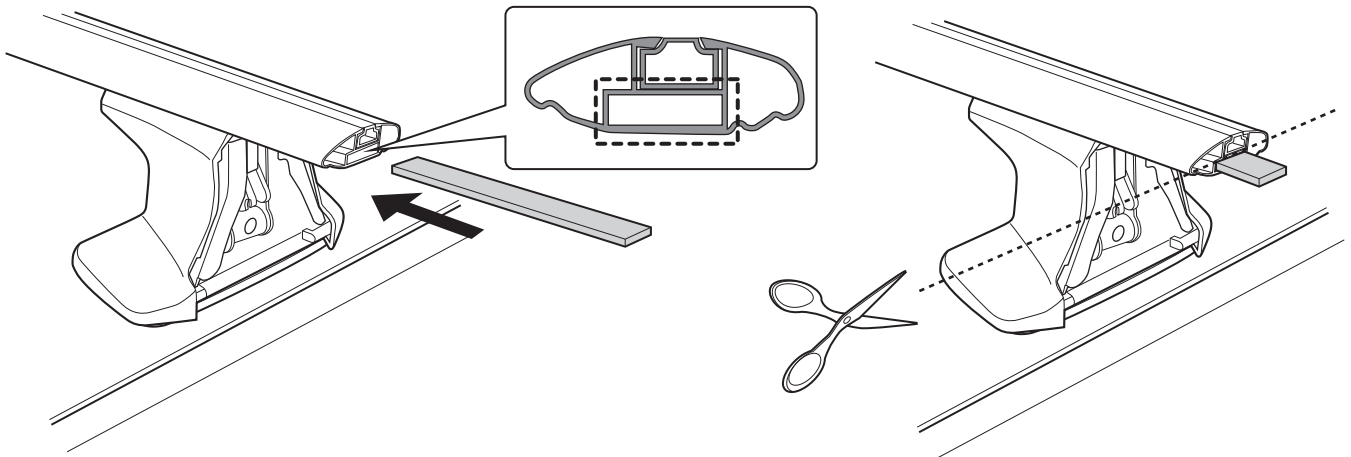

16

Attach the end garnish to the bar. (Confirm L and R of the end garnish before attaching.)

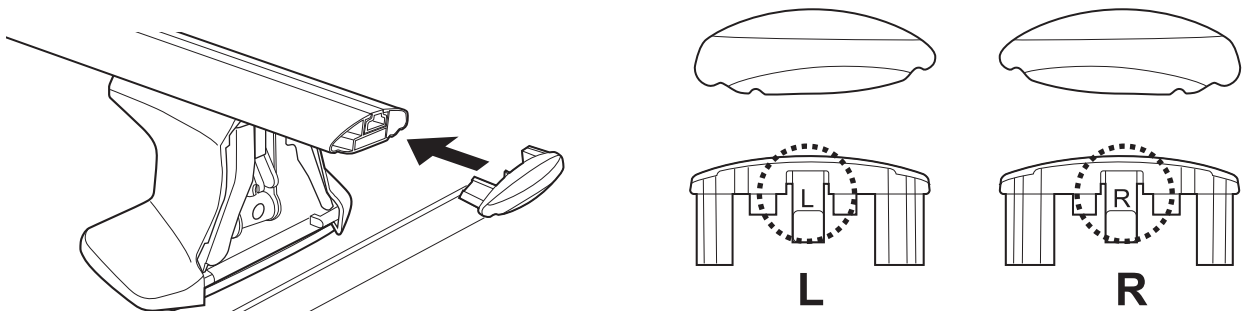

17

As the stay swings against the bar by $\pm 5^\circ$, adjust it in accordance with the vehicle.

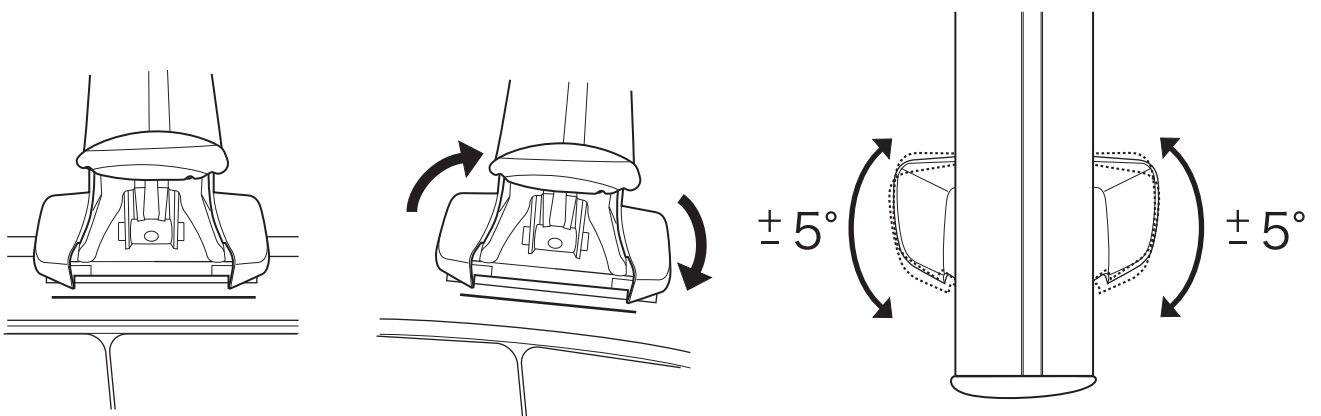

18

Assemble the included torque knob.

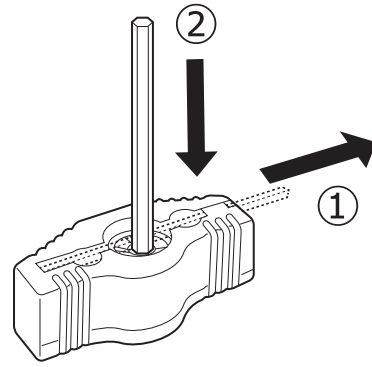

19

In accordance with the base and hook combination written in Procedure **12**, loosely assemble ① hook, ② flange washer (black), ③ nylon washer (white), and ④ bolt in the order shown below. (about 2 rotations)

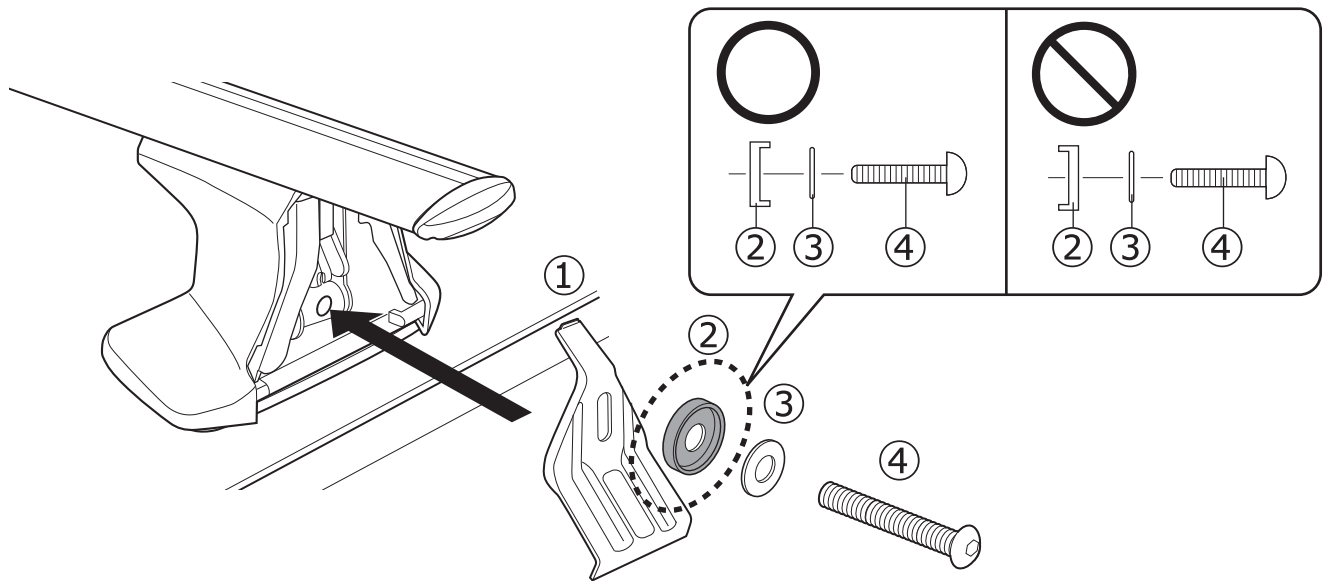

20

Evenly tighten bolts left and right alternatively until the included torque knob rotates freely. For mounting conditions, follow the SU mounting hook installation instructions.

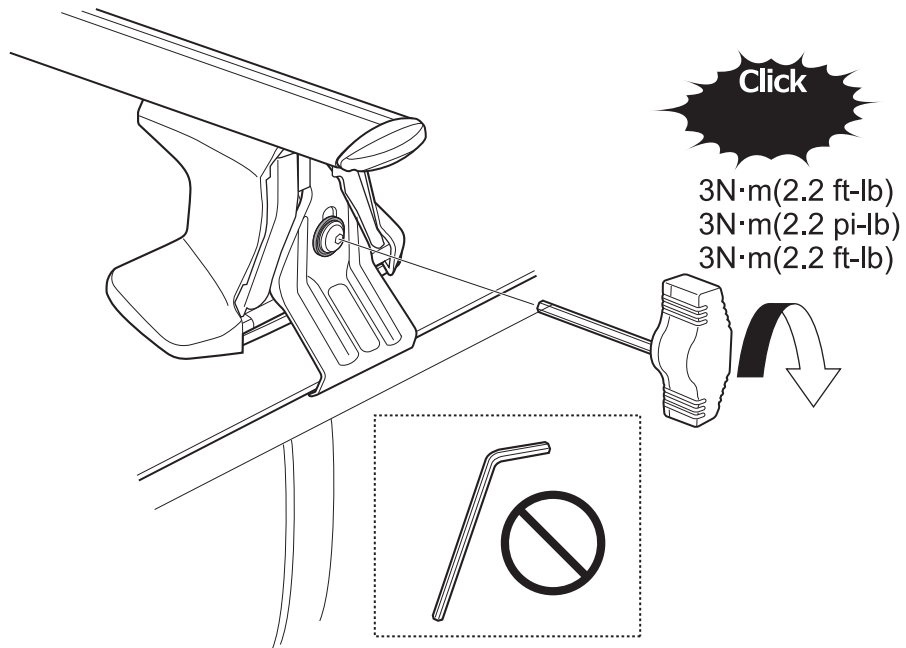

21

① Attach the cover to the stay. ② Close the cover. ③ Lock cover with key.

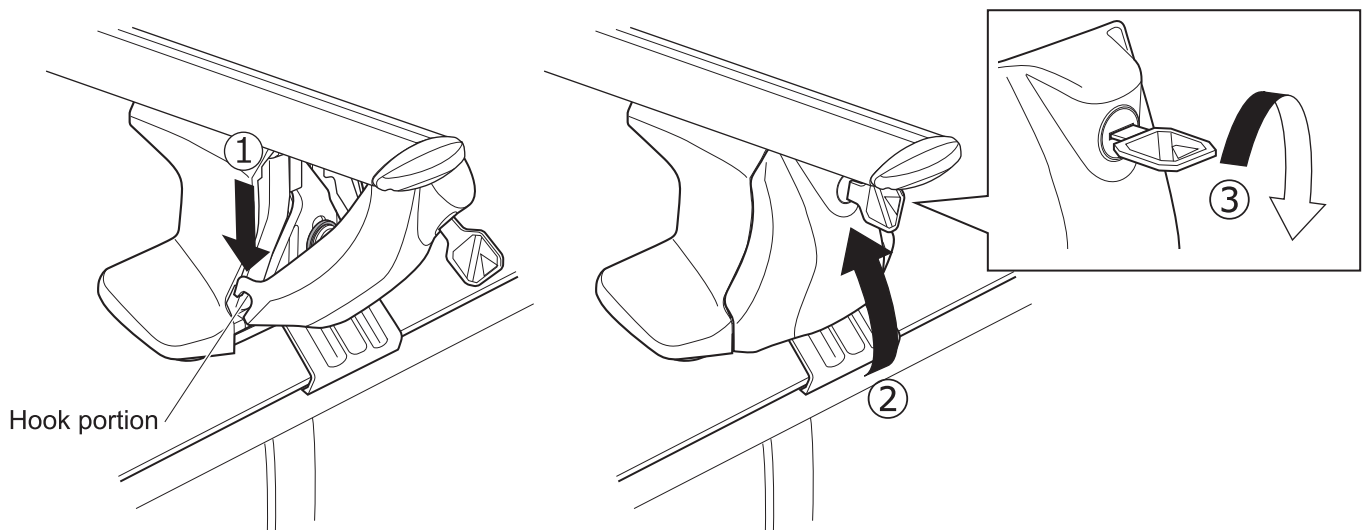

22

Shake the carrier to the front, rear, left, right, upward and downward. If loose, tighten the bolt until the included torque knob rotates freely. 3N·m(2.2 ft-lb)

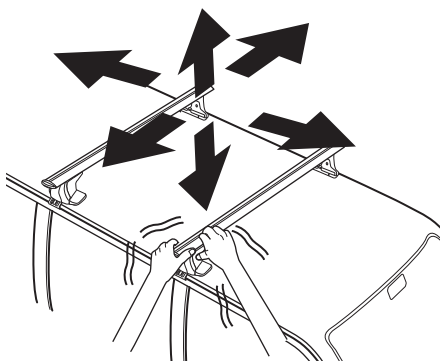

Repair parts

Please specify part name when ordering repair parts.

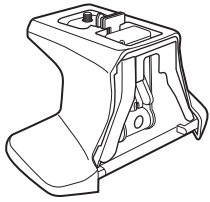

x1

ISP 891
Stay main unit



x1

ISP 892
(Key number is not changeable)

Cover

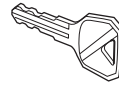

x2

Key

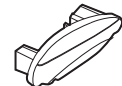

Lx2

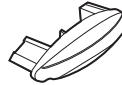

Rx2

ISP 883
End Garnish



x1

ISP 864
Hex Wrench

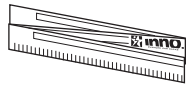

x1

ISP 888
XS250 Measuring Tape

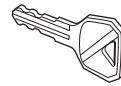

x1

Key



x1

XS250 Installation Instructions

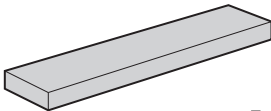

x4

ISP 884
Inner Block

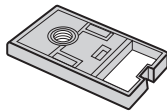

x1

ISP 893
Inner plate

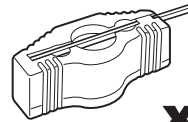

x1

ISP 863
Torque knob



x1

Bar sticker



x4

ISP 96