

Thank you for purchasing this INNO product.  
 -Read these instructions carefully before using this product.  
 -Do not discard these instructions.

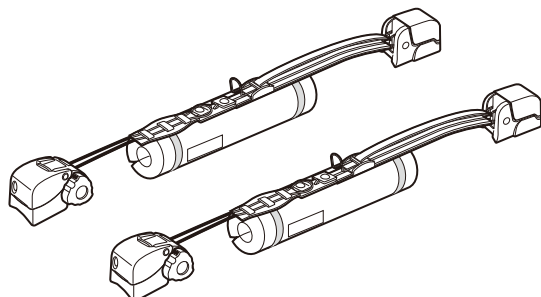

**⚠ WARNING** Falling carrier parts or loads may cause potentially serious accidents involving vehicles and individuals following behind may result in severe injury or death.

- Confirm the stability and strength of the carrier base onto which this product is to be installed, and attach it securely.
- Maintain a distance of 24" (60 cm) or more between the front and rear carriers / crossbars.
- Assure that neither knobs nor wires are loose before driving.
- Do not alter this product.
- Do not carry items other than SUP, canoes, kayaks, surfboards, and sailboards with this product.
- Exercise due care when driving while using this carrier.
- Lock securely while driving.

**⚠ CAUTION** May cause injury to individuals or damage to the product, vehicle and loads being carried.

-This product is not theft-proof. Therefore, do not leave equipment on this product unattended for long time.

## 1 Content of Parts

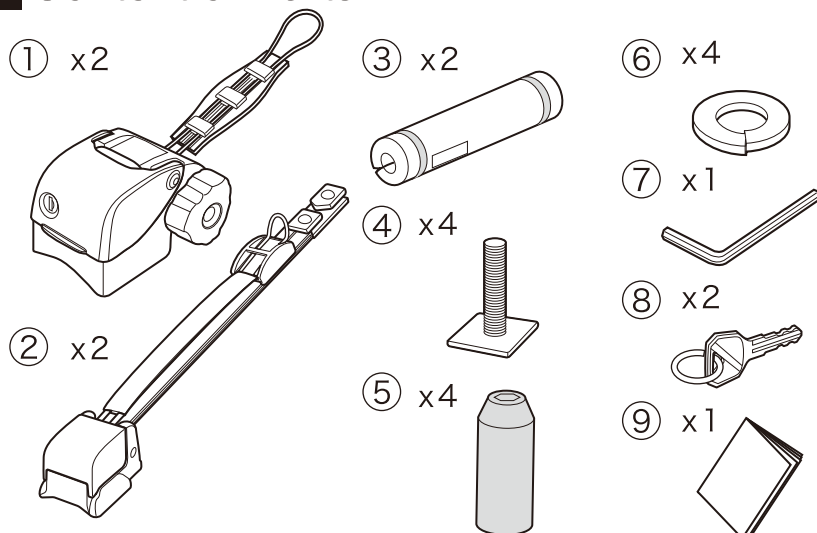

No.	Part	Qty
①	Main Ratchet Unit	2
②	Main Crane Unit	2
③	Pad (INA446 only)	2
④	Square Bolt	4
⑤	Long Nut	4
⑥	Spring Washer	4
⑦	Hex Wrench	1
⑧	Key	2
⑨	Installation Instructions	1

## 2 Attaching to the Carrier Base

This product can be attached not only to the INNO aero bar but also to the factory crossbar whose T slot fits the dimensions below.

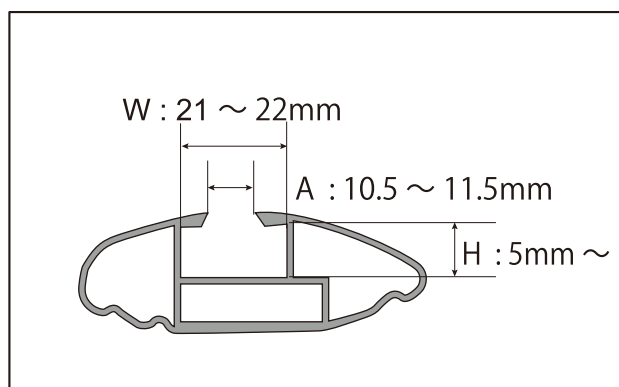

**⚠ WARNING**

- Check vehicle or carrier base product instructions to confirm that the carrier base to which this product is to be installed has sufficient strength to support this product. If the carrier base does not have sufficient strength to support this product, do not install.
- Maintain a distance of 24" (60 cm) or more between the front and rear carriers. If adjustment of the distance is possible, keep as much distance as possible in order to increase load stability.

At least  
24" (60 cm)

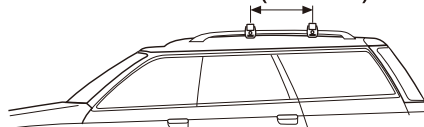

### 3 Installing the Attachment

To open the cover, turn the main ratchet unit key to the OPEN position.

#### ⚠ CAUTION

Do not operate the cover while holding onto the key.  
This may result in damaging the key.

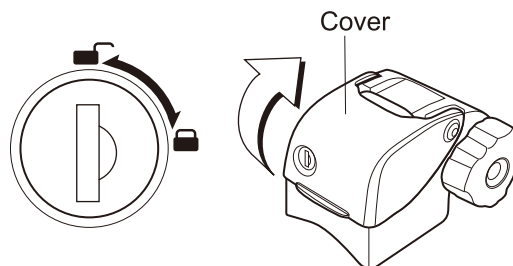

### 4 Setting the Main Crane Unit by Adjusting According to the Width of the loading equipment

Adjust the crane position so that the main ratchet unit and the main crane unit are as close to the loading equipment as possible, and fix the main crane unit securely. If the main ratchet unit and main crane unit are away from the loading equipment, it cannot be fixed securely.

#### REQUIRED BAR SPACE

Width of Loading equipment  
+ 9.0"(230mm)

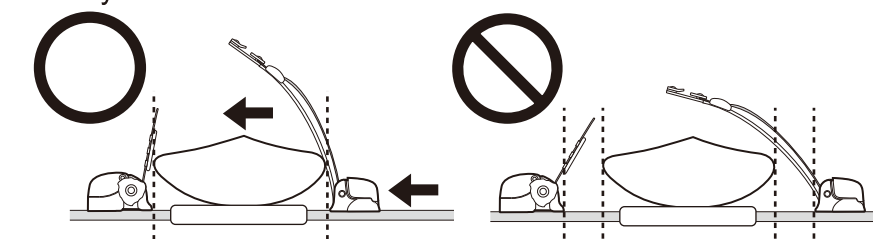
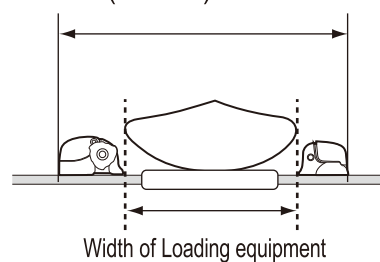

⚠ WARNING Position of the attachment must be adequate to the width of the loading equipment.

### 5 Installation of Main Ratchet Unit

- ① If the cover is attached, remove to allow insertion into T slot on the bar.
- ② Set the square bolt to the T slot.
- ③ Pass the square bolt through the mounting hole of the main ratchet body, then temporarily place there.
- ④ Be sure to set the spring washer to the square bolt, then securely tighten the long nut using the wrench included in this product's package.  
Due to applied screw locking agent, the bolt may resist when tightening. Regardless, tighten the bolt until the main unit is secured.
- ⑤ Close the cover.

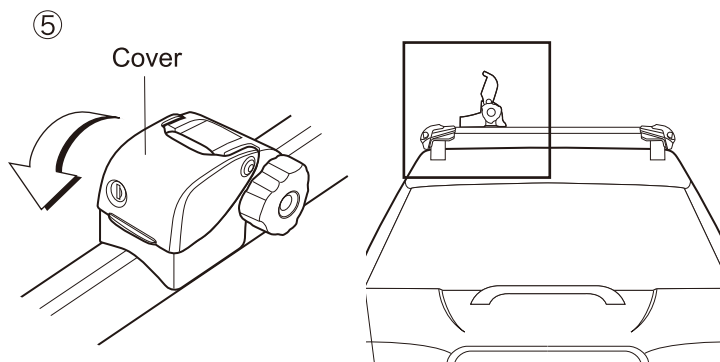
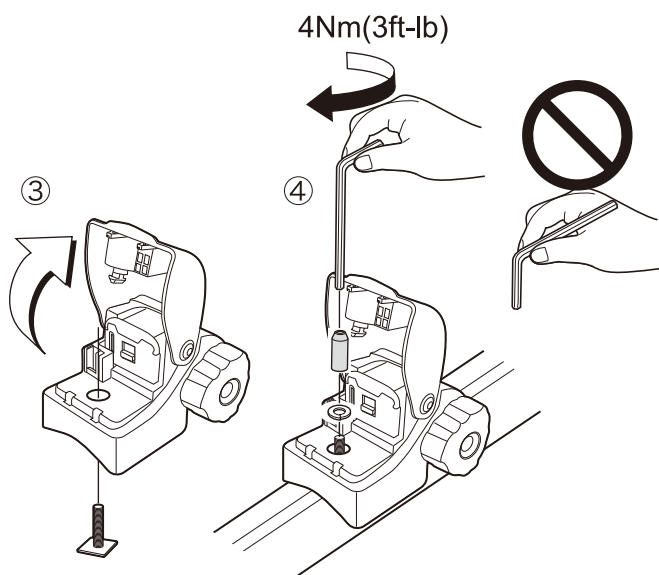
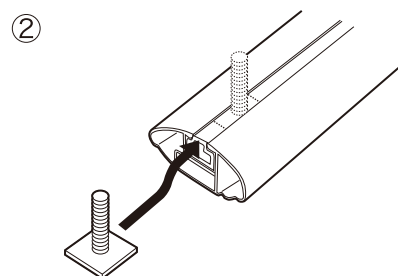
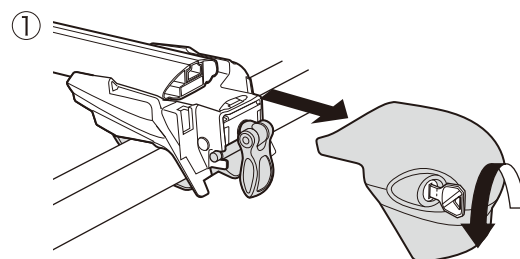

## 6 Installation of Main Crane Unit

- ① Open the main crane unit cover.
- ② Set the square bolt to the T slot.
- ③ Pass the square bolt through the mounting hole of the main ratchet body, then temporarily place there. Be sure to set the spring washer first, then insert the long nut.
- ④ Securely tighten the long nut using the wrench included in this product's package. Due to applied screw locking agent, the bolt may resist when tightening. Regardless, tighten the bolt until the main unit is secured.
- ⑤ Close the cover.

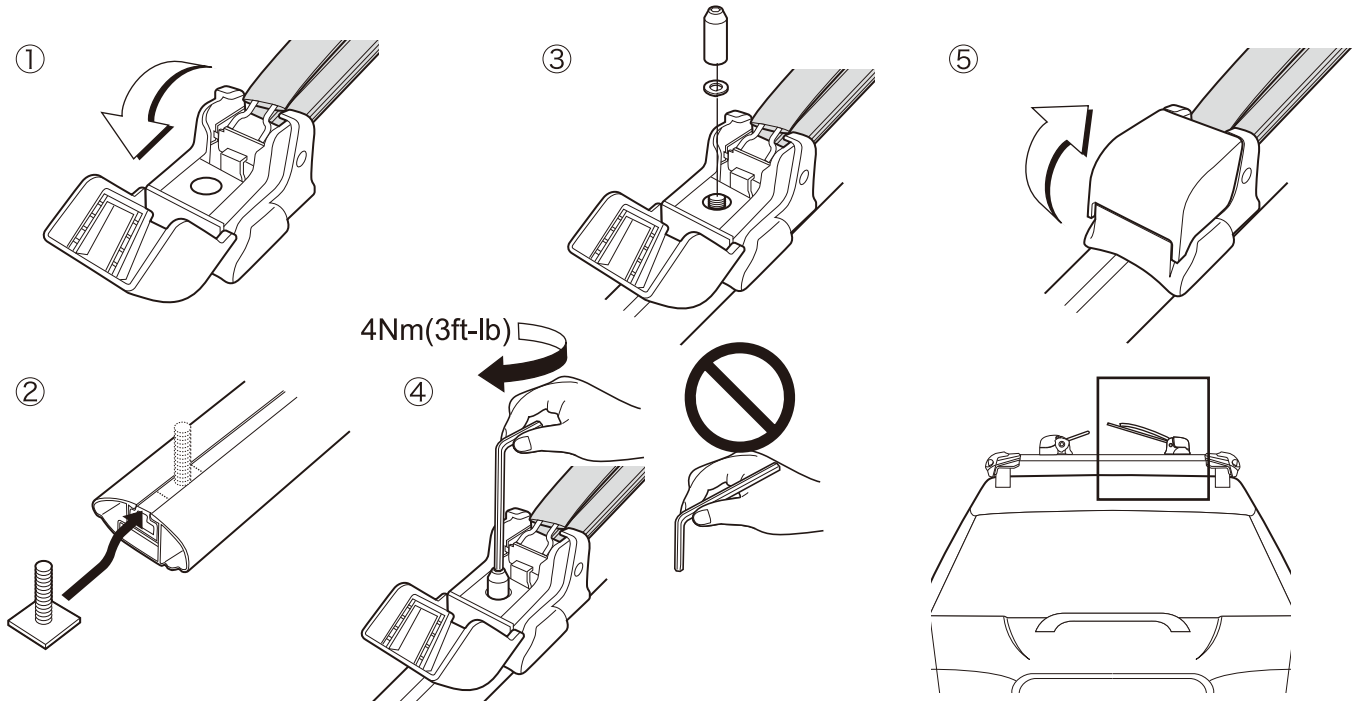

## 7 Maximum Load Capacity

The maximum load capacity of this product is as follows:

SUP/Sail board.....	2
Canoe / kayak.....	1
Short surfboard.....	3
Long surfboard.....	2

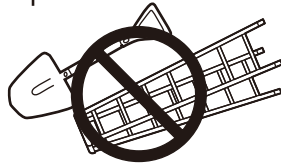

- Do not carry items other than SUP, canoe, kayak, surfboards and windsurf boards.
- Be sure to comply with the maximum load capacity limit.
- Check vehicle or carrier base product instructions to confirm that the carrier base to which this product is to be installed has sufficient strength to support this product.

## 8 Installing Pad (only for XA446)

Install the pad on the crossbars.

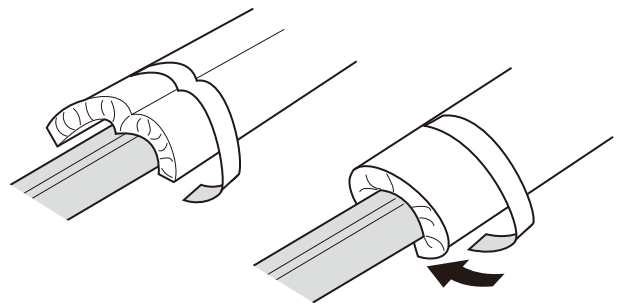

## 9 Loading a Kayak

Load a kayak so that it is well-balanced. The kayak can be loaded either right side up or upside down. Depending on the kayak shape, the pad may not fit. In such cases, use of the pad is unnecessary.

### ⚠ WARNING

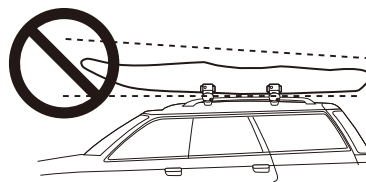

Load kayak / canoe as the rear side of the car gets higher. Making the front side higher is dangerous due to air resistance.

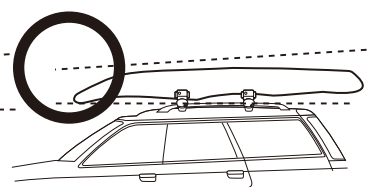
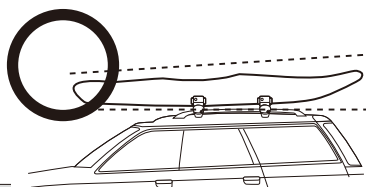

## 10 For Loading SUP, Surfboards or Sailboards

-Follow the same instructions as for loading a kayak when loading SUP, surfboards or sailboards.

The pad must be used for loading.

-If the distance between the main ratchet unit and the main crane unit is 33.4" (850mm) or less, remove the corner pad.

### ! WARNING

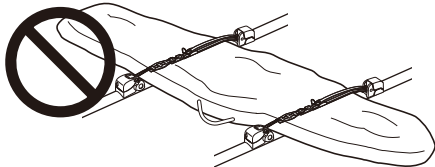

Do not load sail boards or long boards in bag. Only short boards can be loaded in bag.

### ! WARNING

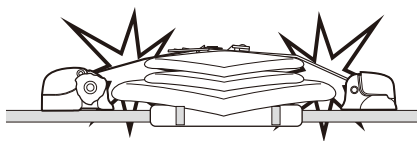

If multiple bare boards are stacked, do not allow cables to contact boards. cables may scratch board surface.

### ! WARNING

Load equipments as the rear side of the car gets higher. Making the front side higher is dangerous due to air resistance.

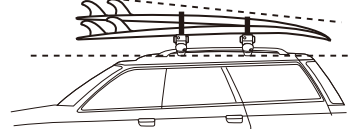
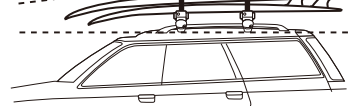
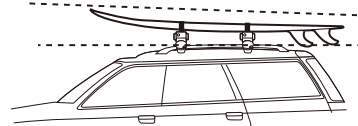
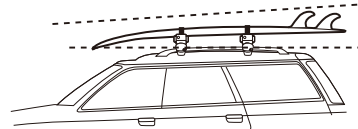

## 11 Tightening the Ratchet

Open the lock, lift the cover, push up the release lever and release the wire.

Attach the wire to the hook of the crane and turn the ratchet with both hands to tighten it. Roll up the ratchet not to bend the wire.

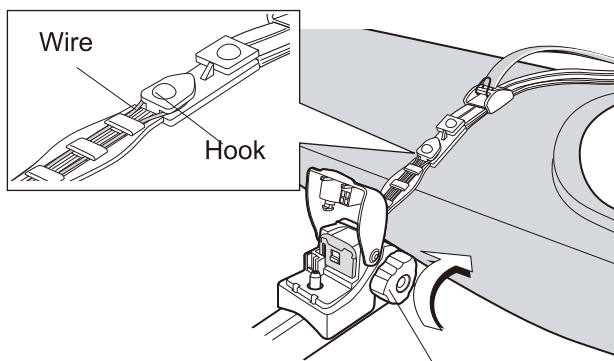
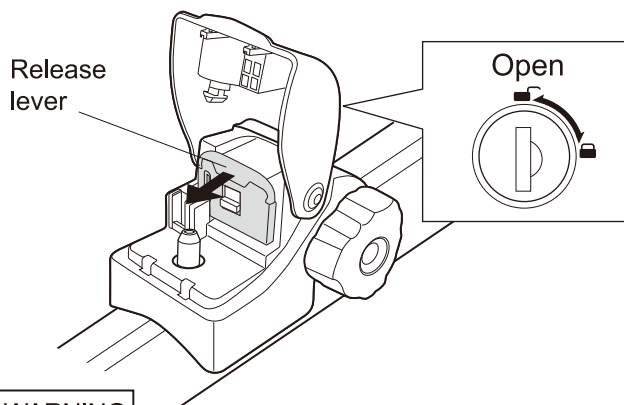

### ! WARNING

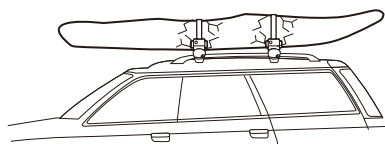

Do not overtighten the wire. Polypropylene boat can be wired up tightly secured in a short term. However, when it is wired up for a long period of time, the shape will not be restored. FRP boat can be broken when it is overtightened.

## 12 Close and Lock the Cover

Be sure to lock cover with key before driving.

### ! WARNING

If cover is not locked, release lever may open accidentally causing equipment to drop.

This system is a theft deterrent.

Equipment should not be left unattended for long periods of time.

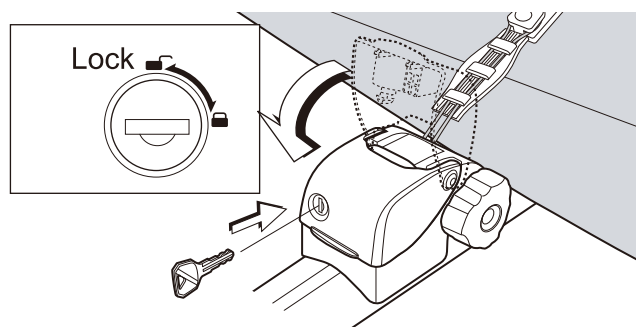

## 13 Driving

- Before driving, shake the carrier and equipment load in order to confirm that they are set securely. If there is any looseness, tighten the bolts and ratchet again.
- When loading a kayak/canoe longer than 13.2 ft.(4 m), secure the front and back to the car body with belts.
- Load equipment straight.
- When driving without using the attachment, remove the pad and fix the crane by ratchet.
- Remove the corner pad when the ratchet is not rolled up enough.
- This product is not theft-proof. Therefore, do not leave equipment on this product unattended for an extended period of time.

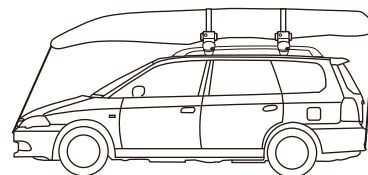
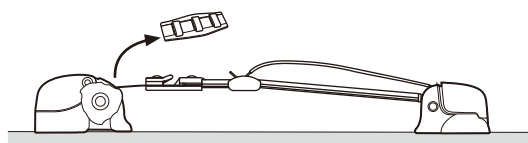
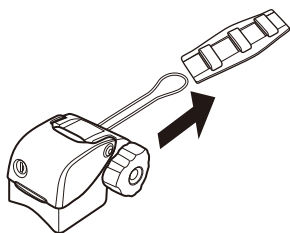
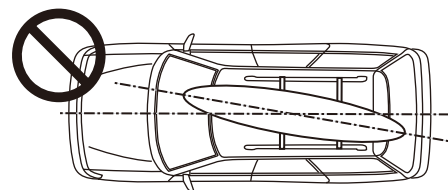
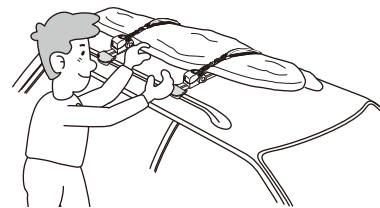

### ⚠ WARNING



Obey all posted speed limits. Drive slower under strong winds or on rough roads.

### ⚠ WARNING



Do not drive your carrier through a car wash. Always remove the carrier system before running your car through a car wash.

### ⚠ WARNING

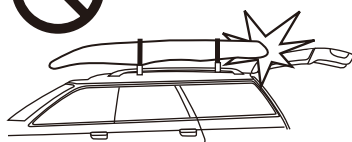

Be careful not to hit the surfboards or sailboards with the vehicle's tailgate or trunk lid. In case your gear is accidentally hit by the tailgate or trunk lid, be sure to check the carrier's mounting condition.

### ⚠ WARNING



Do not make hard starts, unnecessary sharp turns, abrupt maneuvers or sudden stops. In case you have to perform such a maneuver, always check afterwards to see that the carrier and cargo remain secure.

### ⚠ WARNING



Avoid flapping. When you load the shortboard in a case, make sure to tighten securely, so that the case is not flapping. If the case is flapping while driving, wind pressure might cause boards to fly off.

### ⚠ CAUTION

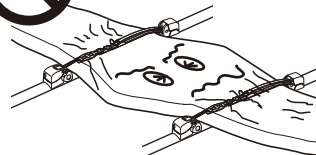

Tighten the ratchet securely, but avoid denting the board. Excessive tightening may cause damage to the board.



## 14 Care and storage

When the carrier is not in use, remove from the vehicle.

Store in a covered, dry location away from sunlight.

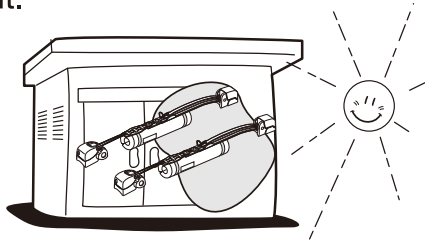

### ⚠ WARNING

- Pad is expendable.
- Remove from carrier when not in use.
- Replace when there is deep scratch or crack.

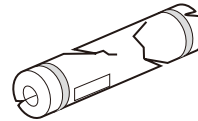

### ⚠ WARNING

- DO NOT lubricate Key and Bolts.
- DO NOT apply thinner and/or solvent as they may damage plastics.

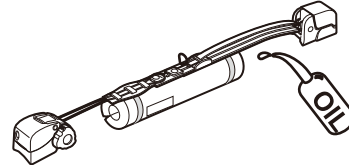

## Genuine INNO Replacement Parts

The following genuine replacement parts are available for this Inno carrier system component.

### Note

Specifications and appearance of the carrier system and genuine replacement parts are subject to change without prior notice in the interest of product improvement.

