

Fork Lock for Aero Base XA391

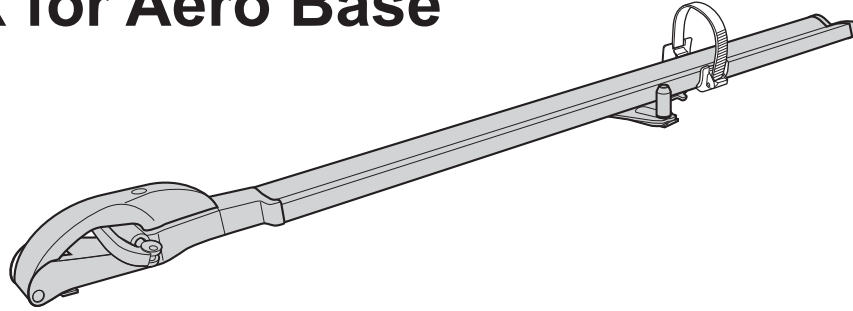

Thank you for purchasing this INNO product.

-Read these instructions carefully before using this product. Do not discard these instructions.

⚠ WARNING Falling carrier parts or loads may cause potentially serious accidents involving vehicles and individuals following behind may result in severe injury or death.

- Confirm the stability and strength of the carrier base onto which this product is to be installed, and attach it securely.
- Maintain a distance of 23.6"- 31.4" (60-80 cm) or more between the front and rear carriers/crossbars. If adjustment of the distance is possible, keep as much distance as possible in order to increase load stability.
- Assure that neither screws nor wires are loose before driving.
- Do not alter this product.
- Do not load anything other than a bicycle or load more than one bicycle onto a single attachment system. Maximum load capacity: 15kg/33lbs.
- Exercise due care when driving while using this carrier.
- Lock securely while driving.

⚠ CAUTION May cause injury to individuals or damage to the product, vehicle and loads being carried.

- This product is not theft-proof. Therefore, do not leave equipment on this product unattended for long time.

Before Use

Attaching to the Carrier Base

This product can be attached not only to the INNO aero bar but also to the factory crossbar whose T slot fits the dimensions below.

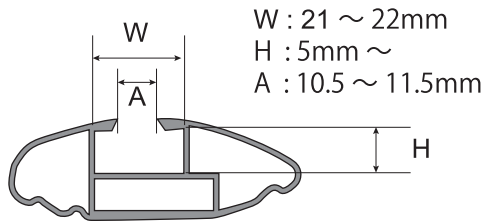

23.6~31.4 inch
(600-800 mm)

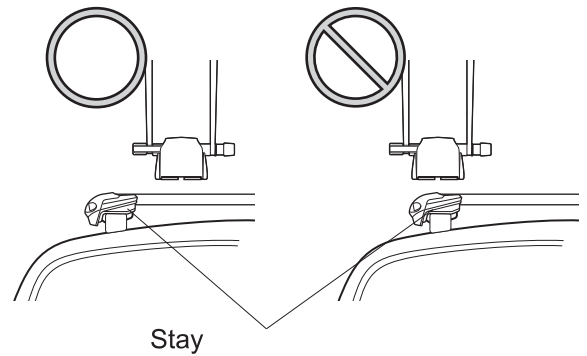
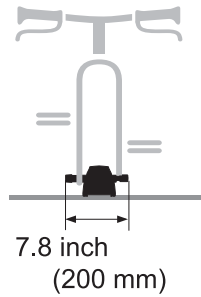
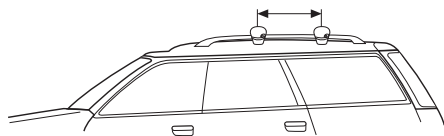

WARNING

- Check vehicle or carrier base product instructions to confirm that the carrier/crossbar to which this product is to be installed has sufficient strength to support this product. If the carrier /crossbar does not have sufficient strength to support this product, do not install.
- Maintain a distance of 23.6"- 31.4" (60 -80 cm) or more between the front and rear carriers. If adjustment of the distance is possible, keep as much distance as possible in order to increase load stability.
- This product requires a width of 7.9" (200 mm) for installation. However, If more than one Slim Fork is used, the bicycles may interfere with each other, depending on their size.
- This product cannot be mounted while in contact with any part of the resin portion including the stay cover.

⚠ WARNING



23.6~31.4 inch
(60cm~80cm)

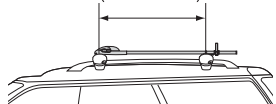

The space between the front and rear carriers / crossbar must be between 23.6-31.4 inch.(60-80cm) Assure that neither knobs nor bolts are loose before driving.



Mount the bicycle attachment system so that the bicycle's handlebar doesn't protrude toward the side, exceeding the width of the vehicle.



Before driving the vehicle, always check the vehicle's overall height, including the bicycle loaded on the roof of your vehicle, and remind yourself to be aware of low-clearance parking garage, tunnels and other structures.

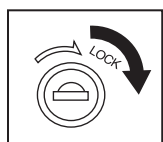

Always use the key lock to secure the carrier.

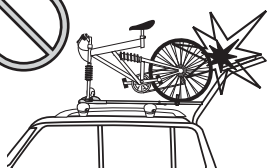

Be careful not to hit the bicycle with the vehicle's tailgate or trunk lid. In case your gear is accidentally hit by the tailgate or trunk lid, be sure to check the carrier's mounting condition.

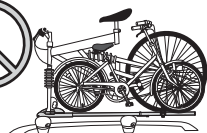

Do not load anything other than a bicycle or load more than one bicycle onto a single attachment system.

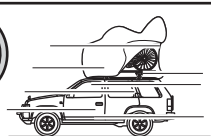

When loading a bicycle, do not use the gear casing or protective plastic packaging.



When driving with items loaded, observe the local speed limit. Reduce your driving speed in strong winds and bad road conditions.



Always remove the carrier system before running your car through a car wash.

1 Content of Parts

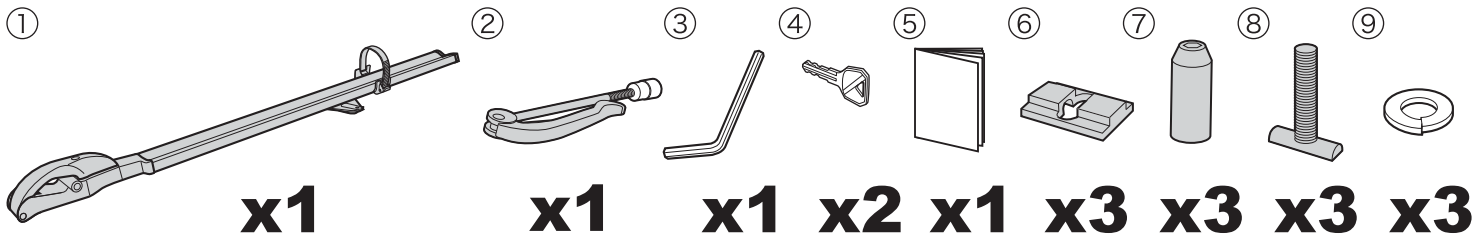

Name of Parts

NO.	Part
①	Main Body
②	Quick lever ASSY
③	Hex Wrench
④	Key
⑤	Installation Instructions
⑥	Bolt Base
⑦	Long Nut
⑧	T Bolt
⑨	Spring Washer
⑩	Front Cover
⑪	Adjuster
⑫	Quick Shaft
⑬	Frame
⑭	Holder
⑮	End Cap
⑯	Buckle
⑰	Wheel Belt
⑱	Rear Plate
⑲	Flat Washer
⑳	Knob
㉑	Front Fork
㉒	Front Hub
㉓	Disk Brake Caliber

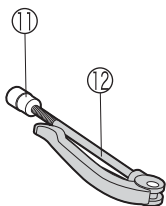
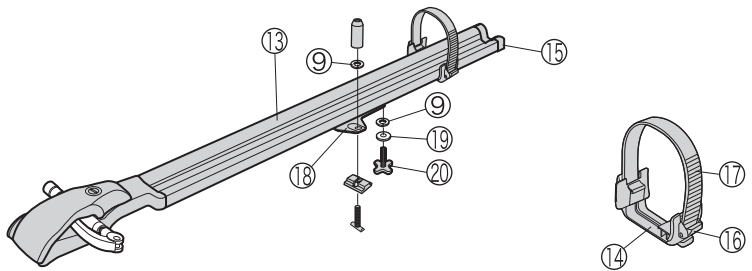
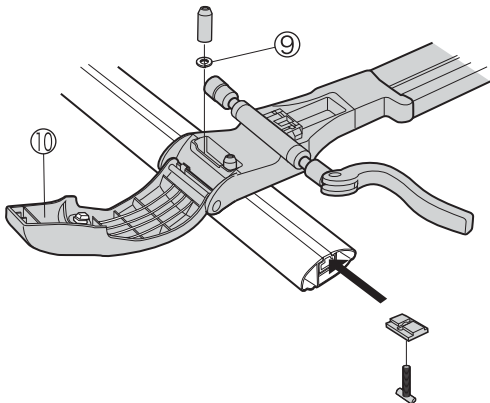

Name of Bicycle parts

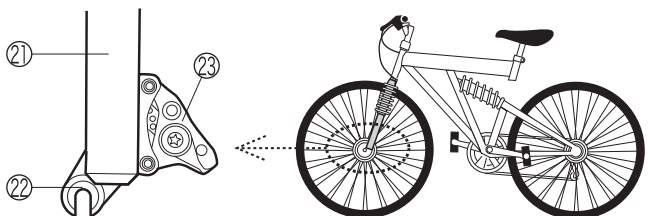

Preparation before Installation

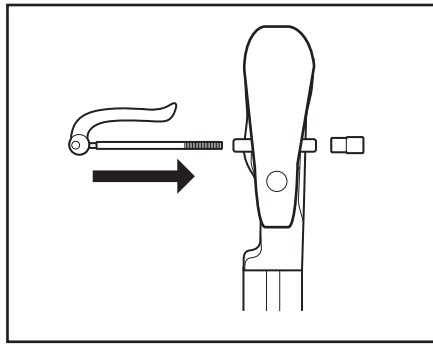

On the right side

On the left side

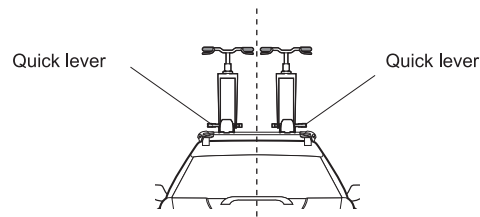

Front-facing



Rear-facing

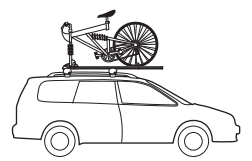

Choose the position (right side or left side) and direction (mounting bike to front or back) of the bike carrier on the vehicle.
Make sure installation position to attach Quick Lever ASSY.

How to replacement of the holder

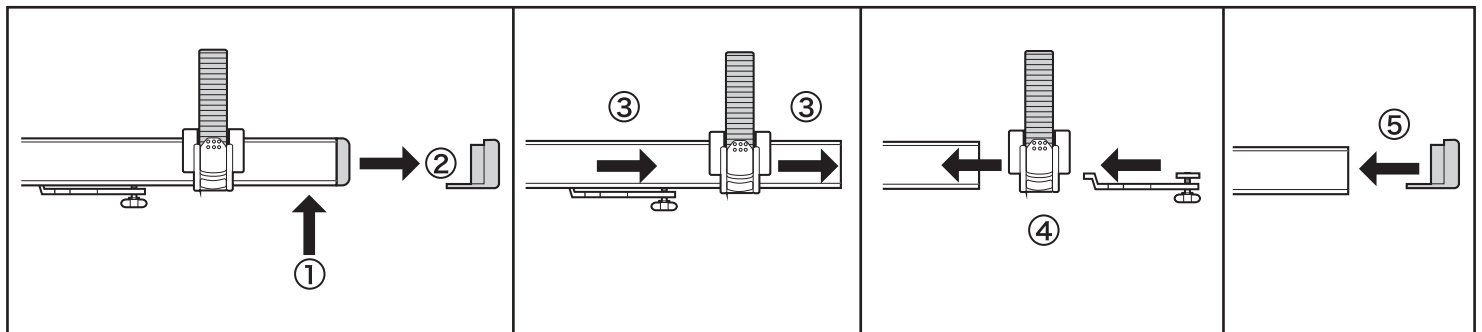

Installing

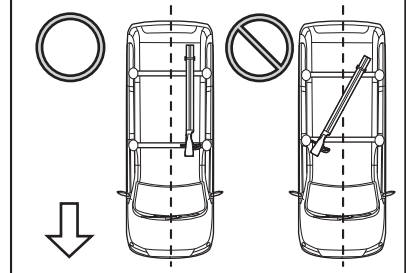
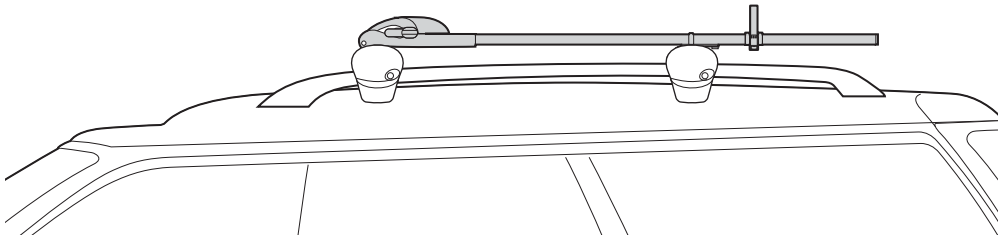

1

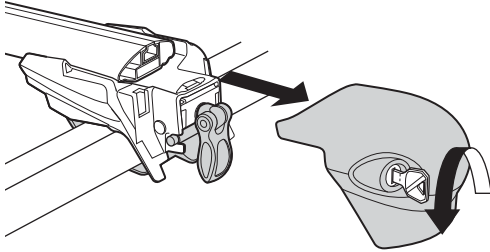

2

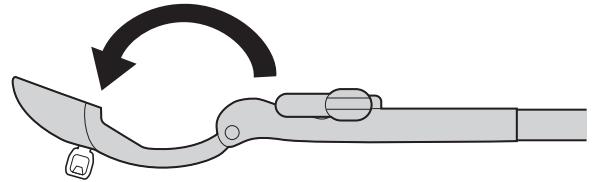
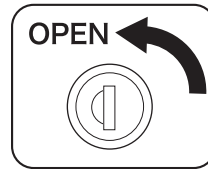

3

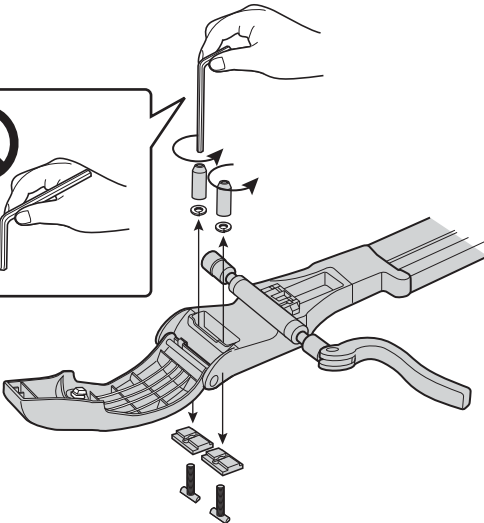
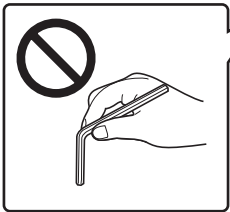

4

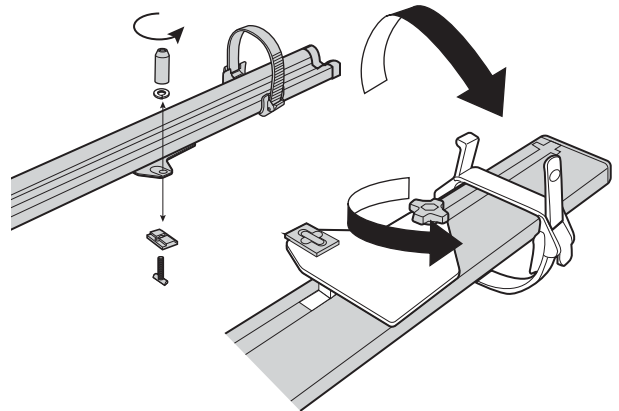

5

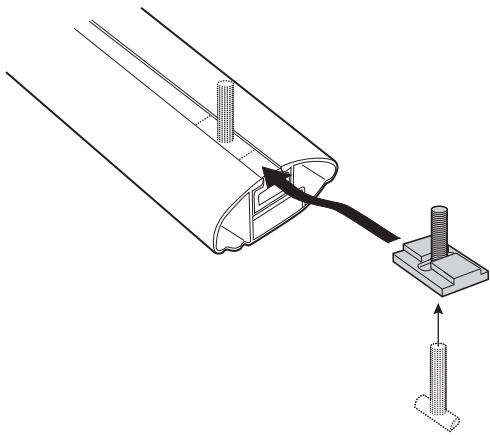

6

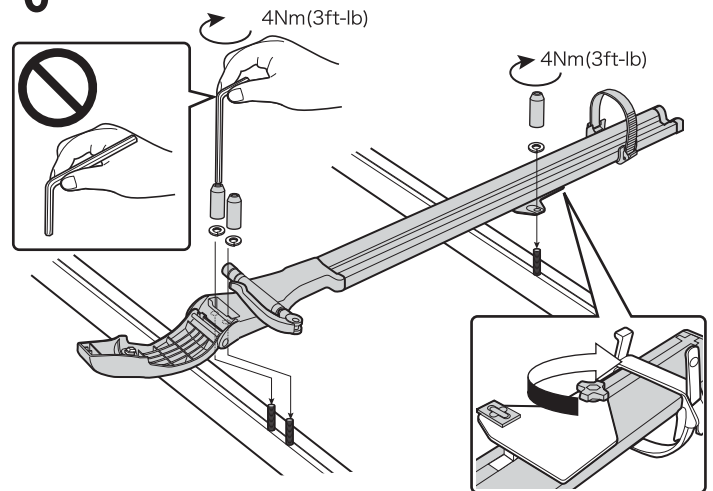

Installing

- 1 If the cover is attached, remove to allow insertion into T slot on the bar.
- 2 Insert the key and release the lock to open the front cover.
- 3 Loosen the long nuts first, then remove the long nuts, spring washers, T bolts, and bolt base from the main body.
- 4 Loosen the knob of the rear plate but not to the point where the knob will come off. Remove the long nuts, spring washers, T bolts, and bolt base from the main body.
- 5 With the T bolt set into the bolt base, insert into the bar T slot. 2 sets on the front side, 1 set on the rear side.
- 6 Set the bolts into the main body Attachment and place it on top of the bar.
Set the spring washers to the long nuts first, then tighten the long nuts.
Tighten them firmly using a hex wrench. For the front side, tighten left and right alternately. (4 Nm/3 ft-lb)
Tighten the knob firmly.

Check Installation

- Shake the carrier and equipment load in order to confirm that they are set securely.
If there is any looseness, tighten the bolts and knobs again.
- Load equipment straight.

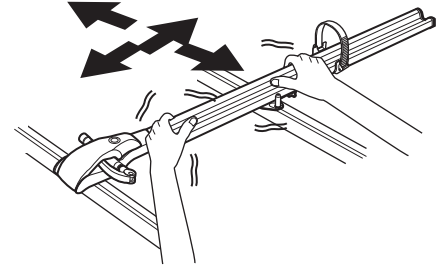

Loading

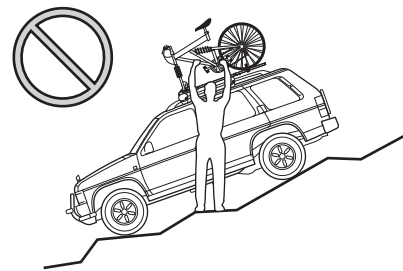
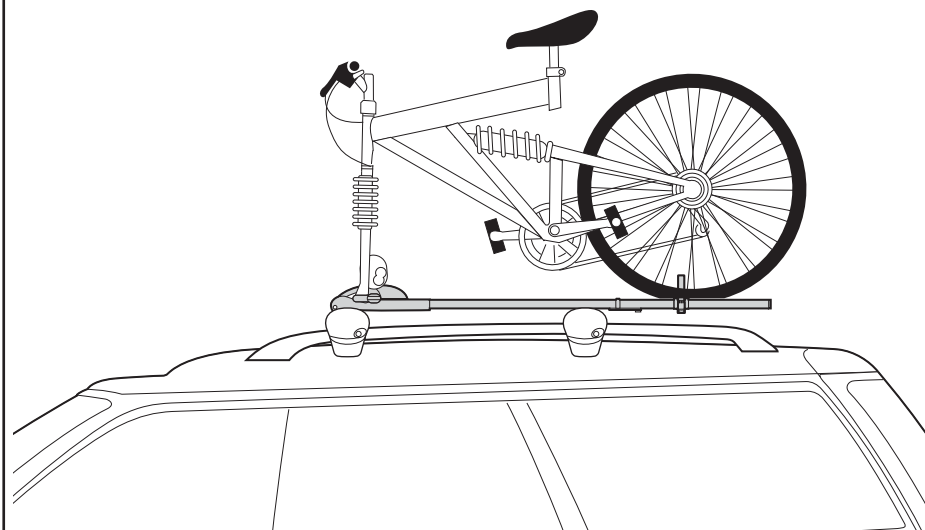

Make sure to load/take down bicycle on flat and stable ground.

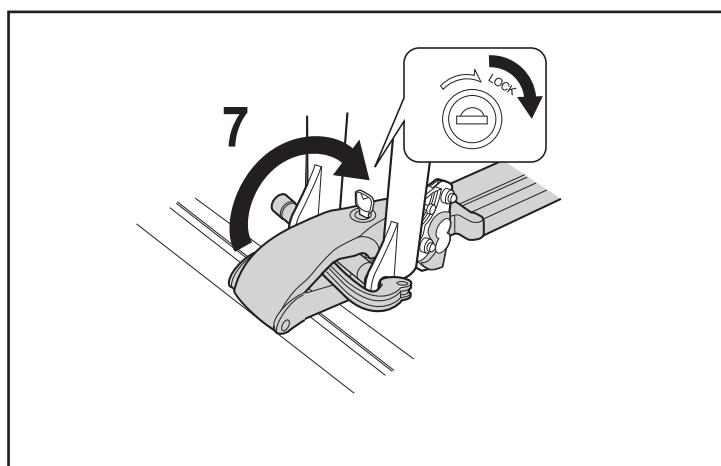
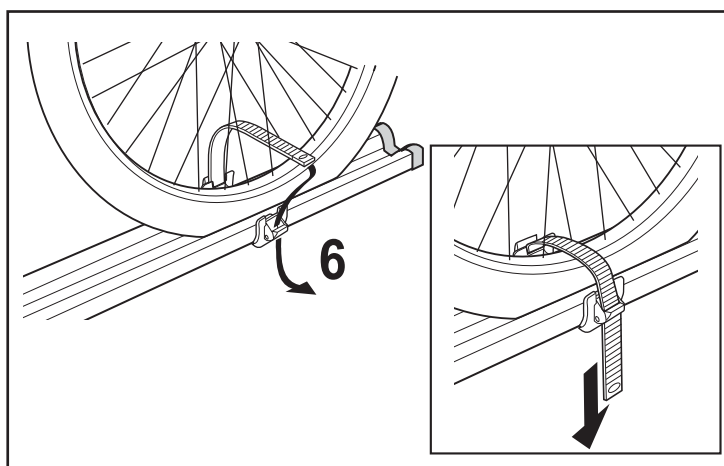
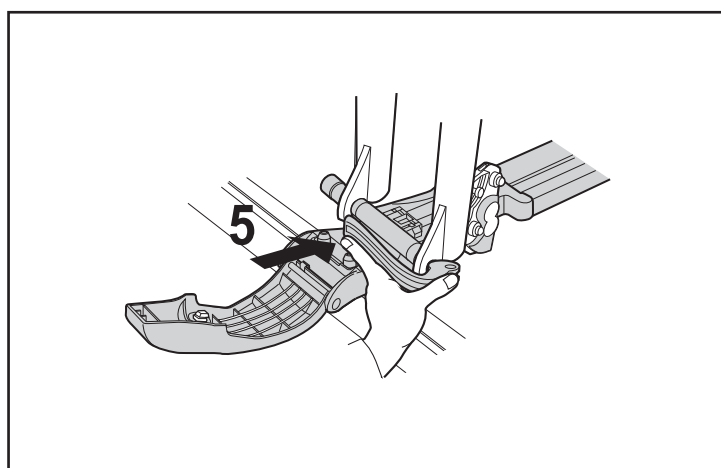
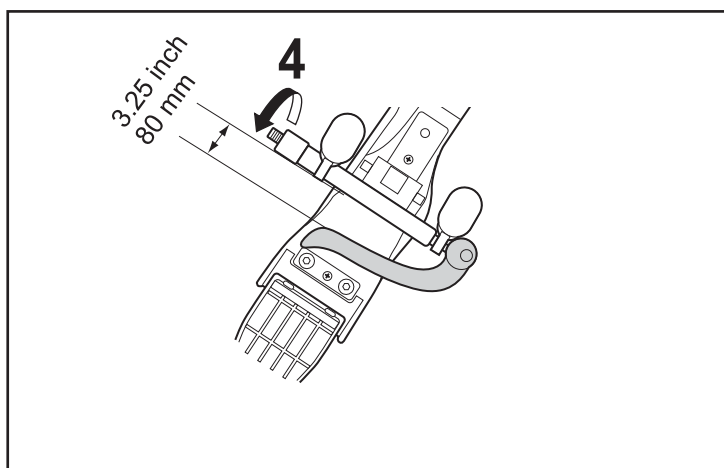
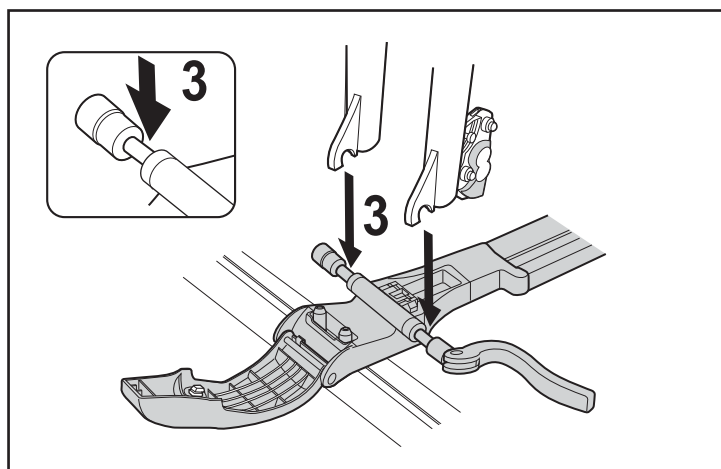
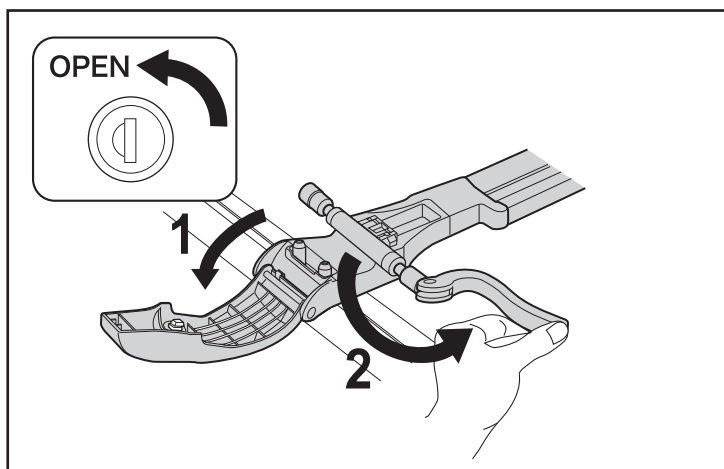

Loading

- 1 Open front cover.
- 2 Pull quick lever.
- 3 Place the edge (dropouts) of the front fork of the bicycle onto the quick shaft.
- 4 Close quick lever loosely, so that space between quick lever and stopper is about 3.25 inch (80 mm), then tighten adjuster to fix.
- 5 Close quick lever until Lever touches stopper. The adjuster cannot be tightened when the bicycle is affixed and tightened.
- 6 Move wheel belt to center of rear tire, then tighten tire with wheel belt.
- 7 Close front cover, then lock key.

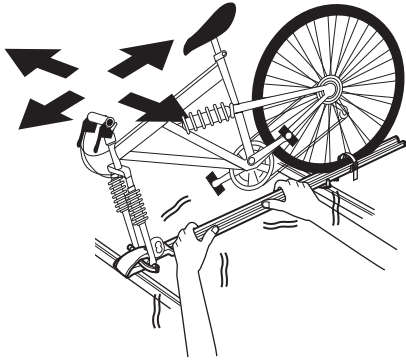

Check Installation

- Shake the carrier and equipment load in order to confirm that they are set securely. If there is any looseness, tighten the bolts and knobs again.

Taking Down a Bicycle

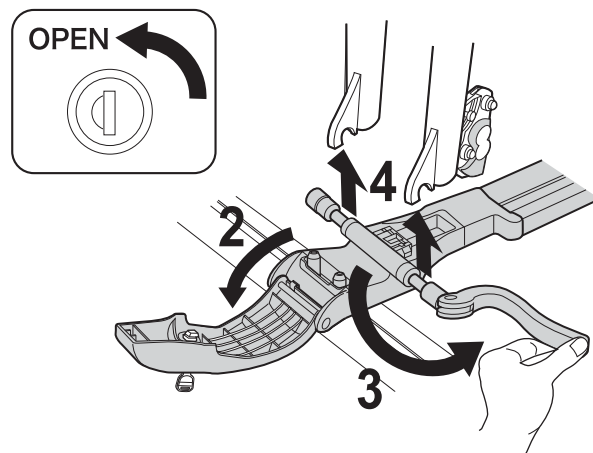
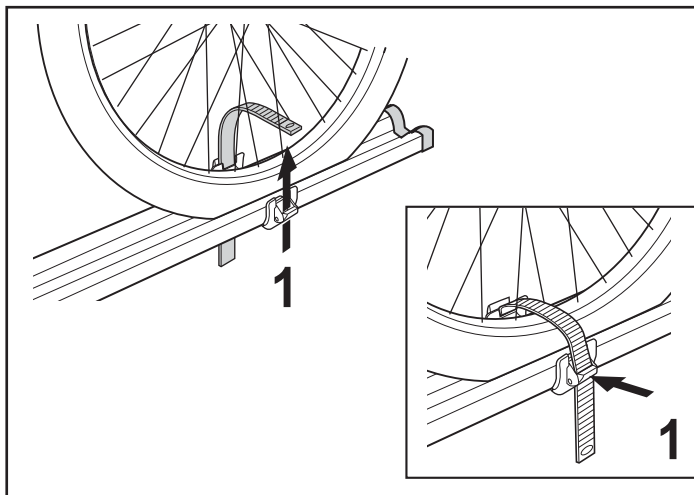
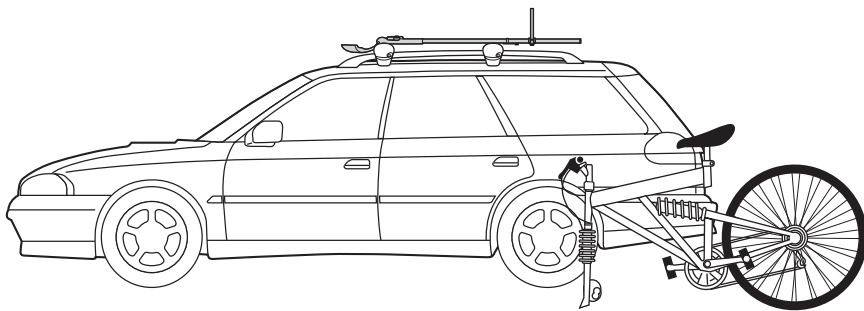

1 Remove Wheel Belt.

2 Open front cover.

3 Pull quick lever.

4 Hold bicycle securely, pick up bicycle vertically, and take down bicycle.

Daily Maintenance

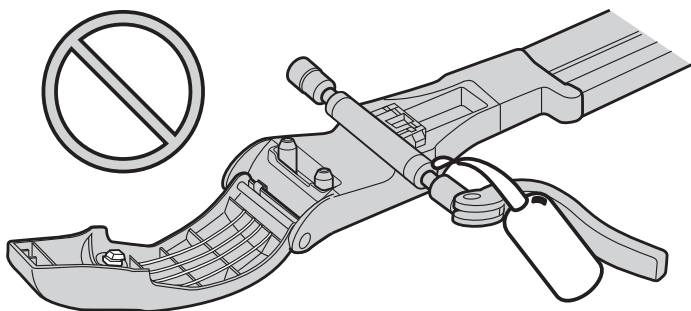

- 1 Wash off dirt and mud with water.
- 2 Wipe off dirt with a well wrung-out wet towel.
- 3 Allow it to dry in the shade.

CAUTION -DO NOT lubricate Key and Bolts. -DO NOT apply thinner and/or solvent as they may damage plastics.

Care and storage

Inspecting the parts

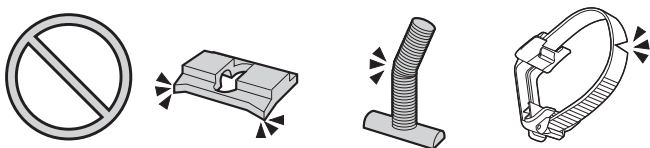

Clean the parts, and inspect each of the parts for abnormalities. If you discover any bent or damaged parts, discontinue use immediately and replace the parts.

Storage

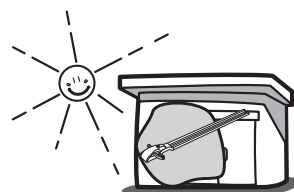

Store in a covered, dry location away from sunlight.

Spare Part Information

The following genuine spare parts are available for this lock. If you require spare parts, take the part to the dealer where you bought the carrier, or order the necessary part using the part name listed below.

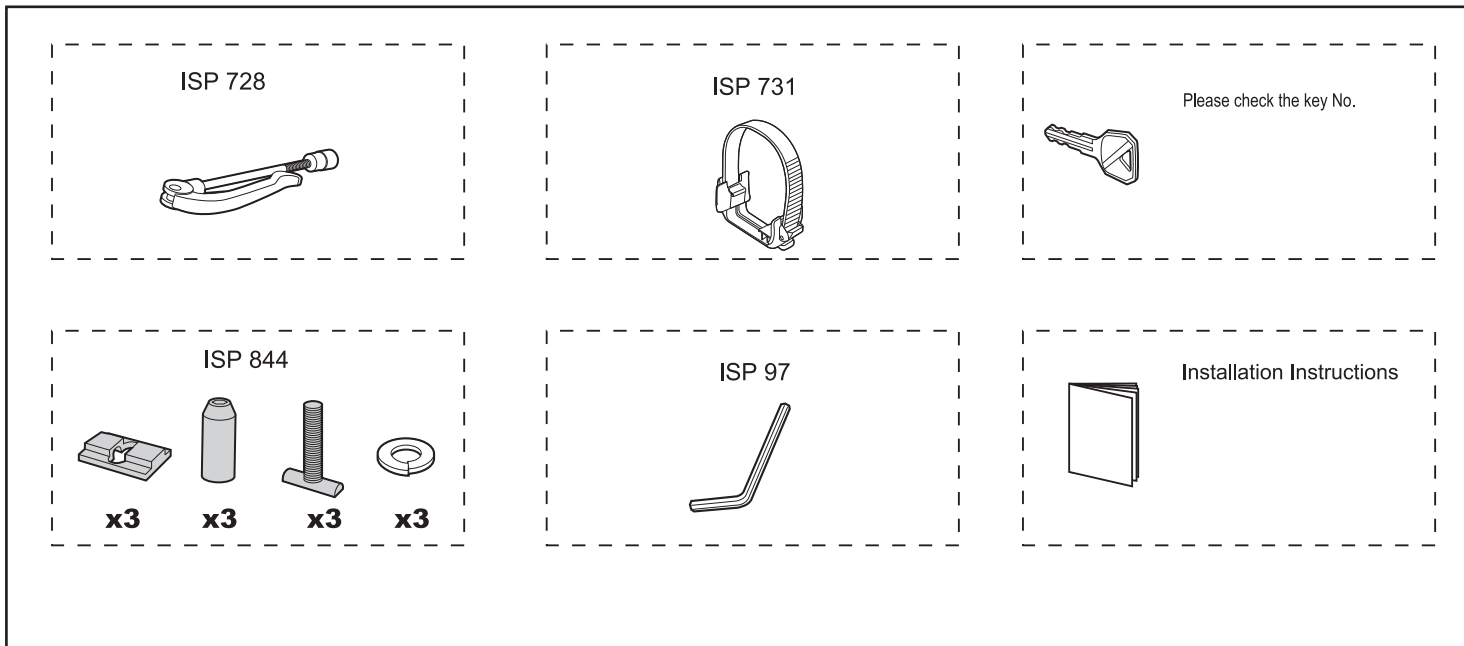

Notes

Specifications and external appearances of this carrier and genuine repair parts are subject to change without notice in the interest of product improvement.

[View other bike racks made by INNO on our website.](#)