

Installation Instructions

Before using the Mounting hooks, carefully read this installation instruction as well as the installation instructions for basic carrier systems, and follow all usage instructions. After reading the manual, keep it in a safe place along with the installation instructions for basic carrier systems. If you are to give themounting hooks to a third person, provide this manual to ensure safe installation and usage.

- Read instructions matching the model
- If appropriate instructions are not available

⚠ **Precautions**

- Install hooks correctly at specified positions according to the instructions herein and instructions for the applicable carrier system. Installation positions of hooks depend on the vehicle type. If hooks are not installed at specified positions, the carrier may fall and cause an accident.
- Do not use these hooks for attachments of non-specified types. The carrier may drop and cause accident.
- Observe the specified loading conditions.
n may cause the carrier to break or loosen and drop, resulting in accident.

For INNO dedicated ski & snowboard carriers read carrier instruction manuals for determining proper mounting locations.

The XR Mounting hooks includes the parts listed below. Verify that all of these parts are included in the carrier system you have purchased.

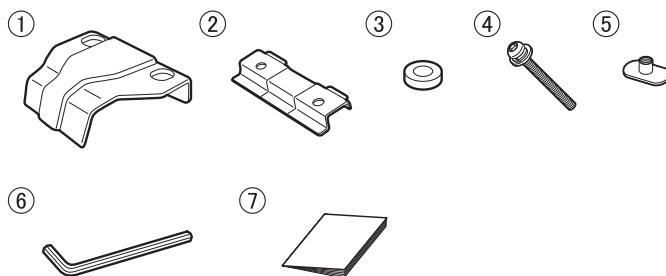

No.	Parts	Qty
①	Front hook	4
②	Rear hook	4
③	Rubber spacer	8
④	Bolt [M6 x 40 mm]	8
⑤	T-Nut	8
⑥	Allen key [B = 4]	1
⑦	Instruction manual	1

📖 Note

Installation procedures are described for different models, years and types.
If your car doesn't match any of the vehicle types listed, refer to the instructions for the applicable carrier.

Manufacturer	Vehicle model	Vehicle type	Model year	Loading conditions	
				Maximum Load Capacity	Bike
JEEP	GRAND CHEROKEE	5-door wagon	2005-2007	64 Kg / 140lbs (loaded items + attachment)	3 bikes

IN-TR

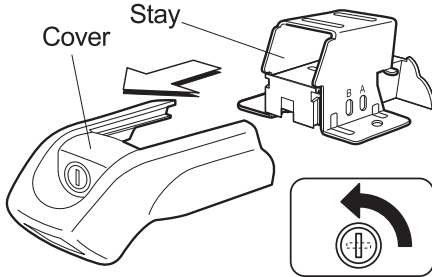

- 1 Before installing your rack, clean the surfaces of your vehicle's factory tracks or rails.
- 2 Unlock the key and remove covers from stays.

TR117

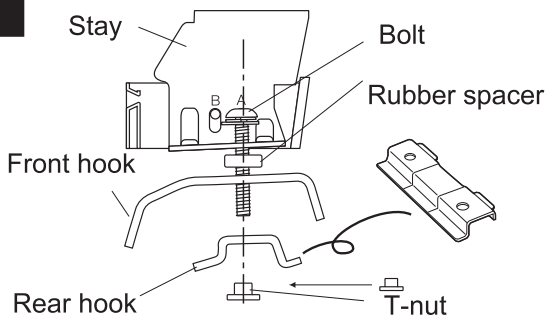

- 3 Attach the stay to front hook, rear hook and T-Nut with 2 bolts. At this point, do not tighten T-nut all the way.

CAUTION

Verify direction of T-Nut and rear hook.

Note

Tip of the bolt should not protrude from T-Nut.

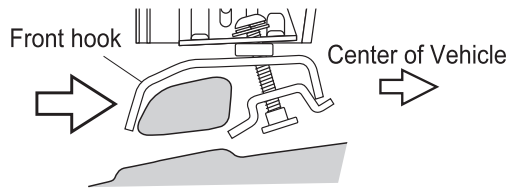

- 4 Spread the front and rear hooks apart and place onto the roof rail. Slide front hook until it fits.

- 5 Mounting location is determined by the following conditions. Mark the mounting points with a piece of masking tape.

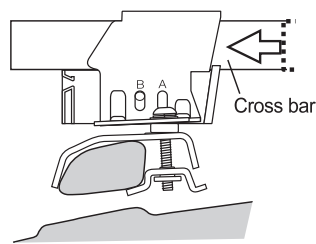

- 6 Choose the position of the cover A or B to slide the spacer.

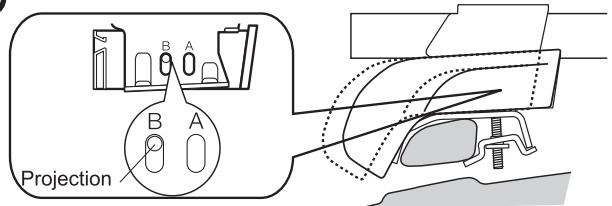

- 7 All mounting screws must be tightened evenly with the hex wrench on both sides until the spring washer flattens.

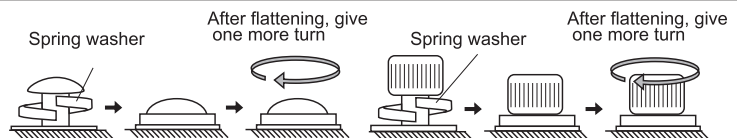

- 8 Close the cover. Insert key and turn right to lock.

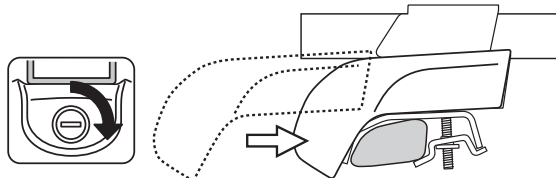

- 9 Place the end caps (included with bars) onto each end of the crossbars.

