

IN-JK Joint Bar Set For SU Installation Instructions

The following Installation Instructions explain how to mount and use the IN-SU basic carrier system. After reading this manual, keep it in a safe place along with the installation instructions for the rest of your carrier system.

The IN-JK Joint Bars include the parts, components and items shown below. Verify that all of these parts are included with the package you have purchased.

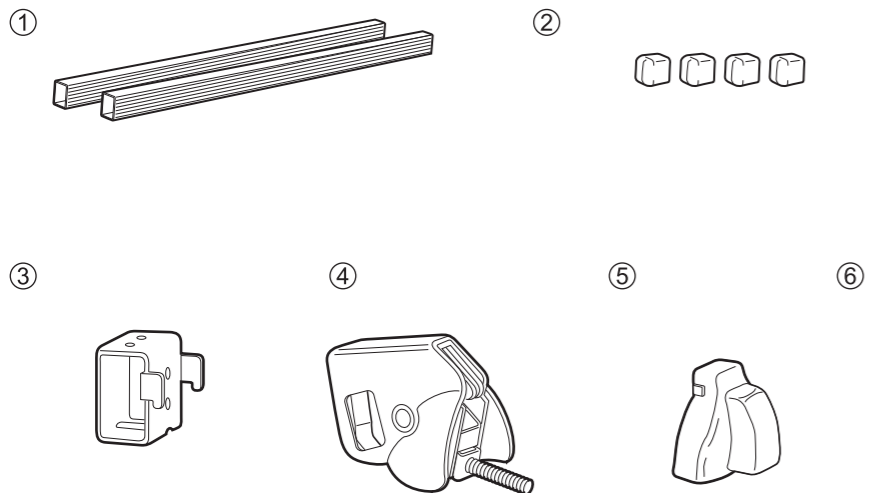

No.	Item	Qty
①	BAR 770mm(30.3")	2
②	BAR END CAP	4
③	BACK HOLDER	4
④	CENTER HOLDER	2
⑤	REAR COVER	2
⑥	USER'S MANUAL	1

CAUTION
Select the SU Mounting Hooks that match your car by referring to the Fit Guide available at your dealer or online. Only use SU Mounting Hooks.

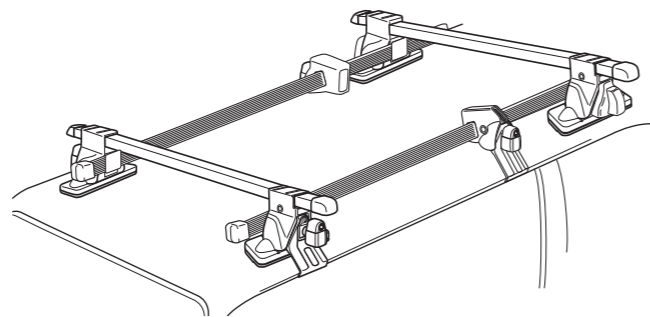

Note
Installation of Joint Bars requires SU Stay set, SU Mounting Hooks and a Bar set (all sold separately) in addition to parts 1 through 6..

Installation instructions for SU Stays and SU Joint Bars are below. Refer to instructions for SU Stays and SU Mounting Hooks for information on preparation of the car and carrier, precautions for installation and use, reference information, usage, care, and storage.



IN-JK Joint Bar Set For SU Installation Instructions

1 Slide back holders and center holder over bar. Back holder hooks should face down.

2 Install bar end caps on both ends of bar.

Note
Install parts on both bars. Bar has no required orientation.

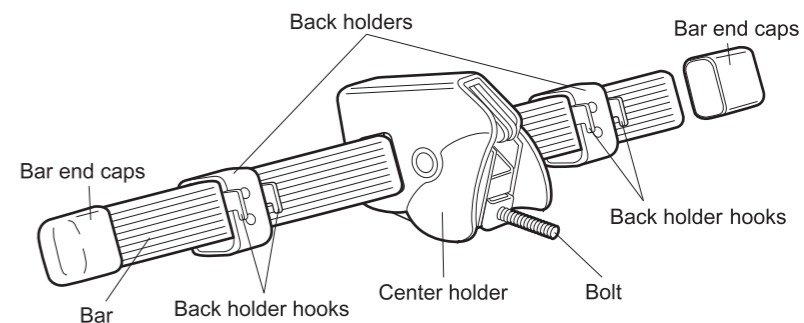

3 Insert stay bolt into rear cover and push rear cover on until flush with stay.

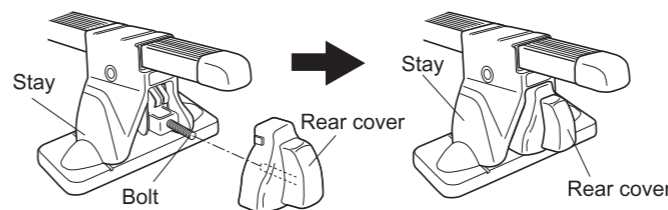

4 Install front carrier according to instructions for SU Stays.

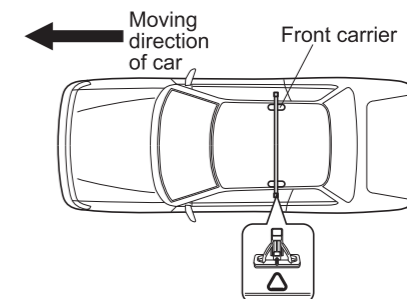

5 Place rear carrier on roof at appropriate positions listed in the instructions for SU Mounting Hooks.

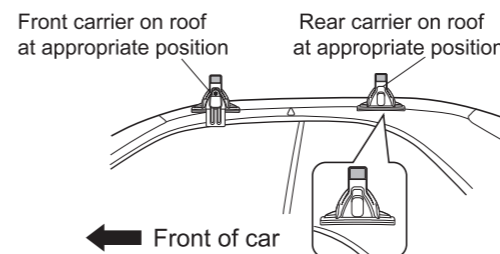

6 Measure distance [D] and adjust rear carrier position.

Note
Measure [D] by referring to "Mark Installation Position on Car" in instructions for SU Mounting Hooks.

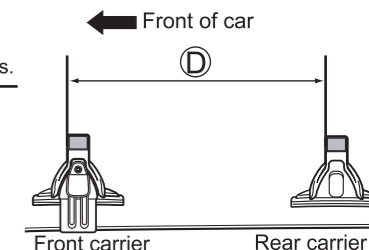

7 Insert back holder hooks into two oval holes on back of each carrier stay.

Note
Be careful to not scratch roof with center holder bolt when installing carrier and bar.

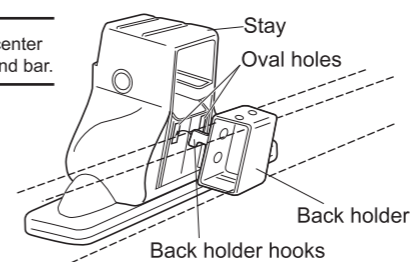

8 Check if back holder hooks are inserted correctly. If not, reinstall.

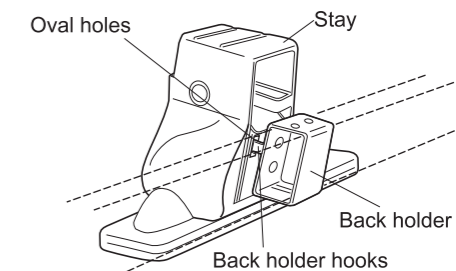

9 Adjust front and rear bar ends to equal lengths. Slide center holder until installation mark (rear) aligns with center holder bolt [a].

Note

If bar contacts rear hatch, etc., slide bar forward or back.

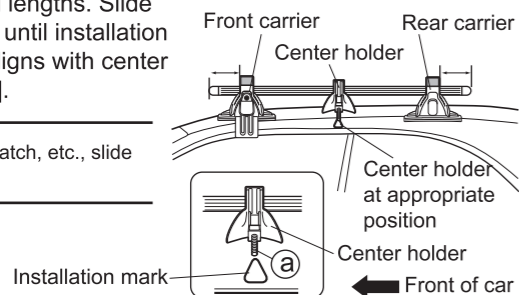

10 Prepare appropriate hook for center holder according to the instructions for the SU Mounting Hooks. Note location of tab on inner side of rear stay.

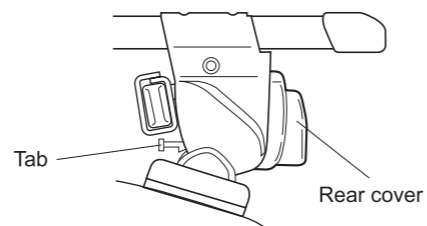

11 Slide hook over center hook bolt and install onto roof.

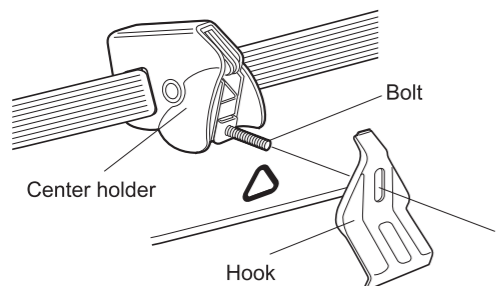

12 Slide key plate over bolt, press it against hook, and loosely tighten knob. Loosely affix hook and key plate on opposite side.

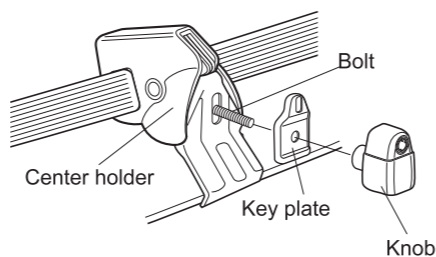

13 Alternately tighten right and left center holder knobs until tab on rear stay drops.

Note

Tab may not drop depending on roof strength or hook number. If so, tighten carefully so as not to allow roof or hook to bend.

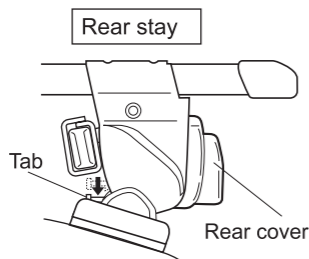

14 Tighten all knobs uniformly.

CAUTION

Avoid overtightening, as it may damage roof or molding end.

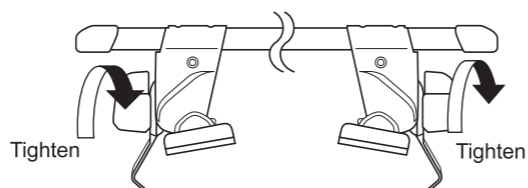

15 Refer to the instructions for the Mounting Hooks. Check position of hook base by referring to installation drawing for applicable vehicle type. Lock knob.

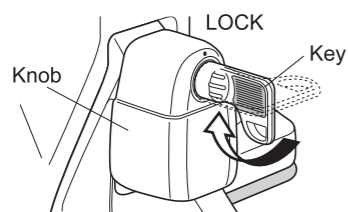

16 Verify that bars are installed correctly.

CAUTION

Before driving the vehicle, rock the stays and bars in all directions to ensure that there is no looseness in any of the four mounting knobs. Retighten any loose knobs.

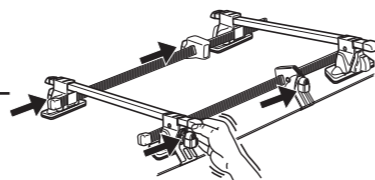

Information on genuine repair parts

The following genuine repair parts are available for the carrier system. Specify the part number when ordering any part from the store where you purchased your system.

Note

- The specifications and external appearance of the carrier system and genuine repair parts are subject to change without prior notice in the interest of product improvement.

Center Holder
ISP-545

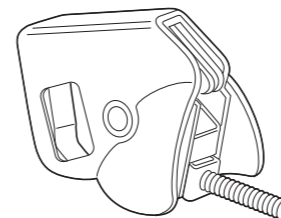

Back Holder
ISP-554

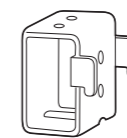

Rear Cover
ISP-546



Bar End Caps
IN-885 (Set of 4 pcs.)



Bar (770mm/30.3")

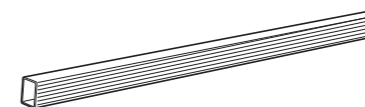

User's Manual

