



- Part number SP1869
00-05 Mitsubishi Eclipse
00-03 Mitsubishi Galant
00-04 Dodge Stratus R/T
00-03 Chrysler Sebring Coupe LXI
3.0 V6 only
- 1- Two piece cold air intake (CA)
 - 1- **3 1/2" Injen filter (#1015)**
 - 1- **3 1/2" composite adapter (#14029)**
 - 1- 2 3/4" 90 deg elbow (#3095)
 - 1- 3 1/4" straight hose (#3045)
 - 1- 3 1/2" straight hose (#3037)
 - 2- Power-Bands (.312) .040 (#4003)
 - 4- Power-Bands (.412) .056 (#4005)
 - 1- 8" 8mm vacuum hose (#3091)
 - 1- m6 vibra-mount (#6020)
 - 1- gray m6 vibra-mount (#6030)
 - 3- m6 flange nuts (#6002)
 - 4- m6 x m25 bolts (#6006)
 - 2- fender washers (#6010)
 - 1- instruction

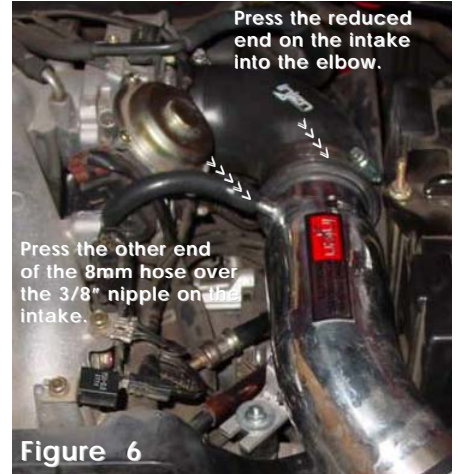
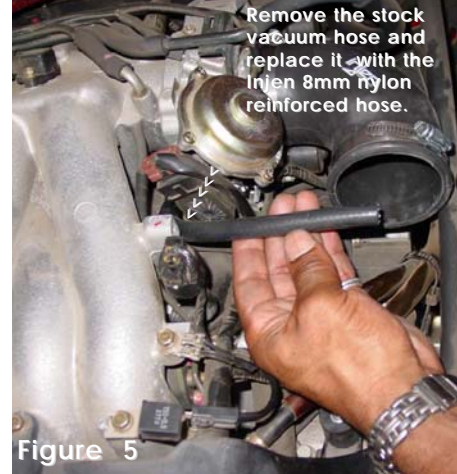
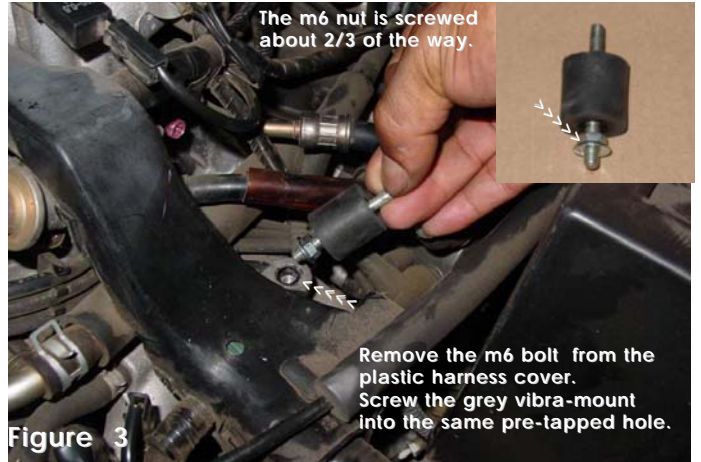

Figure 1

Now available, Hydro Shield by Injen
Part Number X-1034



Hydro Shield Sold Separately



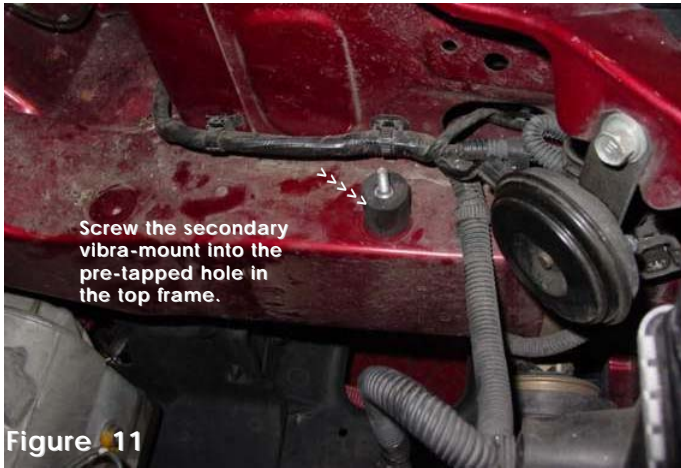

Figure 11



Figure 12



Figure 13

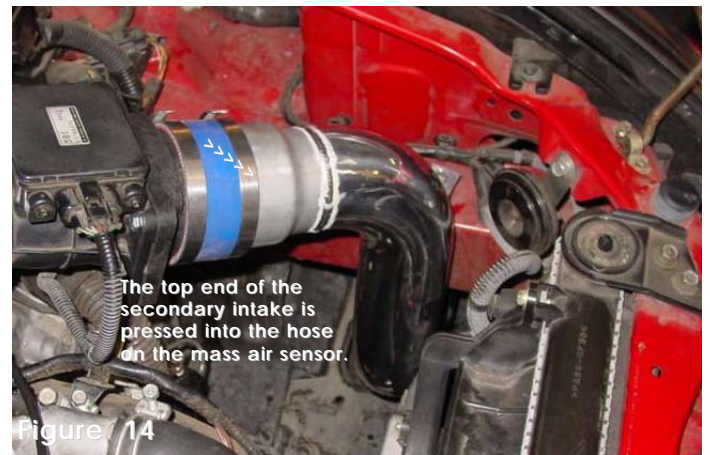

Figure 14

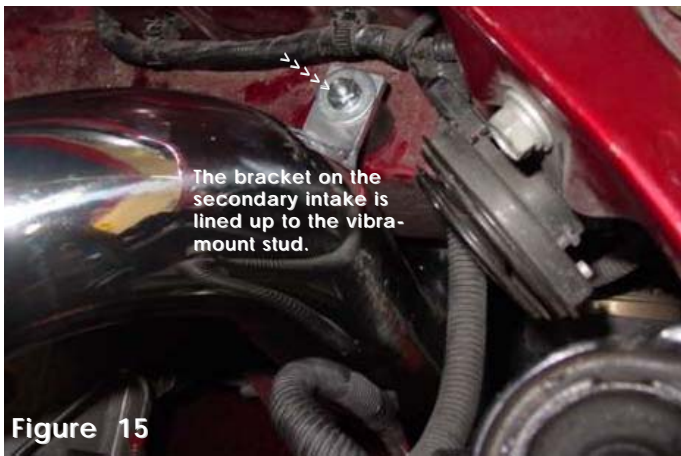

Figure 15

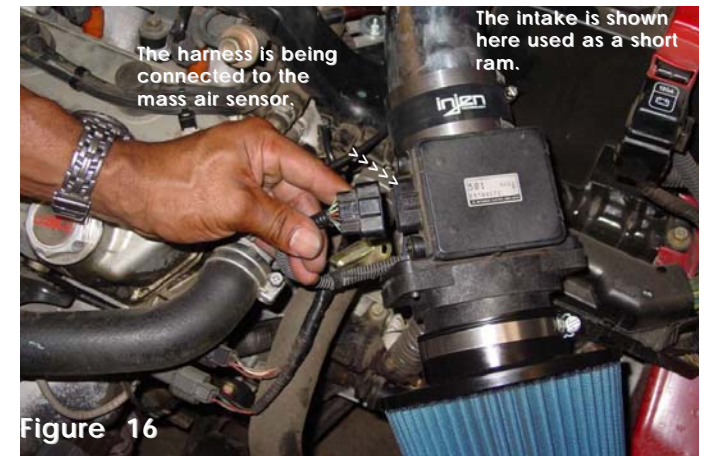
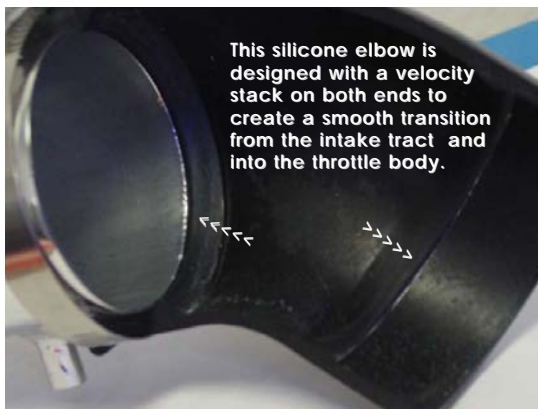

Figure 16



This silicone elbow is designed with a velocity stack on both ends to create a smooth transition from the intake tract and into the throttle body.



This adapter is designed out of special composites that repel heat while creating a vortex affect with the patented fins sealing along the inside walls.

Note: Disconnect the negative battery terminal before starting this installation.

- 1- Remove the stock air intake box and air intake duct leading to the throttle body. For this installation you also need to remove the mass air flow sensor from the stock air box. Some early models may have the air intake resonator box located in the driver side bumper area right under the head lamp. In situations when the resonator box is in the bumper area, you will need to remove it and make room in that location.
- 2- Press the shortest end on the 90 degree elbow over the throttle body. Place a clamp on each end of the elbow then semi-tighten the clamp on the throttle body. (See fig. 2)
- 3- Take the gray vibra-mount and screw the m6 nut 2/3rds of the way on to the stud. Unscrew the m6 bolt from the plastic harness cover and screw the gray m6 vibra-mount into the pre-tapped hole. (See figs. 3 and 4)
- 4- Remove the stock vacuum hose at the throttle body and press the Injen 8mm nylon reinforced hose over the port on the throttle body. (See fig. 5)
- 5- Take the intake and press the 2 3/4" upper end into the elbow on the throttle body. Line up the bracket on the intake to the gray vibra-mount stud, use the fender washer and m6 nut to secure the intake in place. (See figs. 6 and 7)
- 6- Press the 3 1/4" straight hose over the round end on the mass air flow sensor. Place two clamps on hose and only tighten clamp on the mass air sensor at this time. Take the new composite fin adapter and butt it up against the mass air sensor. Use the four m6 x m25 bolts in this kit to attach the adapter to the mass air flow sensor. (See fig. 8)
- 7- Press the hose end on the assembled mass air flow sensor over the end of the primary intake. Position the mass air sensor in place then semi-tighten the clamp. (See fig. 9)
- 8- Take the 3 1/2" straight hose and press it over the end of the adapter inlet, use two clamps and only tighten the clamp on the adapter at this point. (See fig. 10)
- 9- Take the secondary vibra-mount and screw it into the pre-tapped hole located on top of the frame of the car. (See fig. 11)
- 10- Press the 3 1/2" over the end of the secondary intake secondary intake, tighten the clamp on the filter. (See fig. 12)
- 11- Take the assembled intake and filter and insert the filter end into the resonator opening behind the headlamp. (See fig. 13)
- 12- Press the top end of the secondary intake into the 3 1/2" hose on the composite adapter. (See fig. 14)
- 13- Line up the bracket on the secondary intake to the vibra-mount stud. Use the m6 nut and fender washer to hold the intake in place. (See fig. 15)
- 14- Make sure the harness clip is plugged into the mass air flow sensor. You will hear a firm snap when the clip has been plugged in correctly. (See fig. 16)
Note: The C.A.I can be converted into a short ram by placing the filter directly over the composite fin adapter.
- 15- Align the entire cold air intake for best fit. Once proper clearance has been made through out the length of the intake continue to tighten all nuts, bolts and clamps. (See fig. 1)
- 16- Remove all tools and rags from the engine compartment and check all lines and fittings for any leaks or rubbing.
- 17- Congratulations! You have just completed the installation.