



**Part number RD3025**  
**2000-02 Audi TT 1.8T**  
**FWD/Quattro**

- 1- Primary Injen intake tube (CA)
- 1- 4" 2.50"ID coupler
- 1- **Silicone molded intake tube (#3046)**
- 1- **2.50" Injen filter (#1012)**
- 1- 2.75" straight hose (#3043)
- 1- Power-Band (.326)(.048) (#4004)
- 3- Power-Bands(.312)(.040) (#4003)
- 1- 2020 bracket (#20011)
- 1- m6 vibra-mount (#6020)
- 2- m6 nuts (#6002)
- 2- fender washers (#6010)
- 1- m8 flange nut (#6017)
- 1- m8 x 16 hex head bolt (#6018)
- 1- 3025 HID mounting bracket (#20030)
- (Not required on late models)
- 1- instruction



Figure 1

Now available, Hydro Shield by Injen  
Part Number X-1033



Hydro Shield Sold Separately



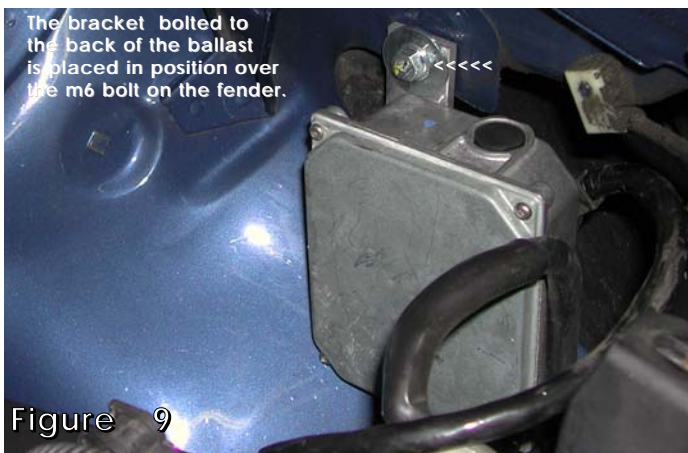
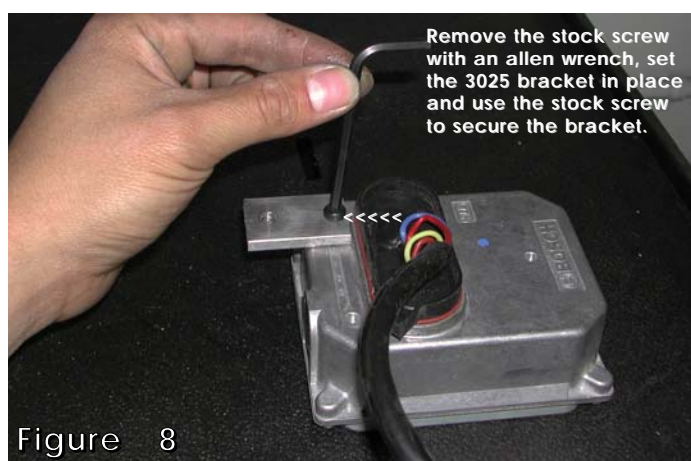
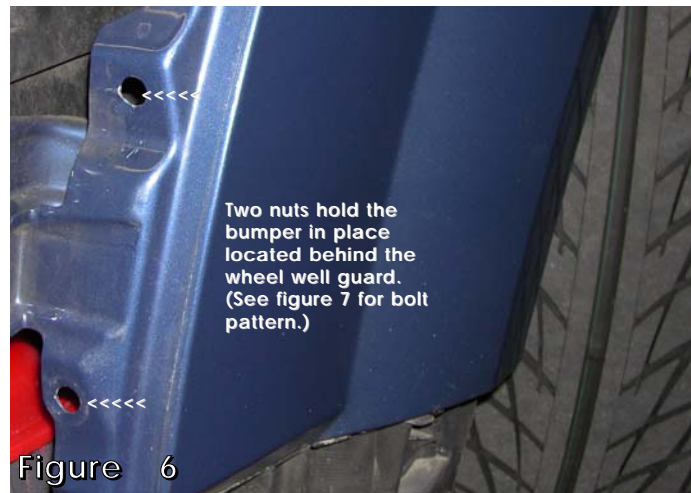
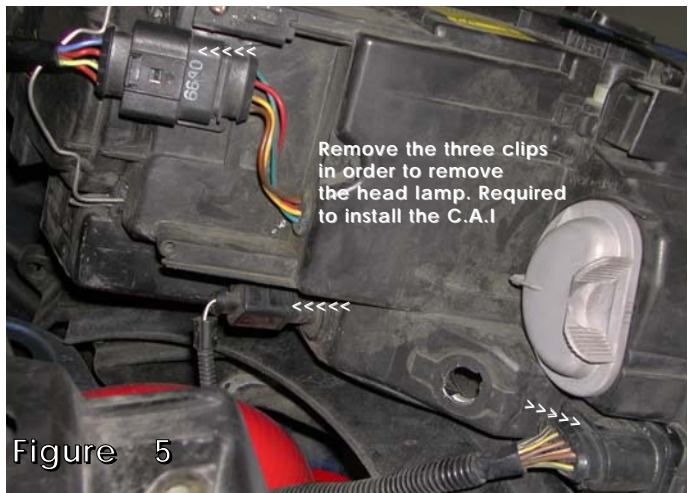
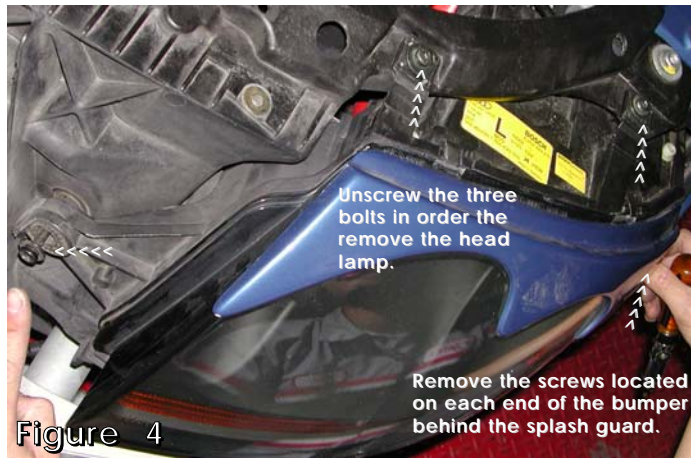



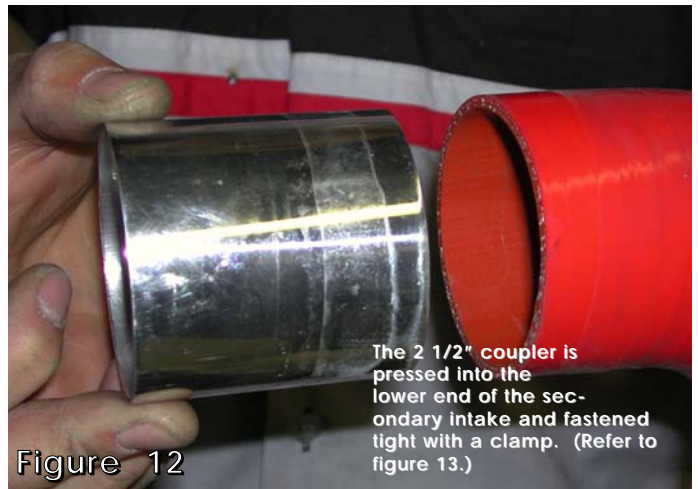
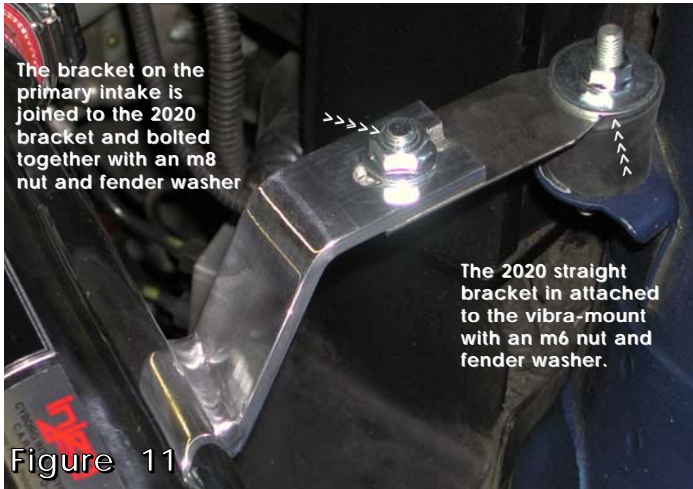

Late models such as this one has the HID ballast built into the head lamp.

These types of ballast will not interfere with the installation of the secondary silicone intake tube.

The 3025 mounting bracket will not be required.

**Note: Disconnect the negative battery terminal before starting this installation.**

1. Remove the air intake box and air intake duct that leads to the mass air flow sensor.
2. Slip the 2 3/4" straight hose over the mass air flow sensor use two clamps and tighten the clamp on the mass air flow sensor. (See fig. 2)
3. Take the vibra-mount and screw it into the bracket located on the side of the strut tower mount. (See fig. 3)

**Removing the head lamp and the front bumper.**

4. Remove the 3 m6 bolts located on the extended plastic arms on the head lamp. (See fig. 4) You will also disconnect the three harness clips located on the back side of the head lamp. (See fig. 5)
5. In order to remove the bumper you need to peel back the splash guards in the wheel well. Unscrew two m6 nuts on each side of the frame located behind the splash guards. (See fig. 6) The nuts are screwed into the two studs located on each side of the bumper. (See fig. 7) Remove the plastic clips located over the front grill and underneath the bumper splash guard. Unscrew the screws on the bumper one located on each side of the top corner behind the wheel well splash guard and carefully remove the bumper (See figs. 4 and 7)
6. Carefully remove the HID ballast from the stock location. Take an allen wrench and remove the bolt on the back side of the pad. Take the 3025 bracket in this kit and place it in position replace the bolt back to its original location. (See fig. 8) **Note:** Some late model cars have the HID ballast built into the head lamp no changes are required. (See fig. 17)
7. Take the assembled ballast and hang it on the stud located on the fender wall use the m6 nut and fender washer to hold it in place. (See fig. 9)
8. Take the 2020 straight bracket, m6 nut and fender washer and attach it to the vibra-mount. (See fig. 11)
9. Insert the top end of the intake into the 2 3/4" straight hose on the mass air flow sensor. Align the intake bracket to the 2020 bracket on the vibra-mount use the m8 nut and bolt to hold the intake in place. (See figs. 10 and 11)
10. Take the 2 1/2" connecting coupler and secondary silicone intake then insert the coupler into the 2 1/2" side of the secondary intake use a clamp to hold the coupler in place. (See fig. 12)
11. Press the Injen filter on the other end of the connecting coupler then fasten the clamp tight. (See fig. 13)
12. Insert the top end of the secondary intake under the frame and up over the primary intake. Align the secondary intake for best fit and tighten the clamp. (See figs. 14 and 15)
13. Take the plastic connecting hose on the air pump and press the clip end over the machined tip on the intake vacuum tube. (See fig. 10)
14. Align the entire intake system for best fit. Once proper clearance has been made throughout the length of the intake continue to tighten all nuts, bolts and clamps. (See figs. 1 and 16)
15. Replace the bumper back to its stock location and replace all nuts, bolts and plastic clips holding the bumper in place.
16. Reconnect the negative battery terminal and remove all tools and rags from the engine compartment prior to starting the engine.
17. Congratulations! You have just completed the installation.