

Instruction P/N:EVO7200

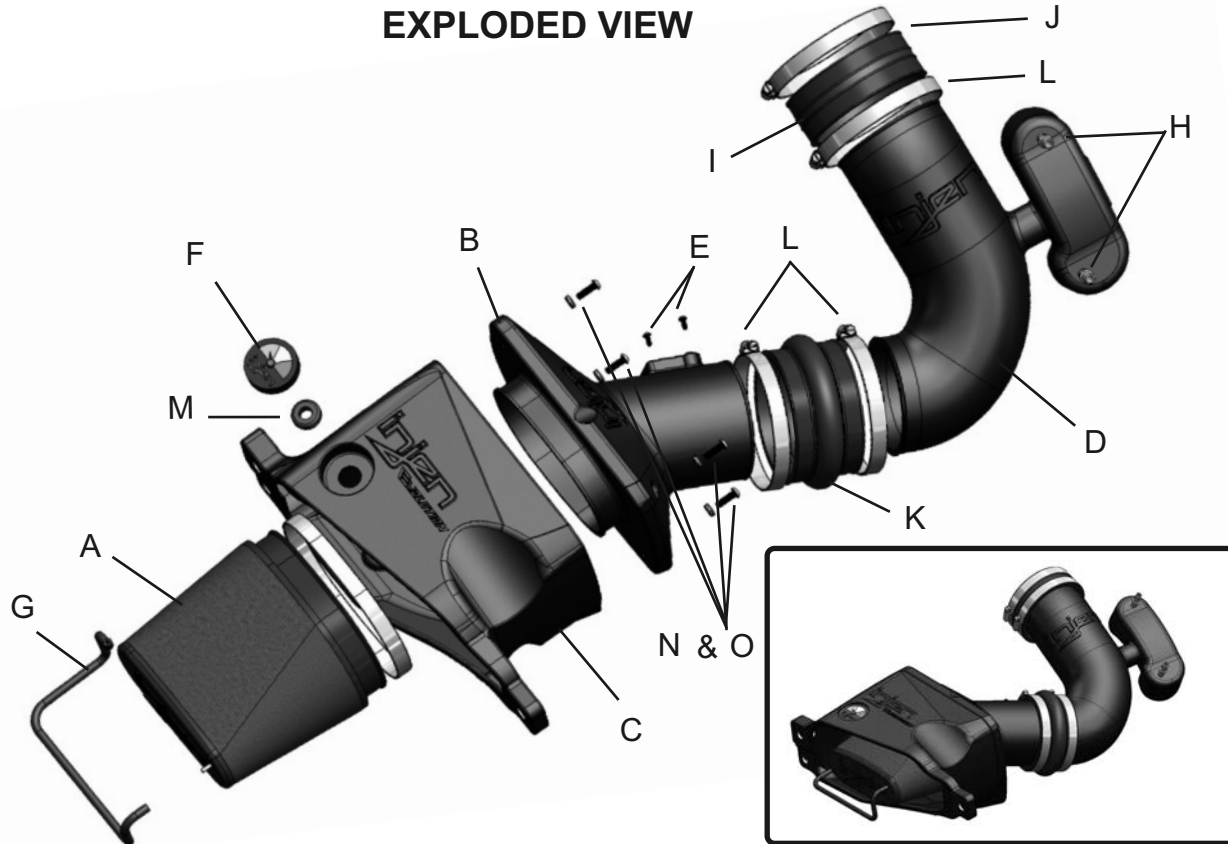

Vehicle Application:
 Make: **Chevrolet**
 Model: **Corvette StingRay C7**
 Year: **2014/2015**
 Engine: **6.2L**

EXPLODED VIEW



Item	QTY.	P/N	Discription
A	1	1083	Air Filter
B	1	15073	Plenum
C	1	15074	Box
D	1	15072	Tube
E	2	6047	M4 screws
F	1	15040	Filter Minder
G	1	3198	3mm Hose @ 12"L
H	2	14064	3/8" Machined Fitting
I	1	3149	Step Hose
J	1	4008	#64 Clamps
K	1	3200	4.5" Hump Hose
L	3	4014	#72 Clamps
M	1	8026	Grommet
N	4	6100	M6x20mm
O	4	8047	Rubberized Washers

TOOLS REQUIRED

- 10mm Ratchet & Socket
- 8mm nut drive
- Allen key
- Needle nose
- Phillips Screwdriver
- Pliers

WARNING: FAILURE TO FOLLOW INSTALLATION INSTRUCTIONS AND NOT USING THE PROVIDED HARDWARE MAY DAMAGE THE INTAKE SYSTEM, ENGINE AND COMPONENTS!!!
*Do not attempt to install the intake system while the engine is hot.
 Severe burn could result from touching hot engine components!

The SuperNano-Web filter media is a dry synthetic media that outperforms the competition. The media itself is a proprietary base blend of synthetics and cellulose. Cellulose fibers are larger than synthetic fibers, and have larger spaces between the fibers, causing contaminants to load in the depth of the media and plug the airflow path. This creates higher restriction levels and less capacity. The synthetic fibers in the SuperNano-Web media are submicron in diameter and have small interior fiber spaces, which result in more contaminants being captured on the surface of the media. This can help keep restriction levels low as the filter loads with dirt and containments



If you look at the picture to the left, you can see the Nano-fiber web on top of our base media. That web, or Super-Nano-Web as we like to call it, helps trap smaller particles and protect your engine.

To Clean your filter:

Carefully remove the filter from the housing. Once removed, wipe down the housing using a clean shop towel, being careful not to knock any dirt and/or debris in the air inlet. Your filters can be cleaned by carefully vacuuming the filter media from the dirty side, or by holding the filter with one hand and carefully blowing the filter media at a 45-degree angle from the clean side using low-pressure shop air (15-20 lbs. psi).

****IT IS IMPORTANT TO NOT USE ANY CLEANERS ON THE SUPERNANO-WEB MEDIA OR APPLY ANY OIL!!!***

NOTE: DISCONNECT BATTERY BEFORE INSTALLATION!!!

Instruction Manual P/N:EVO7200



1. Stock intake system shown.



2. Use a 7mm nut driver to remove the four air vent screws. Remove the air vent from the engine bay for now.



3. Loosen the clamps on the stock intake tube using 8mm nut driver. Disconnect the crank case lines on intake tube.



4. Now pull out the intake tube out of vehicle.



5. Pull back lines away from the air box. Disconnect MAF sensor harness.



6. Loosen the two 10mm bolts holding in air box.



7. Carefully remove the air box out of the vehicle.



8. Loosen the 2 screws holding in the MAF sensor, remove the sensor.

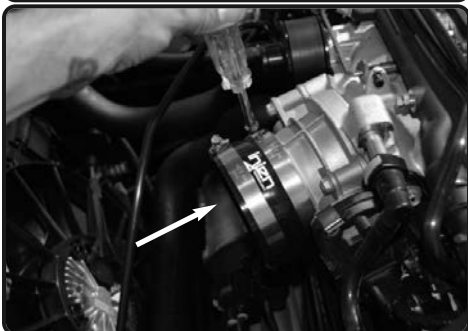

9. Install the straight hose with clamps to throttle body. Tighten the clamp on throttle body only.

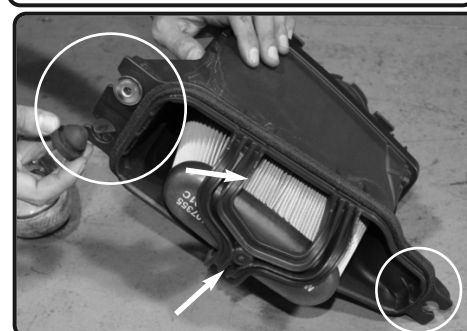

10. Remove the factory grommets and washer-spacer out of air box. These will be used on new injen air box. Keep same configuration.

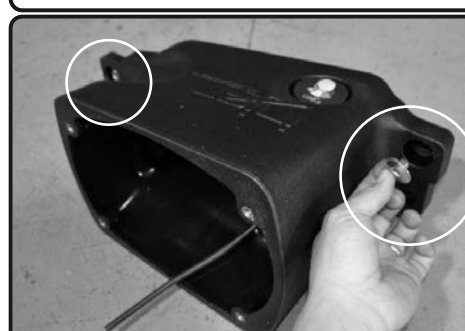

11. Now install the grommets and washer-spacers to the new injen airbox.



12. Install the provided grommet to the hole on air box. Now attach the 3mm hose to the filter minder. Now install the filter minder to the air box and make sure the filter minder seats in grommet.

Instruction Manual P/N:EVO7200

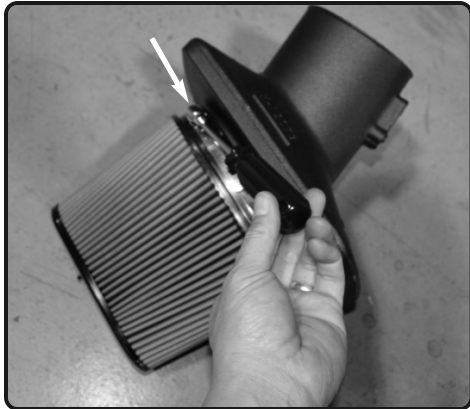

13. Place the filter onto the Injen plenum and then secure the clamp



14. Install the plenum assembly into the lower air box.

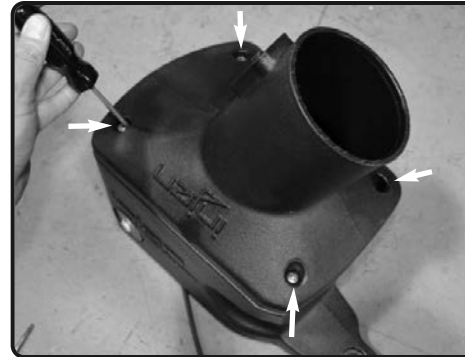

3. Place the Injen plenum onto the Injen lower air box assembly and use 4-M6X20 bolts and rubberized washers secure the plenum to the lower air box.



4. Connect the 3mm hose to the fitting on air filter and secure.



5. Now install the MAF sensor into the plenum. Secure using provided M4 screws.



6. Install the airbox assembly to the factory position.



7. Secure the air box using factory bolts. Tighten and secure using 10mm socket and ratchet.

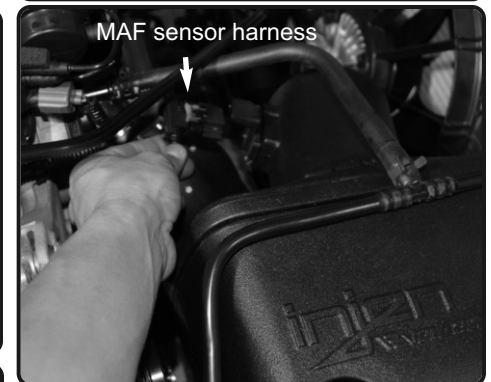

8. Re-connect MAF sensor harness.

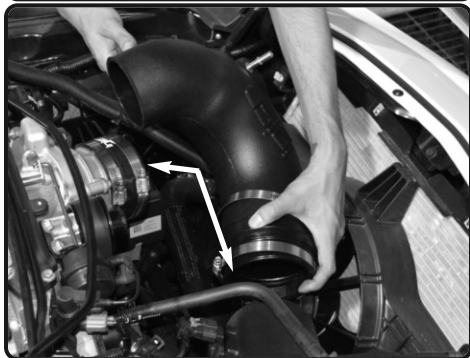

9. Install the intake tube. Attach the with clamps to the intake tube. Position for best fit.

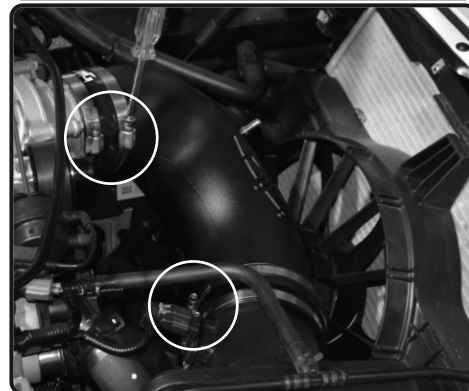

10. Now secure and tighten all clamps using 8mm nut driver.



11. Re-connect both crank case fittings.



12. Re-install air vent and secure.



Congratulations! You have just completed the installation of this intake system. Periodically, check the alignment of the intake, normal wear and tear can cause nuts and bolts to come loose. **Note: Check clearance and adjust if needed! Failure to check the alignment and adjust the intake can cause damage that will void the warranty. Injen Technology is not responsible for any damages caused by/from improper installation.**

Test Drive:

1. With the transmission in neutral or park and the parking brake engaged, start the engine. Listen for air leaks or odd noises. If air leaks are detected, secure hoses and connections. For any odd noises, inspect entire system for cause and adjust intake as needed. The Injen intake will function identically to the factory system but will be louder and more powerful.
2. Perform a road test. Listen for odd noises or rattles and fix as necessary.
3. If there are no issues, continue to enjoy your added performance from the Injen performance Intake kit.
4. Injen Technology recommends you periodically check clearance and adjust if needed! Failure to check the alignment and adjust the intake can cause damage that will void the warranty. Injen Technology is not responsible for any damages caused by/from improper installation.

1. Upon completion of the installation, reconnect the negative battery terminal before you start the engine.
2. Align the entire intake system for the best possible fit. Once the intake has been properly fitted continue to tighten all nuts, bolts and clamps.
3. Periodically, recheck the alignment of the intake system and make sure there is proper clearance around and along the length of the intake. Failure to follow proper maintenance procedures may cause damage to the intake and will void the warranty.
4. Start the engine and listen carefully for any odd noises, rattles and/or air leaks prior to taking it for a test drive. If any problems arise go back and check the vacuum lines, hoses and clamps that maybe causing leaks or rattles and correct the problem.
5. Check the filter for excessive dirt build up. Clean or replace the filter with an original Injen filter. Congratulations! You have just completed the installation of the best intake system sold on the market. Enjoy the added power and performance of your new intake system.