

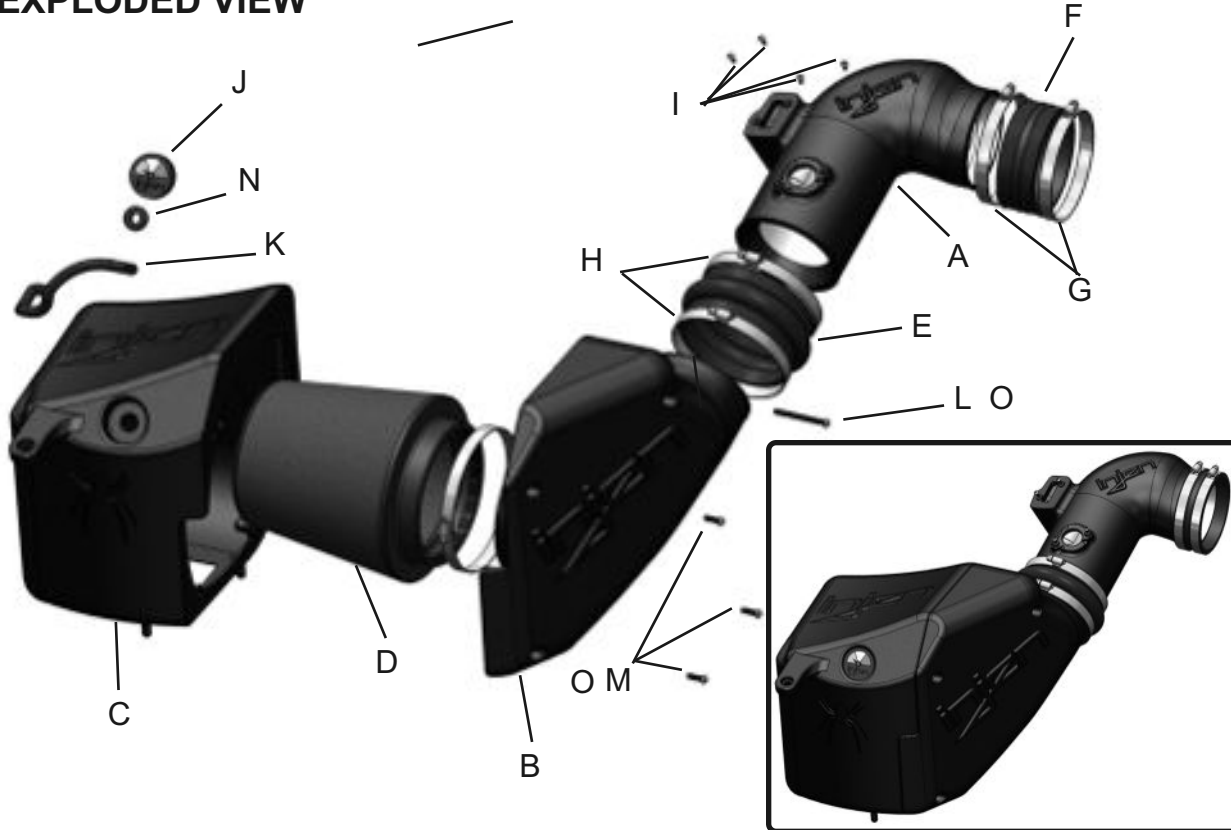

EXPLODED VIEW



Vehicle Application:
 Make: **Chevrolet /GMC**
 Model: **Silverado / Sierra**
2500/3500
 Year: **2013-2014**
 Engine: **6.6L (TD) Duramax LML**

Item	QTY.	P/N	Discription
A	1	#15054	Rotomold Tube
B	1	#15055	Rotomold Plenum
C	1	#15056	Rotomold Box
D	1	#1068	6.00" Filter
E	1	#3201	5.00" Hump Hose
F	1	#3163	4.25"- 4.50" Straight Hose
G	2	#4014	#72 Clamps
H	2	#4019	#80 Clamps
I	4	#6047	M4X10mm Button Head Bolts
J	1	#15040	Filter Minder
K	1	#3198	3mm-16" Vacuum Hose
L	1	#6095	M6X80mm Bolt
M	3	#6096	M6x30mm bolt
N	1	#8026	Grommet
O	4	#8047	1/2"OD rubber seal washer

TOOLS REQUIRED

- 10mm Ratchet & Socket
- 8mm nut drive
- Allen key
- Flat Blade Screwdriver
- Philllips Screwdriver

WARNING: FAILURE TO FOLLOW INSTALLATION INSTRUCTIONS AND NOT USING THE PROVIDED HARDWARE MAY DAMAGE THE INTAKE SYSTEM, ENGINE AND COMPONENTS!!!
***Do not attempt to install the intake system while the engine is hot.**
 Severe burn could result from touching hot engine components!

Report any defective or missing parts to the authorized Injen dealer you purchased this product from. Before installing any parts of this system, please read the instructions thoroughly. If you have any questions regarding installation, please contact your Injen Technology dealer. Installation DOES require some mechanical skills. A qualified mechanic is always recommended.

A Limited Lifetime Warranty to the original purchaser against defects in material and workmanship on all Injen intake systems excluding the filter element. Any and all warranty coverage is limited to the repair or replacement of the defective part only, at Injen Technology's discretion. The warranty does not cover incidental or consequential damages, nor does it cover the cost of installation or removal of the defective part or its replacement. Proof of purchase is required.

Instruction Manual P/N:EVO7005

NOTE: This intake kit may not work on vehicles with the following aftermarket modifications.

- Aftermarket Intercooler piping
- Aftermarket intercooler
- Turbo upgrade
- Modified body panels
- Suspension & Chassis modifications

Injen intake systems are street legal in most states unless the state is adopting to California Emissions standards. States that have adopted California emission standards include: Arizona, California, Connecticut, District of Columbia, Maine, Maryland, Massachusetts, New Jersey, New Mexico, New York, Oregon, Pennsylvania, Rhode Island, Vermont, and Washington. These states will require an California Air Resource Board Executive Order Number (CARB E.O.) for the legal use of an Injen intake system in your vehicle for use on public roads or highways. These vehicle will be considered "Legal in California only for racing vehicles competition use only, which may never be used upon a public street or highway. **Please keep your factory air box assembly for any future use.**



The SuperNano-Web filter media is a dry synthetic media that outperforms the competition. The media itself is a proprietary base blend of synthetics and cellulose. Cellulose fibers are larger than synthetic fibers, and have larger spaces between the fibers, causing contaminants to load in the depth of the media and plug the airflow path. This creates higher restriction levels and less capacity. The synthetic fibers in the SuperNano-Web media are submicron in diameter and have small interior fiber spaces, which result in more contaminants being captured on the surface of the media. This can help keep restriction levels low as the filter loads with dirt and containments



If you look at the picture to the left, you can see the Nano-fiber web on top of our base media. That web, or Super-Nano-Web as we like to call it, helps trap smaller particles and protect your engine.

To Clean your filter:

Carefully remove the filter from the housing. Once removed, wipe down the housing using a clean shop towel, being careful not to knock any dirt and/or debris in the air inlet. Your filters can be cleaned by carefully vacuuming the filter media from the dirty side, or by holding the filter with one hand and carefully blowing the filter media at a 45-degree angle from the clean side using low-pressure shop air (15-20 lbs. psi).

****IT IS IMPORTANT TO NOT USE ANY CLEANERS ON THE SUPERNANO-WEB MEDIA OR APPLY ANY OIL!!!***

NOTE: DISCONNECT BATTERY BEFORE INSTALLATION!!!

Instruction Manual P/N:EVO7005



1. Stock intake system shown.

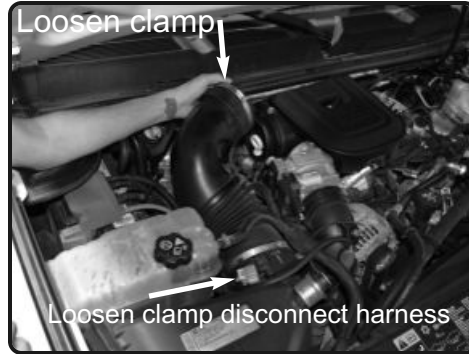

2. Disconnect the MAF sensor harness. Loosen the clamp on the intake duct and then remove entire air duct



3. Remove the factory torx screws from the MAF sensor and then remove the MAF sensor from the factory air box assembly.



4. Firmly lift up on the stock air box assembly and pull the stock air box assembly out of the engine bay.

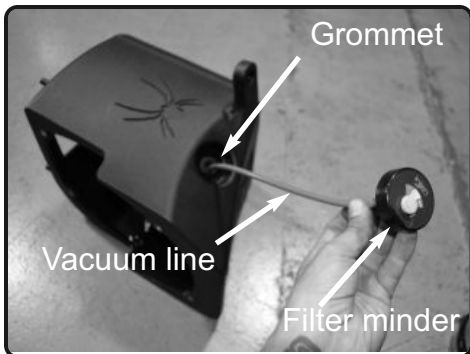

5. Place the grommet onto the drilled hole on top of the Injen air box. Connect the vacuum line to the filter minder then run the Filter minder into the grommet.



6. Place the filter onto the the Injen intake plenum and then secure the clamp.

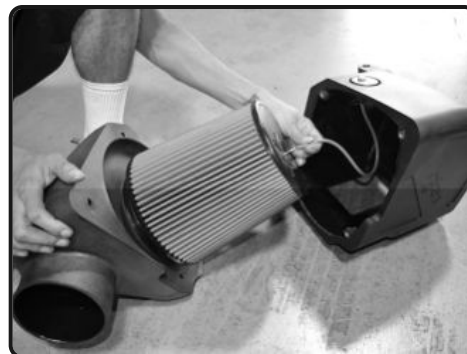

7. Connect the 3mm vacuum hose from figure 6 to the barbed fitting on the filter

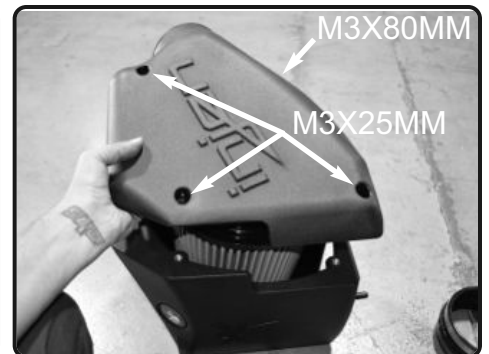

8. Place the three M6X25mm bolts and one M6X80mm into the plenum illustrated by the photo. Your Injen air box assembly is now complete.



9. Remove the 10mm headlight bracket bolt on the passenger side headlight. The Injen air box assembly will bolt up to this bolt.

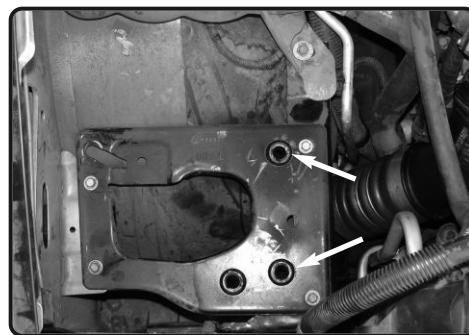

10. The factory air box assembly bracket is shown in the photo. Arrows indicate the grommets where the Injen air box mounts will go.



11. Lower the Injen air box into the engine bay. Make sure the pegs under the Injen air box goes into the factory air box grommets on the air box tray from figure 10



12. Place the 4.25"-4.50" step hose and two #72 clamps onto the turbo inlet. Tighten the clamp on the turbo inlet side for now.

Instruction Manual P/N:EVO7005

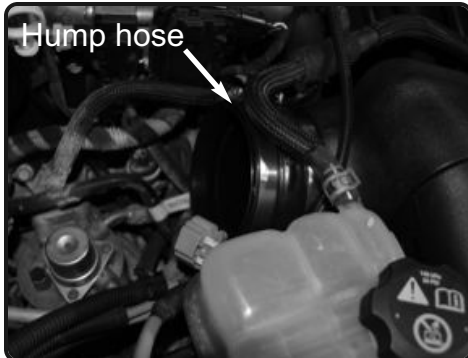

13. Place the 5.00" hump hose and two #80 clamps onto the Injen intake plenum on the Injen air box.

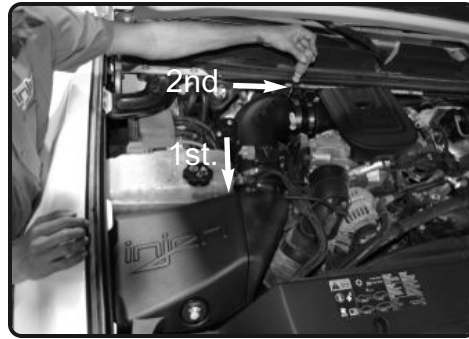

14. First slide the big end of the intake pipe into the 5.0" hump hose on the air box plenum. Then slip the smaller end into the 4.25"-4.50" step hose on the turbo inlet. Once intake is adjusted, tighten all clamps.

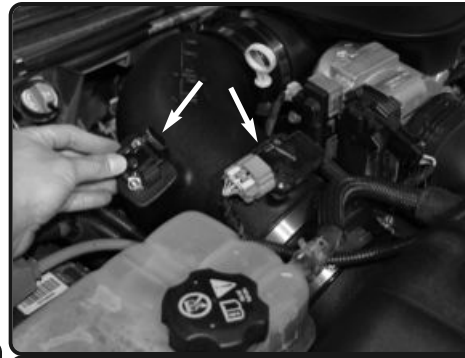

15. Place both MAF sensors onto their appropriate location and then screw them down with the supplied M4 bolts. Reconnect the MAF sensor harnesses



16. Reuse the factory 8mm bolt and secure the Injen air box bracket to the passenger side headlight bracket.



Congratulations! You have just completed the installation of this intake system. Periodically, check the alignment of the intake, normal wear and tear can cause nuts and bolts to come loose. **Note: Check clearance and adjust if needed! Failure to check the alignment and adjust the intake can cause damage that will void the warranty. Injen Technology is not responsible for any damages caused by/from improper installation.**

Test Drive:

1. With the transmission in neutral or park and the parking brake engaged, start the engine. Listen for air leaks or odd noises. If air leaks are detected, secure hoses and connections. For any odd noises, inspect entire system for cause and adjust intake as needed. The Injen intake will function identically to the factory system but will be louder and more powerful.
2. Perform a road test. Listen for odd noises or rattles and fix as necessary.
3. If there are no issues, continue to enjoy your added performance from the Injen performance Intake kit.
4. Injen Technology recommends you periodically check clearance and adjust if needed! Failure to check the alignment and adjust the intake can cause damage that will void the warranty. Injen Technology is not responsible for any damages caused by/from improper installation.

1. Upon completion of the installation, reconnect the negative battery terminal before you start the engine.
2. Align the entire intake system for the best possible fit. Once the intake has been properly fitted continue to tighten all nuts, bolts and clamps.
3. Periodically, recheck the alignment of the intake system and make sure there is proper clearance around and along the length of the intake. Failure to follow proper maintenance procedures may cause damage to the intake and will void the warranty.
4. Start the engine and listen carefully for any odd noises, rattles and/or air leaks prior to taking it for a test drive. If any problems arise go back and check the vacuum lines, hoses and clamps that maybe causing leaks or rattles and correct the problem.
5. Check the filter for excessive dirt build up

Enjoy the added power and performance of your new intake system.